

Sicherheitsbestimmungen · Safety instructions · Consignes de sécurité
 Disposiciones de seguridad · Norme di sicurezza · Veiligheidsbepalingen ·
 Prescrições de segurança · Säkerhetsbestämmelser · Turvallisuusohjeet
 Zasady bezpieczeństwa · Biztonsági rendelkezések · Varnostna določila
 Bezpečnostní předpisy · Bezpečnostné predpisy · Sikkerhetsbestem-
 melser · Sikkerhedsbestemmelser · أنظمة السلامة · Διατάξεις ασφαλείας ·
 安全准则 · 안전수칙

#370160139 Drift Car

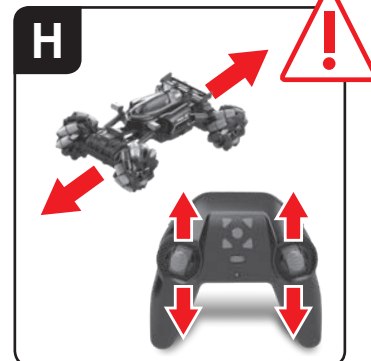
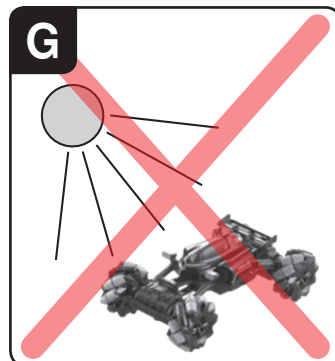
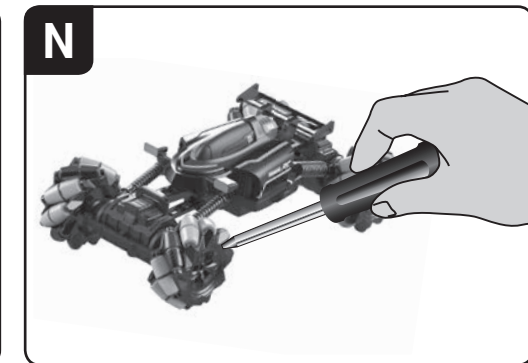
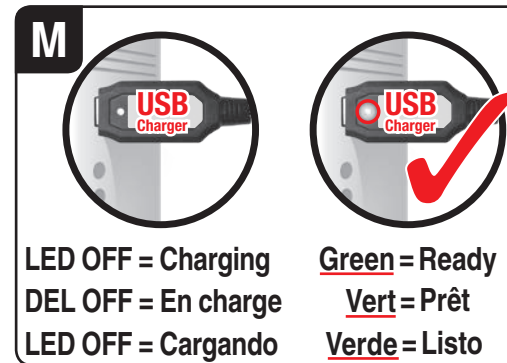
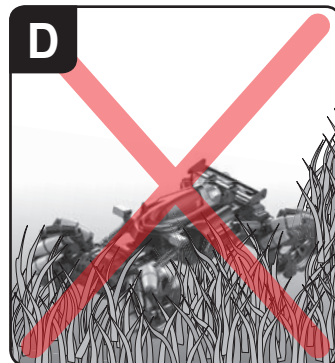
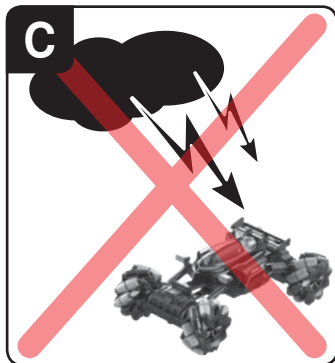
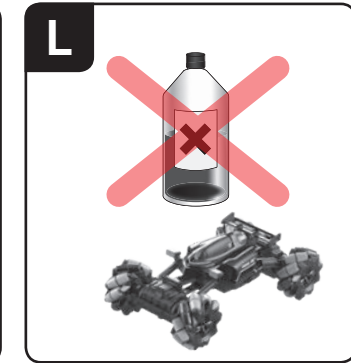
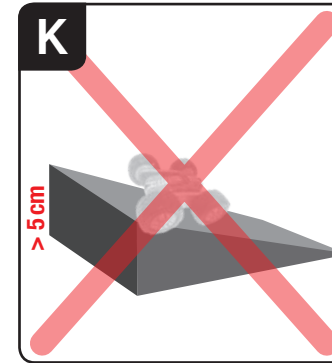
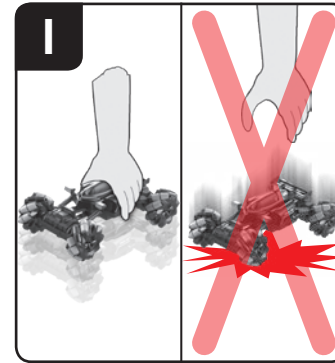
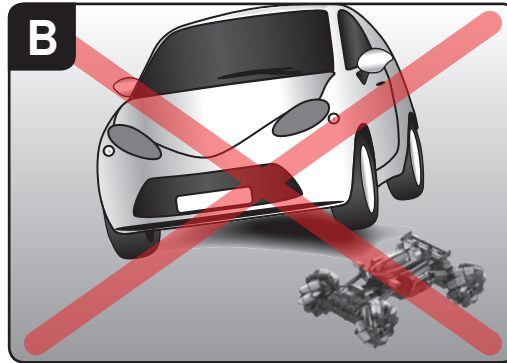

Vorläufiges Modell/Symbolabbildung
 Preliminary model/Symbolic image only
 Modèle provisoire/Illustration avec symboles
 Modelo provisional/Illustración de símbolo

1

USB Charger

**6,4 V 700 mAh!
4,48 Wh LiFePO₄**

**2x 1.5 V Micro AAA batteries
2x Piles 1, 5 V micro AAA
2x Pilas de 1,5 V Micro AAA**

8

~ 20 km/h

4m **5m**

9

2

1 **2** **6,4 V 700 mAh!
4,48 Wh LiFePO₄**

**LED OFF = Charging
DEL OFF = En charge
LED OFF = Cargando**

**Green = Connection OK
Vert = Connexion OK
Verde = Conexión OK**

**Green = Ready
Vert = Prêt
Verde = Listo**

10

R **L**

11

360°

3

**6,4 V
700 mAh!
4,48 Wh
LiFePO₄**

4

**2x 1.5 V Micro AAA batteries
2x Piles 1, 5 V micro AAA
2x Pilas de 1,5 V Micro AAA**

12

L 2 **1 R** **2** **L** **R**

13

3 **4** **5** **6**

5

OFF **ON**

6

OFF **ON**

7

14

ON-Road

OFF-Road

7

15