**Zündapp KS 750**

Über 18.000 Exemplare des Modells Zündapp KS 750 wurden von 1941 bis 1944 in Serie hergestellt. Dank seiner klaren Linienführung und des zweckmäßigen technischen Konzepts war es eines der fortschrittlichsten und modernsten Motorräder seiner Zeit. Aufgrund seiner außerordentlichen Leistungen und Robustheit wurde es vom Deutschen Heer während des zweiten Weltkrieges an allen Fronten eingesetzt. Der Viertaktmotor mit einem Hubraum von 751 ccm erzielte eine konstante Leistung von 26 PS bei 4.400 Umdrehungen pro Minute. Die Motorkraft wurde auf zwei Antriebsräder verteilt, die das 400 kg (mit Beiwagen) schwere Krad auf eine maximale Geschwindigkeit von 95 Km/h beschleunigten. Die Zündapp verfügte über 4 Vorwärtsgänge, einen untersetzten Geländegang und sogar über einen Rückwärtsgang. Der Verbrauch betrug auf der Straße ca. 7 Liter pro 100 Km, im Gelände wurden es 9 Liter und mehr, trotzdem konnte eine Reichweite von 350 Km erzielt werden.

Zündapp KS 750

More than 18,000 machines of the Zündapp KS 750 model were produced in series between 1941 and 1944. With its clear, streamlined design and practical technological concept, it was one of the most advanced and state-of-the-art motorcycles of its day. Thanks to its exceptional performance and robustness it was deployed by the German Army on all fronts during WW II. The 751 cc four-stroke engine produced a constant output of 26 h.p. at 4,400 rpm. The engine power was transferred to two drive wheels which accelerated this heavy motorcycle (400 kg incl. sidecar) to a top speed of 95 km/h. The Zündapp had four forward speeds, a stepped-down off-road gear and even a reverse gear. Fuel consumption on the road was approx. 7 litres per 100 kilometres, off-road it took 9 litres and more. Nevertheless, a range of around 350 kilometres could be achieved.

Verwendete Symbole / Used Symbols

Bitte beachten Sie folgende Symbole, die in den nachfolgenden Baustufen verwendet werden.

Veľmiž oter les symboles indiqués ci-dessous, qui sont utilisés dans les étapes suivantes du montage.
Silvance tener en cuenta los símbolos facilitados a continuación, a utilizar en las siguientes fases de construcción.
Si prega di fare attenzione ai seguenti simboli che vengono usati nei susseguenti stadi di costruzione.
Huomioi seuraavien symbolien, joita käytetään seuraavissa kokoonpanovaiheissa.
Legg merke III symbolene som benyttes i monteringsstrinene som følger.
Proszę zwracać na następujące symbole, które są użyte w poniższych etapach montażowych
Daha sovrakı montaj basamaklarında kullanılacak olan, aşağıdaki sembollere lütfen dikkat edin.
Körjék, hogy a következő szimbólumokat, melyek az alábbi építési fázisokban alkalmazásra kerülnek, vegyétek figyelembe.

Please note the following symbols, which are used in the following construction stages.

Neem a.u.b. de volgende symbolen in acht, die in de onderstaande bouwfasen worden gebruikt.
Por favor, preste atenção aos símbolos que seguem pois os mesmos serão usados nas próximas etapas de montagem.
Observara: Nedanstående piktogram används i de följande arbetsmomenten.
Leg venligst merke III følgende symboler, som benyttes i de følgende byggestraper.

Показате, обратите внимание на следующие символы, которые используются в последующих операциях сборки.
Παρακαλώ προσέξτε τα παρακάτω σύμβολα, τα οποία χρησιμοποιούνται στις παρακάτω βαθμίδες συναρμολόγησης.
Dbejte prosim na dále uvedené symboly, které se používají v následujících konstrukčních stadiích.
Prosimo za Vašu pozornost na sledeće simbole ki se uporabljajo v naslednjih korakih gradnje.



Abziehbild in Wasser einweichen und anbringen
Soak and apply decals
Mouiller et appliquer les décalcomanies
Transfer in water even latex waxes en aanbrengen
Remojar y aplicar las calcomanías
Por de molho em água e aplicar o decalque
Immergere in acqua ed applicare decalcomanie
Díkt och fast dekalerna
Kostula silinokiva vedessä ja aseta paikalleen
Fukt mövel i varmt vatten och lät det ovet på modellen
Dypp bildet i vann og sett det på
Персонально картишки намочить и нанести
Zmiezkyz kalcomanię w wodzie a następnie nakleić
βουτήξτε τη χαλκομανία στο νερό και τοποθετήστε τη
Çiğartmayı suda yumuşatın ve koyun
Ötisk namöcít ve vodě a umísti
a matricál vízben beázlatni és felhelyezni
Preskicač potopiti v vodo in zatem nanasati



Kleben
Glue
Coller
Lijmen
Engomar
Colar
Non incollare
Limmas
Limmaa
Limes
Lim
Клеить
Przykleić
κόλλημα
Yapıştırma
Lepeni
ragasztani
Lepiti



Nicht kleben
Don't glue
Ne pas coller
Niet lijmen
Non engomar
Não colar
Non incollare
Limmas ej
Aiä limmaa
Skal ikke limes
Ikke lim
Не клеить
Nie przyklejać
μη κολλάτε
Yapıştırmayın
Nelapiti
nem szabad ragasztani
Ne lepiti



Wahlweise
Optional
Facultatif
Naar keuze
No engomar
Alternado
Facultativo
Vaihtiv
Vaihtoehtoisesti
Vaigrlitt
Valgrlitt
Ha valdort
Do wyboru
εναλλακτικά
Semmel
Voltelnd
letesz szert
način izbire



Anzahl der Arbeitsgänge
Number of working steps
Nombre d'étapes de travail
Het aantal bouwstappen
Número de operaciones de trabajo
Número de etapas de trabalho
Numero di passaggi
Antal arbetsmoment
Tyvähäiden lukumäärä
Antali arbeidstrinn
Antali arbeidstrinn
Κομίστασση οπράσιων
Liczba operacji
αριθμός των εργασιών
Is sahalarminn sayis
Počet pracovných operáci
a munkafolyamatok száma
Številka koraka montaže



Klebeband
Adhesive tape
Dévidoir de ruban adhésif
Plakband
Cinta adhesiva
Fita adesiva
Nastro adesivo
Tejp
Teippi
Tape
Tape
Клейкая лента
Tašma klejaca
κόλλητική ταινία
Yapıştırma bandı
ծծծծծծ օւծծծծ օւծծծծ օւծծծծ օւծծծծ օւծծծծ
Tiáð á "öðð"



Klarsichtteile
Clear parts
Pièces transparentes
Transparente onderdelen
Limpiar las piezas
Peça transparente
Parte transparente
Gonomsittiliga delar
Läpinäkyvät osat
Glassklare deler
Gjennomsiktige deler
Προзрачные детали
Elemeny przezroczyste
διαφανή εξαρτήματα
Šeffa parçalar
Průzračné díly
átetsző alkatrészek
Deli ki se jasno vide



Gleichen Vorgang auf der gegenüberliegenden Seite wiederholen
Repeat same procedure on opposite side
Opérer de la même façon sur l'autre face
Dezelfde handeling herhalen aan de tegenoverliggende kant
Realizar el mismo procedimiento en el lado opuesto
Repetir o mesmo procedimento utilizado no lado oposto
Stessa procedura sul lato opposto
Upprepa proceduren på motsatta sidan
Toista sama toimenpide kullen viereisellä sivulla
Gjenta prosedyren for den motsatte siden
Gjenta prosedyren på siden lvers overfor
Повторять такую же операцию на противоположной стороне
Taki sam przebieg czynności powtórzyć na stronie przeciwniej
επανάλαβε την ίδια διαδικασία στην απέναντι πλευρά
Aynı işlemi karşı tarafta tekrarlayın
Stajny postup zopakovat na protilehlé straně
ugyvanazt a folyamatot a szemben található oldalon megismételni
Isti postopek ponoviti in na suprotni strani



Abbildung zusammengesetzter Teile
Illustration of assembled parts
Figure représentant les pièces assemblées
Afbeelding van samengevoegde onderdelen
Ilustración piezas ensambladas
Ilustração peças encaixadas
Illustratione delle parti assemblate
Bilden visa "dåarna hopsatta
Kuva yhteensillitystä osista
Illustrasjonen viser de sammensatte delene
Illustrasjon, sammensatte deler
Изображение смонтированных деталей
Rysunek złożonych części
εικόνιση των συναρμολογημένων εξαρτημάτων
Birleştirilen parçaların şekli
Zobrazení sestavených dílů
összeállított alkatrészek ábrája
Slika sklopljenoga dela

Benötigte Farben / Used Colors

Benötigte Farben Required colours	Peintures nécessaires Derecidiye kleuren	Pinturas necesarias Tintas necessárias	Colori necessari Använda färger	Tarvillavat värt Du trenger følgende färger	Nødvendige farver Необходимые краски	Potrzebne kolory Απαιτούμενα χρώματα	Gerekli renkler Potřebné barvy	Szükséges színek. Potrebne barve
A panzergrau, matt 78 tank grey, mat gris blindé, mat panzergrj, mat pionzo, mate cemento militar, fosco color casto armato, opaco pansergri, mat pansarinfärg, himmeä kamprogrä, mat pansergri, mat серый танк, матовый szary czoig, matowy γκρι τανκς, ματ panzer grijs, mat панцёрный бёдä, матнä pãncërszürke, mat okropno siva, mat	B Afrikabraun, matt 17 Africa brown, mat Bun Afrique, mat Afrikabrun, mat Marón africano, mate Castanho africano, mate Bruno africano, opaco Afrikabrun, mat Kikimuseja, himmeä Afrikabrun, mat Afrika-brun, mat Африканско-коричневий, матовий Brqz alykañski, matowy Κορέ Αφρικης, ματ Africa kahverengisi, mat Afrikabarna, matt Africká hnědá, matná Afriskorjave, brez leska	50 % anthrazit, matt 9 anthracite grey, mat anthracit, mat antracite, mate antracite, fosco antracit, opaco antracit, mat antrasit, himmeä kicsgyä, mat antrasit, mat антрацит, матовый antracyt, matowy ανθρακίς, ματ antrasit, mat antracit, matná antracit, matt tamno siva, mat	50 % C eisen, metallic 91 steel, metallic coloris fer, métalique ijzerkleurig, metallic ferroso, metalizado ferro, metallico ferro, metallico järfrög, metallic leis-senwäitren, metallikilto jen, metallik jezi, metallic сталний, металлик želazo, metaliczny ođbrun, metaliko demir, metalik železnä, metaliza vas, metalli železna, metalik	D messing, metallic 92 brass, metallic laiton, métalique messing, metallic plata, metalizado latão, metallico ottone, metallico näsning, metallic messini, metallikilto messing, metallik messing, metallic латунний, металлик mosiqdz, metaliczny ορείχολκου, μεταλλικό püring, metalik mosazná, metaliza sárgaréz, metalli mesing, metalik	E silber, metallic 90 silver, metallic argent, métalique zilver, metallic plata, metalizado prata, metalico argento, metallico silver, metallic hõpna, metallikilto sølv, metallik sølv, metallic сребористий, металлик srebro, metaliczny σημπρι, μεταλλικό gümüş, metalik stifbrnä, metaliza ezüst, metalli srebrna, metalik	F rosi, matt 83 rust, matt rouille, mat roest, mat roestgen, fosco color ruggine, opaco rost, matt rusela, himmeä rust, mat rust, matt ржавчина, матовий rdzawy, matowy χρωμ ακουριός, ματ pas rengi, mat rozavä, matná rozsedä, matt rjave, mat	G eisen, metallic 91 steel, metallic coloris fer, métalique ijzerkleurig, metallic ferroso, metalizado ferro, metallico ferro, metallico järfrög, metallic leis-senwäitren, metallikilto jen, metallik jezi, metallic сталний, металлик želazo, metaliczny ođbrun, metaliko demir, metalik železnä, metaliza vas, metalli železna, metalik	
H feuerrot, glänzend 31 fiery red, gloss rouge feu, brillant rood helder, glanzend rojo fuego, brillante vennetto vivo, brillant rosso fuoco, lucente elhdä, blank tulikasainen, kiiltävä ilhdä, skinnende ilhdä, blank огненк-хркий, блестящий szereowy ognisty, blyszczący κόκκινο φωτιός, υαλιστερό aleg kirmizis, parlak ohné červenä, lesklä tüzpiros, fényes cyañ rdca, bleskajoča	I braun, matt 85 brown, matt bun, mat brun, mat marón, mate castanho, fosco marone, opaco bun, mat ruska, himmeä bun, mat bun, mat коричневий, матовий brązowy, matowy κορέ, ματ kahverengi, mat hnědá, matná barna, matt rjave, mat	J steingrau, matt 75 stone grey, matt gris pierre, mat steengrijs, mat gris pizarra, mate cvarnilo pldra, fosco grigio roccia, opaco stengri, mat kivenharma, himmeä stengri, mat ste ngri, mat серый каменистый, матовый szary kamien-, matowy γκρι πέτρας, ματ lag gris, mat kamenné šedä, matná köszürke, matt kamen siva, mat						

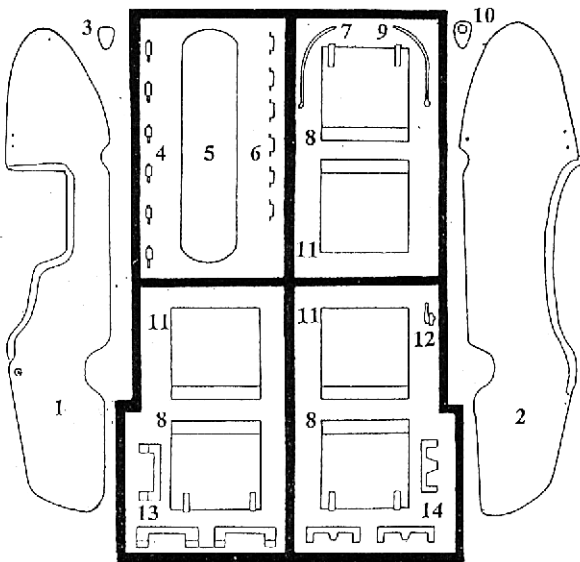

Nicht benötigte Teile
 Parts not used
 Pièces non utilisées
 Não necessários
 Não utilizados
 Parts not used
 Teile anwinda delar
 Тапетліонал осал
 Ikke nødvendige dele
 Deler som ikke er nødvendige
 Elementy niepotrzebne
 μη χρειαζόμενα εξαρτήματα
 Gerekli parçalar
 Nepotrebni díly
 Fel nem használt alkatrészek
 Nepotrebni deli

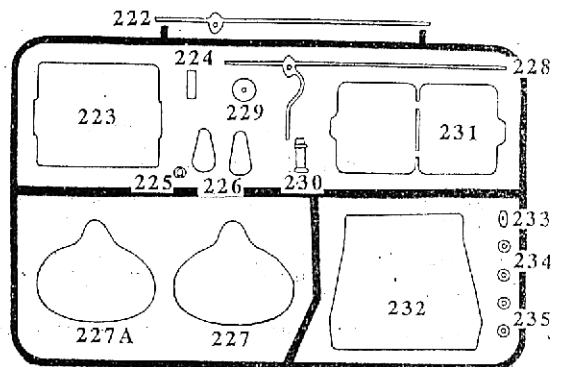
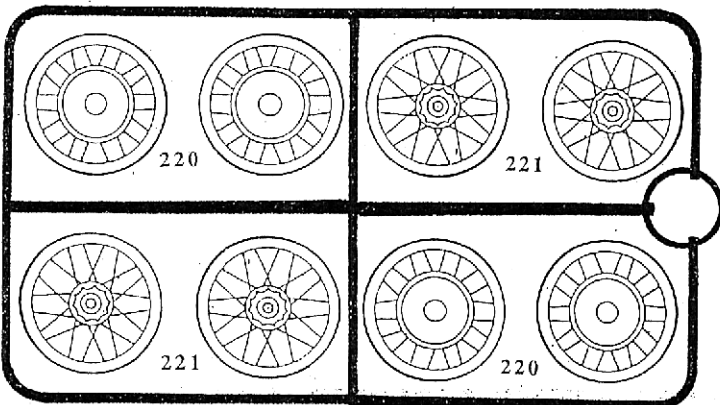
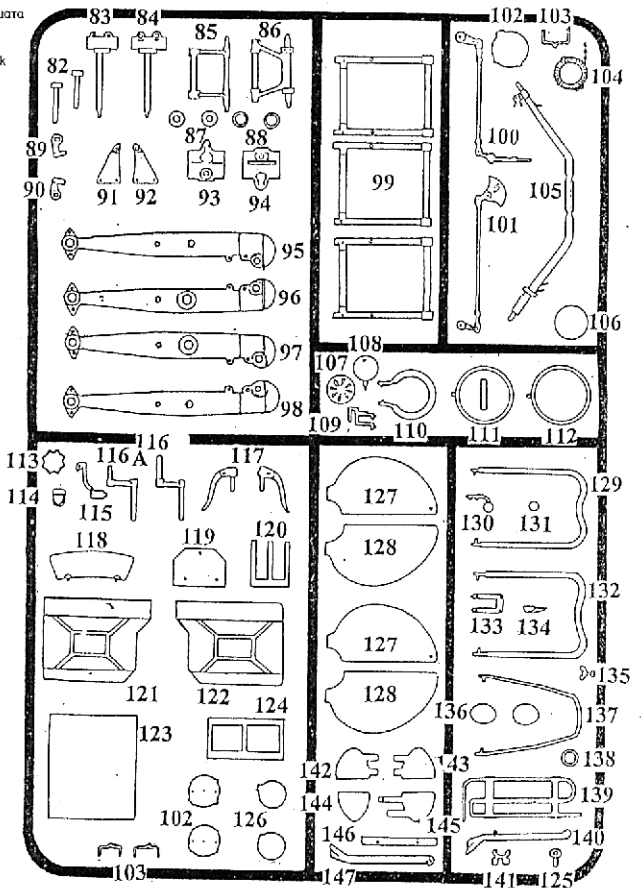
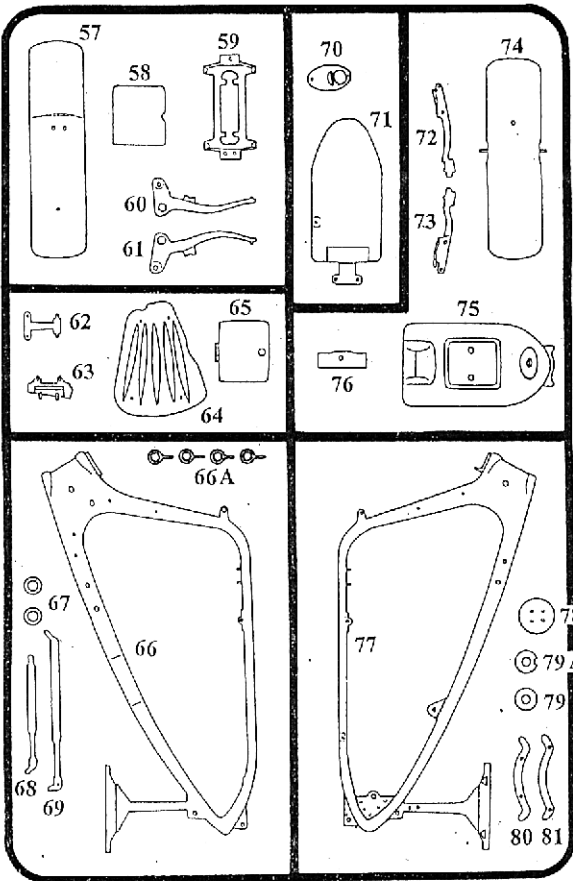
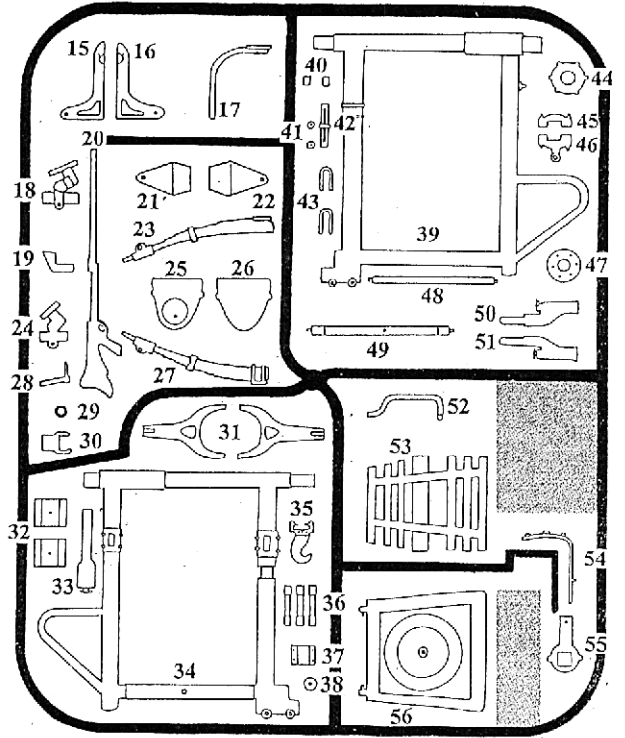

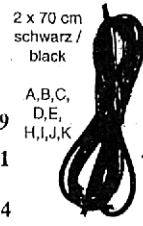
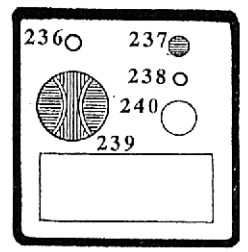
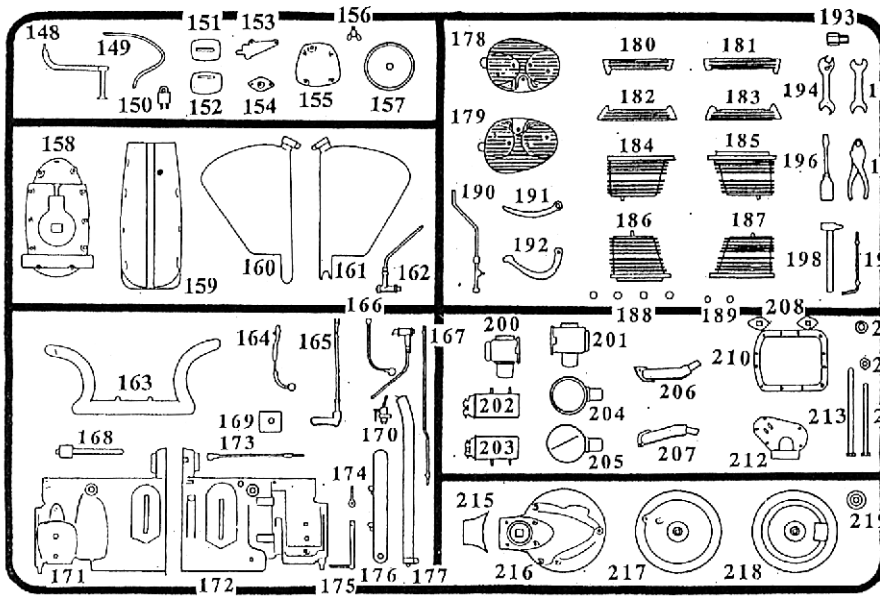

A,B,C,
D,E,
H,I,J,K

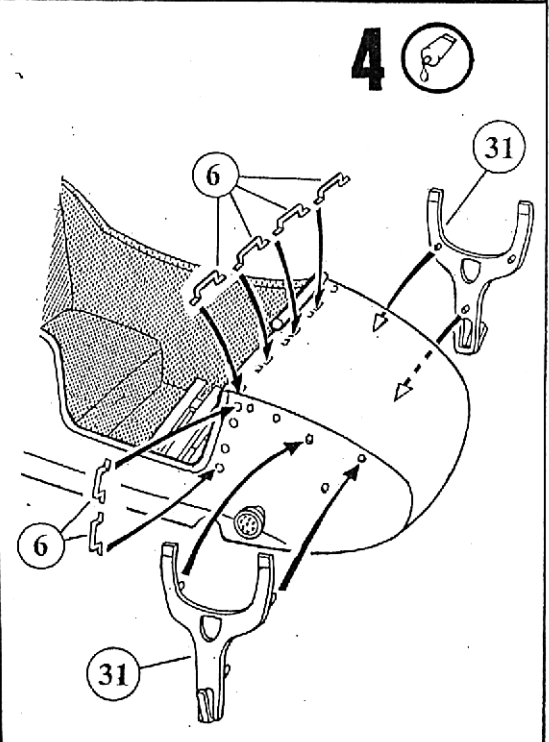
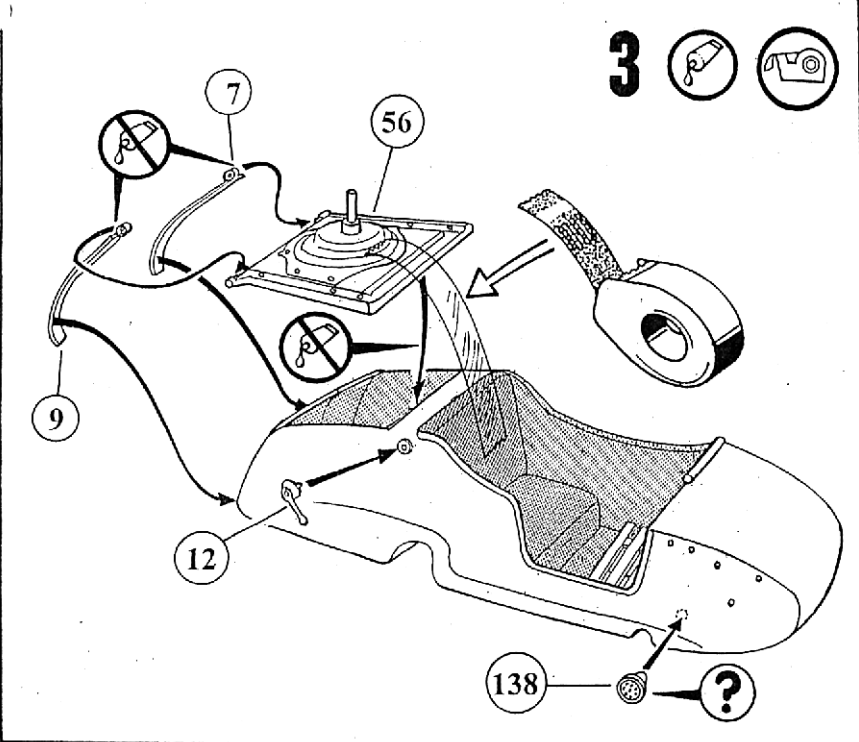
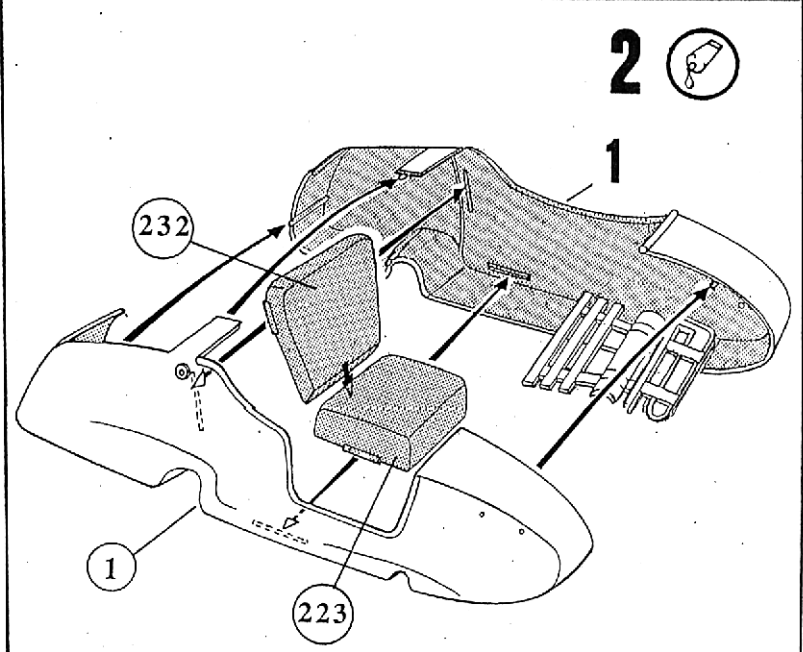
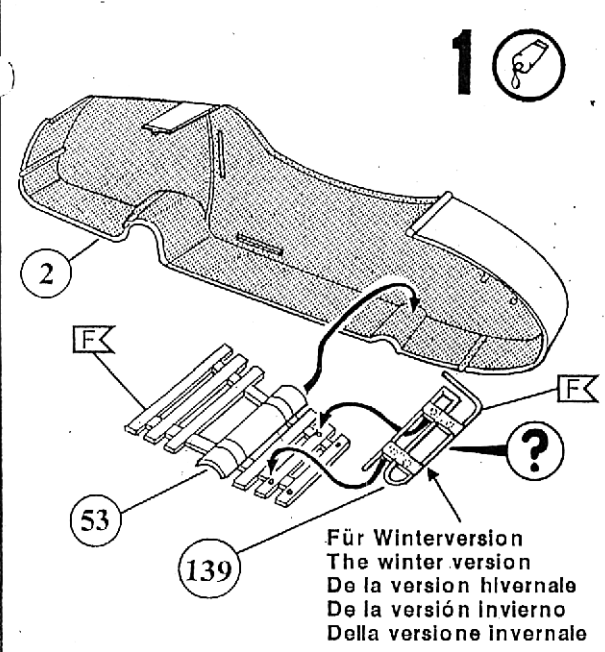
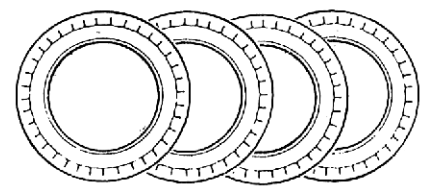
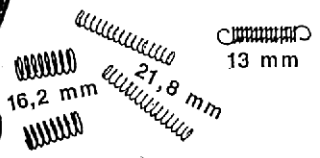

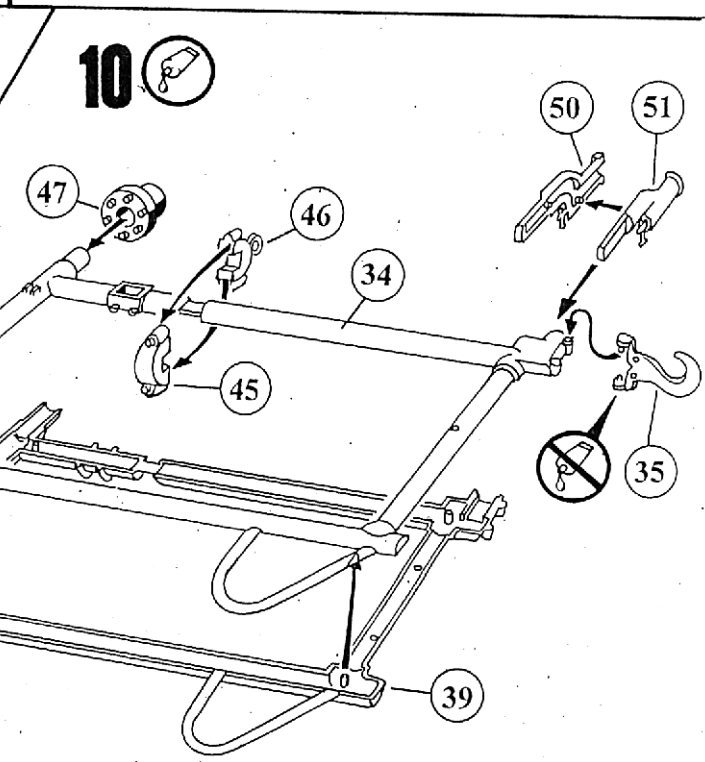
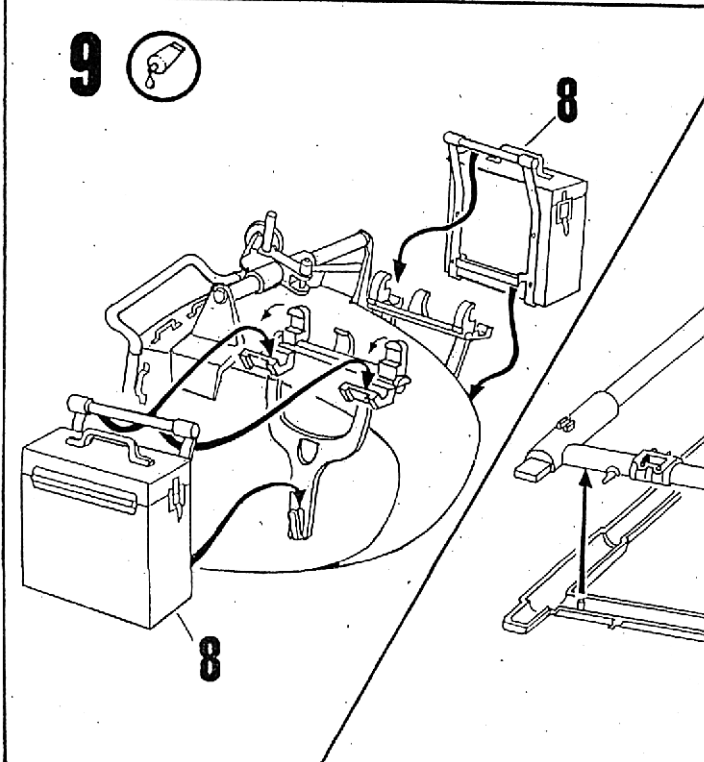
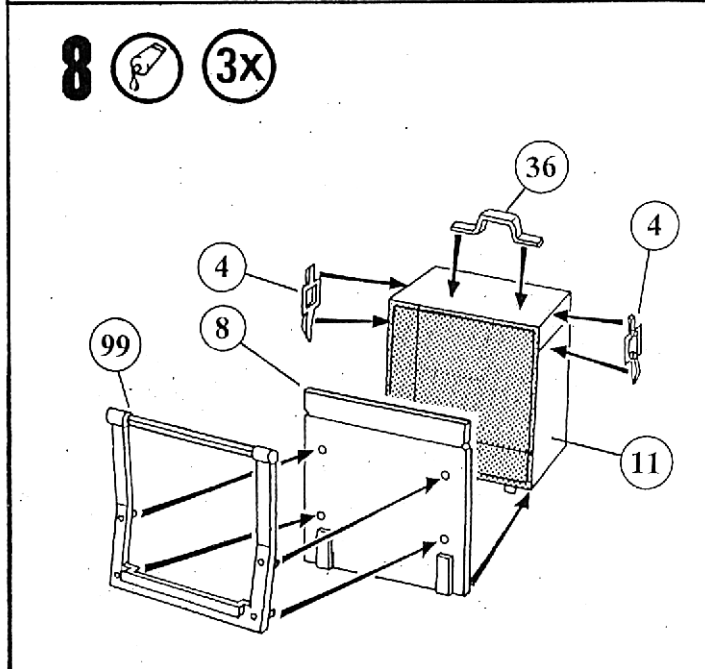
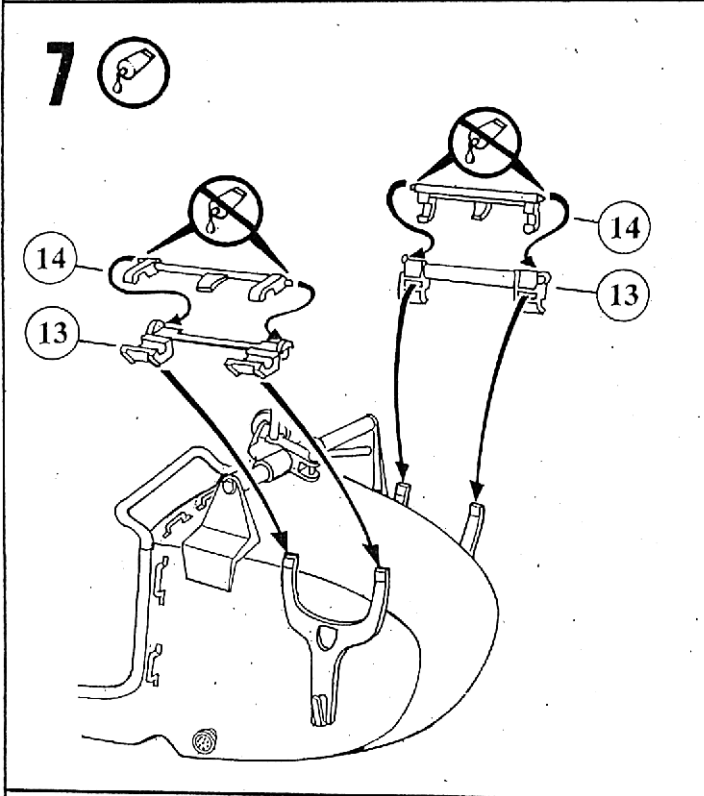
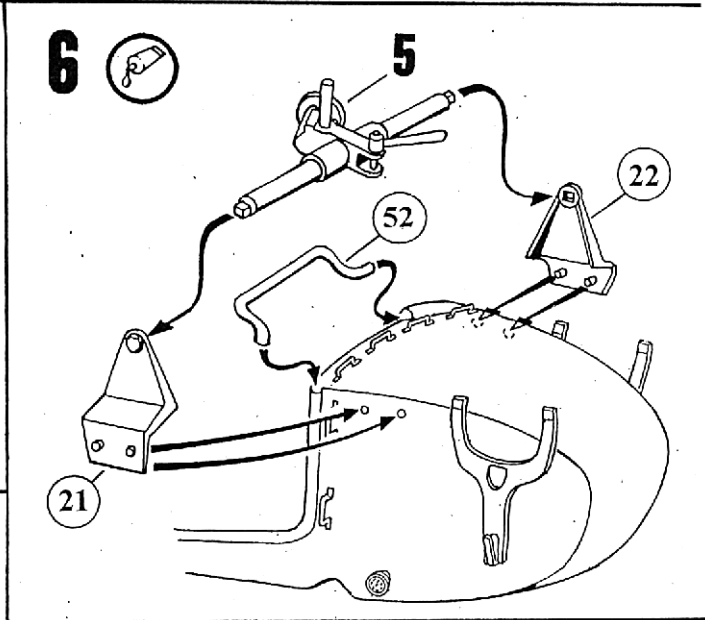
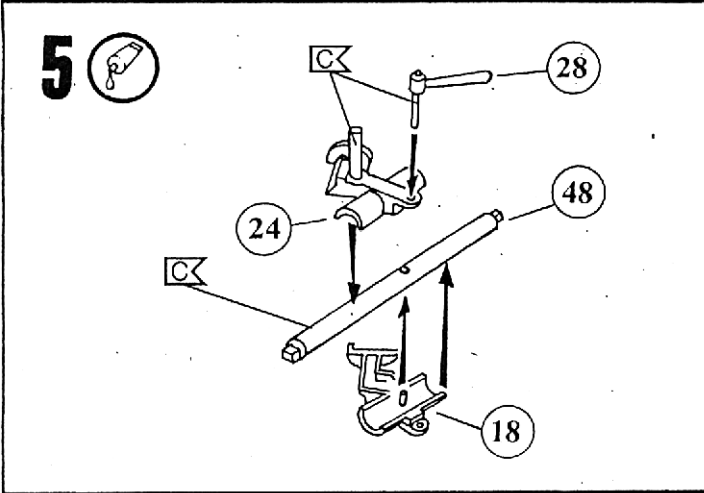

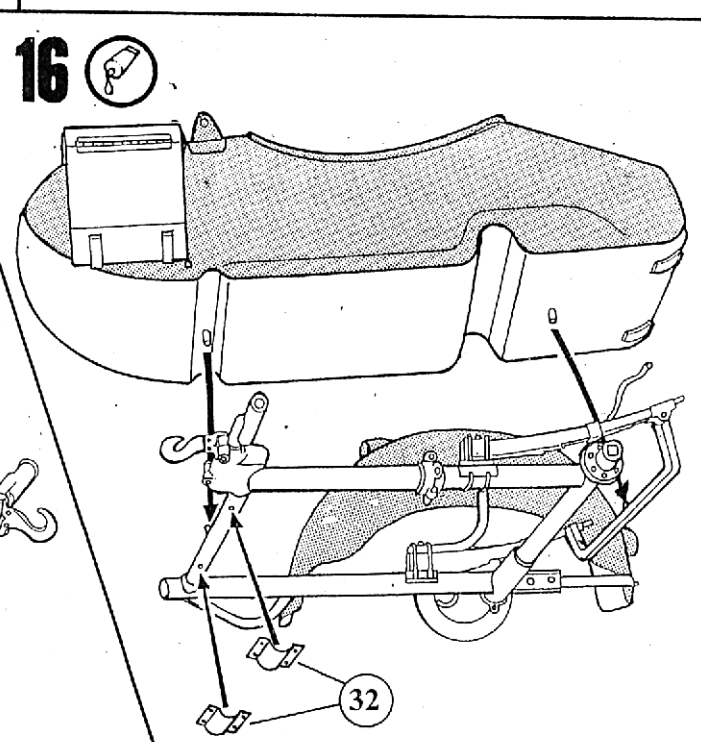
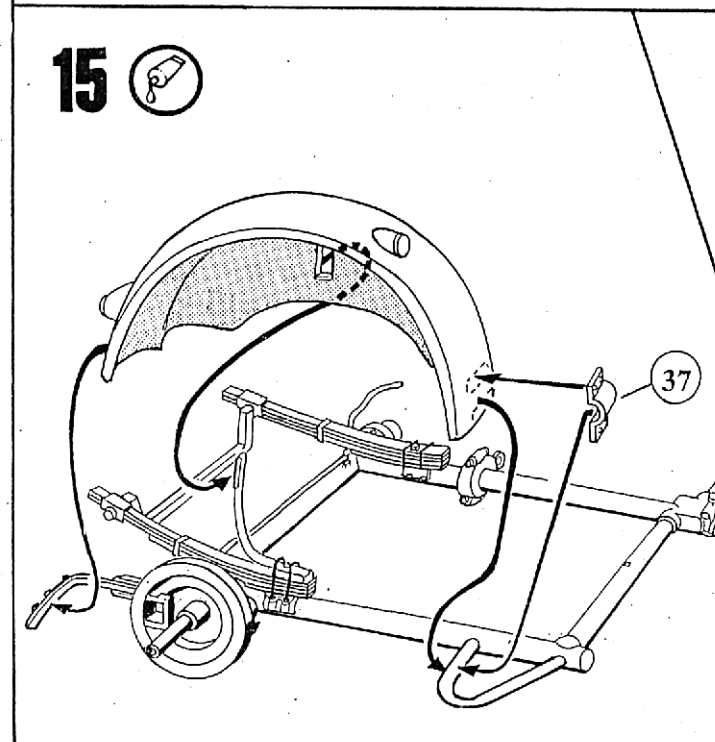
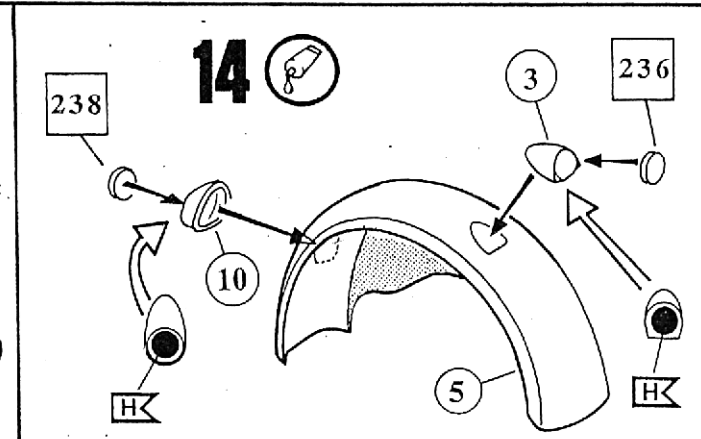
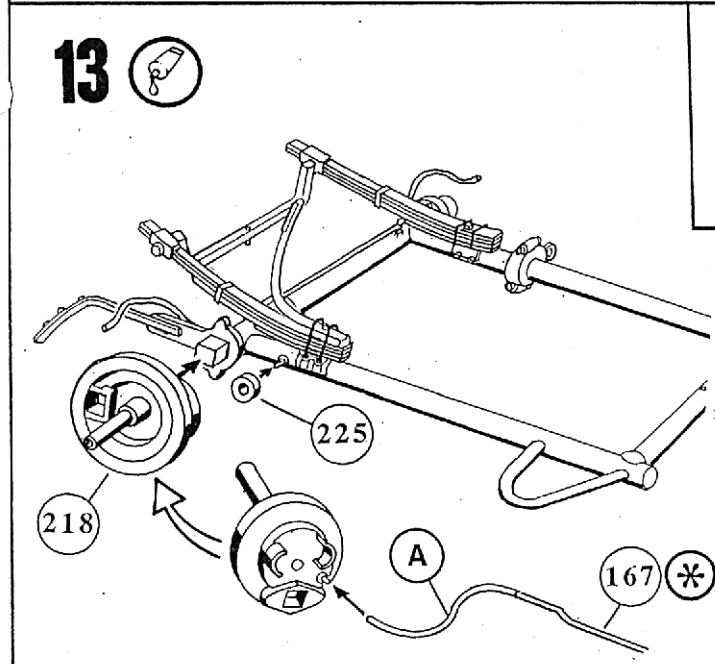
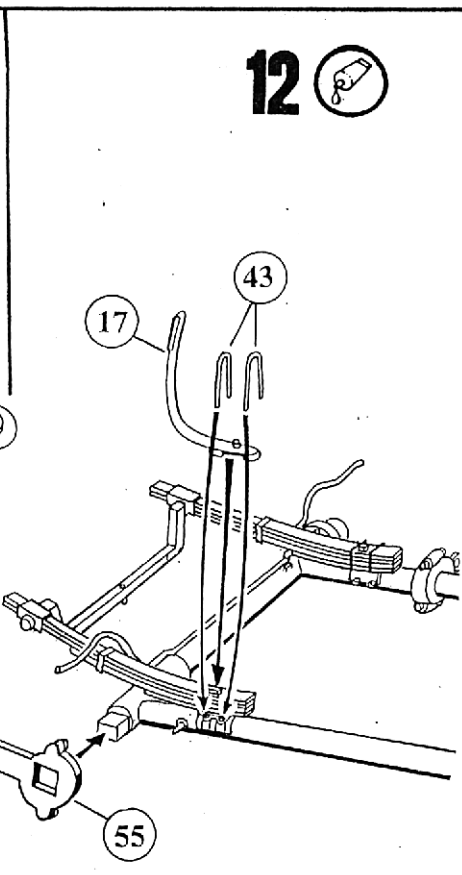
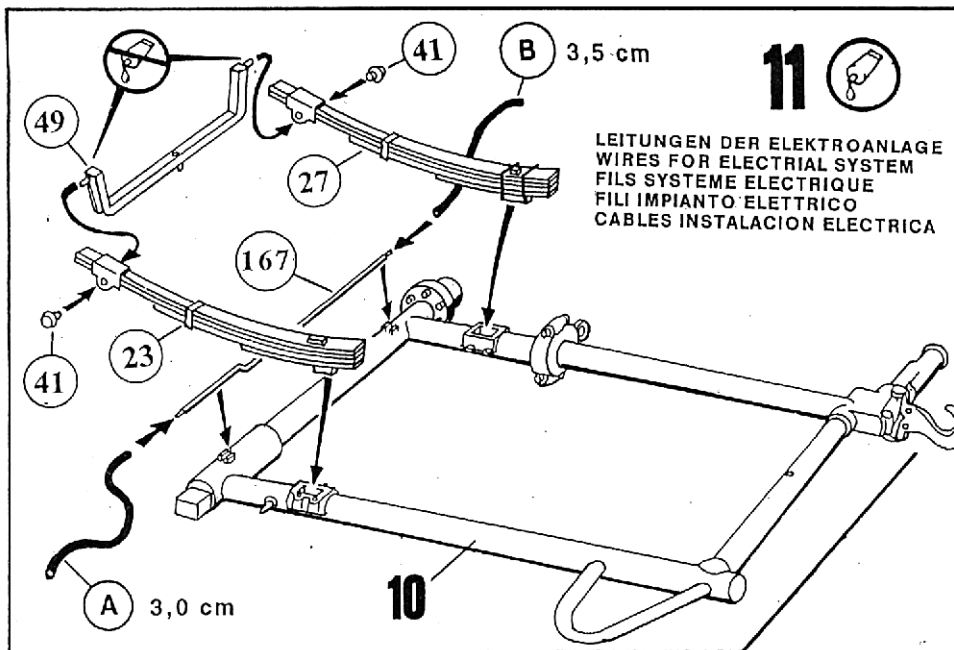

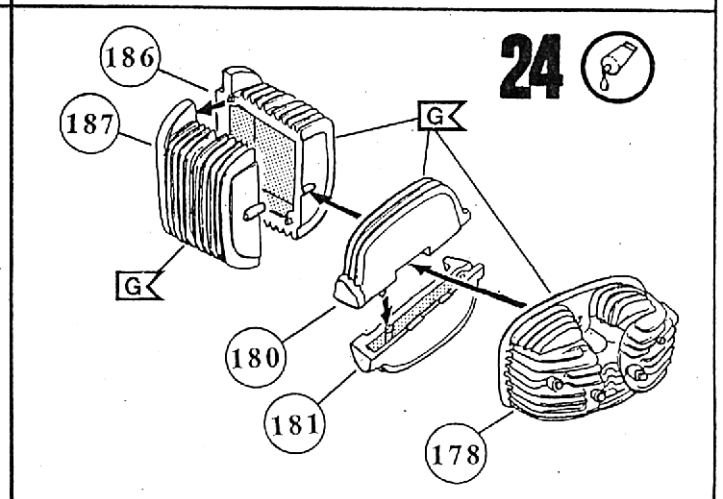
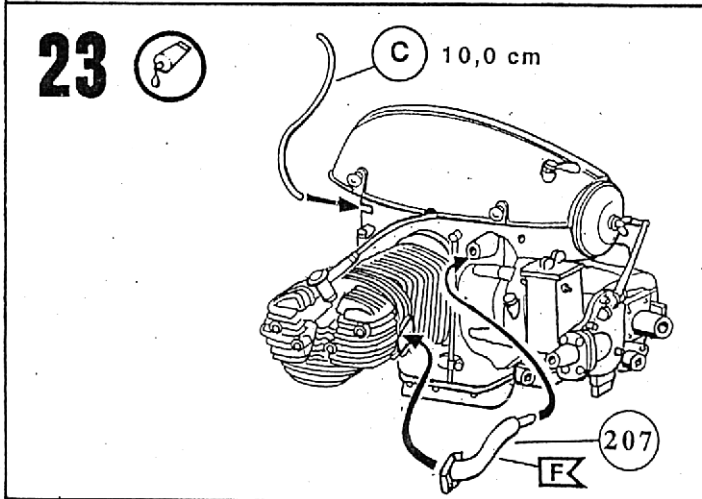
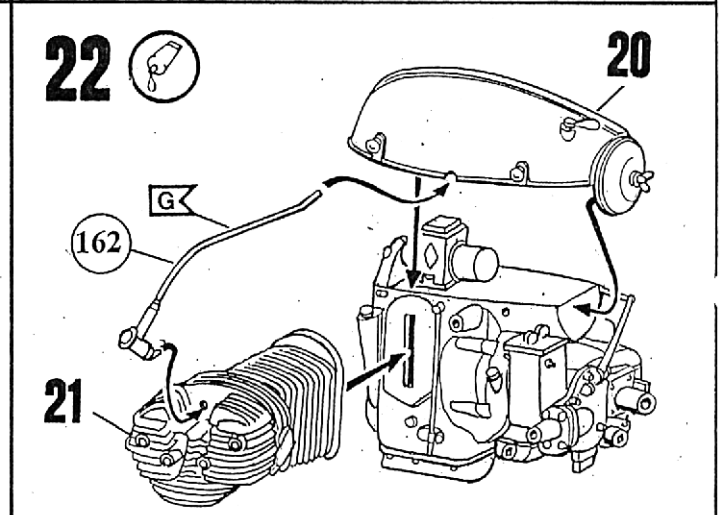
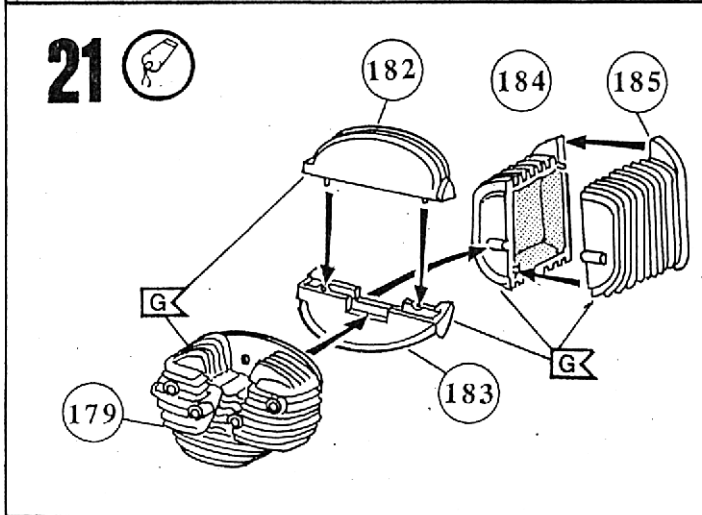
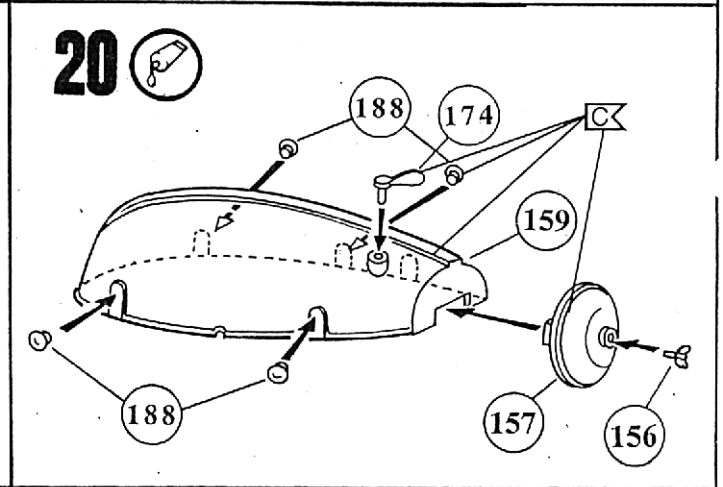
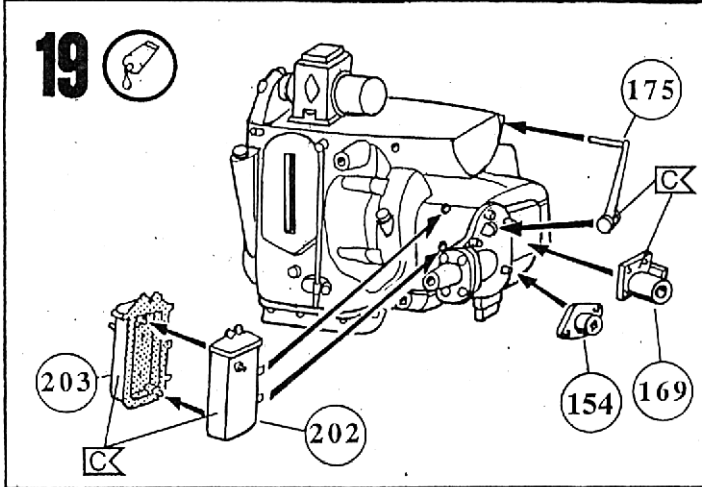
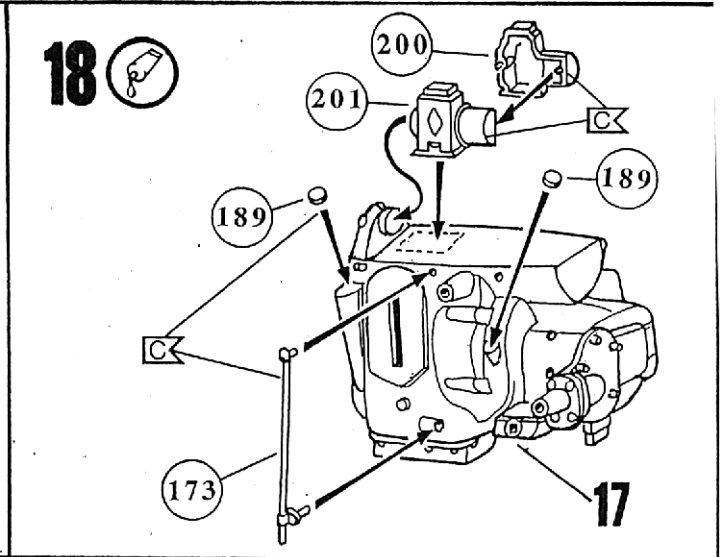
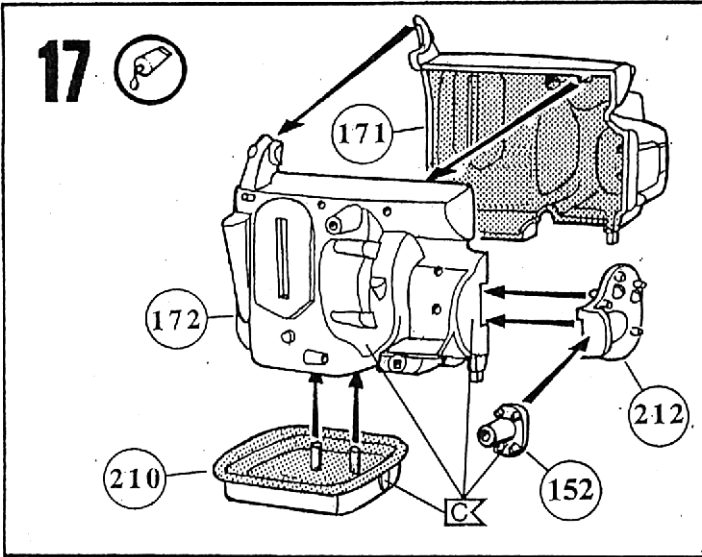

25

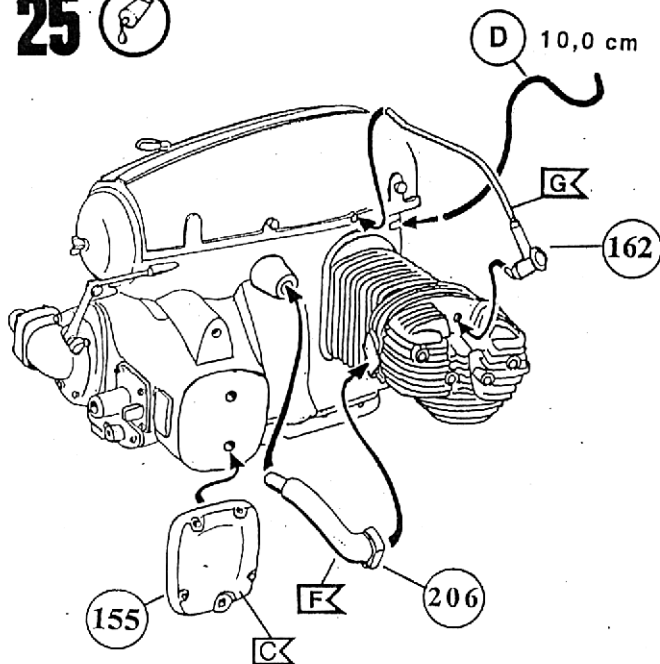

26

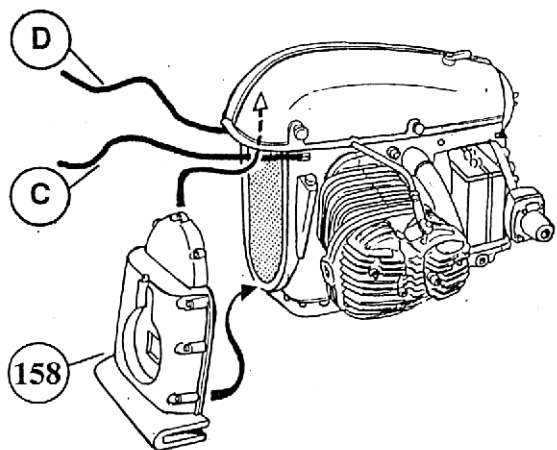

27

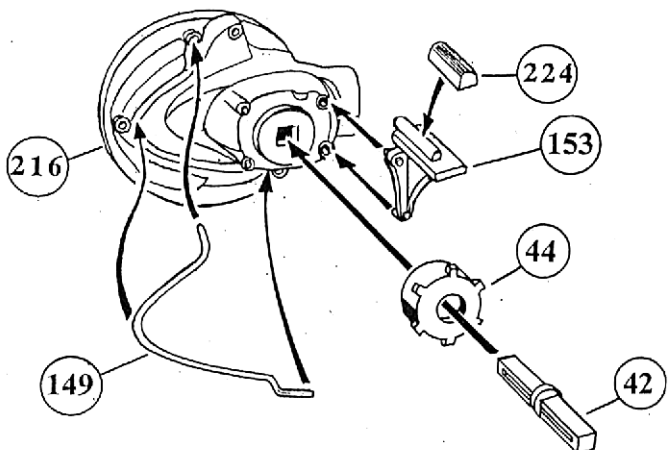

28

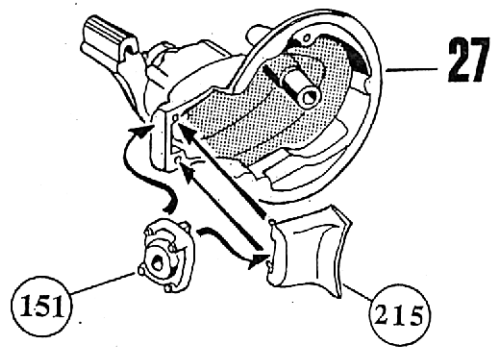

29

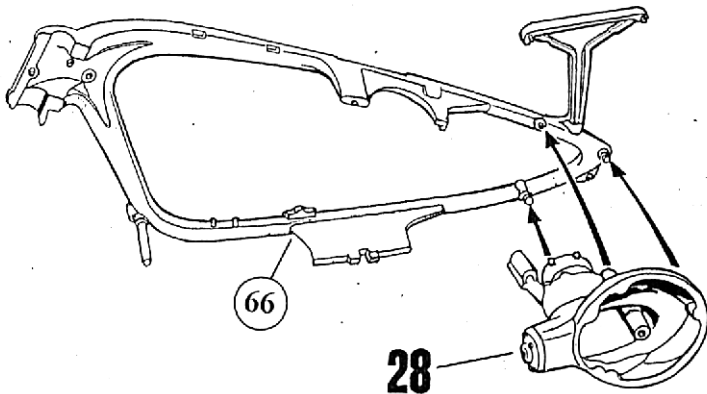

30



4x

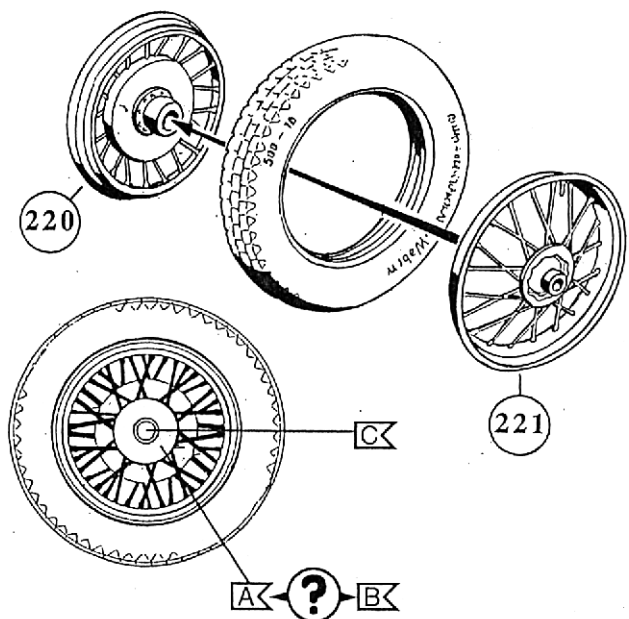

Die Speichen der Räder müssen versetzt eingebaut werden
 The spokes must be not alligned
 Les rayons ne doivent pas etre alignes entre eux
 I raggi devono risultare sfalsati e non allineati tra di loro
 Cuidar que los rayos no esten alienados entre si

31

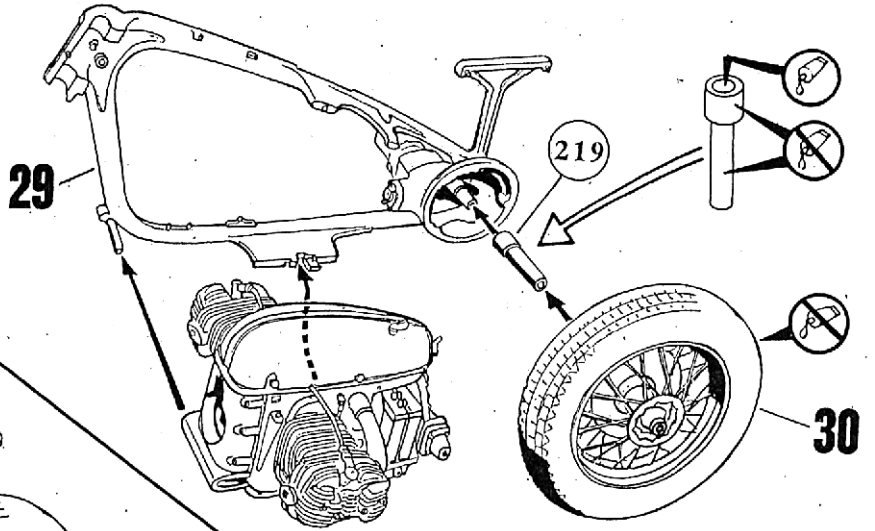

32

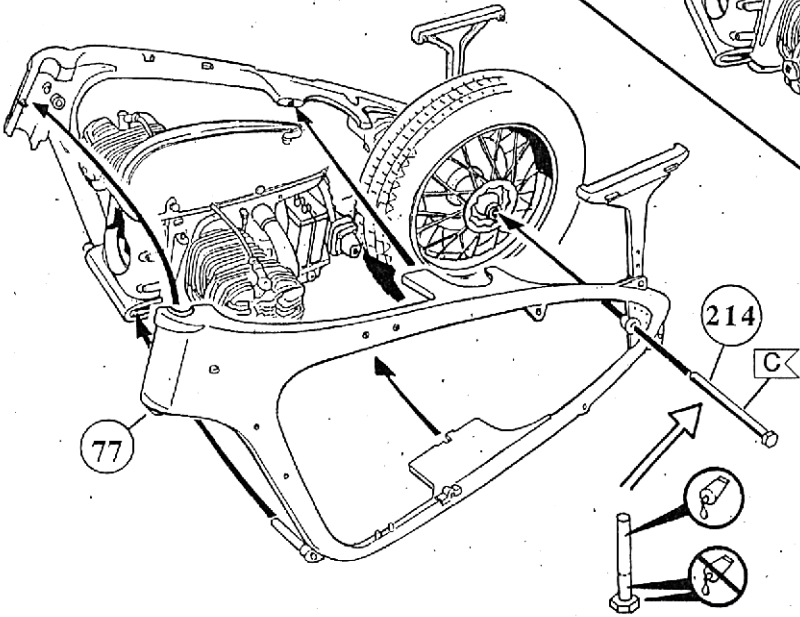

33

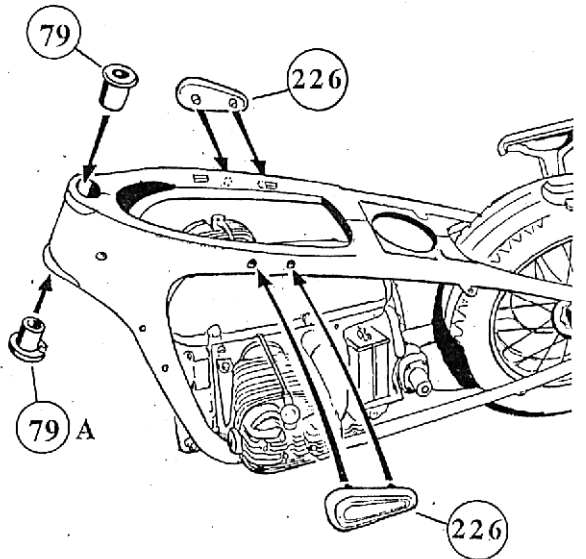

34

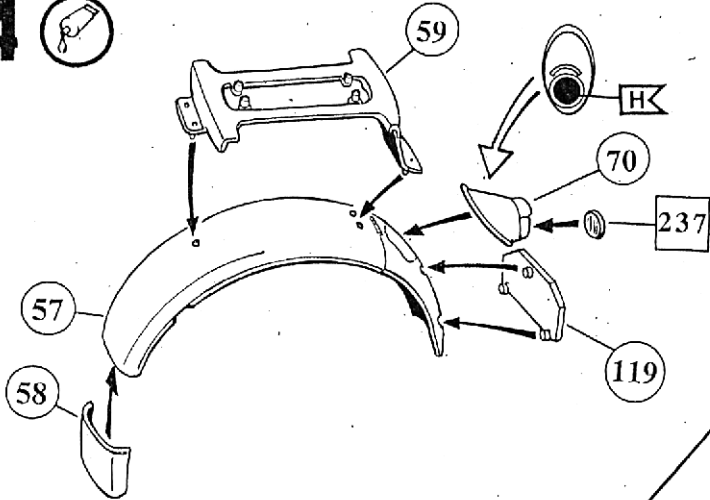

35

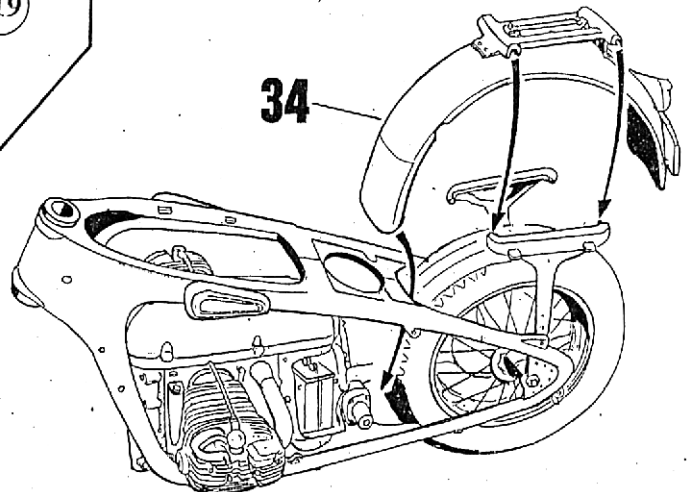

36

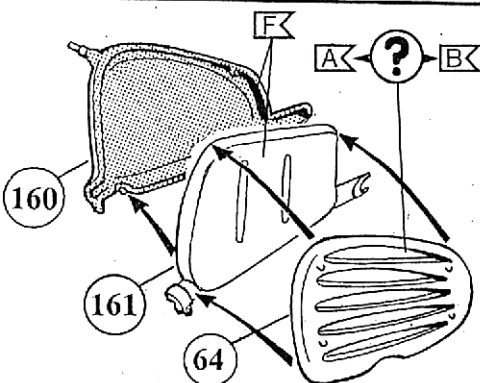

37

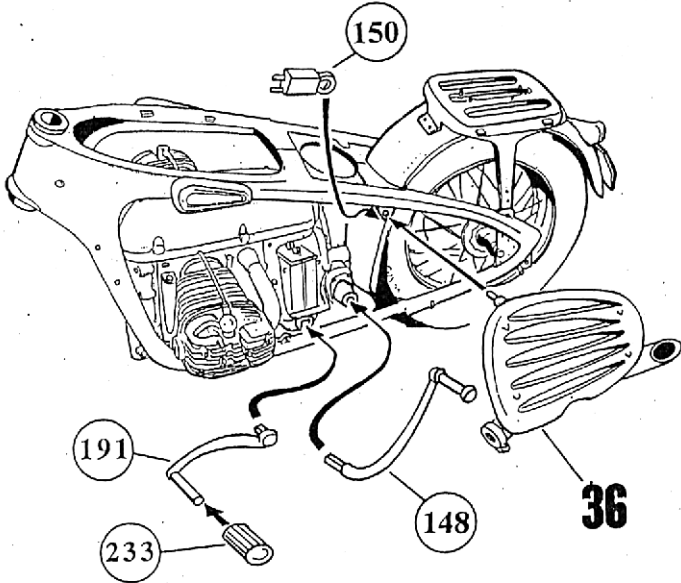

38



LEITUNGEN DER ELEKTROANLAGE
 WIRES FOR ELECTRICAL SYSTEM
 FILS SYSTEME ELECTRIQUE
 FILI IMPIANTO ELETTRICO
 CABLES INSTALACION ELECTRICA

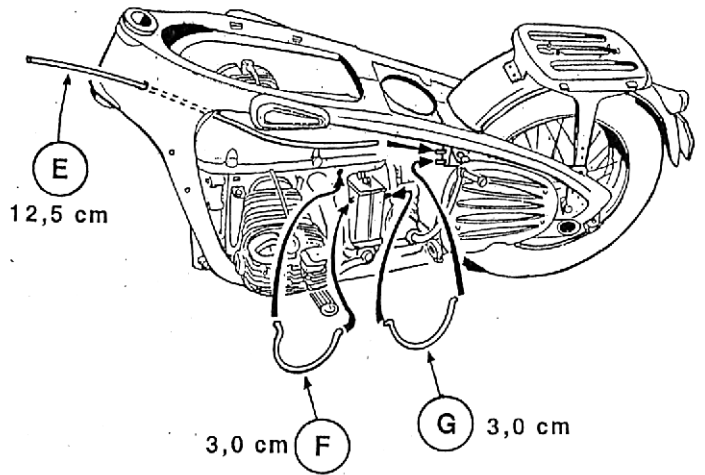

39



LEITUNGEN DER ELEKTROANLAGE
 WIRES FOR ELECTRICAL SYSTEM
 FILS SYSTEME ELECTRIQUE
 FILI IMPIANTO ELETTRICO
 CABLES INSTALACION ELECTRICA

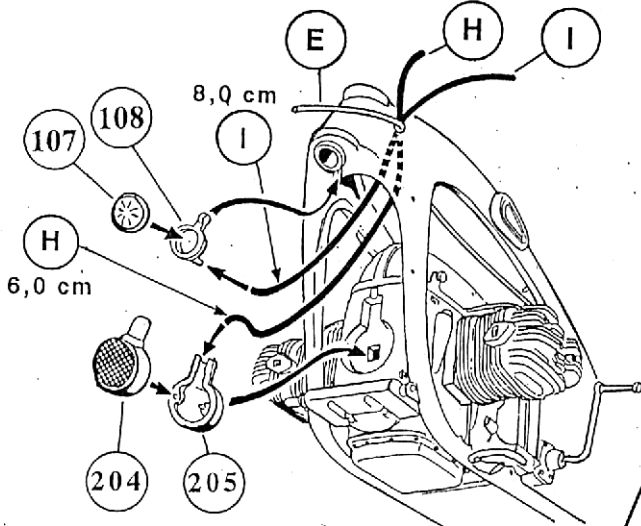

40

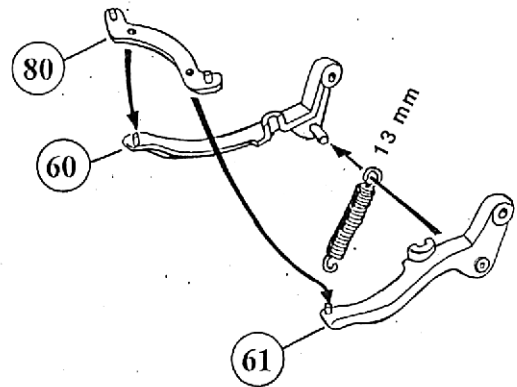

41

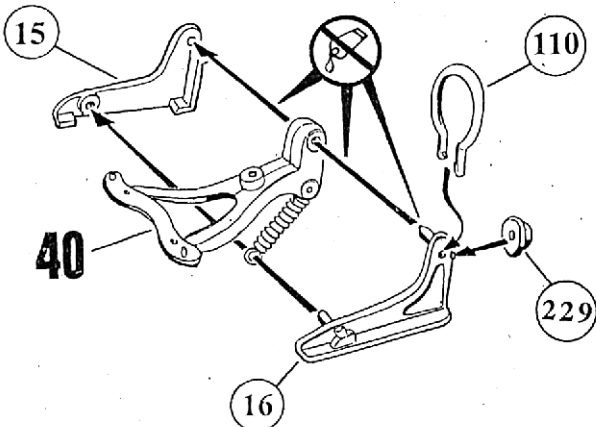

42

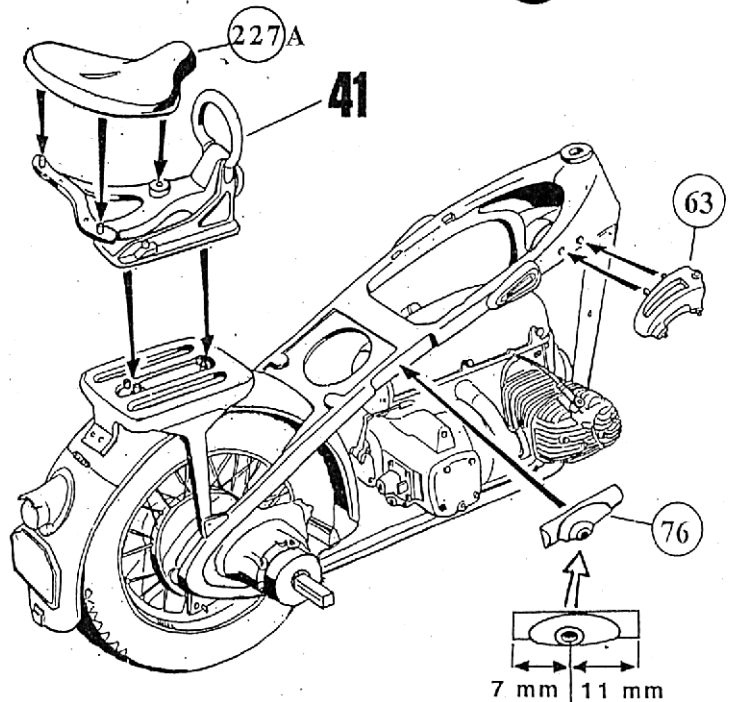

43

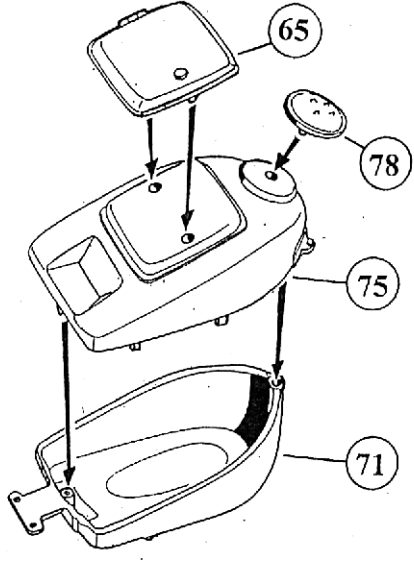

44

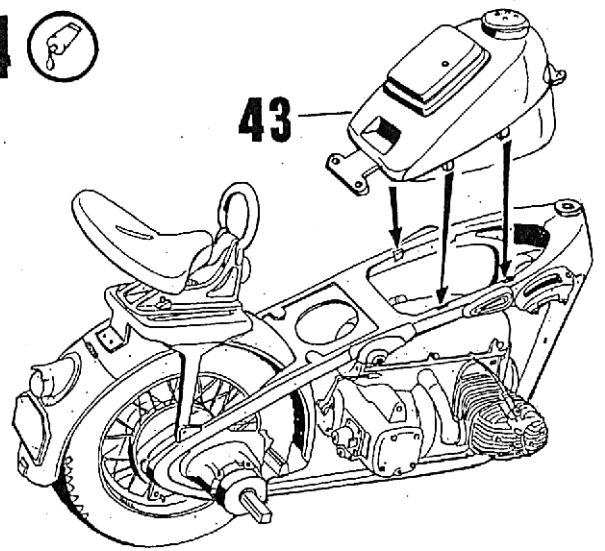

45

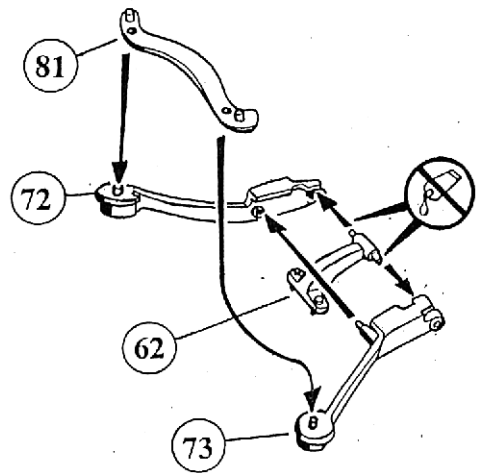

46

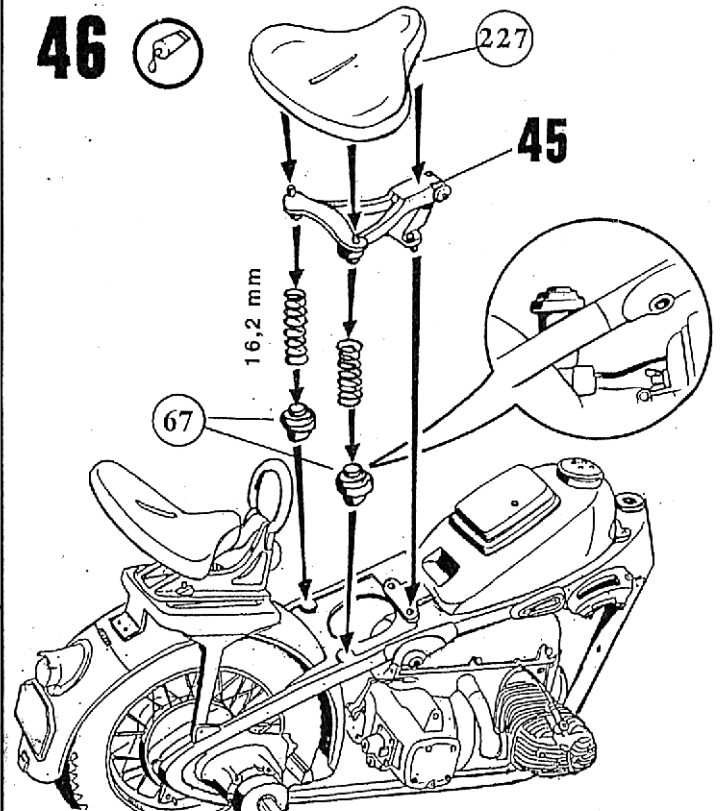

47

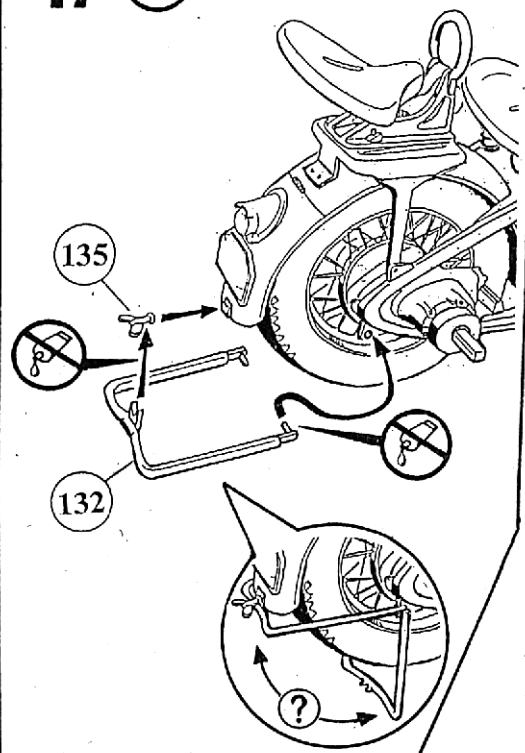

Für Winterversion
The winter version
De la version hivernale
De la version hiverno
Della versione invernale

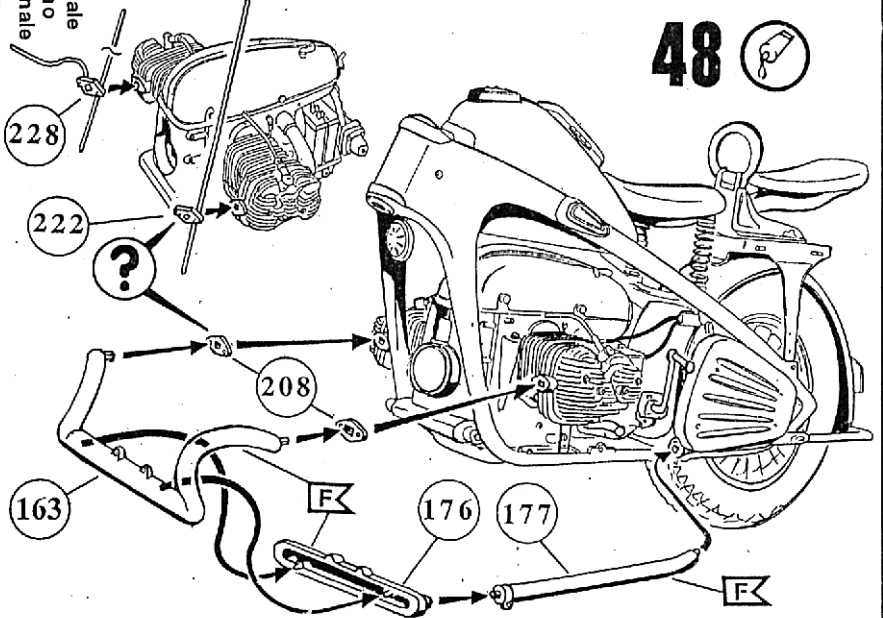

48



49

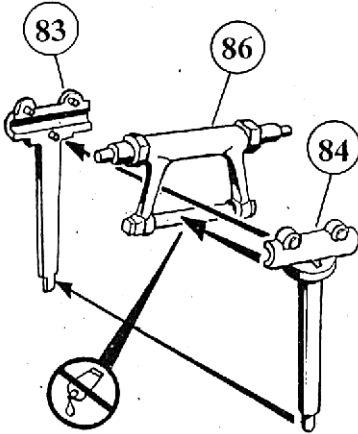

50

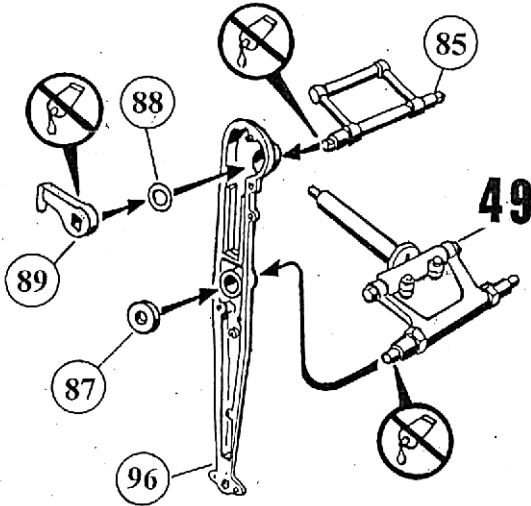

51

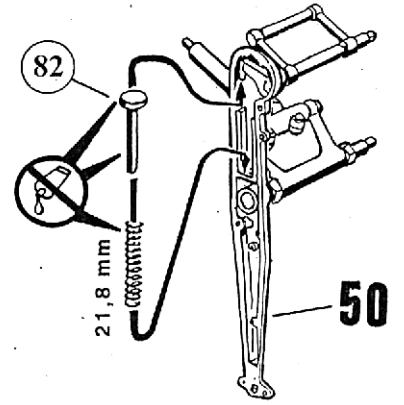

52

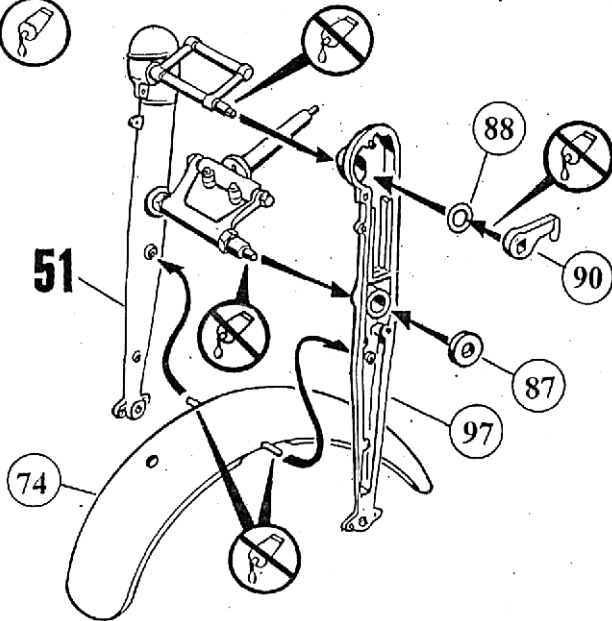

53

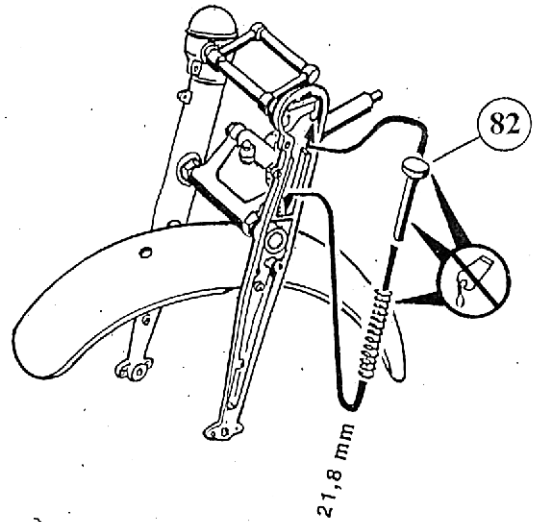

54

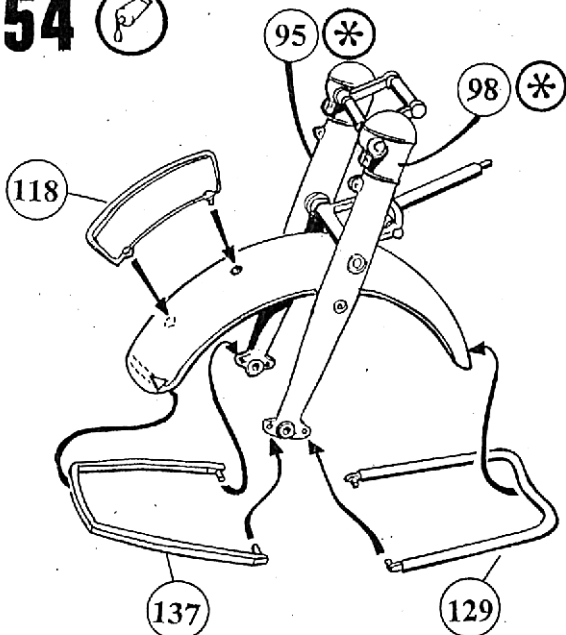

55

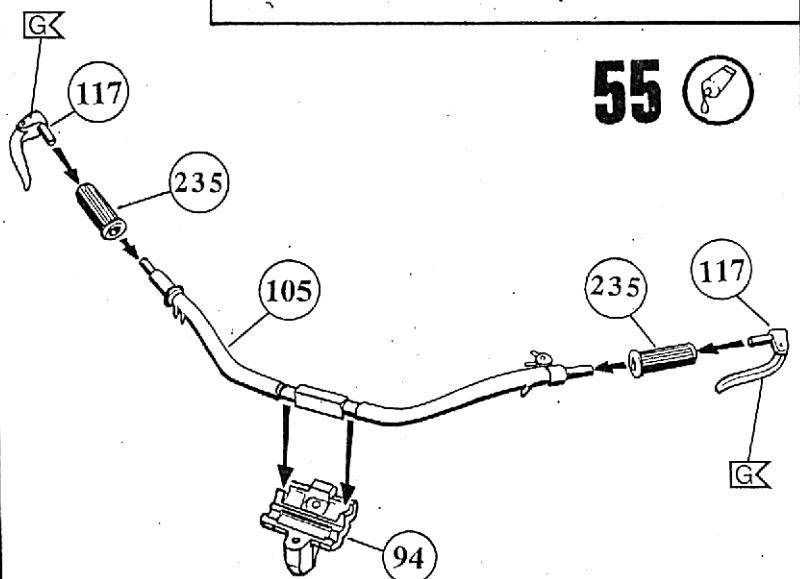

56

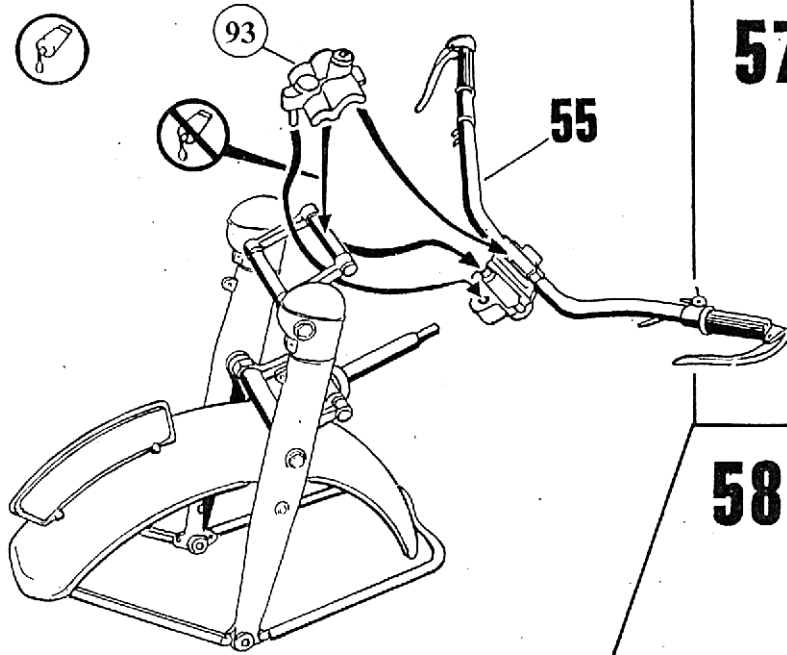

57

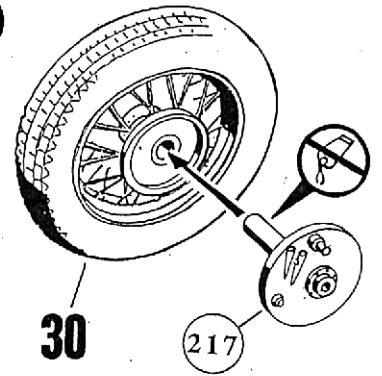

58

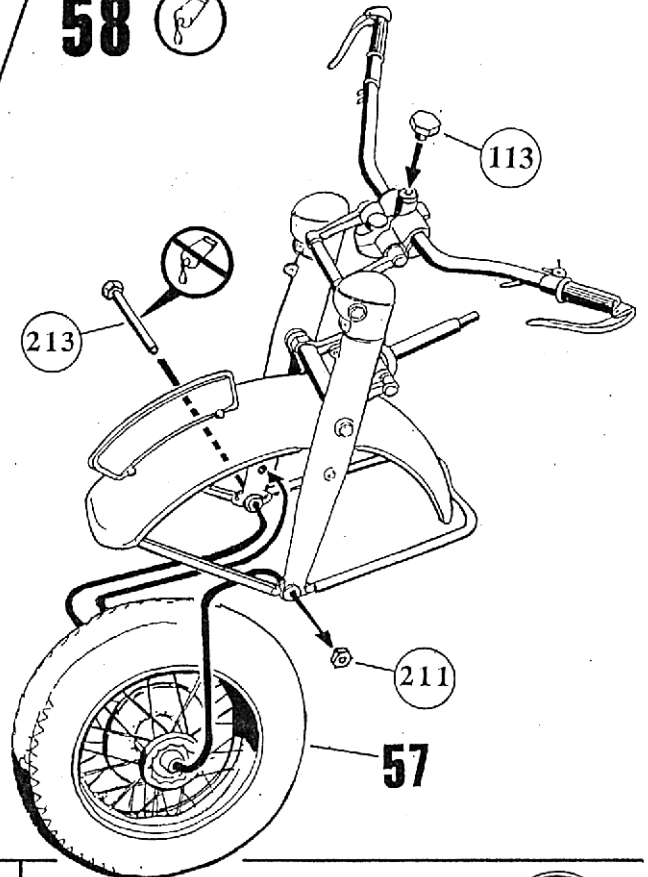

59

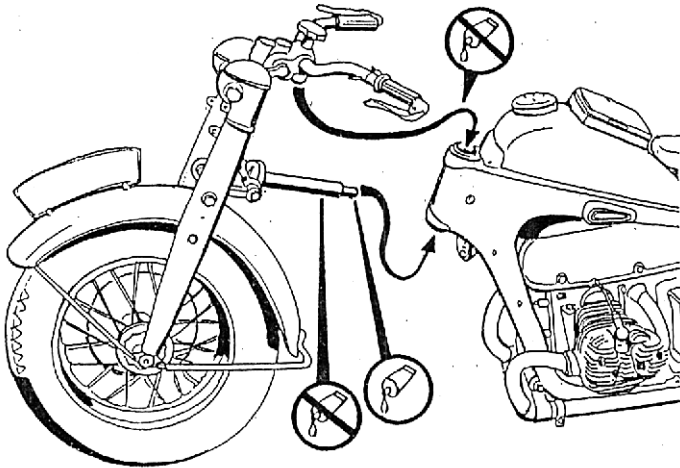

60

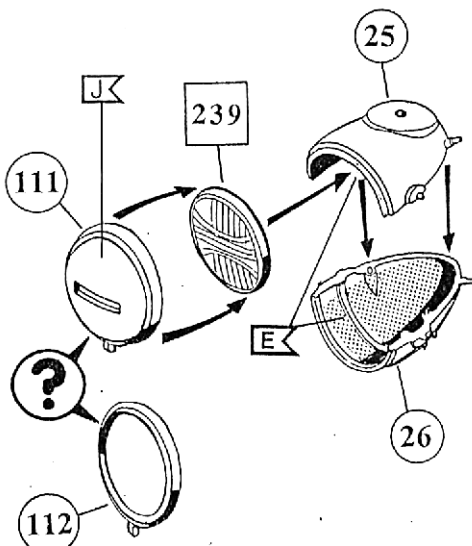

61

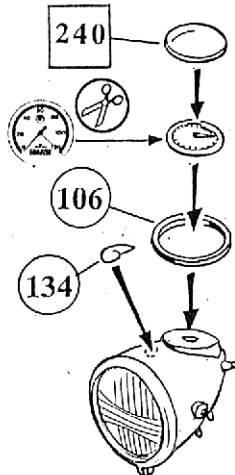

62

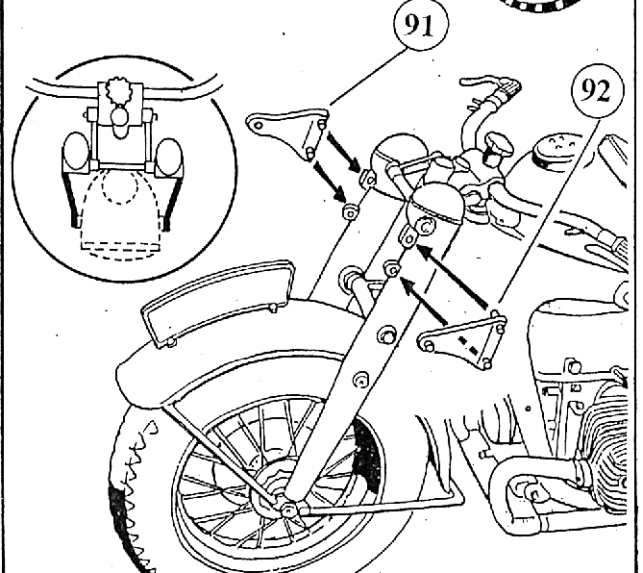

63



LEITUNGEN DER ELEKTROANLAGE
WIRES FOR ELECTRICAL SYSTEM
FILS SYSTEME ELECTRIQUE
FILI IMPIANTO ELETTRICO
CABLES INSTALACION ELECTRICA

64

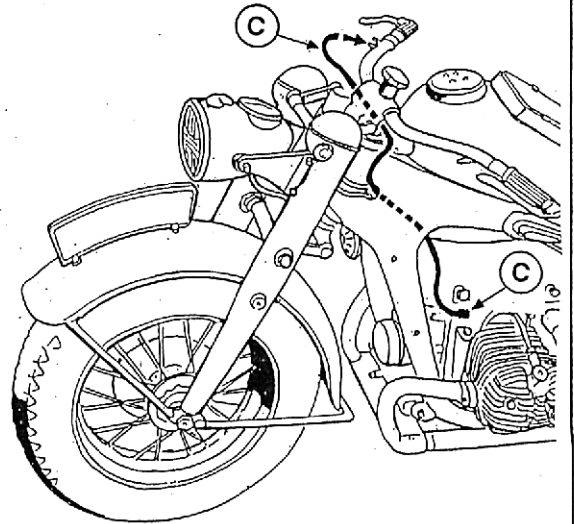
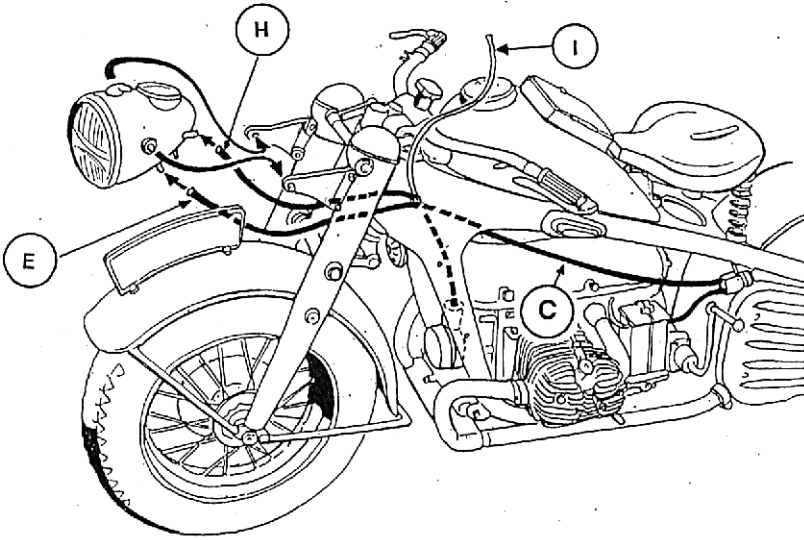

65

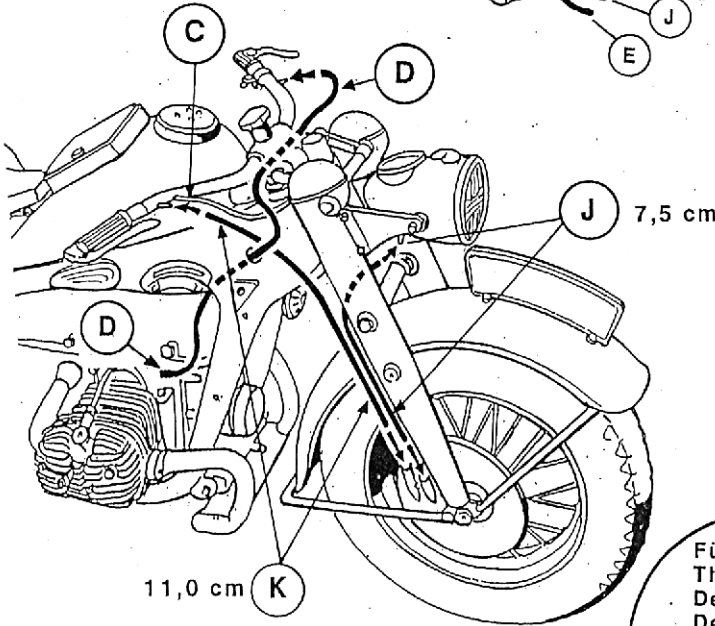
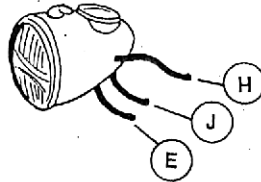

66

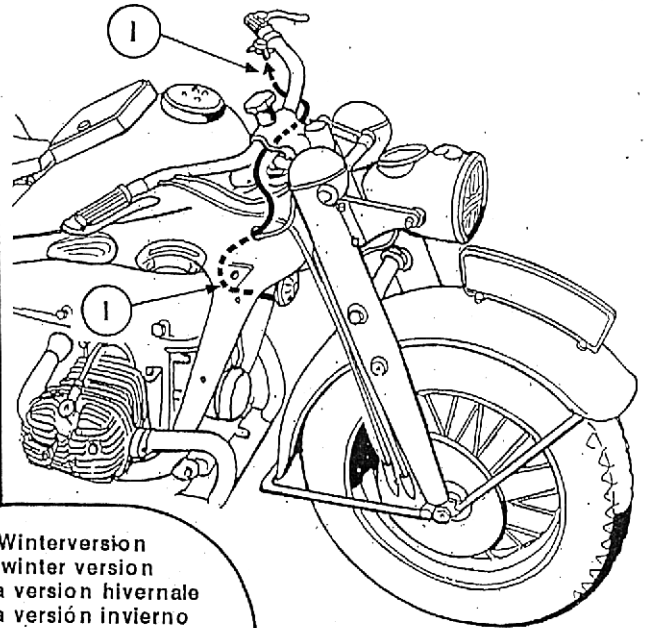

Für Winterversion
The winter version
De la versión hivernal
De la versión invierno
Della versione invernale

67

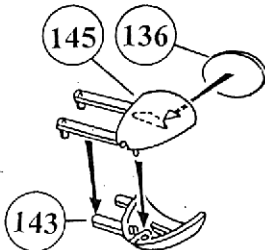

69

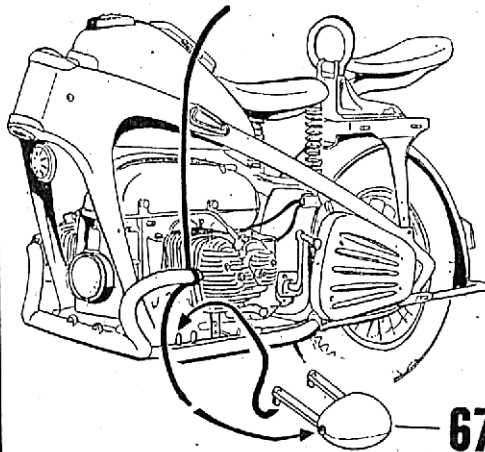

70

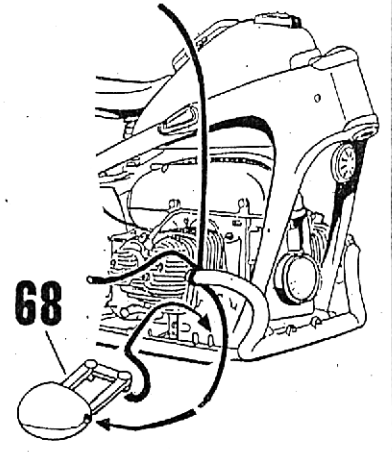

68

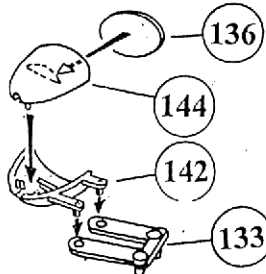

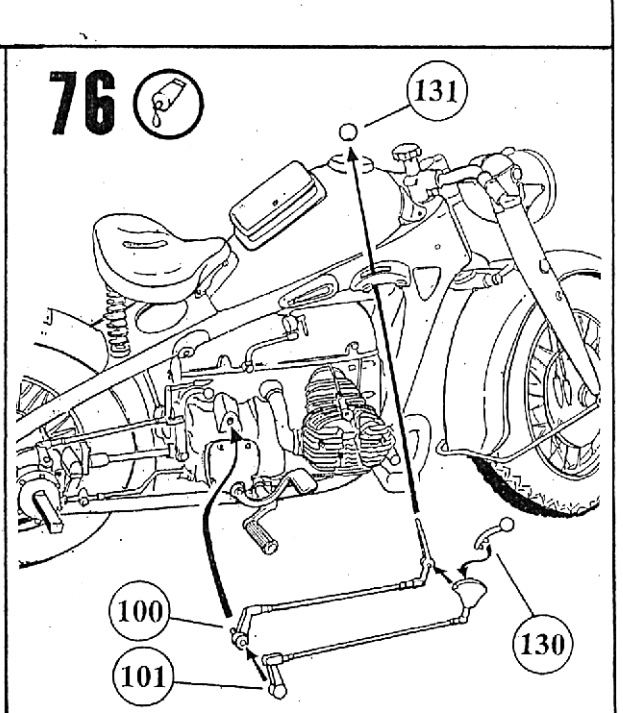
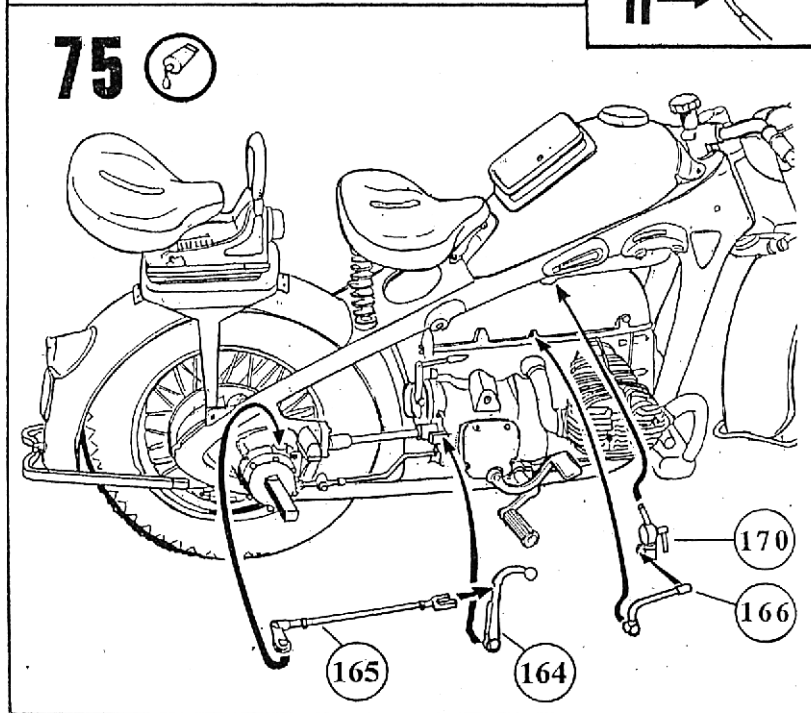
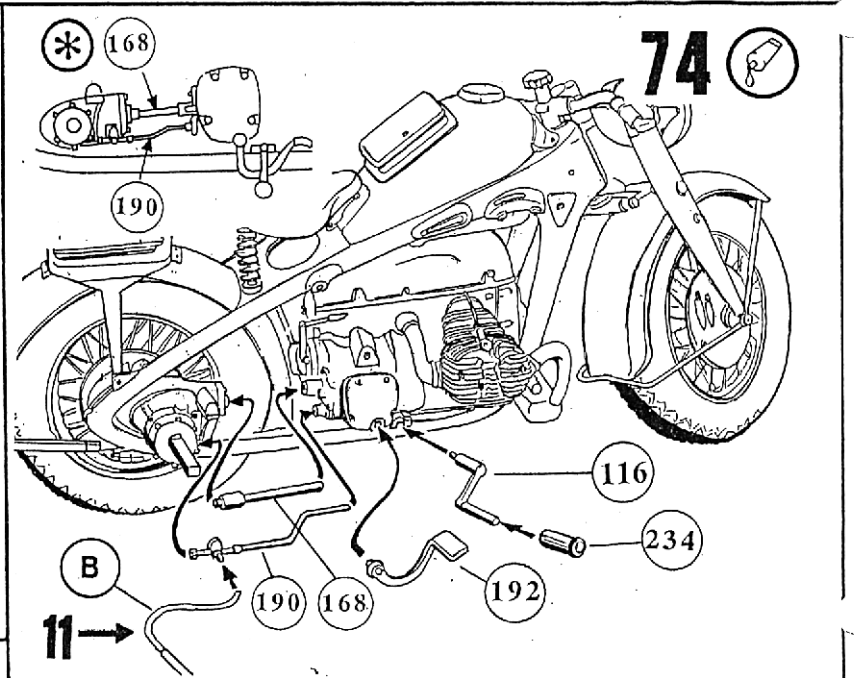
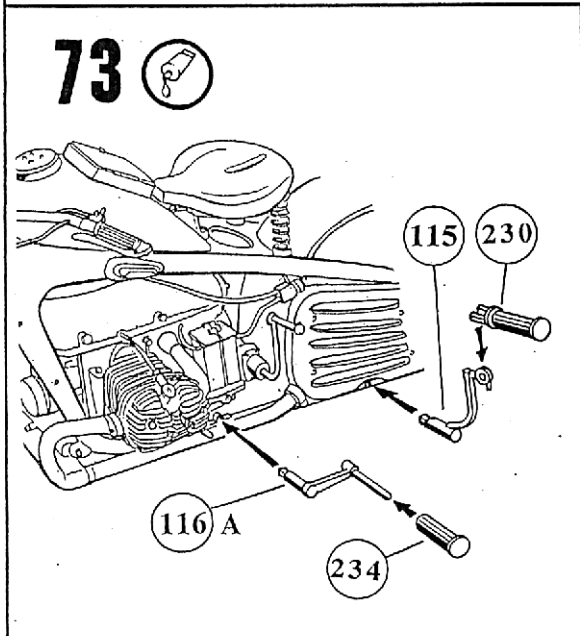
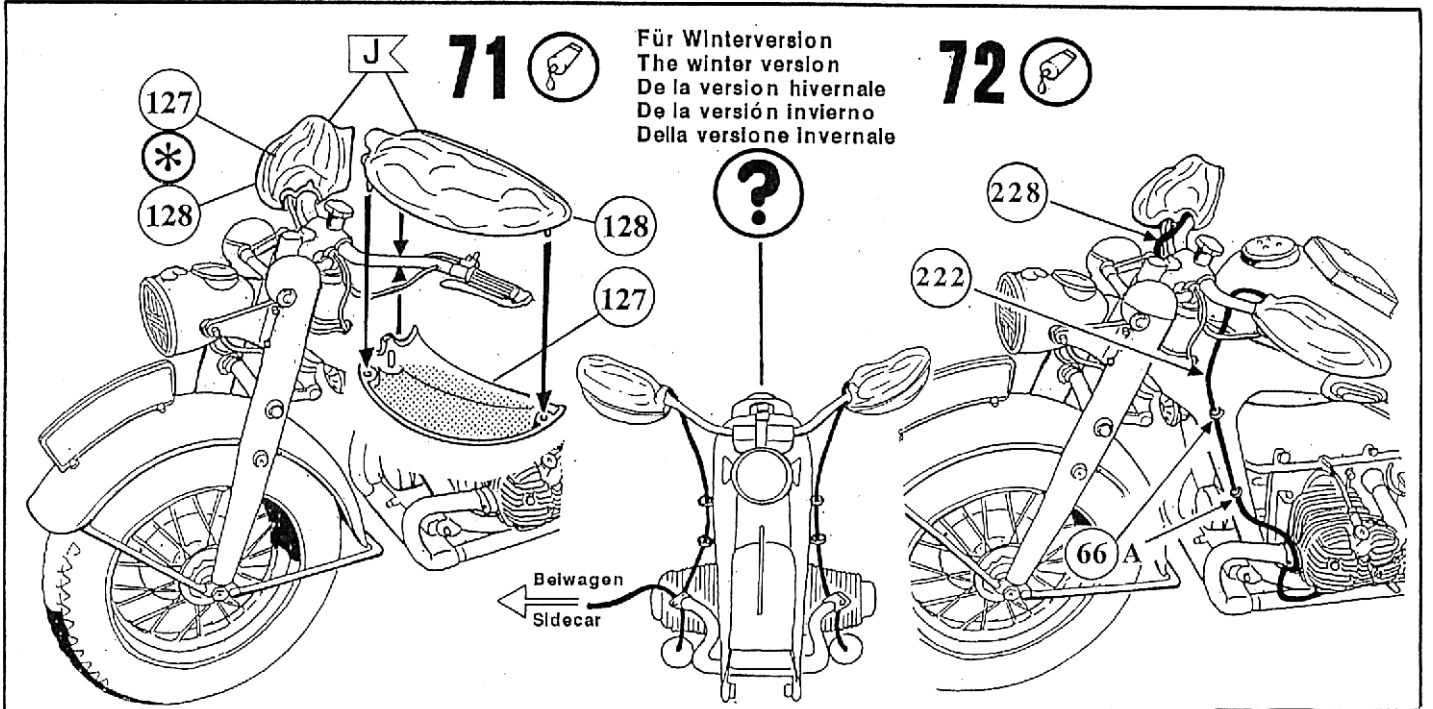

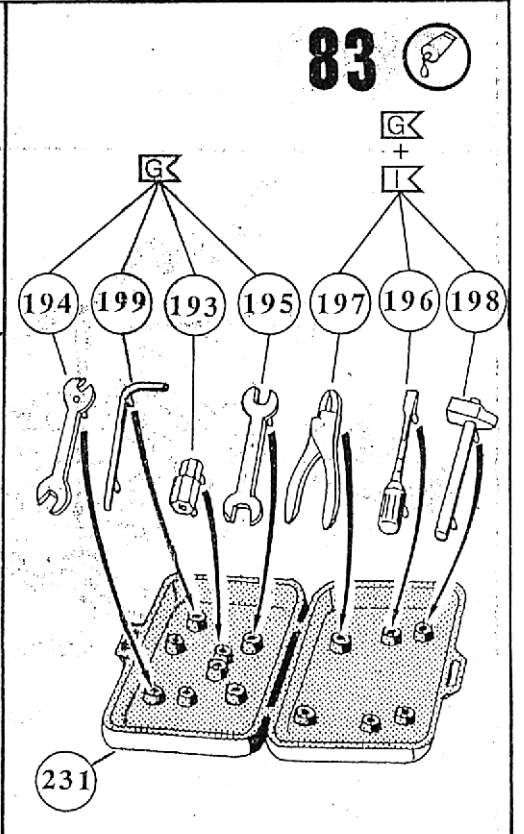
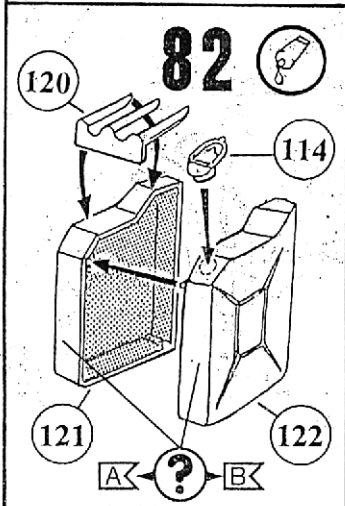
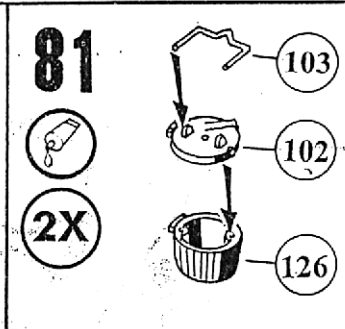
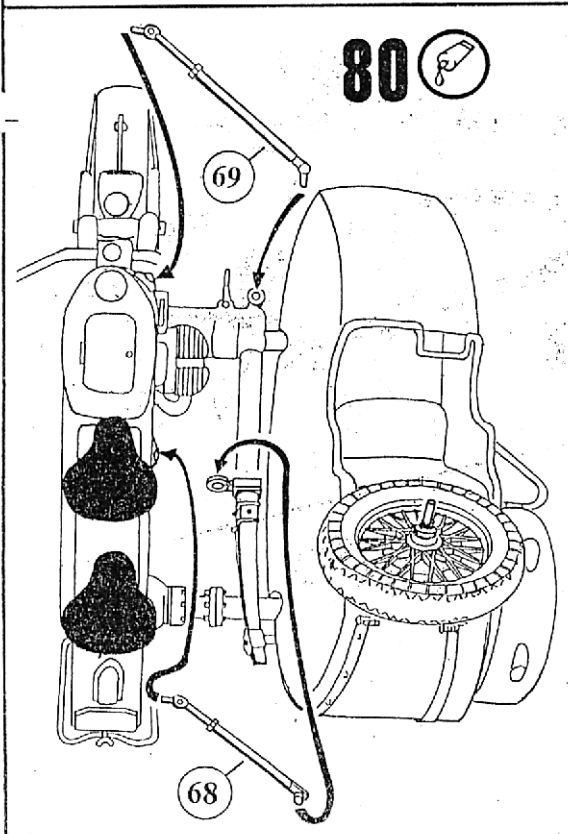
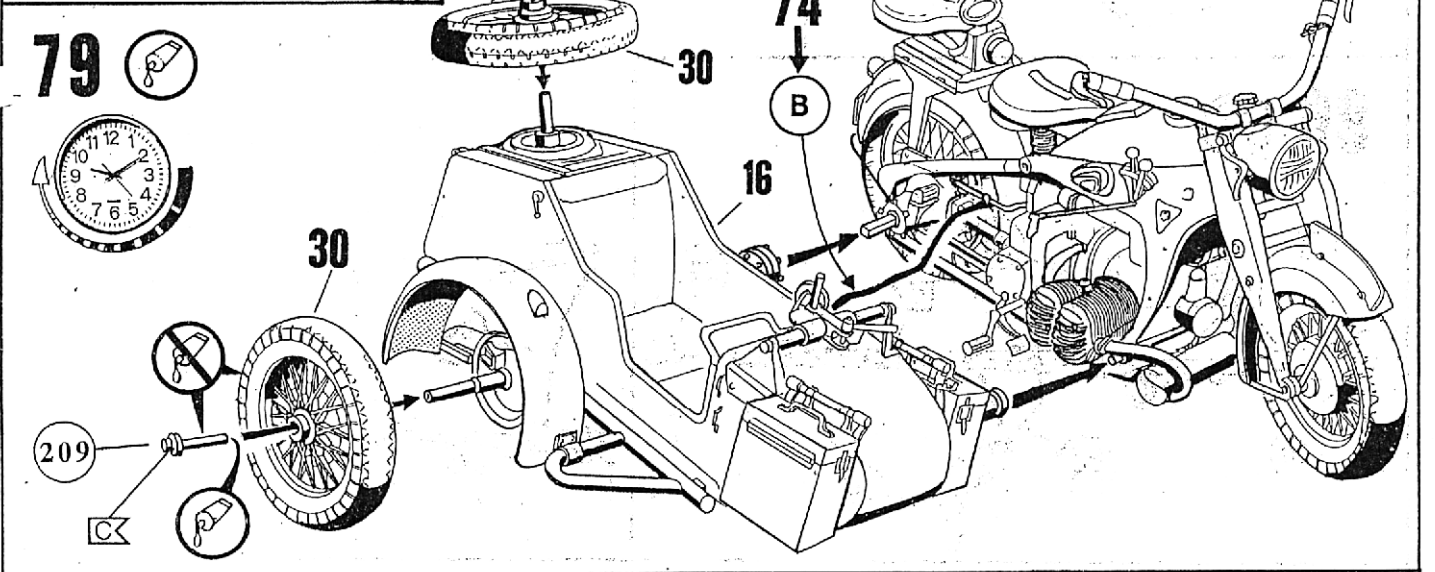
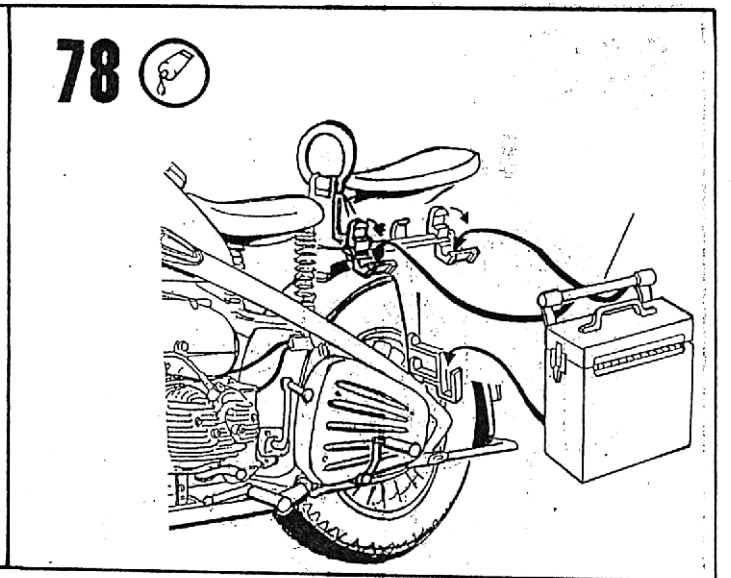
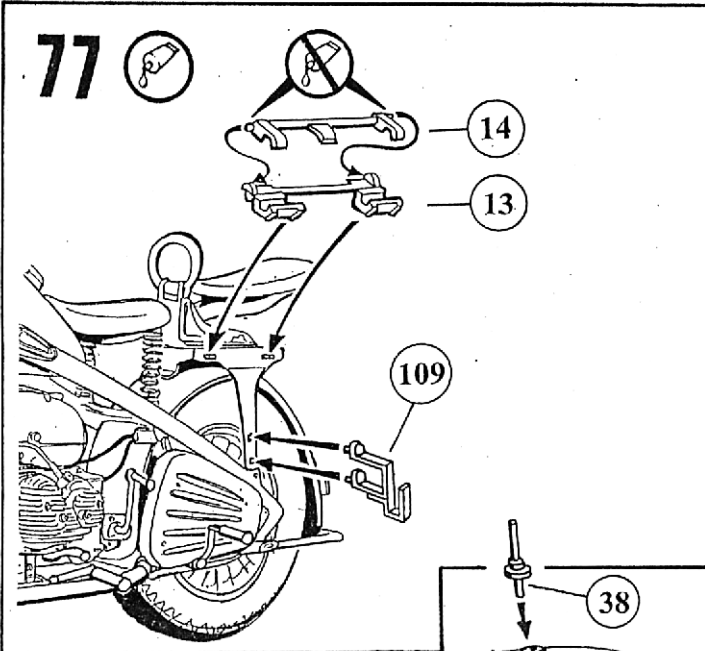

84 

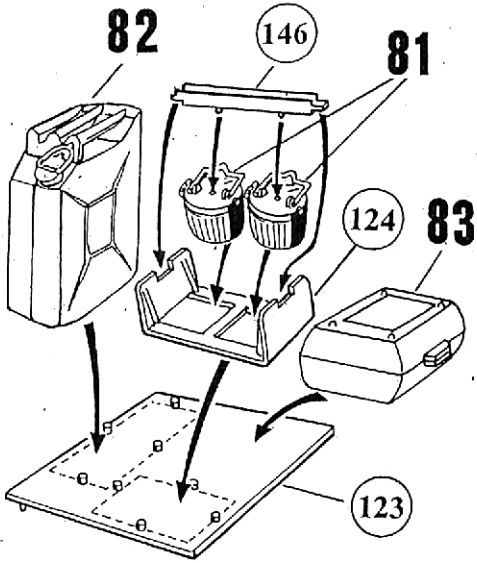

85 

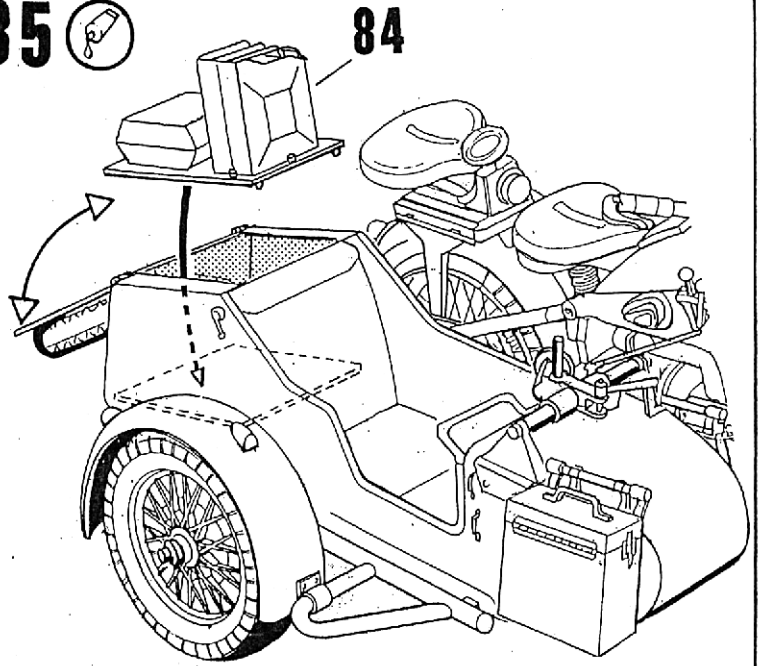

86 

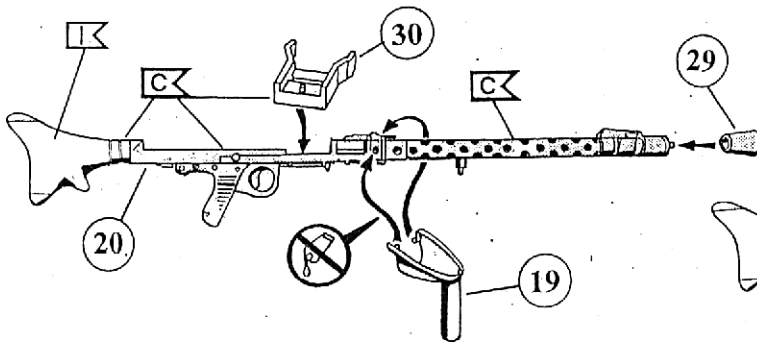

87 

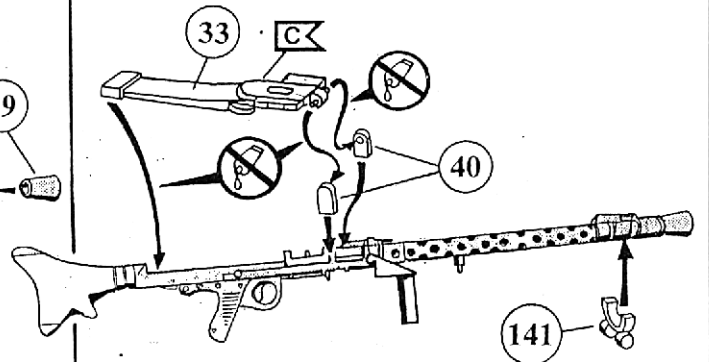

88 

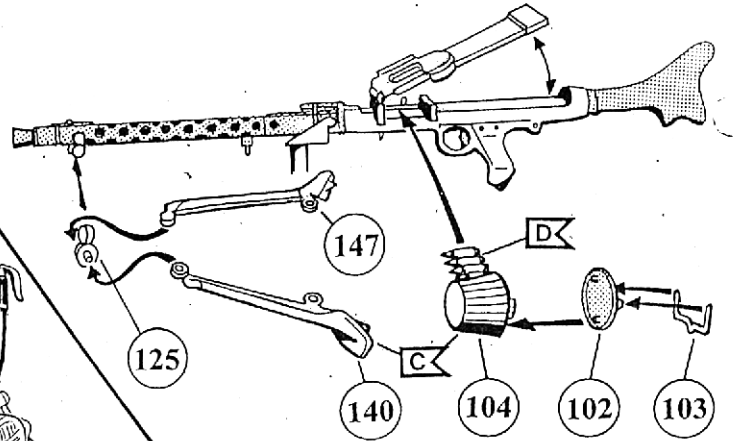
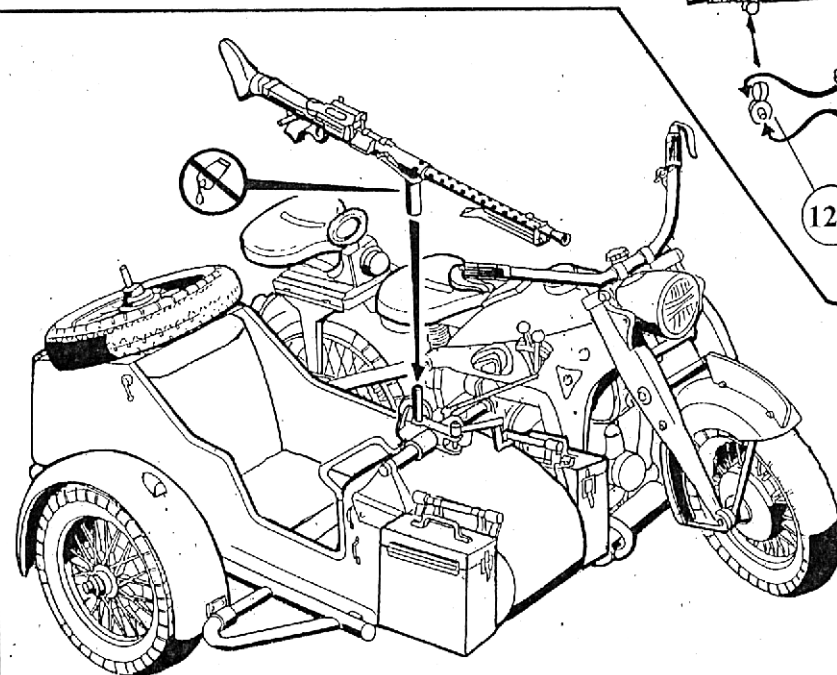

89 

91



1. Panzerdivision
Gubanizi, Ostfront, 1941



A

WH-22206	WH-698128	POL 1231	WL-287802
WH-22206	WH-698128	POL 1231	WL-287802
WH-22206	WH-698128	POL 1231	WL-287802
WH-22206	WH-698128	POL 1231	WL-287802
WH-22206	WH-698128	POL 1231	WL-287802
WH-22206	WH-698128	POL 1231	WL-287802
WH-22206	WH-698128	POL 1231	WL-287802
WH-22206	WH-698128	POL 1231	WL-287802
WH-22206	WH-698128	POL 1231	WL-287802
WH-22206	WH-698128	POL 1231	WL-287802
WH-22206	WH-698128	POL 1231	WL-287802

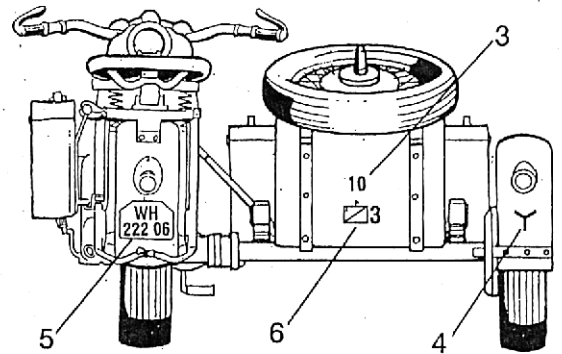
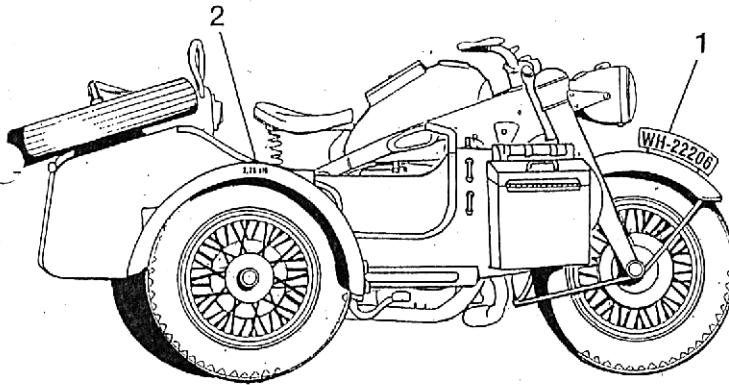
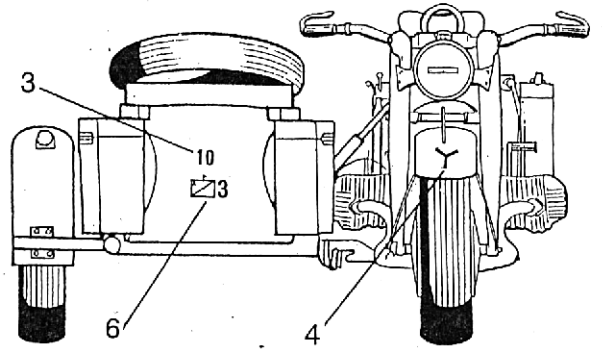
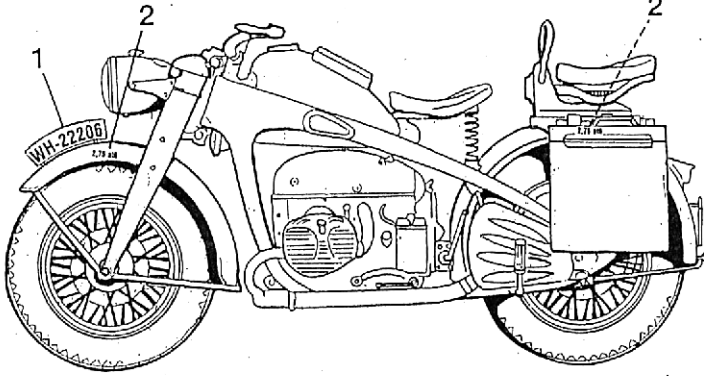

92



Unbekanntes Kradschützenbataillon
Ostfront 1941



A

WH-22206	WH-698128	POL 1231	WL-287802
WH-22206	WH-698128	POL 1231	WL-287802
WH-22206	WH-698128	POL 1231	WL-287802
WH-22206	WH-698128	POL 1231	WL-287802
WH-22206	WH-698128	POL 1231	WL-287802
WH-22206	WH-698128	POL 1231	WL-287802
WH-22206	WH-698128	POL 1231	WL-287802
WH-22206	WH-698128	POL 1231	WL-287802
WH-22206	WH-698128	POL 1231	WL-287802
WH-22206	WH-698128	POL 1231	WL-287802
WH-22206	WH-698128	POL 1231	WL-287802

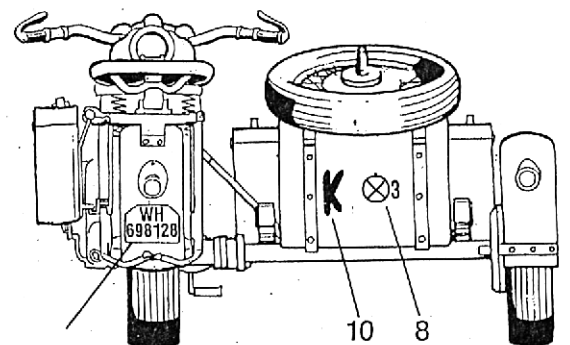
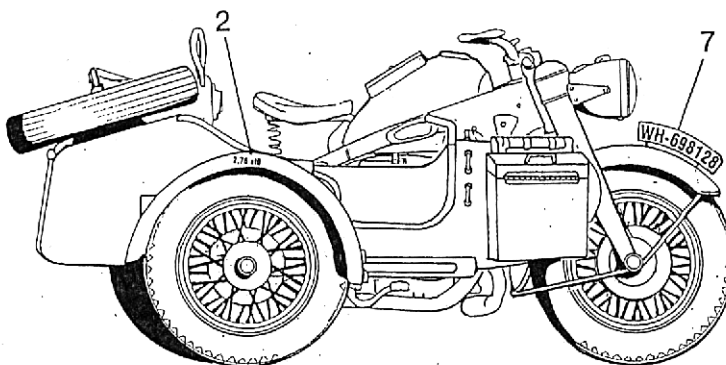
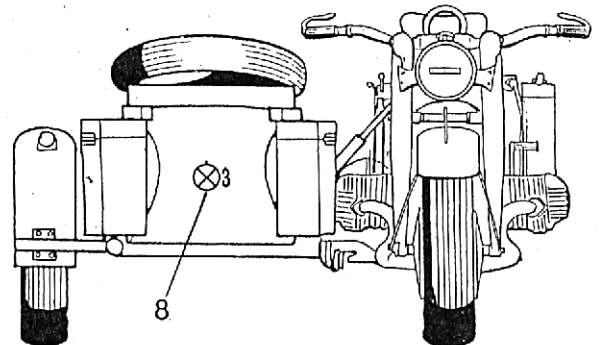
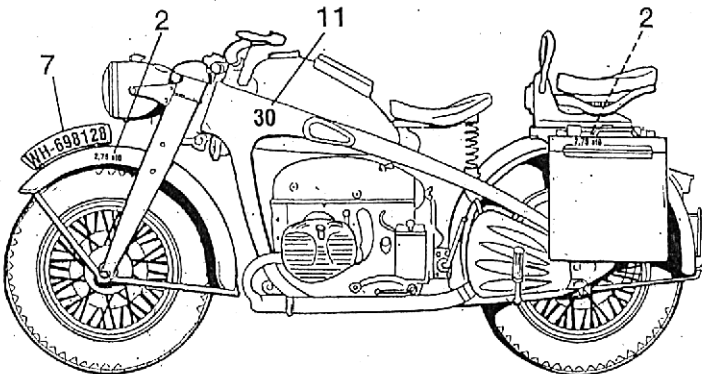

93



Unbekannte Feldjägereinheit, Welish, Ostfront 1942



A

WH-22206	WH-688128	POL 1231	WL-287 902
WH-22206	WH-688128	POL 1231	WL-287 902
WH-10	WH-10	WH-10	WH-10
WH-22206	WH-688128	POL 1231	WL-287 902
WH-22206	WH-688128	POL 1231	WL-287 902
WH-22206	WH-688128	POL 1231	WL-287 902
WH-22206	WH-688128	POL 1231	WL-287 902
WH-22206	WH-688128	POL 1231	WL-287 902
WH-22206	WH-688128	POL 1231	WL-287 902
WH-22206	WH-688128	POL 1231	WL-287 902

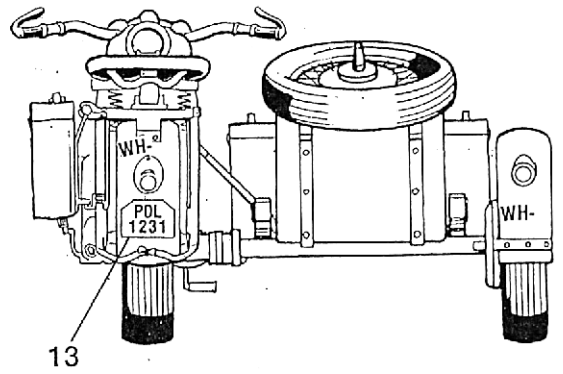
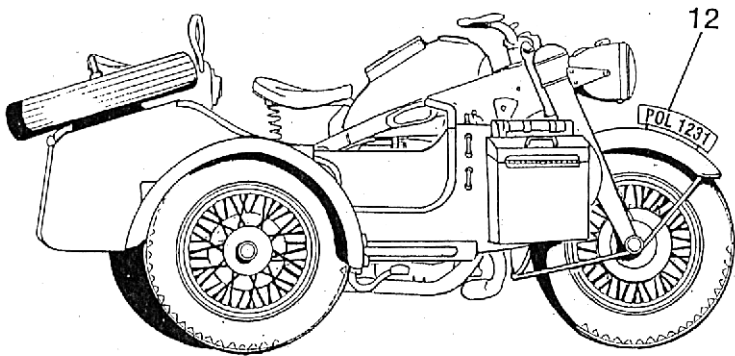
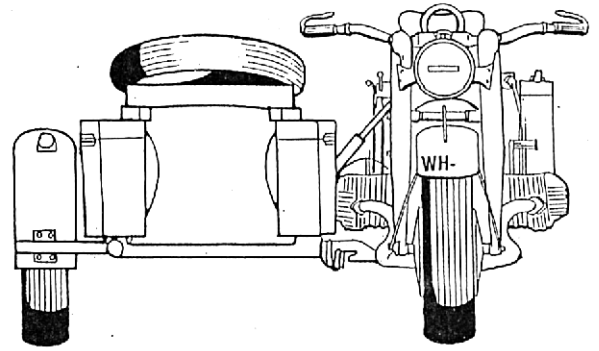
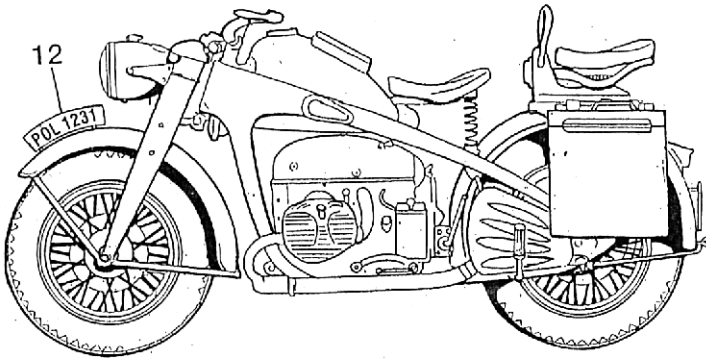

94



Jagdgeschwader 27, Nordafrika 1942



B

WH-22206	WH-688128	POL 1231	WL-287 902
WH-22206	WH-688128	POL 1231	WL-287 902
WH-10	WH-10	WH-10	WH-10
WH-22206	WH-688128	POL 1231	WL-287 902
WH-22206	WH-688128	POL 1231	WL-287 902
WH-22206	WH-688128	POL 1231	WL-287 902
WH-22206	WH-688128	POL 1231	WL-287 902
WH-22206	WH-688128	POL 1231	WL-287 902
WH-22206	WH-688128	POL 1231	WL-287 902
WH-22206	WH-688128	POL 1231	WL-287 902

