

# GREEN HORNET

## FORD "T" SHOW AND GO ROADSTER

Here's a supercharged show-go machine which would be the envy of any hot-rodder. Steel tubing seat and roll bar and alloy frame rails with lightening holes help keep the cars weight at a minimum. Although most of the non-essentials have been eliminated, this rod has a wealth of interesting detail.

Powered by a V-8 engine having 461 cubic inch displacement, topped with a 4-71 blower driven by five V belts and using dual four-throat carburetion, this is a real hot rod.

The car has a removable '23 Ford "T bucket" body. Ford unlightened front axle, pre-war ford rear axle, Weiand heads, tubular shocks and a quick change rear end. Note the interesting arrangement of the seat and fuel tank. Also, instead of a radiator the car has a concealed transfer tube reservoir in the radiator shell for cooling. Cycle fenders and a canvas top complete this beautiful car.

About the model - The "Green Hornet" has a removable body, just as on many of the full size cars. The top and fenders are also removable. Assemble your car complete as a show-go roadster or remove the top and fenders and you have a competition car. With body, top and fenders removed the "Hornet" becomes a flashy "rail" job in gleaming chrome plate.

The many highly detailed chrome plated parts, green parts, clear windshield, rubber tires and large customizing decal sheet combine to make this an interesting and beautiful model that you will be proud to show your friends.

*Reprinted sections from the original 1960 plan 85006100200*



**\* REPEAT SEVERAL TIMES**  
\* A REPETER PLUSIEURS FOIS



**\* OPTIONAL PARTS**  
\* PIECES EN OPTION



**\* DECAL**  
\* DECAL COMANIE



**\* ALTERNATIVE ASSEMBLY**  
\* ENSEMBLAGE ALTERNATIVE



**\* CEMENT TOGETHER**  
\* A COLLER



**\* REMOVE AND THROW AWAY**  
\* A RETIRER ET JETER



**\* DO NOT CEMENT**  
\* NE PAS COLLER

**READ THIS BEFORE YOU BEGIN**

- \* Study the assembly drawings.
- \* Each plastic part is identified by a number.
- \* In the assembly drawings, some parts will be marked by a star (★) to indicate chrome plated plastic.
- \* For better paint and decal adhesion, wash the plastic parts in a mild detergent solution. Rinse and let air dry.
- \* Check the fit of each piece before cementing in place.
- \* Use only cement for polystyrene plastic.
- \* Scrape plating and paint from areas to be cemented.
- \* Allow paint to dry thoroughly before handling parts.
- \* Any unused parts may be discarded.

**DECAL APPLICATION INSTRUCTIONS**

1. Cut desired decal from sheet.
2. Dip decal in water for a few seconds.
3. Place wet decal on paper towel.
4. Wait until decal is movable on paper backing.
5. Place decal in position on model, face up and slide backing away.
6. Press out air bubbles with a soft damp cloth.
7. Milkiness that may appear is for better decal adhesion and will dry clear. Wipe away any excess adhesive.
8. Do not touch decal until fully dry.
9. Allow the decals 48 hours to dry before applying clear coat.

**NOTE: Decals are compatible with setting solutions or solvents.**

**LIRE CE QUI SUIT AVANT DE COMMENCER**

- \* Etudier les schémas de montage.
- \* Chaque pièce en plastique est identifiée par un numéro.
- \* Sur les schémas de montage, certaines pièces sont marquées d'une étoile (★) pour indiquer qu'elles sont en plastique chromé.
- \* Pour une meilleure prise de la peinture et des autocollants, laver les pièces en plastique avec une solution détergente peu concentrée. Les rincer et les laisser sécher à l'air.
- \* Vérifier que chaque pièce s'ajuste bien avant de la coller en place.
- \* N'utiliser que de la colle pour polystyrène.
- \* Gratter les parties à coller pour enlever le chrome et la peinture.
- \* Laisser la peinture bien sécher avant de manipuler les pièces.
- \* Toute pièce inutilisée peut être jetée.

**DIRECTIVES D'APPLICATION DES AUTOCOLLANTS**

1. Découper l'autocollant désiré de la feuille.
2. Tremper l'autocollant dans de l'eau pendant quelques secondes.
3. Placer l'autocollant mouillé sur une serviette en papier.
4. Attendez que l'autocollant puisse être déplacé sur son support en papier.
5. Mettre l'autocollant en position sur le modèle face sur le dessus et faire glisser le support pour l'enlever.
6. Appuyer avec un chiffon doux humide pour éliminer les bulles d'air.
7. La substance laiteuse qui peut apparaître est destinée à améliorer l'adhésion de l'autocollant et devient incolore au séchage. Essuyer pour enlever tout excédent d'adhésif.
8. Ne pas toucher l'autocollant tant qu'il n'est pas bien sec.
9. Laisser l'autocollant sécher pendant 48 heures avant d'appliquer une couche transparente.

**REMARQUE: Les autocollants sont compatibles avec les solutions de fixation ou les solvants.**

**This paint guide is provided to complete this kit as shown on the box.**

*Ce guide de peinture est fourni pour reproduire le modèle réduit qui apparaît sur la boîte.*

<b>Gloss Black</b>	<i>Noir brillant</i>
<b>Gloss White</b>	<i>Blanc brillant</i>
<b>Satin White</b>	<i>Blanc satiné</i>
<b>Semigloss Black</b>	<i>Noir satiné</i>
<b>Silver</b>	<i>Argent</i>
<b>Transparent Red</b>	<i>Rouge transparent</i>

**If you have any questions or comments, call our hotline at: (800) 833-3570 or, please write to:**

**Revell-Monogram Consumer Service Department, 725 Landwehr Road, Northbrook, Illinois 60062**

*Be sure to include the plan number (85006110200), part number, description, your return address and phone number.*

**Visit our website: [www.revell-monogram.com](http://www.revell-monogram.com)**

# 1

# FRAME ASSEMBLY

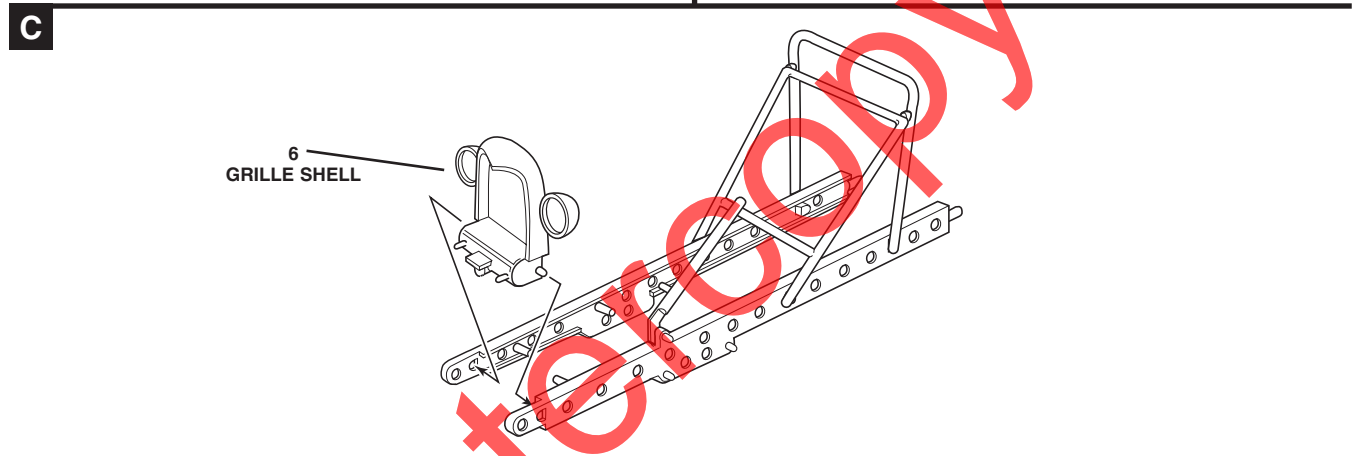
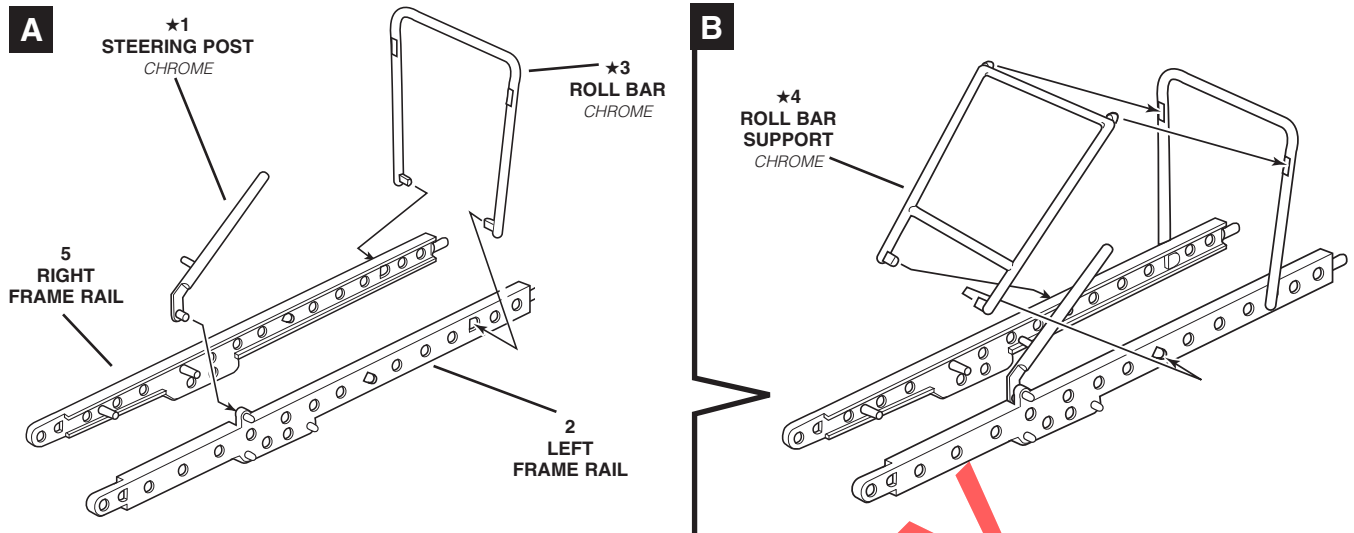

# 2

# ENGINE ASSEMBLY

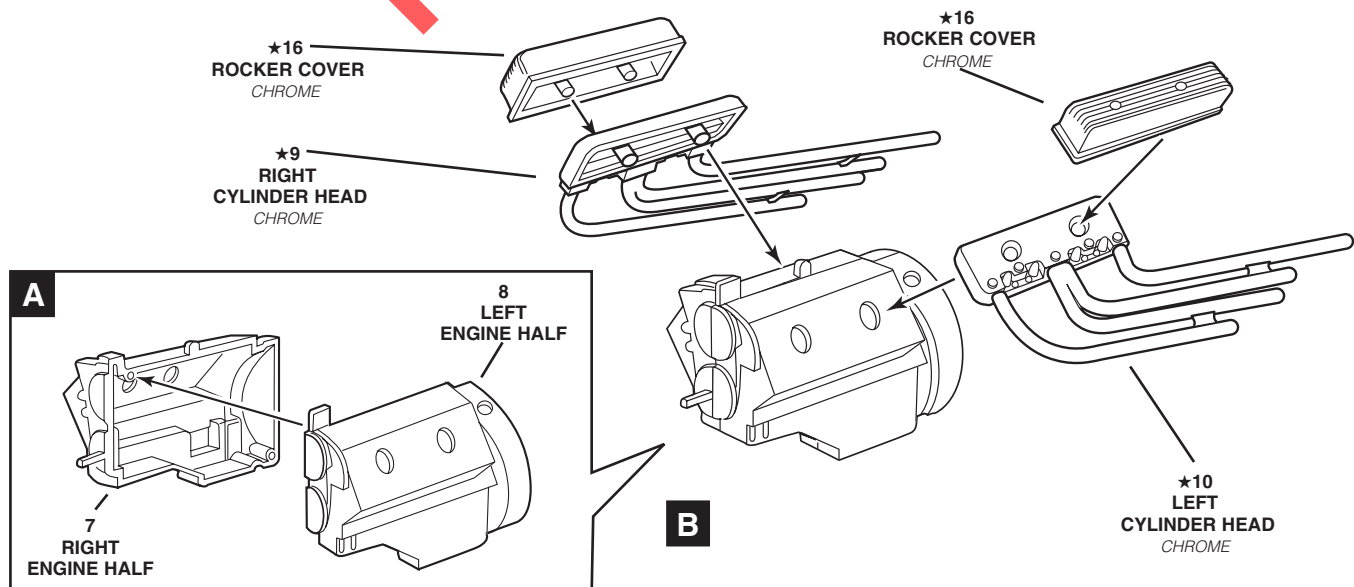

# 2

# ENGINE ASSEMBLY CONTINUED

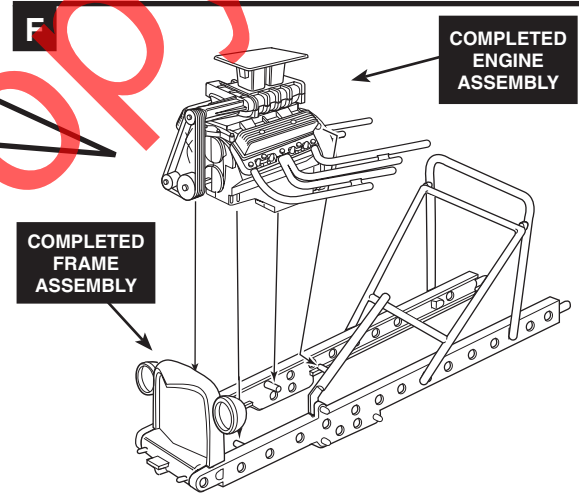
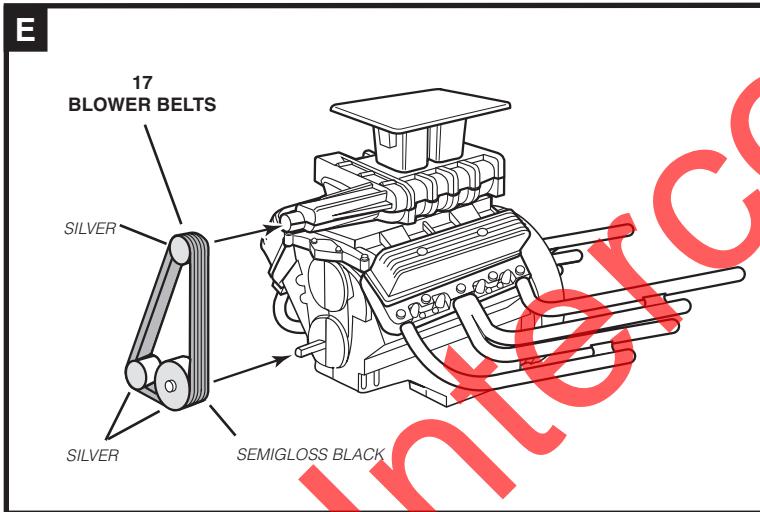
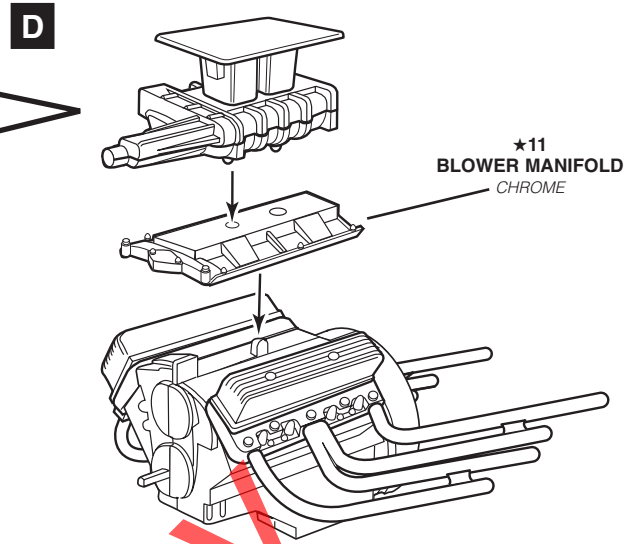
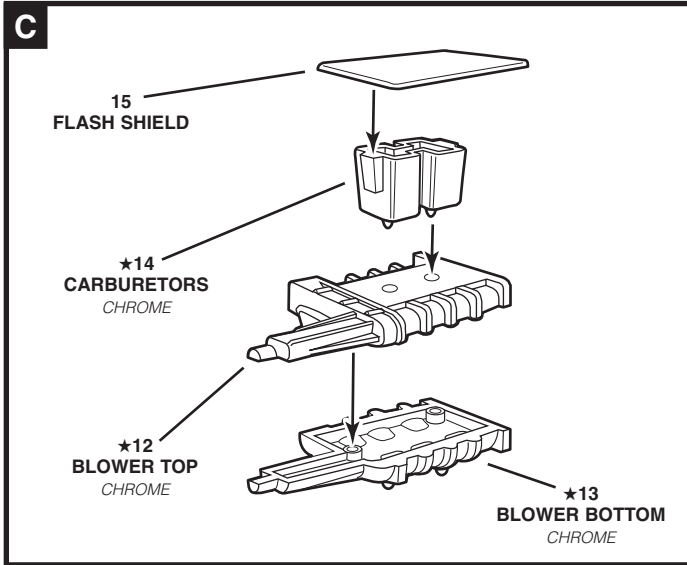

# 3

# FRONT ASSEMBLY

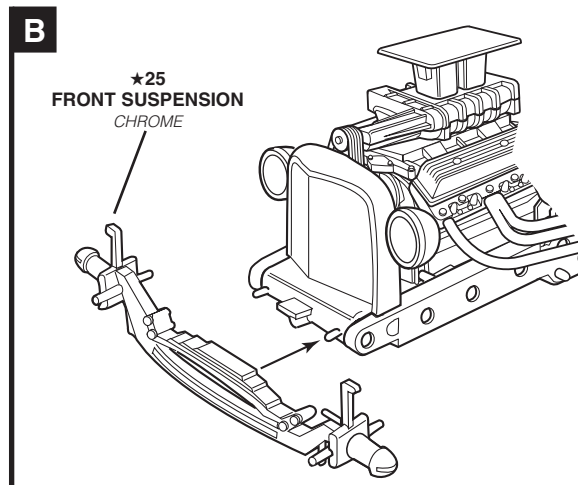
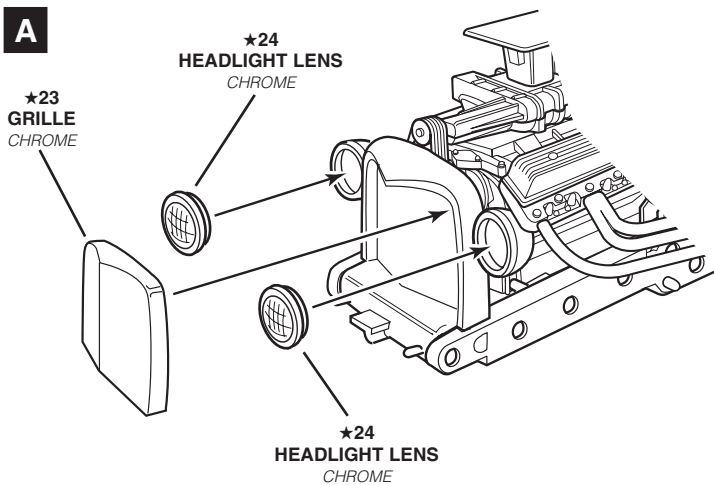

# 4

# REAR AXLE ASSEMBLY

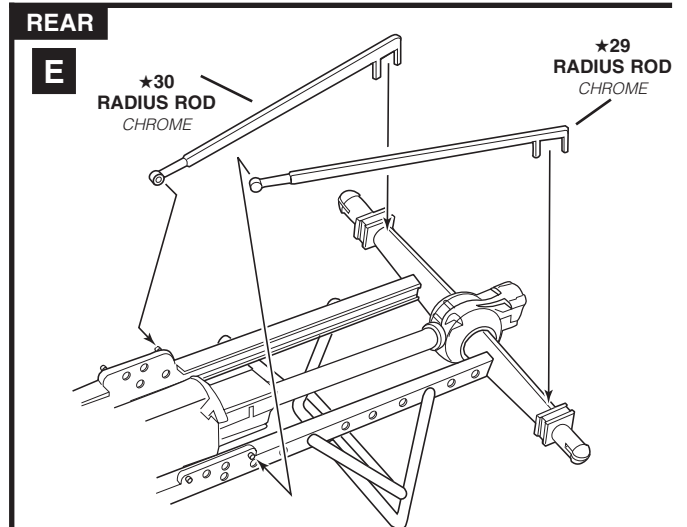
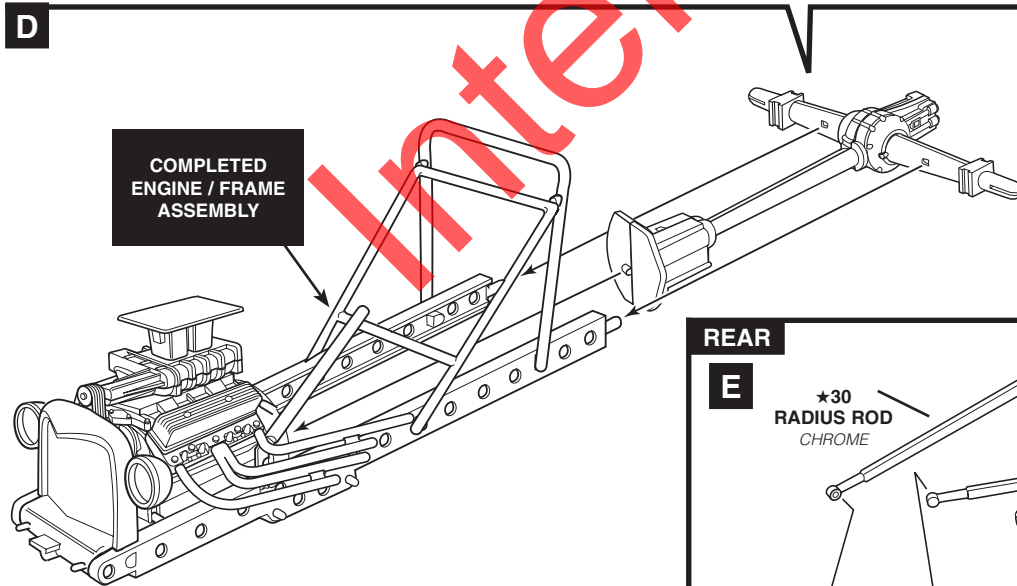
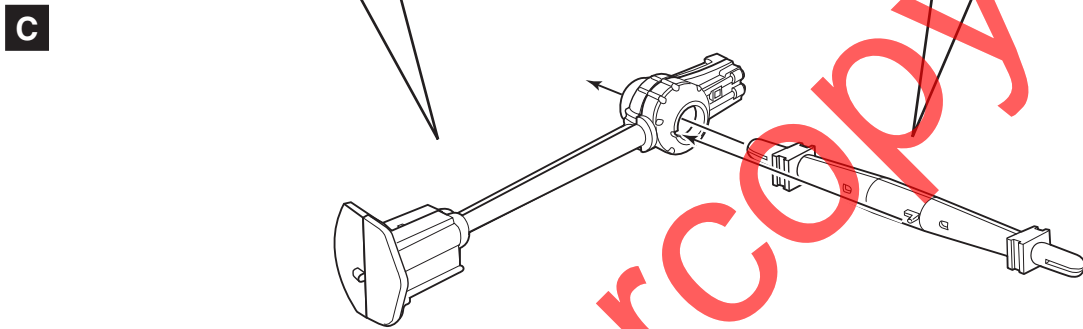
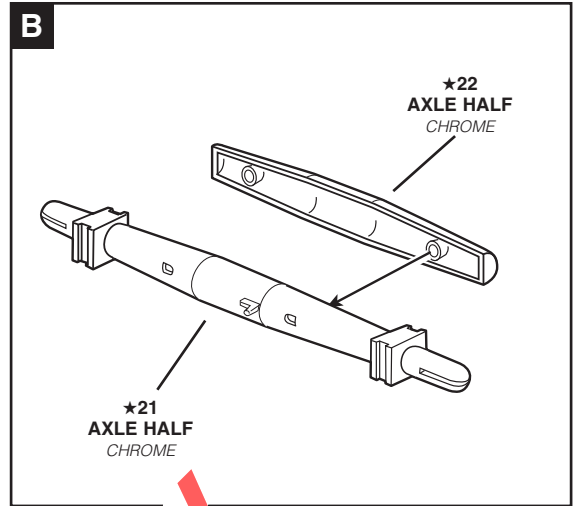
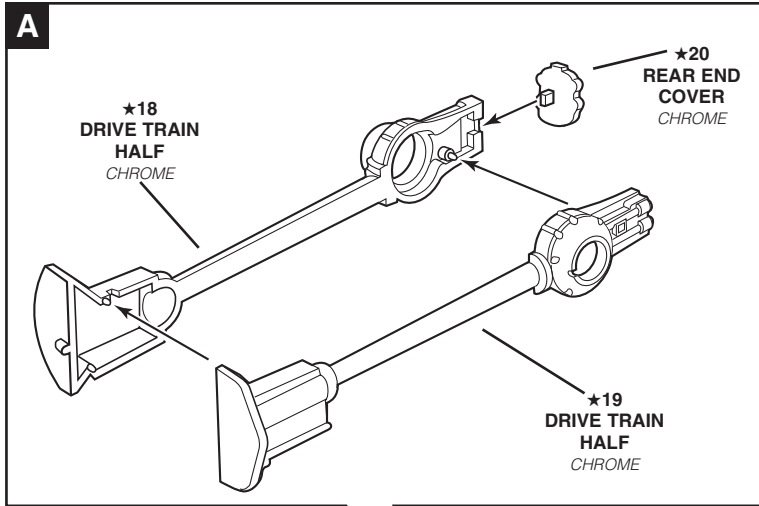

# 5

# FRONT SUSPENSION ASSEMBLY

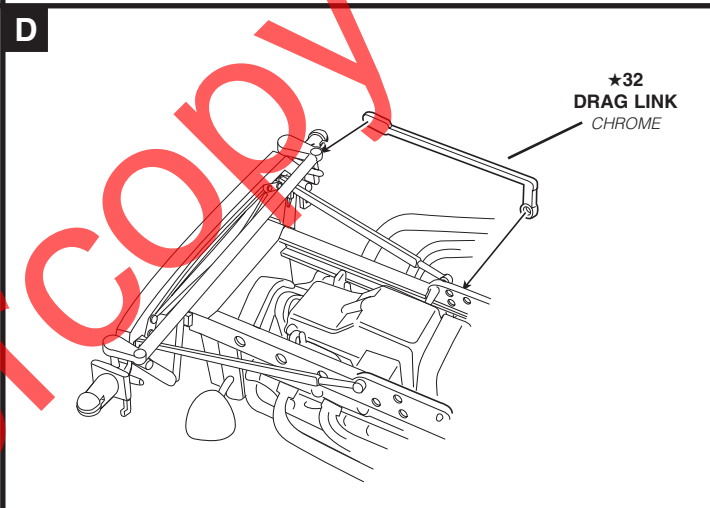
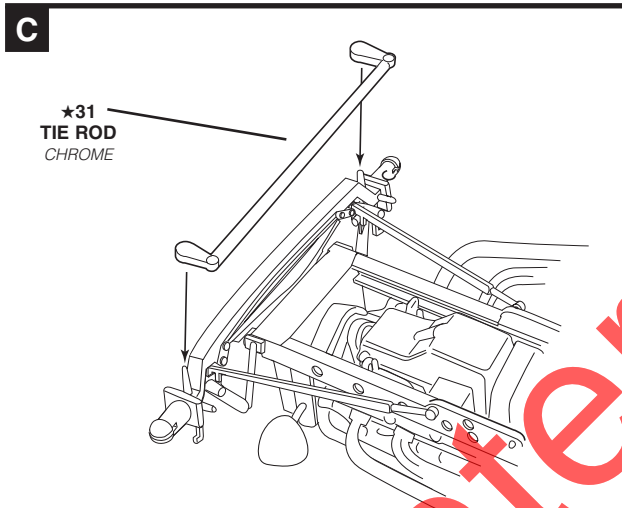
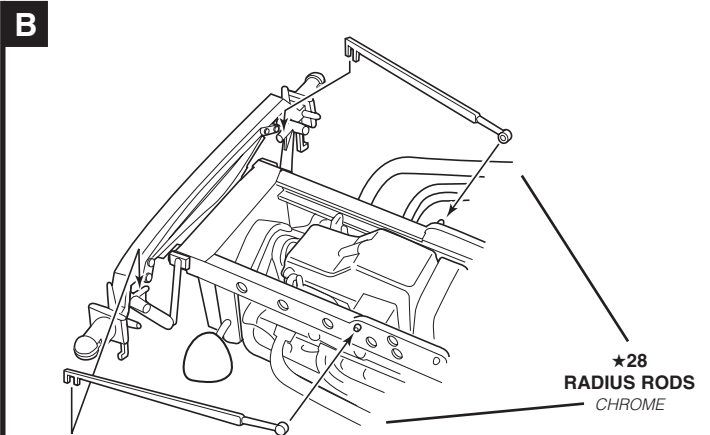
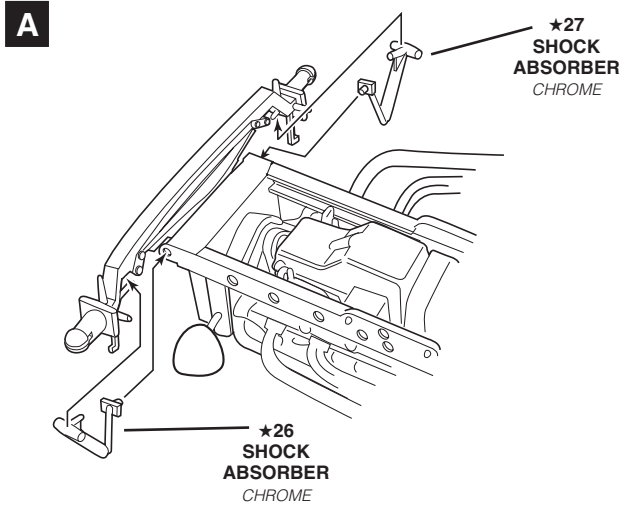

# 6

# SEAT ASSEMBLY

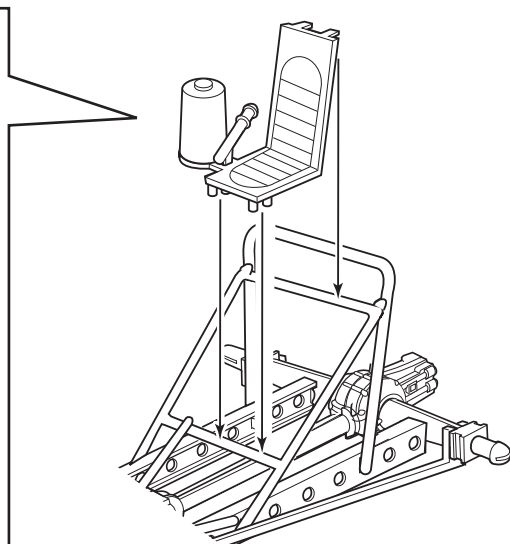
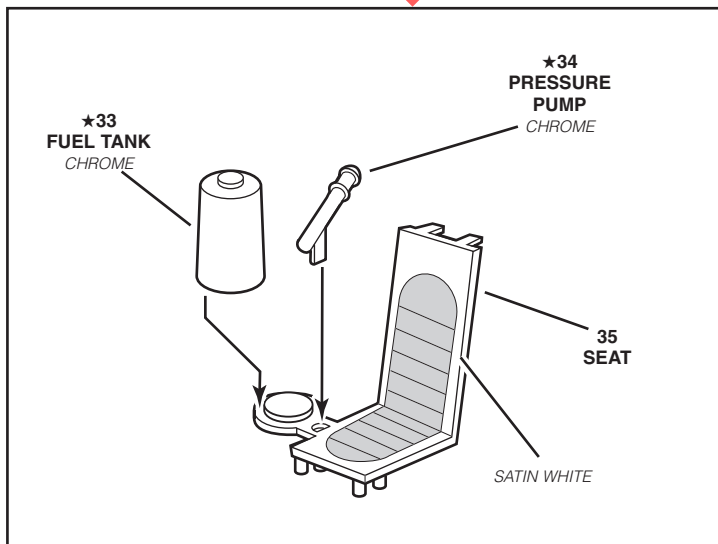



# 7

# FENDER ASSEMBLY

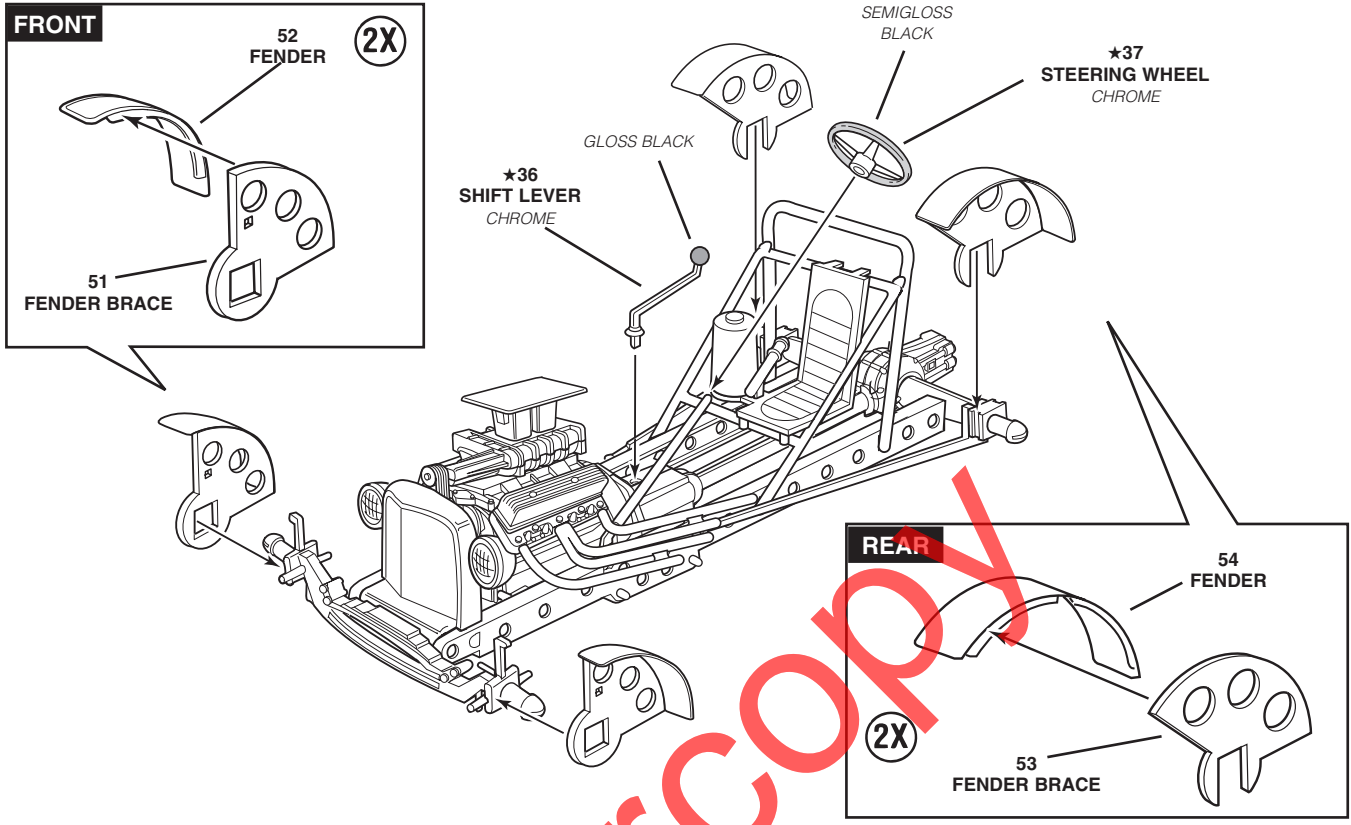

# 8

# WHEEL ASSEMBLY

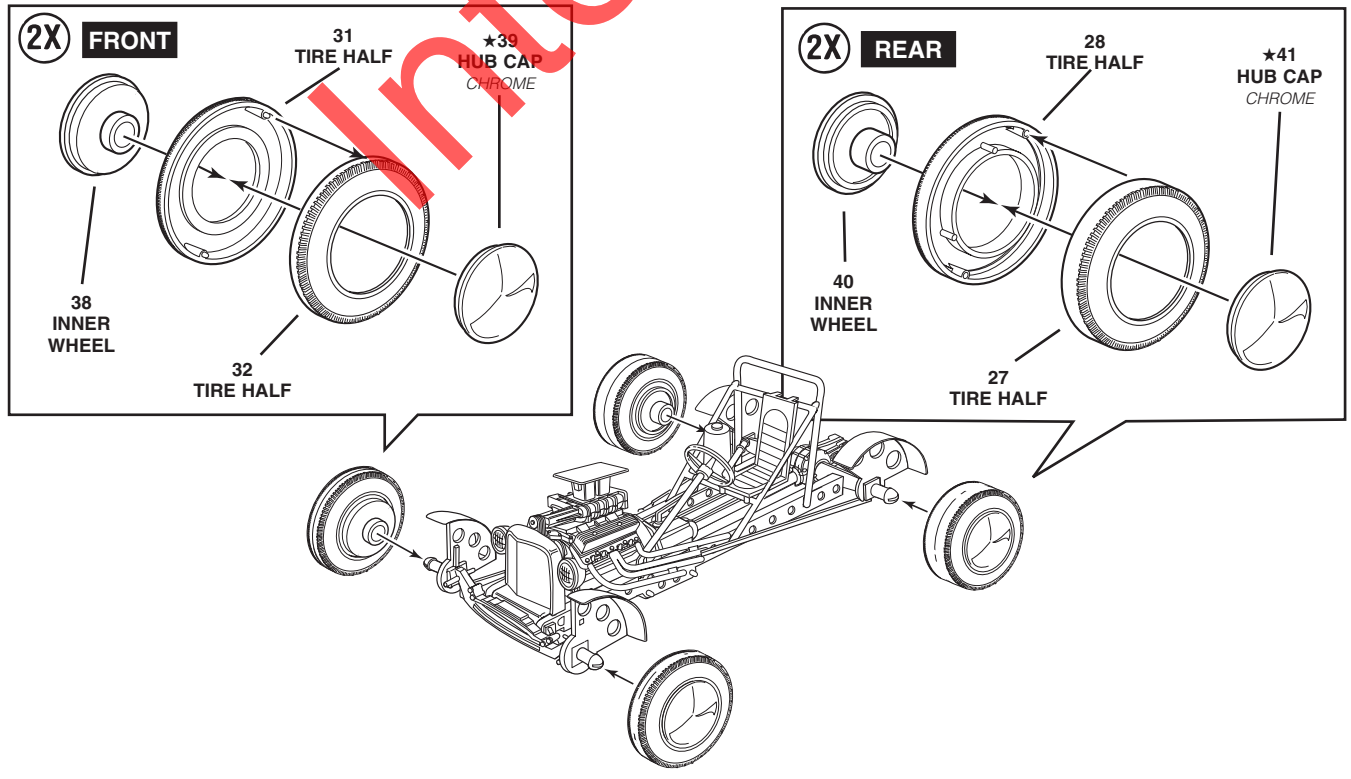

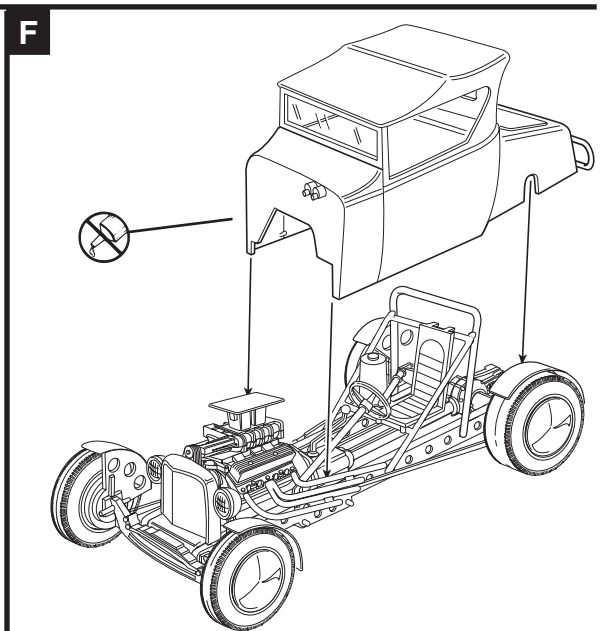
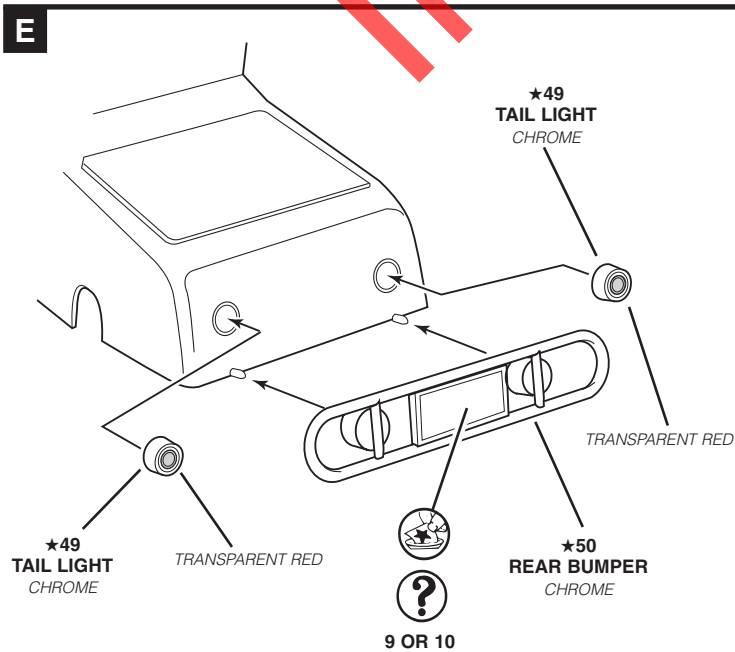
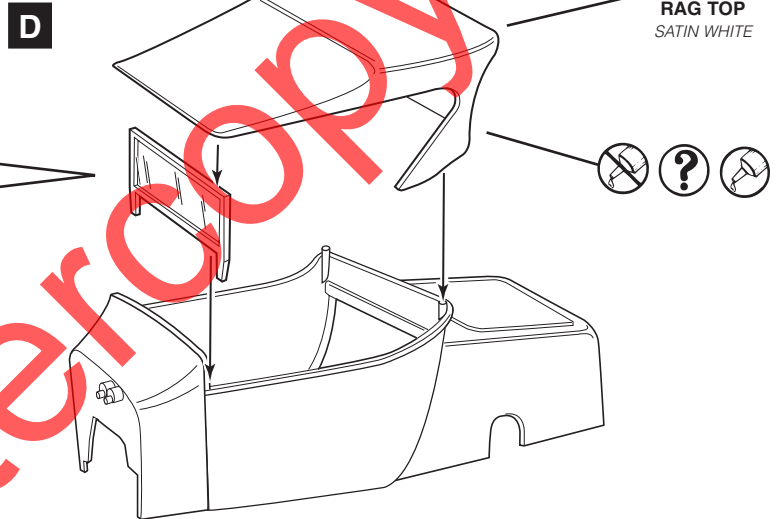
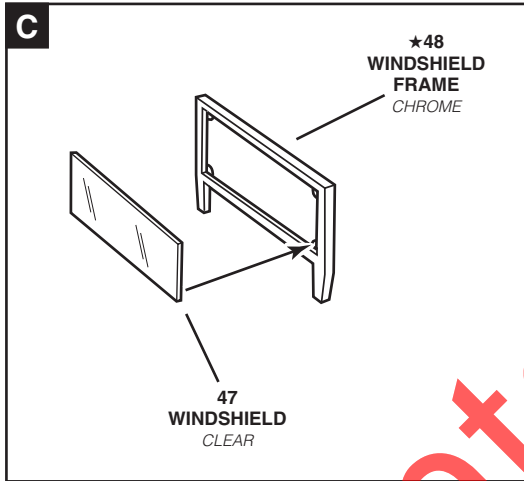
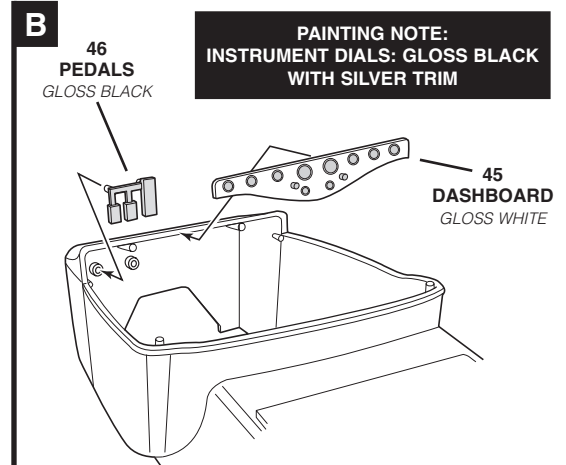
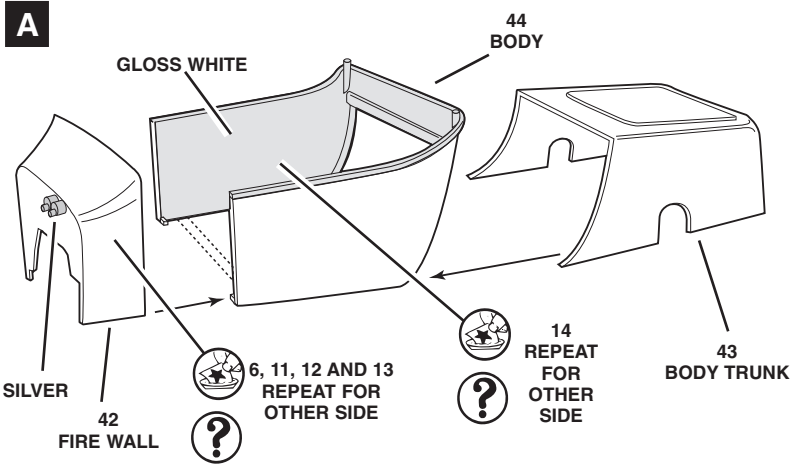

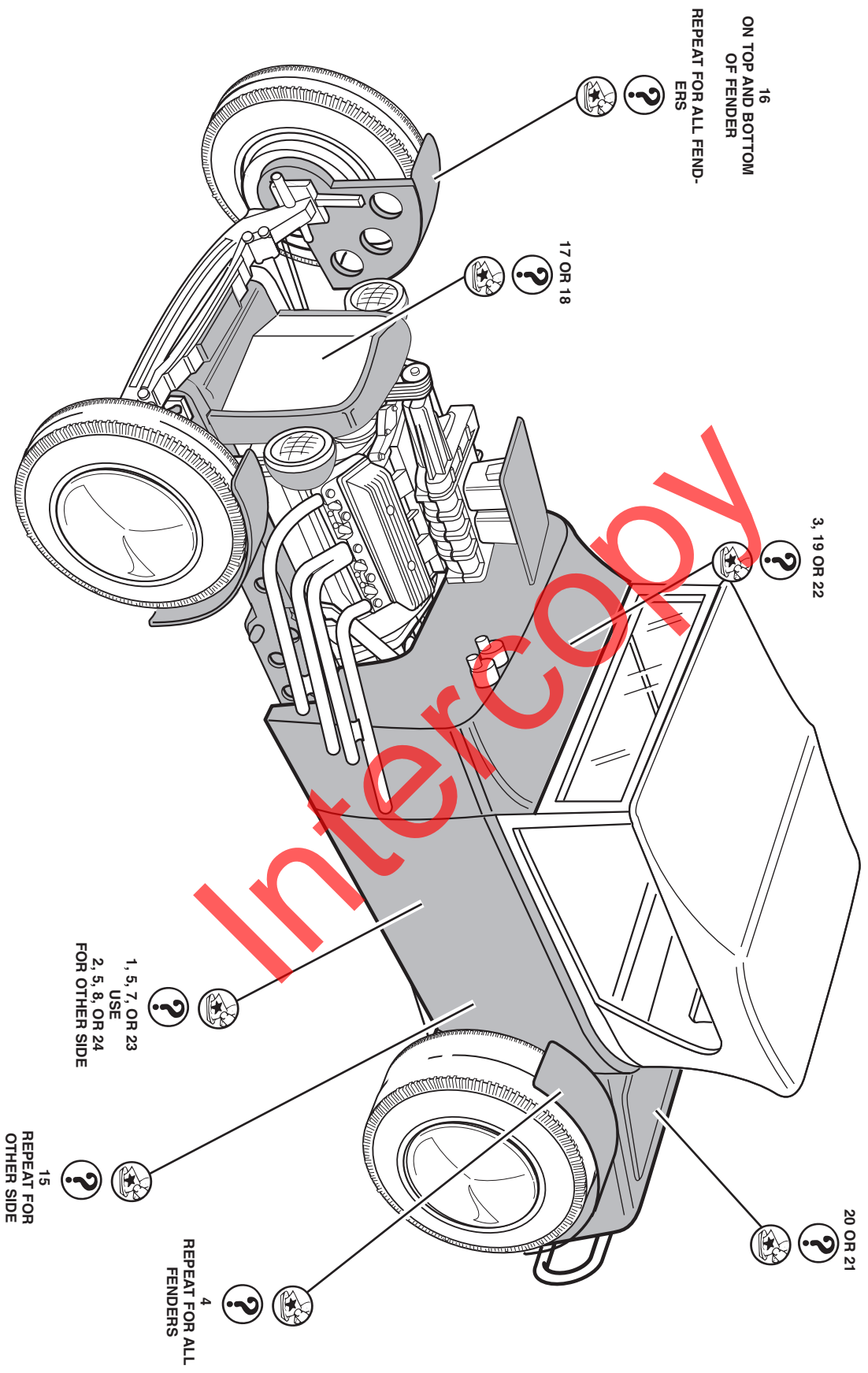

16  
ON TOP AND BOTTOM  
OF FENDER  
REPEAT FOR ALL FEND-  
ERS

17 OR 18

3, 19 OR 22

20 OR 21

1, 5, 7, OR 23  
2, 5, 8, OR 24  
FOR OTHER SIDE

15  
REPEAT FOR  
OTHER SIDE

4  
REPEAT FOR ALL  
FENDERS