



KIT1554



85155400200

'64 Chevy® Impala™ SS™

The 1964 Chevrolet® was the third and final annual revision of the basic body first introduced with the '61 models. With its handsome squarish looks and metal roof that resembled a raised convertible top, it was also a huge hit with the public. Offering many different body styles and an optional equipment list longer than your arm, it was easy to personalize your new Chevy® any way you wanted.

Because the full-size '64 Chevy was America's best selling car, many examples have survived the decades especially in climates like that found in California and

other western states and can be found at reasonable prices. It's not surprising then that the '64 Chevy has become one of the most popular subjects among older iron to become transformed into lowriders.

Revell's '64 Chevy Lowrider plastic kit has been one of our best sellers for years. Now for those of you that prefer the heft of die cast metal, we now present our Metal Body™ kit version of the famous Impala™. With its pre-painted body, opening hood & trunk and detailed interior, we think we have another best seller on our hands.



*** REPEAT SEVERAL TIMES**
* A REPETER PLUSIEURS FOIS



*** OPTIONAL PARTS**
* PIECES EN OPTION



*** DECAL**
* DECAL COMANIE



*** ALTERNATIVE ASSEMBLY**
* ENSEMBLAGE ALTERNATIVE



*** CEMENT TOGETHER**
* A COLLER



*** REMOVE AND THROW AWAY**
* A RETIRER ET JETER



*** DO NOT CEMENT**
* NE PAS COLLER

WARNING: PLASTIC GLUE COULD CATCH ON FIRE. IT COULD HURT YOU IF IT GETS ON YOUR SKIN OR IN YOUR EYES.

CONTAINS: METHYL ETHYL KETONE.

BE CAREFUL: Do not allow long contact with skin. Wash hands at once after use. Wear thick gloves when in use. Keep away from eyes. Do not smell or eat.

KEEP OUT OF THE REACH OF SMALL CHILDREN.

FIRST AID: If glue gets in your eyes wash with clean water for 5 to 10 minutes. If glue gets on your skin, wash with soap and water for 5 minutes. If you start to feel weak, sick, or your speech becomes slow; go outside then wash hands and remove any clothing with glue on it. If you still do not feel better seek your doctors attention.

For further health questions; contact a poison control center.

AVERTISSEMENT: LA COLLE PLASTIQUE RISQUE DE S'ENFLAMMER ET PEUT ETRE DANGEREUSE SI ELLE TOUCHE LA PEAU OU PENETRE DANS LES YEUX.

COMPOSITION: METHYLETHYLKETONE.

ATTENTION: Empêcher tout contact prolongé avec la peau. Se laver les mains immédiatement après utilisation. Porter des gants épais pendant l'utilisation. Ne pas approcher des yeux. Ne pas sentir ni avaler. Conserver hors de portée des jeunes enfants.

CONSERVER HORS DE PORTÉE DES JEUNES ENFANTS.

PREMIERS SECOURS: Si la colle pénètre dans les yeux, les laver à l'eau propre pendant 5 à 10 minutes. Si la colle adhère à la peau, laver celle-ci à l'eau savonneuse pendant 5 minutes. En cas de faiblesse, de nausées ou de diction pâteuse, sortir dehors, se laver les mains et ôter tout vêtement sur lequel adhère de la colle. Si l'on continue alors à ne pas se sentir bien, consulter un médecin. Pour d'autres questions en matière

READ THIS BEFORE YOU BEGIN

- Study the assembly drawings.
- Each plastic part is identified by a number.
- In the assembly drawings, some parts will be marked by a star (*) to indicate chrome plated plastic.
- For better paint and decal adhesion, wash the plastic parts in a mild detergent solution.
- Rinse and let air dry.
- Check the fit of each piece before cementing in place.
- Use only cement for polystyrene plastic.
- Scrape plating and paint from areas to be cemented.
- Allow paint to dry thoroughly before handling parts.

LIRE CE QUI SUIT AVANT DE COMMENCER

- Etudier les schémas de montage.
- Chaque pièce en plastique est identifiée par un numéro.
- Sur les schémas de montage, certaines pièces sont marquées d'une étoile (*) pour indiquer qu'elles sont en plastique chromé.
- Pour une meilleure prise de la peinture et des autocollants, laver les pièces en plastique avec une solution détergente peu concentrée. Les rincer et les laisser sécher à l'air.
- Vérifier que chaque pièce s'ajuste bien avant de la coller en place.
- N'utiliser que de la colle pour polystyrène.
- Gratter les parties à coller pour enlever le chrome et la peinture.
- Laisser la peinture bien sécher avant de manipuler les pièces.
- Toute pièce inutilisée peut être jetée.

This optional paint guide is provided to detail this kit.
Ce guide facultatif de peinture est fourni pour détailler cette trousse.

Chevy Engine Orange	Orange moteur Chevrolet
Flat Black	Noir mat
Silver	Argent

If you have any questions or comments, call our hotline at: **(800) 833-3570**
or, please write to:

Revell-Monogram Consumer Service Department, 725 Landwehr, Northbrook, Illinois 60062

Be sure to include the plan number (85155400200), part number, description, your return address and phone number.

Visit our website: www.revell-monogram.com

1

ENGINE ASSEMBLY

A

11
RIGHT ENGINE
HALF
CHEVY ENGINE
ORANGE

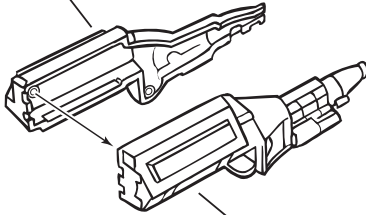

12
LEFT ENGINE
HALF
CHEVY ENGINE
ORANGE

B

***53**
VALVE COVER
CHROME

13B
CARBURETOR

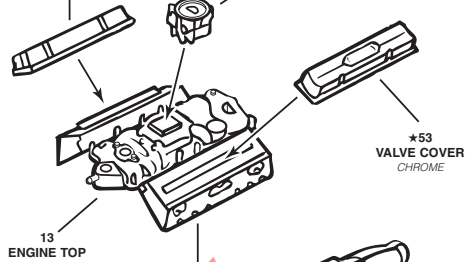

13
ENGINE TOP

***53**
VALVE COVER
CHROME

14
OIL PAN

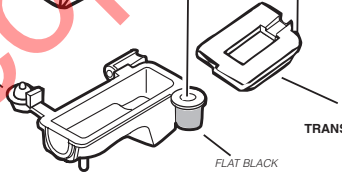

FLAT BLACK

54
TRANSMISSION
PAN

C

***41**
OIL FILLER
TUBE
CHROME

(PAINT SHADED
AREA FLAT BLACK)

15
EXHAUST
MANIFOLD

13C
DISTRIBUTOR CAP
ASSEMBLY

***16**
ENGINE FRONT
CHROME

***18**
FAN
CHROME

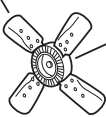

FLAT BLACK
(BELTS)

17
FAN BELT

15
EXHAUST
MANIFOLD

***42**
ALTERNATOR
CHROME

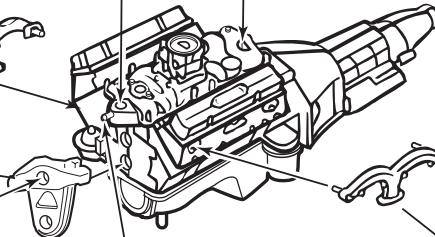

SUSPENSION ASSEMBLY

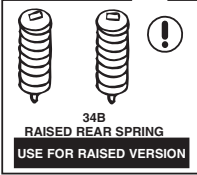
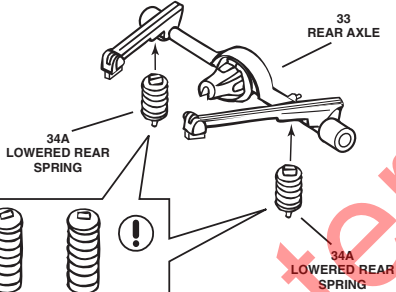
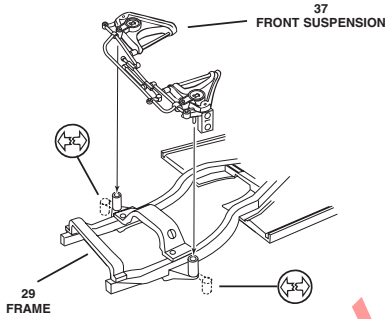

NOTE: PICK A RIDE HEIGHT FOR THE SPRINGS. ONCE THE RIDE HEIGHT IS PLACED YOU CANNOT BUILD THE OTHER VERSION

LOWERED

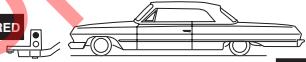

LOWERED

RAISED

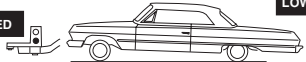

LOWERED

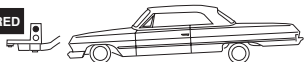

RAISED

RAISED

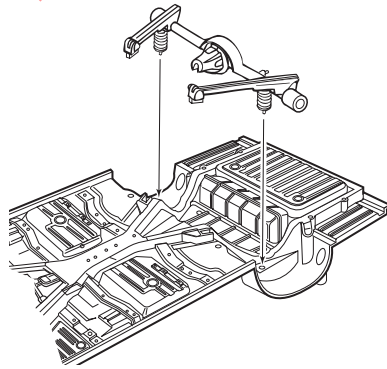
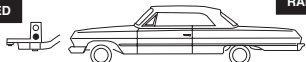

3

ENGINE AND AXLE ASSEMBLY

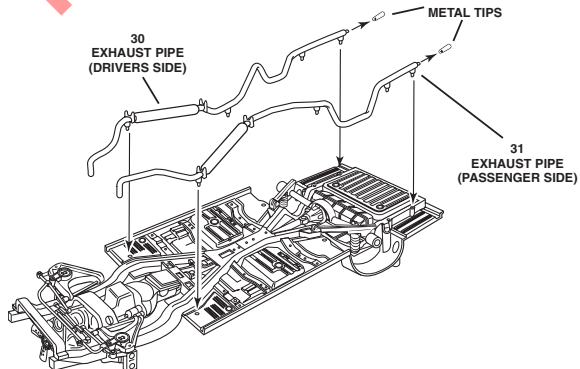
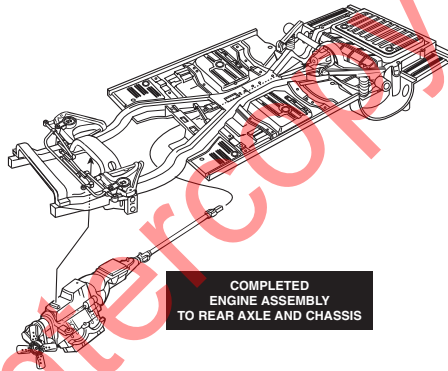
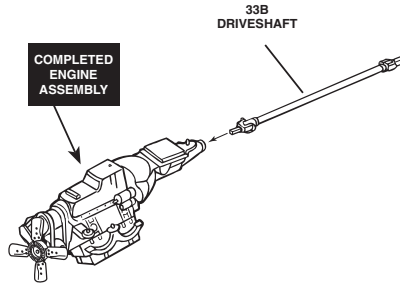

3

ENGINE AND AXLE ASSEMBLY CONTINUED

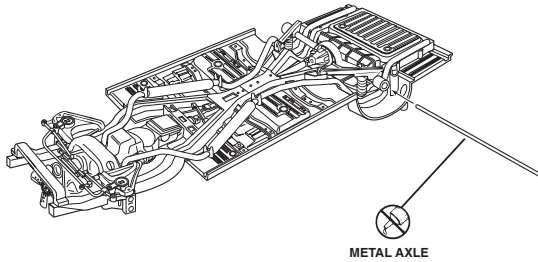

4

WHEEL ASSEMBLY

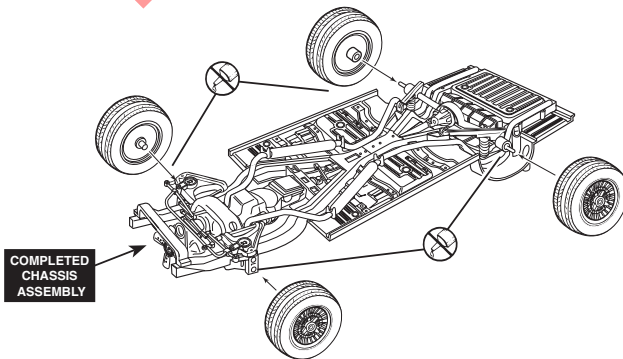
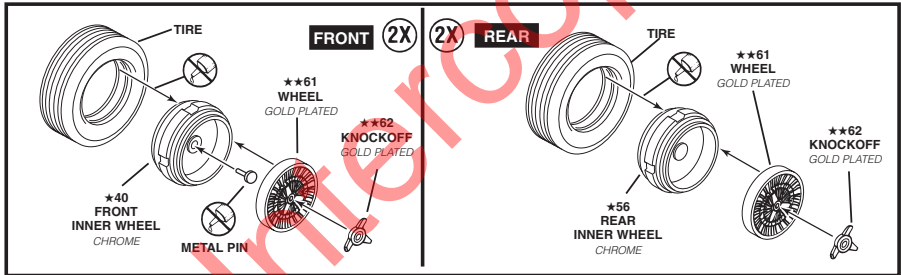

INTERIOR ASSEMBLY

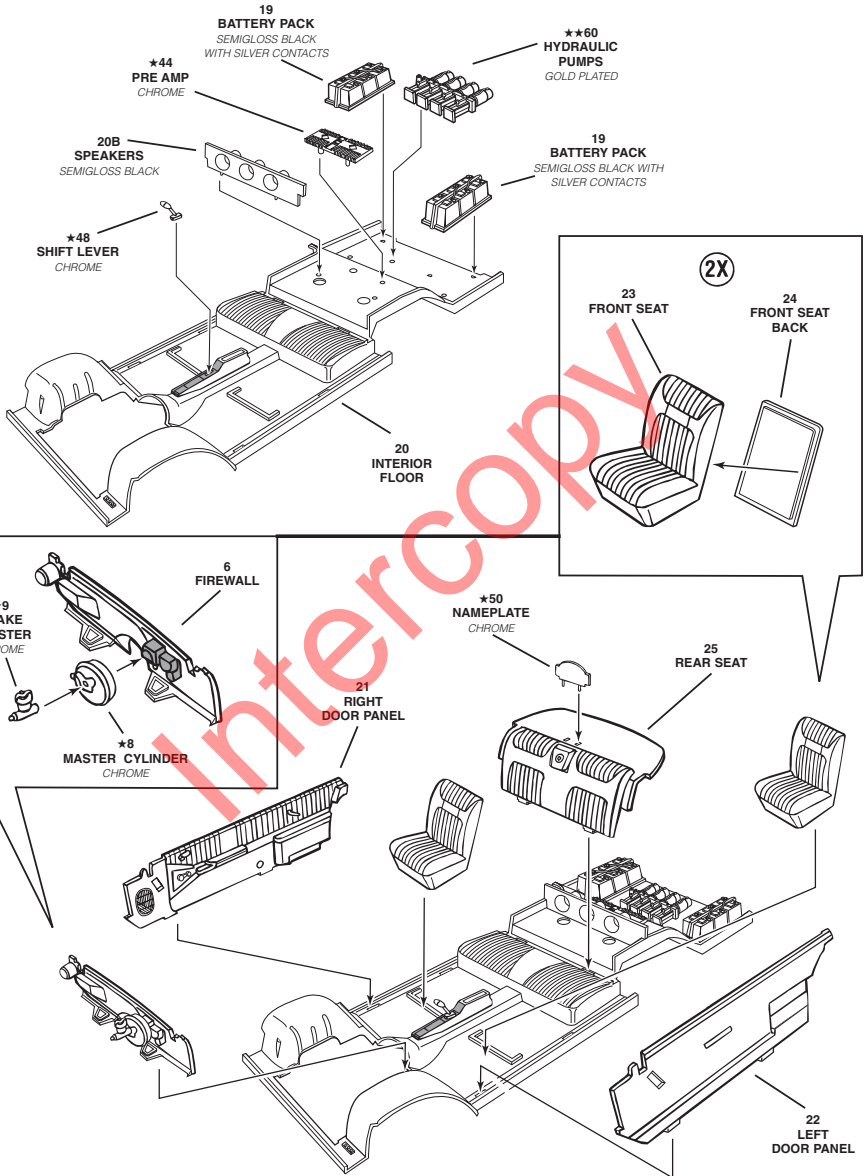

5

INTERIOR ASSEMBLY CONTINUED

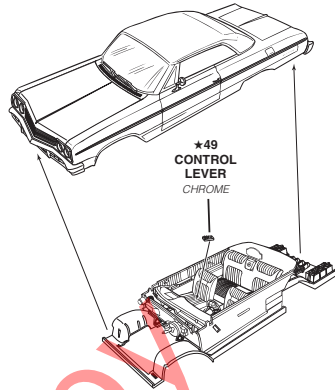
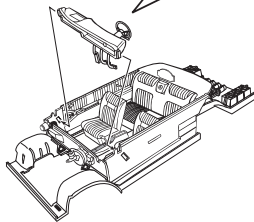
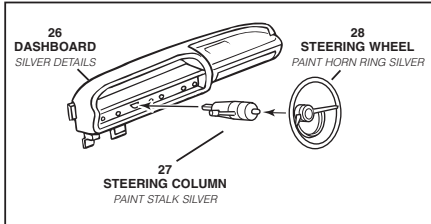

NOTE: THE CONTROL LEVER MAY BE GLUED TO A SEAT OR THE CONSOLE IN THE INTERIOR, OR A PIECE OF THREAD (NOT INCLUDED) MAY BE GLUED TO THE CONTROL LEVER AND UNDERNEATH THE DASH SO THE CONTROL LEVER CAN BE DISPLAYED OUTSIDE THE CAR.

6

RADIATOR ASSEMBLY

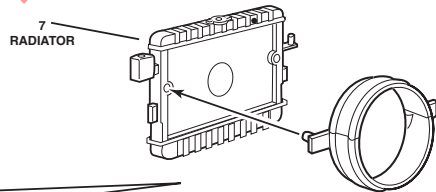
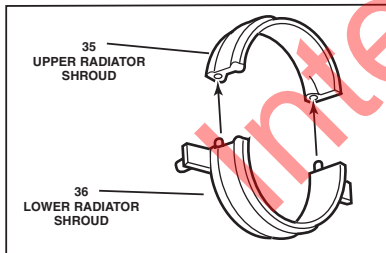

RADIATOR TO FRAME

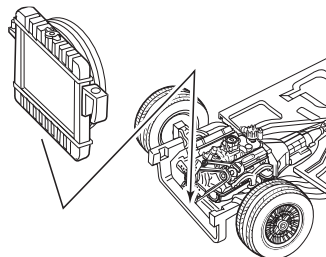

6

RADIATOR ASSEMBLY CONTINUED

BODY TO CHASSIS

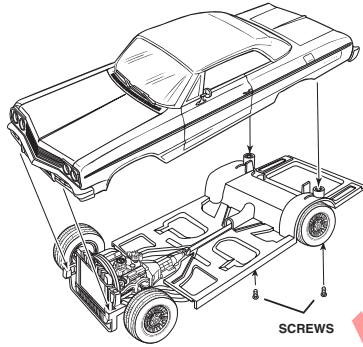

SCREWS

7

FINAL ASSEMBLY

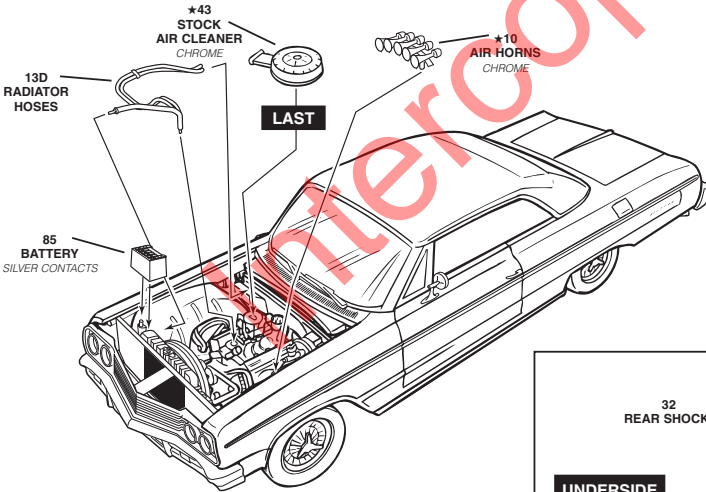

HOOD OMITTED FOR CLARITY

