



KIT 2191

85219100200

48 Jimmie Johnson™ Lowe's 2003 Monte Carlo™

Jimmie Johnson makes it look easy. There's no other way to put it. The ease with which this young man has made himself accustomed to the weekly battles in the high pressure world of NASCAR® Cup series racing is truly amazing. Of course, to have four-time Cup champion Jeff Gordon as both your car owner and mentor has an awful lot to do with it.

Unlike most of the competitors on the Cup circuit, Jimmie came up through the off-road racing series, clinching two Mickey Thompson Stadium Championships along the way. Moving into stock cars, Jimmie entered the ASA circuit, becoming series Rookie of the Year in 1998.

This success caught the eye of fellow California native Gordon, who was looking for a talented up-and-coming driver to drive for a new team he was putting together with Rick Hendrick. Jimmie answered that calling with rookie performances that no one had seen since, well, Jeff Gordon.

He stormed the Grand National division during that first year with six Top 10 finishes and a season ending tenth in the standings.

His first year in the Cup series, 2002, had more veteran observers shaking their heads in disbelief. Three wins, including both races at Dover, one of the toughest tracks on the circuit. Combine that with his 21 Top 10 finishes and it's easy to see why this rookie was actually in the hunt for the Championship at late as September.

2003 hasn't been much different, much to the dismay of the rest of the field. Three wins, 13 Top 10's, eight of those Top 5's, a pole position start...and the season is not even over. Suffice to say, it won't be long before Jimmie Johnson gets to add "NASCAR® Champion" next to his name.



*** REPEAT SEVERAL TIMES**
* A REPETER PLUSIEURS FOIS



*** OPTIONAL PARTS**
* PIECES EN OPTION



*** DECAL**
* DECAL COMANIE



*** ALTERNATIVE ASSEMBLY**
* ENSEMBLAGE ALTERNATIVE



*** CEMENT TOGETHER**
* A COLLER



*** REMOVE AND THROW AWAY**
* A RETIRER ET JETER



*** DO NOT CEMENT**
* NE PAS COLLER

READ THIS BEFORE YOU BEGIN

- * Study the assembly drawings.
- * Each plastic part is identified by a number.
- * In the assembly drawings, some parts will be marked by a star (★) to indicate chrome plated plastic.
- * For better paint and decal adhesion, wash the plastic parts in a mild detergent solution. Rinse and let air dry.
- * Check the fit of each piece before cementing in place.
- * Use only cement for polystyrene plastic.
- * Scrape plating and paint from areas to be cemented.
- * Allow paint to dry thoroughly before handling parts.
- * Any unused parts may be discarded.

DECAL APPLICATION INSTRUCTIONS

1. Cut desired decal from sheet.
2. Dip decal in water for a few seconds.
3. Place wet decal on paper towel.
4. Wait until decal is movable on paper backing.
5. Place decal in position on model, face up and slide backing away.
6. Press out air bubbles with a soft damp cloth.
7. Milkyness that may appear is for better decal adhesion and will dry clear. Wipe away any excess adhesive.
8. Do not touch decal until fully dry.
9. Allow the decals 48 hours to dry before applying clear coat.

NOTE: Decals are compatible with setting solutions or solvents.

LIRE CE QUI SUIT AVANT DE COMMENCER

- * Etudier les schémas de montage.
- * Chaque pièce en plastique est identifiée par un numéro.
- * Sur les schémas de montage, certaines pièces sont marquées d'une étoile (★) pour indiquer qu'elles sont en plastique chromé.
- * Pour une meilleure prise de la peinture et des autocollants, laver les pièces en plastique avec une solution détergente peu concentrée. Les rincer et les laisser sécher à l'air.
- * Vérifier que chaque pièce s'ajuste bien avant de la coller en place.
- * N'utiliser que de la colle pour polystyrène.
- * Gratter les parties à coller pour enlever le chrome et la peinture.
- * Laisser la peinture bien sécher avant de manipuler les pièces.
- * Toute pièce inutilisée peut être jetée.

DIRECTIVES D'APPLICATION DES AUTOCOLLANTS

1. Découper l'autocollant désiré de la feuille.
2. Tremper l'autocollant dans de l'eau pendant quelques secondes.
3. Placer l'autocollant mouillé sur une serviette en papier.
4. Attendez que l'autocollant puisse être déplacé sur son support en papier.
5. Mettre l'autocollant en position sur le modèle face sur le dessus et faire glisser le support pour l'enlever.
6. Appuyer avec un chiffon doux humide pour éliminer les bulles d'air.
7. La substance laiteuse qui peut apparaître est destinée à améliorer l'adhésion de l'autocollant et devient incolore au séchage. Essuyer pour enlever tout excédent d'adhésif.
8. Ne pas toucher l'autocollant tant qu'il n'est pas bien sec.
9. Laisser l'autocollant sécher pendant 48 heures avant d'appliquer une couche transparente.

REMARQUE: Les autocollants sont compatibles avec les solutions de fixation ou les solvants.

This paint guide is provided to complete this kit as shown on the box.

Ce guide de peinture est fourni pour reproduire le modèle réduit qui apparaît sur la boîte.

Aluminum	Aluminium
Flat Black	Noir mat
Flat White	Blanc mat
Gloss Dark Blue	Bleu foncé brillant
Gloss Gray	Gris brillant
Gloss Red	Rouge brillant
Gunmetal	Bronze
Jet Exhaust	Flux d'éjection
Semigloss Black	Noir satiné
Silver	Argent

If you have any questions or comments, call our hotline at: **(800) 833-3570** or, please write to:

Revell-Monogram Consumer Service Department, 725 Landwehr, Northbrook, Illinois 60062

Be sure to include the plan number (85219100200), part number, description, your return address and phone number.

Visit our website: www.revell-monogram.com

1

ENGINE ASSEMBLY

A

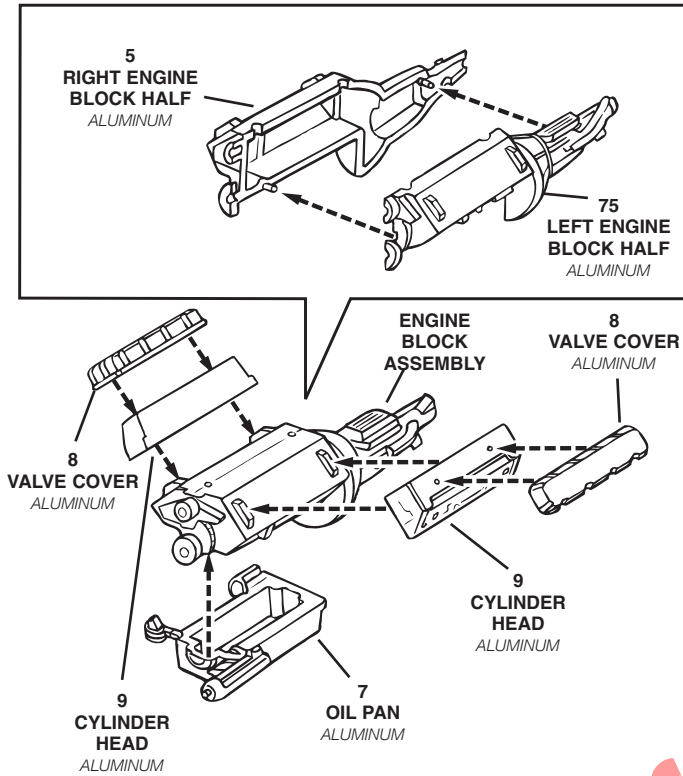

B

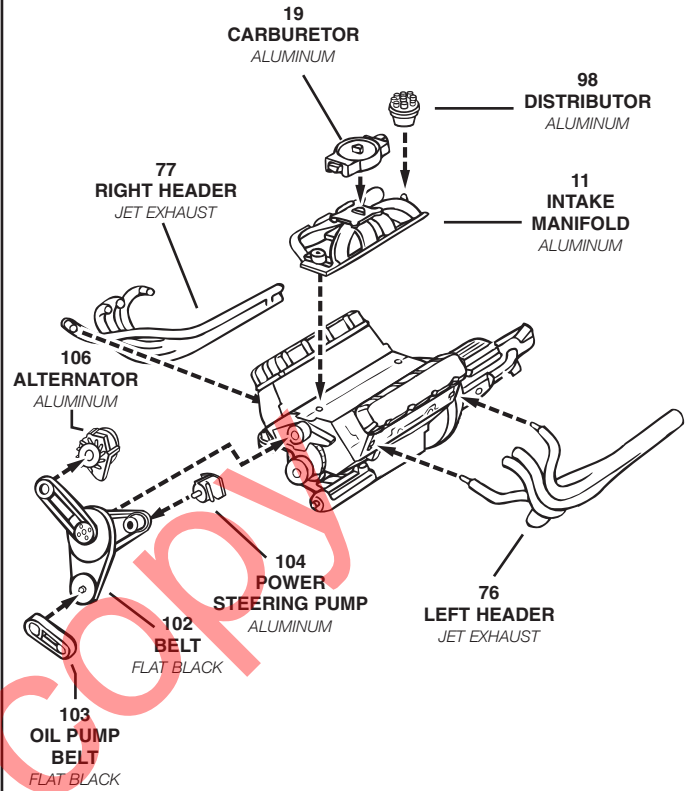

2

CHASSIS ASSEMBLY

A

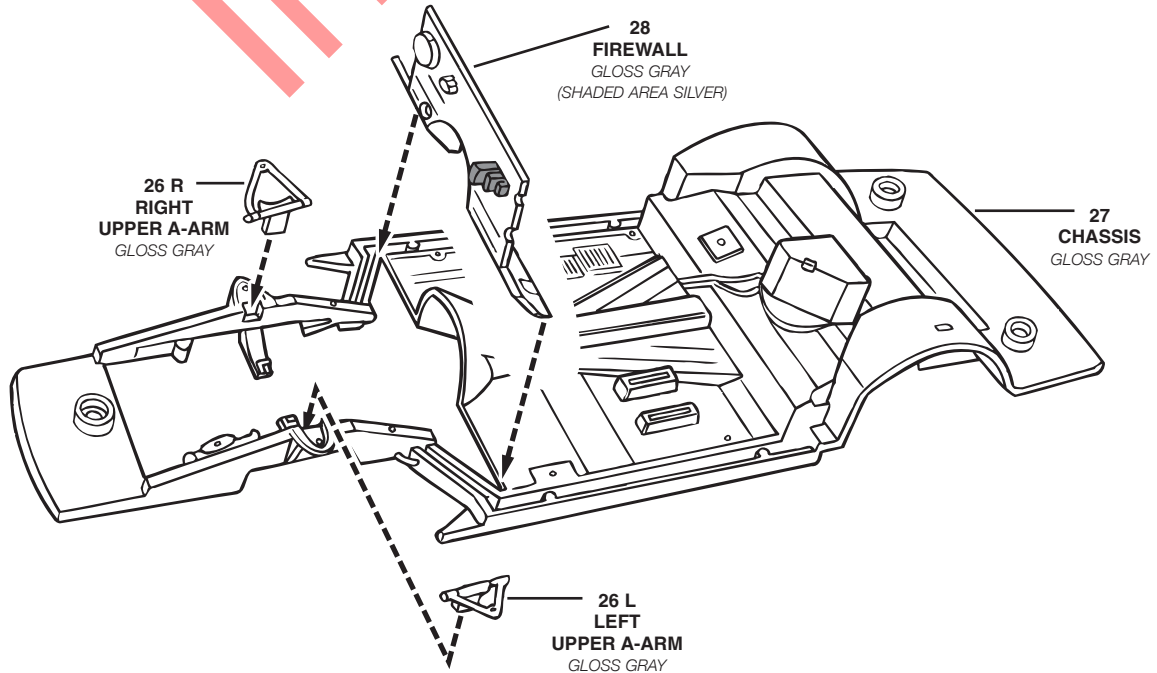

B

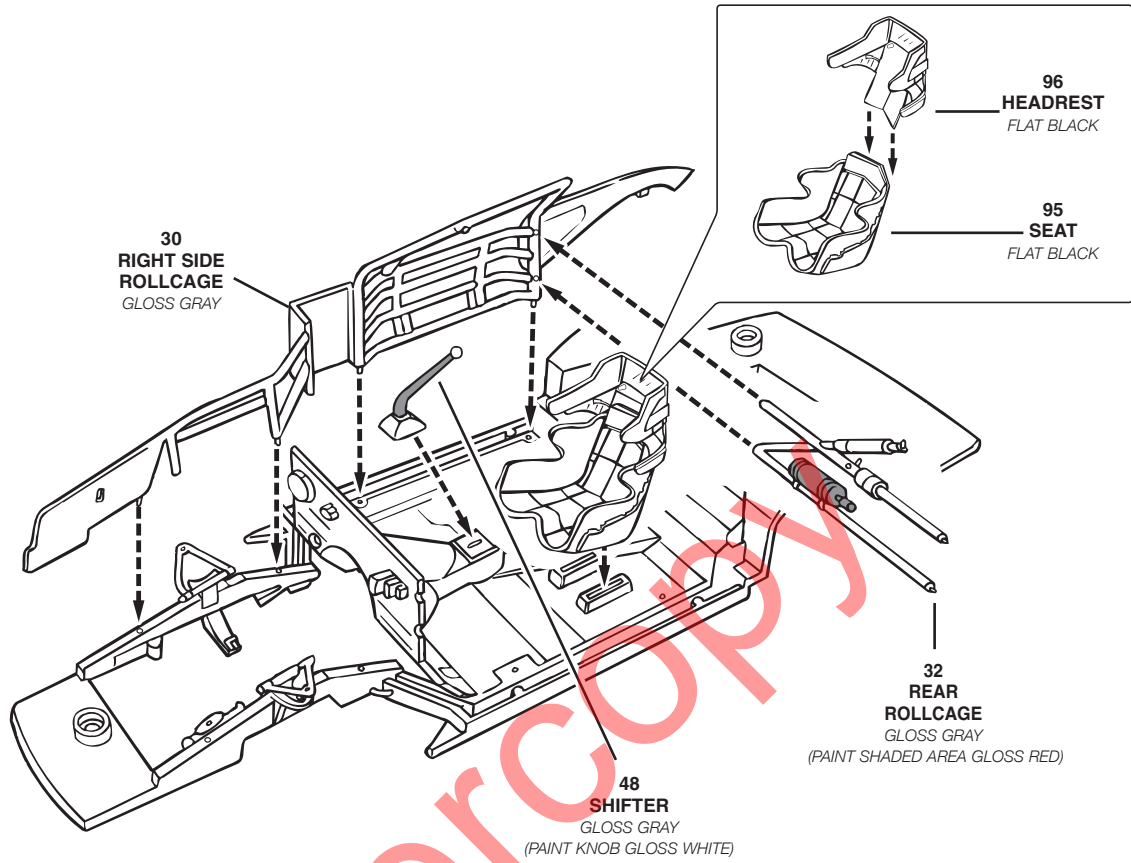

C

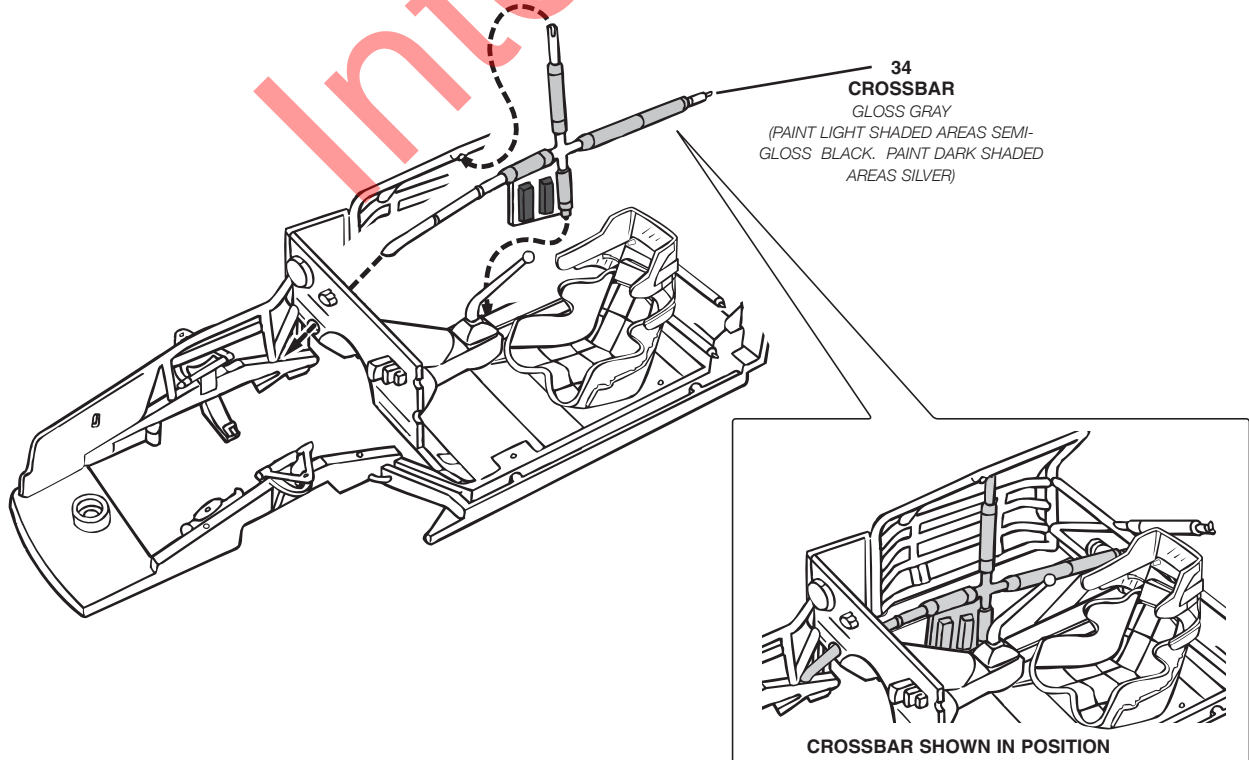

D

NOTE: DRIVER DECALS MUST BE APPLIED BEFORE CEMENTING FIGURE TO CHASSIS

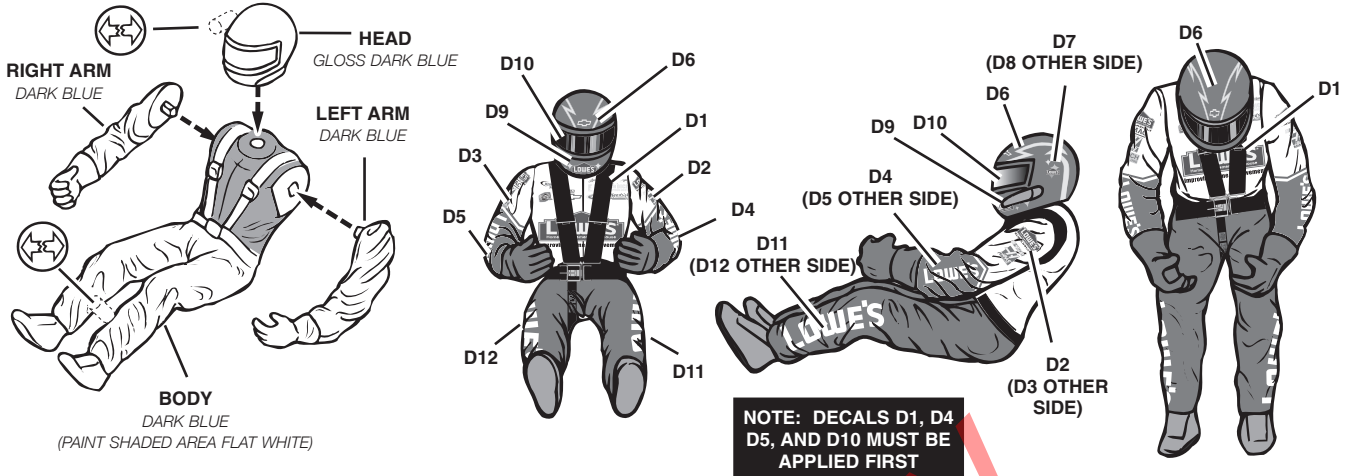

E

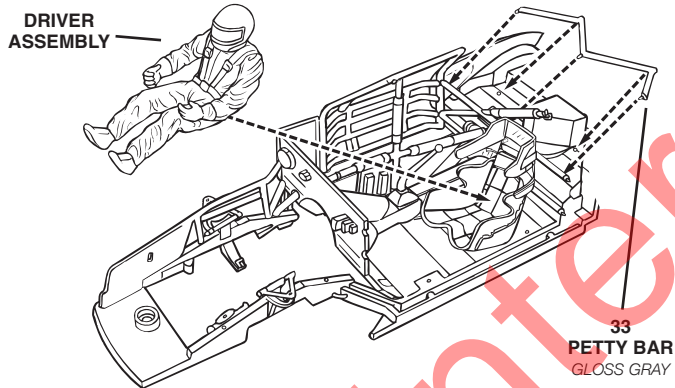

F

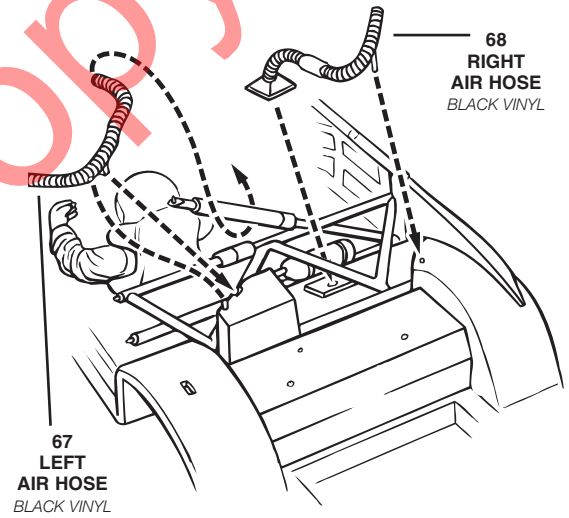

G

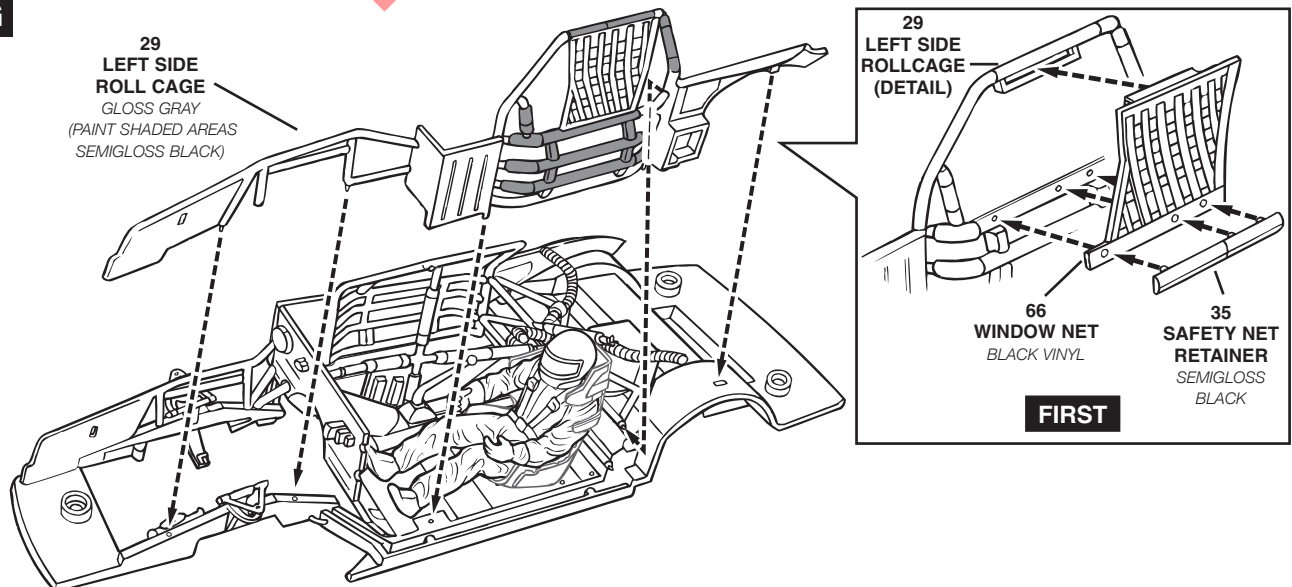

2

CHASSIS ASSEMBLY CONTINUED

H

41 ROLLCAGE TOP (DETAIL)
GLOSS GRAY

45 REAR VIEW MIRROR

41 ROLLCAGE TOP
(PAINT SHADED AREA SEMIGLOSS BLACK)

52 DASHBOARD
FLAT BLACK
(PAINT SWITCHES AND DETAILS SILVER)

59 STEERING WHEEL
(PAINT SHADED AREA ALUMINUM)

NOTE: CUT INSTRUMENT PANEL OFF SHEET AND GLUE TO BACK SIDE OF DASHBOARD USING

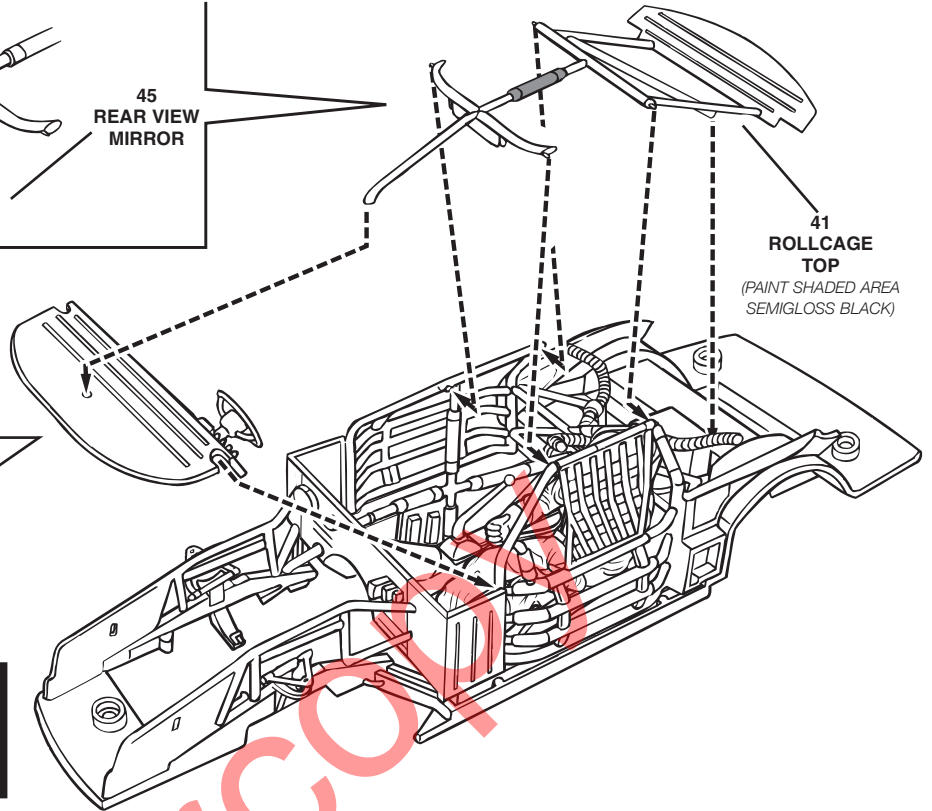

3

REAR SUSPENSION ASSEMBLY

A

92 REAR SPRINGS
ALUMINUM

12 REAR SHOCKS
DARK GRAY

39 OIL TANK
DARK GRAY

CHASSIS ASSEMBLY

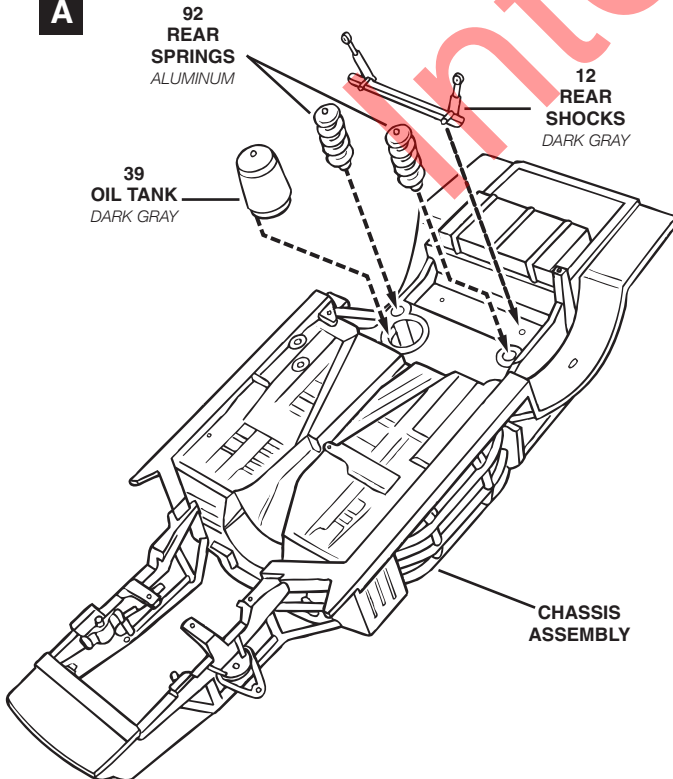

B

89 PUMP
GUNMETAL

47 PANHARD BAR
GUNMETAL

86 PUMPKIN
GUNMETAL

105 BELT
FLAT BLACK

85 REAR SUSPENSION
FLAT BLACK

87 DRIVESHAFT
GUNMETAL

CHASSIS ASSEMBLY

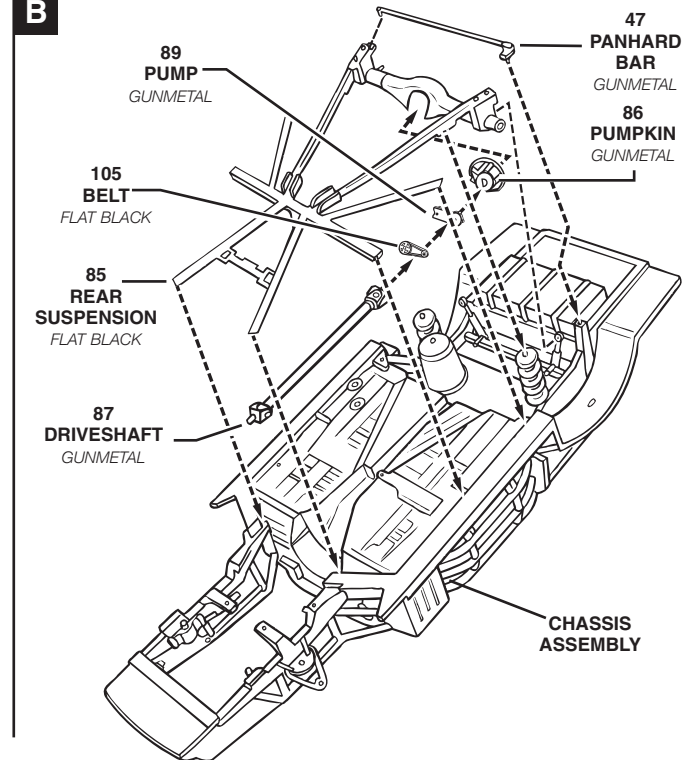

4

DRIVETRAIN ASSEMBLY

A

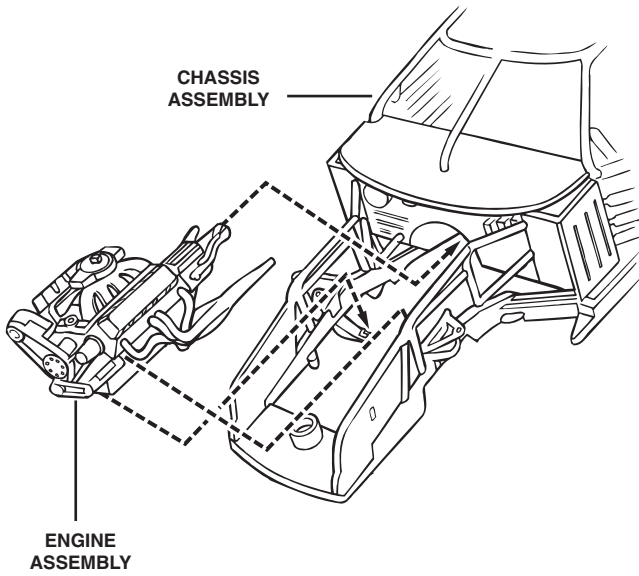

B

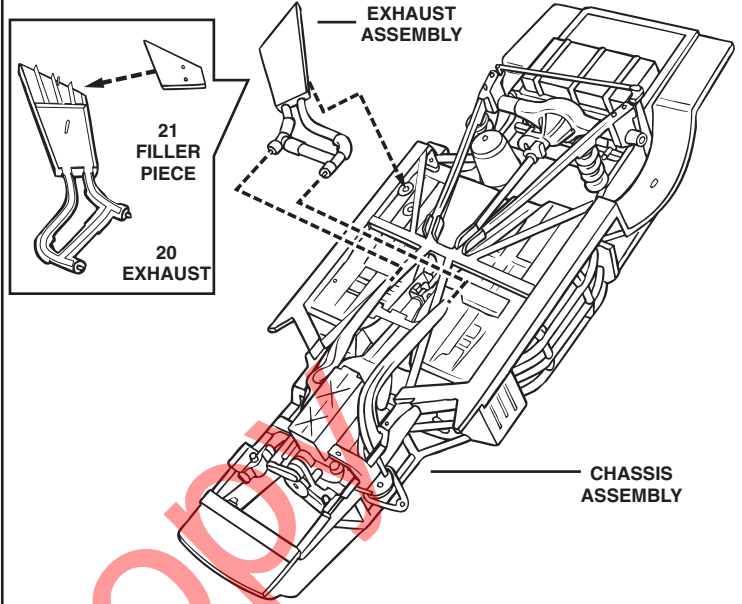

5

FRONT END ASSEMBLY

A

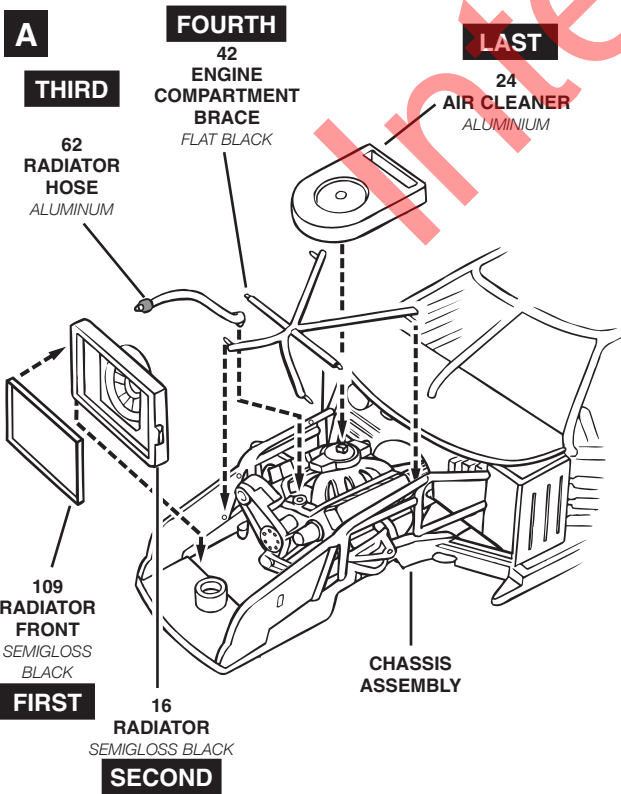

B

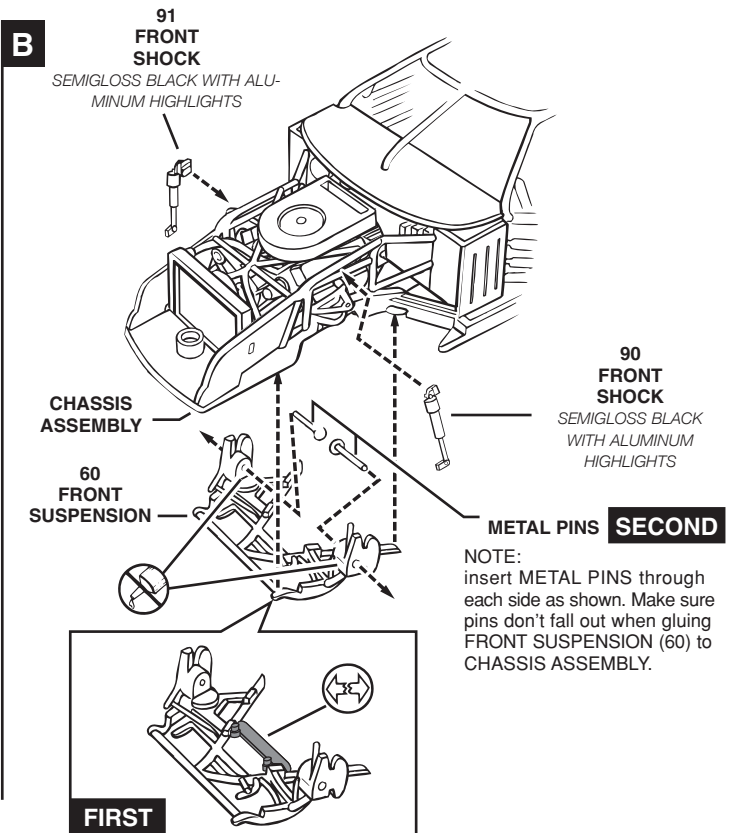

6

FINAL ASSEMBLY

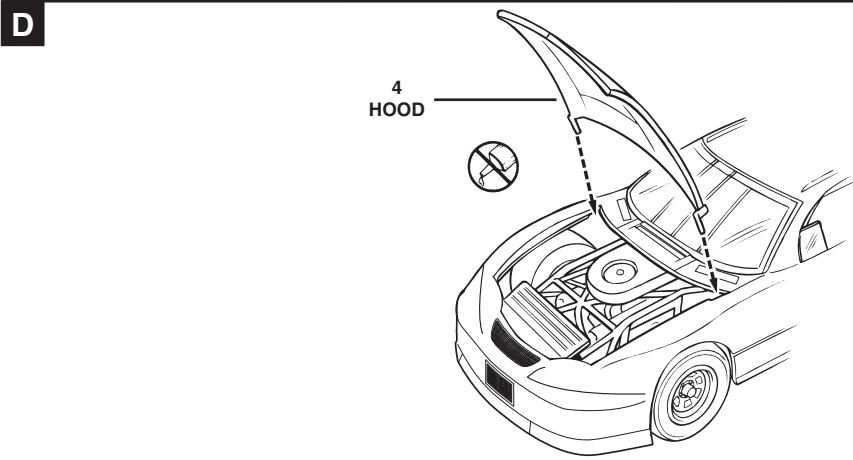
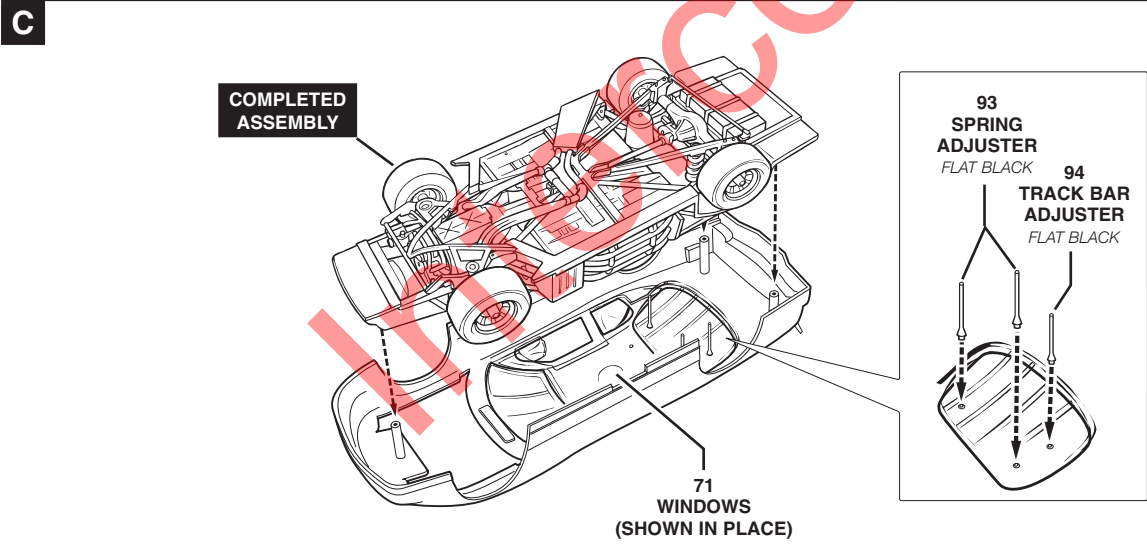
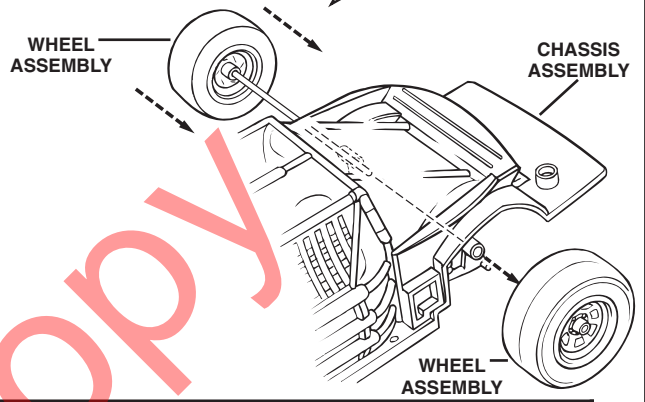
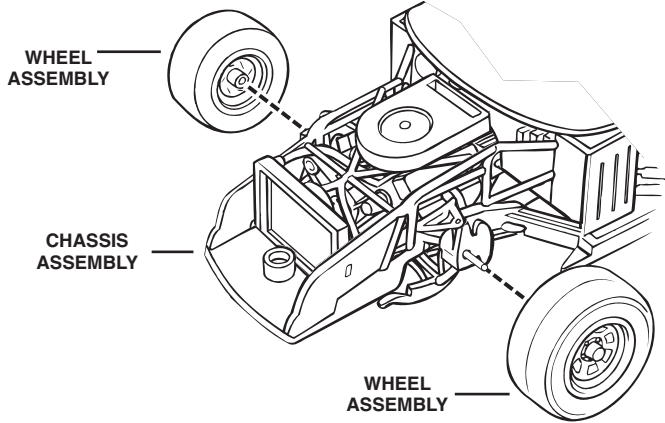
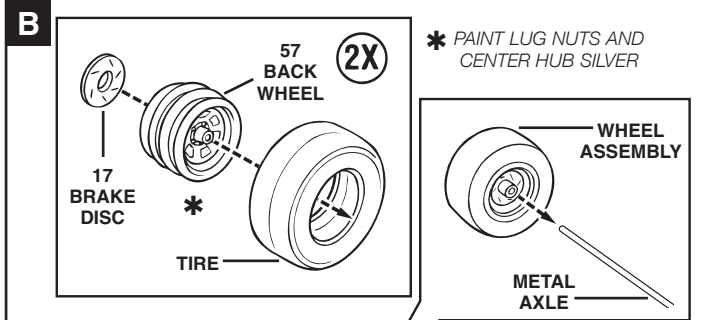
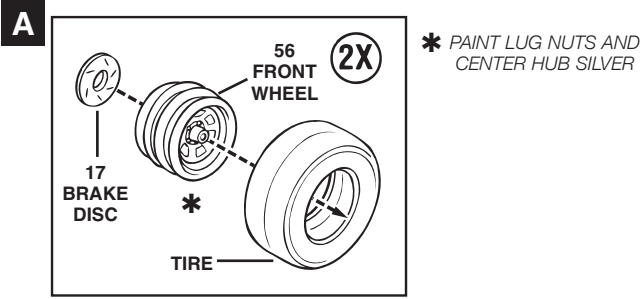

DECAL PLACEMENT

DECALS 1, 2, 13, 14, 19, 20, 32 AND 33 MUST BE APPLIED FIRST

