



KIT 2194



Kevin Harvick™
GM Goodwrench
2003 Monte Carlo™

85219400200

Like many of the new breed of "young guns" that have been a major force in NASCAR® competition, Kevin Harvick started out his racing career at a very young age. Kindergarten, to be exact. Hard to believe, but at the age of 5, when most kids that age are learning how to mix primary colors to make a new color, Kevin was learning how to hit an apex in the corner in order to pass the kid in front of you. Of course, Kevin was piloting a go-cart at the time, but when a kid that young nails 7 driving titles including 2 Grand National carting championships, it would be safe to say there's a prodigy in the making.

But then, kids grow up and get involved in other things, as they say. Not Kevin. Spending a good amount of his formative years strapped into a racing seat, Kevin tore through the various smaller NASCAR® racing series winning a Late Model series title in 1993, a Southwest series title in 1995 and a West series title in 1998.

After spending some time competing in the Craftsman Truck series and but not finding a lot of success, Kevin moved up to the Grand National series. Better make that "stormed through"

the series as in 2000, his first full year in the series, Kevin notched three wins, winding up third in the final point standings for the year and clinching Rookie of the Year honors to boot.

The 2001 season was a bit more difficult. Kevin was going for the Grand National series title when tragic circumstances occurred at the end of the 2001 Daytona 500, opening up the #3 Goodwrench ride. With all the experienced Cup drivers firmly locked up with their respective teams, owner Richard Childress turned to Kevin to fill in while the team regrouped. With the car number now changed to 29, Kevin not only just filled the seat but also won just the third Cup race he was entered in. If that wasn't enough, Kevin effectively competed in both series at the same time, gaining another win in the Cup car and finishing in the Top 10 in points for the year AND winning the Grand National championship.

With the ride his own now, Kevin has shown he can put up a fierce battle both on and off the track. After winning almost everything he has put his hands on, the final prize-a Cup Championship, can't be far behind.



* REPEAT SEVERAL TIMES
* A REPETER PLUSIEURS FOIS



* OPTIONAL PARTS
* PIECES EN OPTION



* DECAL
* DECAL COMANIE



* ALTERNATIVE ASSEMBLY
* ENSEMBLAGE ALTERNATIVE



* CEMENT TOGETHER
* A COLLER



* REMOVE AND THROW AWAY
* A RETIRER ET JETER



* DO NOT CEMENT
* NE PAS COLLER

READ THIS BEFORE YOU BEGIN

- * Study the assembly drawings.
- * Each plastic part is identified by a number.
- * In the assembly drawings, some parts will be marked by a star (★) to indicate chrome plated plastic.
- * For better paint and decal adhesion, wash the plastic parts in a mild detergent solution. Rinse and let air dry.
- * Check the fit of each piece before cementing in place.
- * Use only cement for polystyrene plastic.
- * Scrape plating and paint from areas to be cemented.
- * Allow paint to dry thoroughly before handling parts.
- * Any unused parts may be discarded.

DECAL APPLICATION INSTRUCTIONS

1. Cut desired decal from sheet.
2. Dip decal in water for a few seconds.
3. Place wet decal on paper towel.
4. Wait until decal is movable on paper backing.
5. Place decal in position on model, face up and slide backing away.
6. Press out air bubbles with a soft damp cloth.
7. Milkiness that may appear is for better decal adhesion and will dry clear. Wipe away any excess adhesive.
8. Do not touch decal until fully dry.
9. Allow the decals 48 hours to dry before applying clear coat.

NOTE: Decals are compatible with setting solutions or solvents.

LIRE CE QUI SUIT AVANT DE COMMENCER

- * Etudier les schémas de montage.
- * Chaque pièce en plastique est identifiée par un numéro.
- * Sur les schémas de montage, certaines pièces sont marquées d'une étoile (★) pour indiquer qu'elles sont en plastique chromé.
- * Pour une meilleure prise de la peinture et des autocollants, laver les pièces en plastique avec une solution détergente peu concentrée. Les rincer et les laisser sécher à l'air.
- * Vérifier que chaque pièce s'ajuste bien avant de la coller en place.
- * N'utiliser que de la colle pour polystyrène.
- * Gratter les parties à coller pour enlever le chrome et la peinture.
- * Laisser la peinture bien sécher avant de manipuler les pièces.
- * Toute pièce inutilisée peut être jetée.

DIRECTIVES D'APPLICATION DES AUTOCOLLANTS

1. Découper l'autocollant désiré de la feuille.
2. Tremper l'autocollant dans de l'eau pendant quelques secondes.
3. Placer l'autocollant mouillé sur une serviette en papier.
4. Attendez que l'autocollant puisse être déplacé sur son support en papier.
5. Mettre l'autocollant en position sur le modèle face sur le dessus et faire glisser le support pour l'enlever.
6. Appuyer avec un chiffon doux humide pour éliminer les bulles d'air.
7. La substance laiteuse qui peut apparaître est destinée à améliorer l'adhésion de l'autocollant et devient incolore au séchage. Essuyer pour enlever tout excédent d'adhésif.
8. Ne pas toucher l'autocollant tant qu'il n'est pas bien sec.
9. Laisser l'autocollant sécher pendant 48 heures avant d'appliquer une couche transparente.

REMARQUE: Les autocollants sont compatibles avec les solutions de fixation ou les solvants.

This paint guide is provided to complete this kit as shown on the box.

Ce guide de peinture est fourni pour reproduire le modèle réduit qui apparaît sur la boîte.

| | |
|-------------------|-------------------|
| Aluminum | Aluminium |
| Burnt Iron | Fer brûlé |
| Flat Dark Magenta | Magenta foncé mat |
| Flat Black | Noir mat |
| Gloss Black | Noir lustré |
| Gloss Red | Rouge lustré |
| Satin Light Gray | Gris clair satiné |
| Satin White | Blanc satiné |
| Semigloss Black | Noir satiné |
| Silver Metallic | Argent métallisé |
| Steel | Acier |

If you have any questions or comments, call our hotline at: **(800) 833-3570** or, please write to:

Revell-Monogram Consumer Service Department, 725 Landwehr Road, Northbrook, Illinois 60062

Be sure to include the plan number (85219400200), part number, description, your return address and phone number.

Visit our website: www.revell-monogram.com

1

ENGINE ASSEMBLY

A

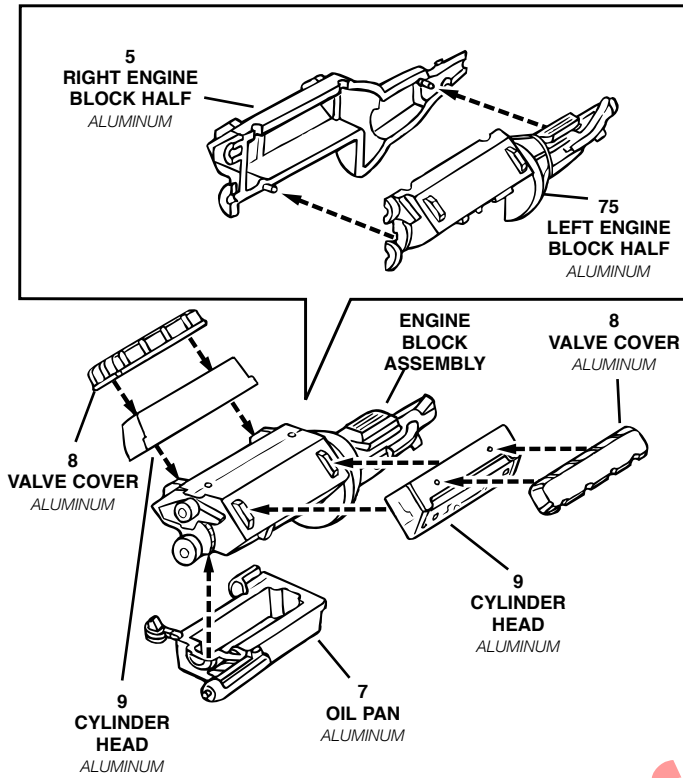

B

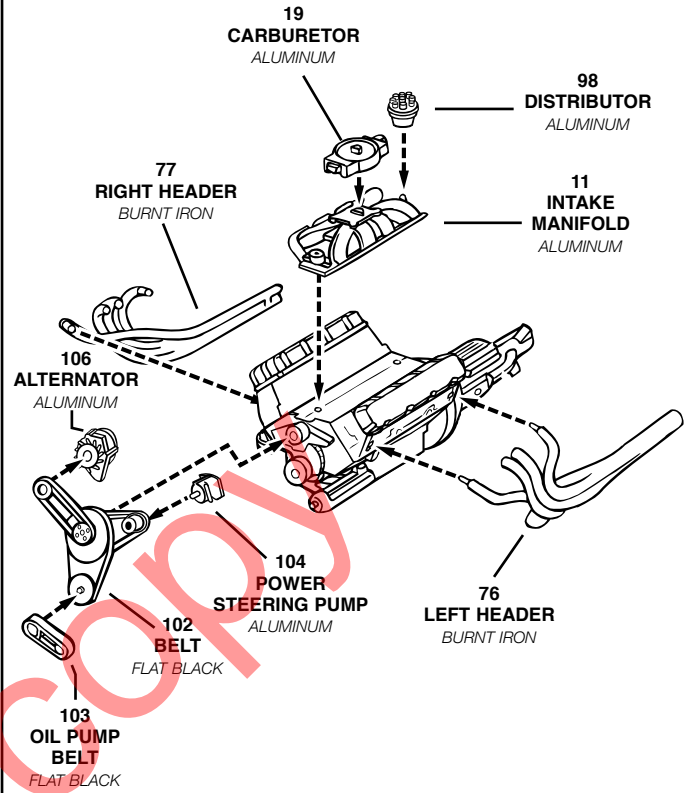

2

CHASSIS ASSEMBLY

A

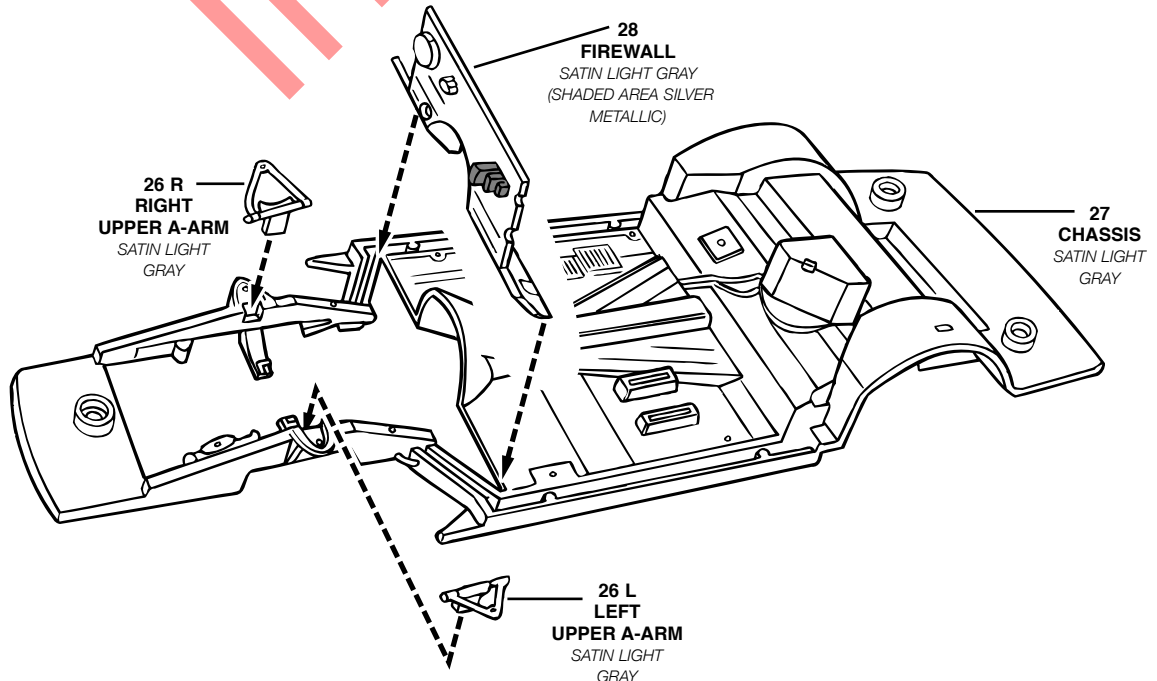

B

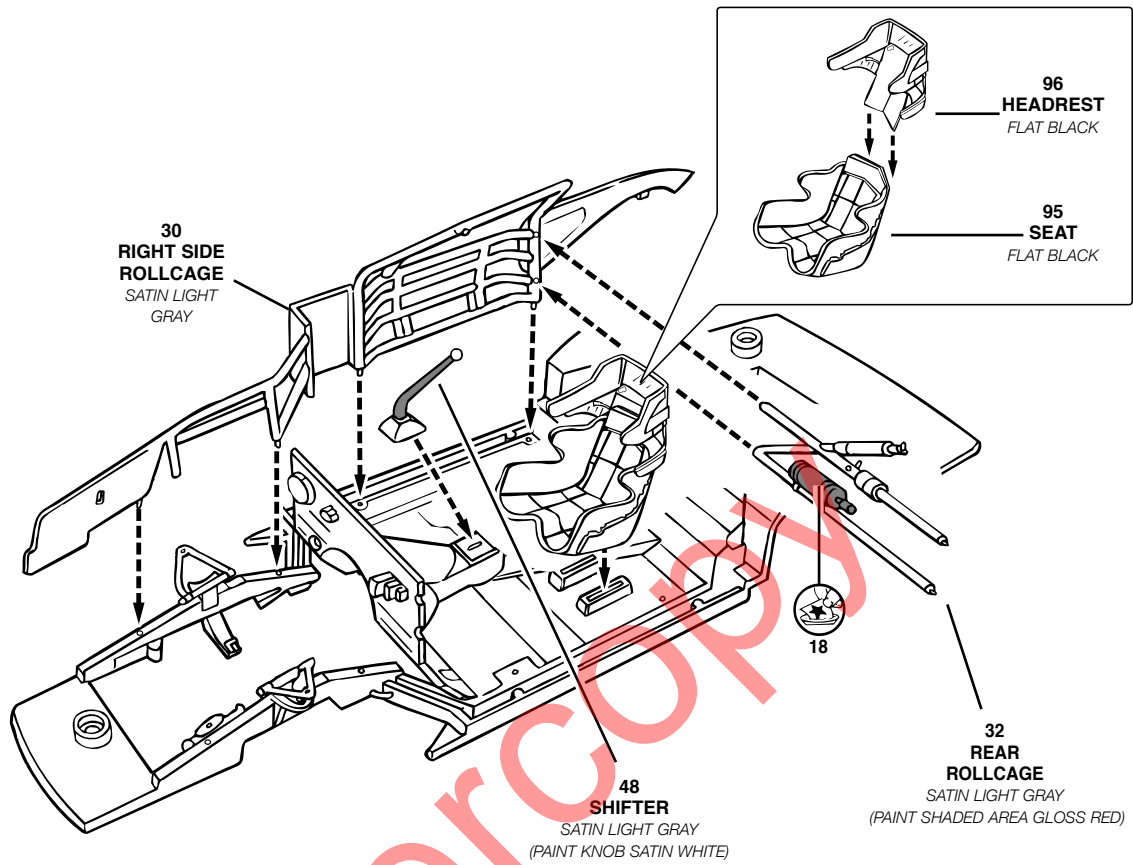

C

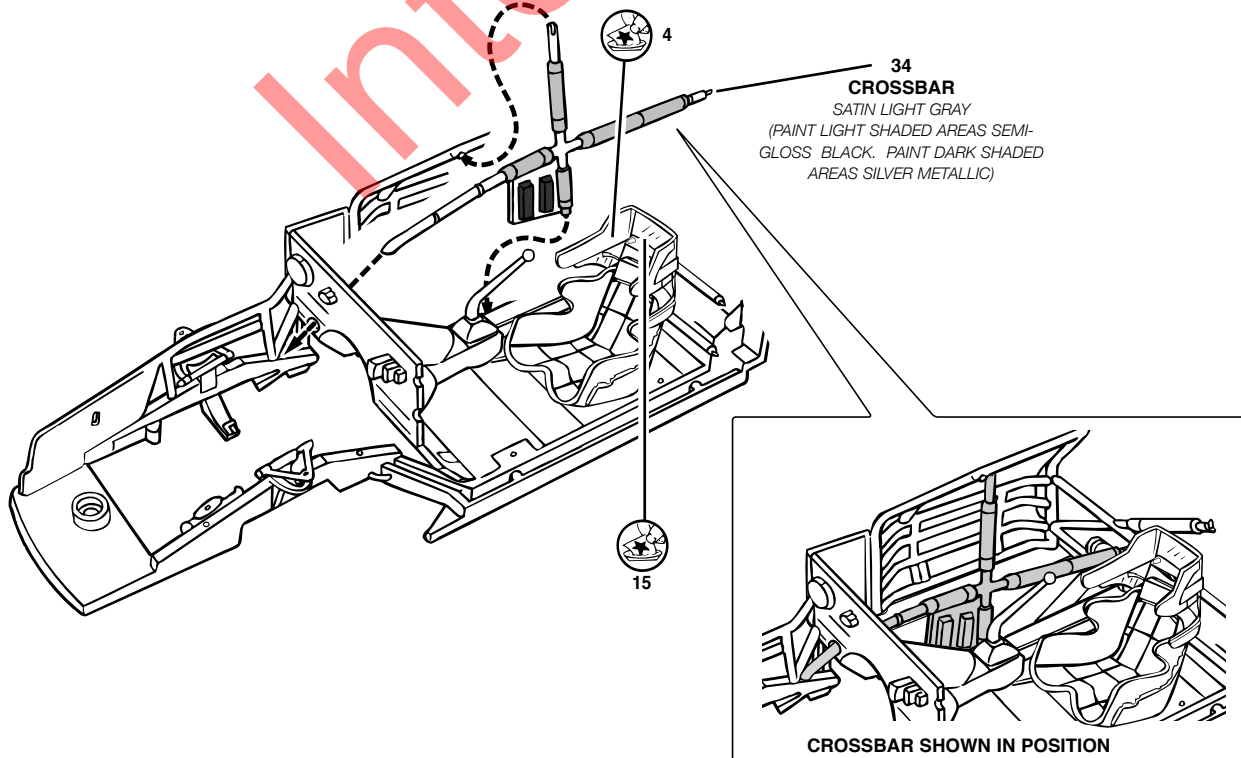

D

NOTE: DRIVER DECALS MUST BE APPLIED BEFORE CEMENTING FIGURE TO CHASSIS

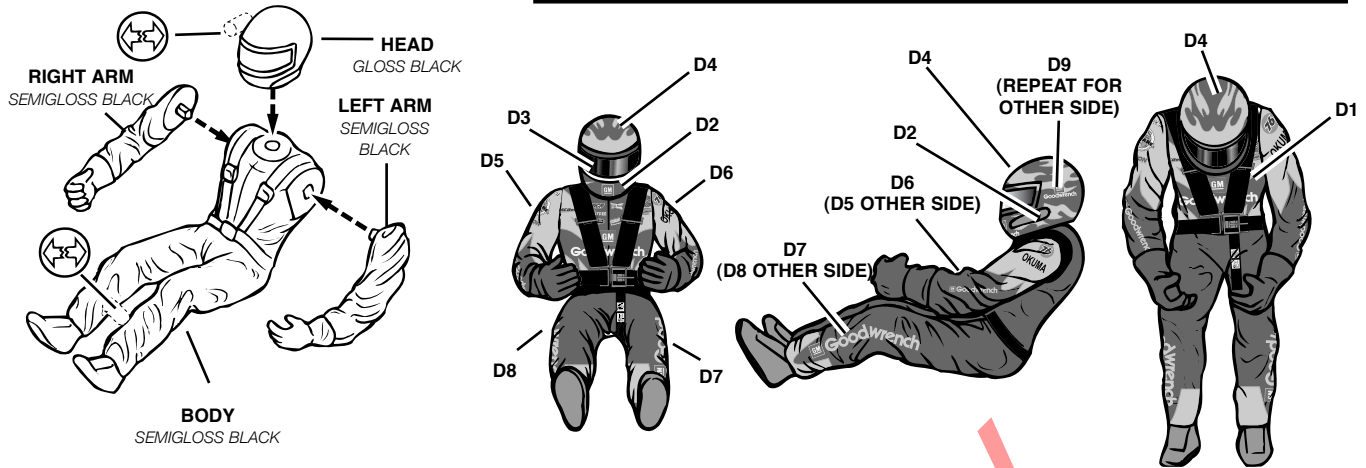

E

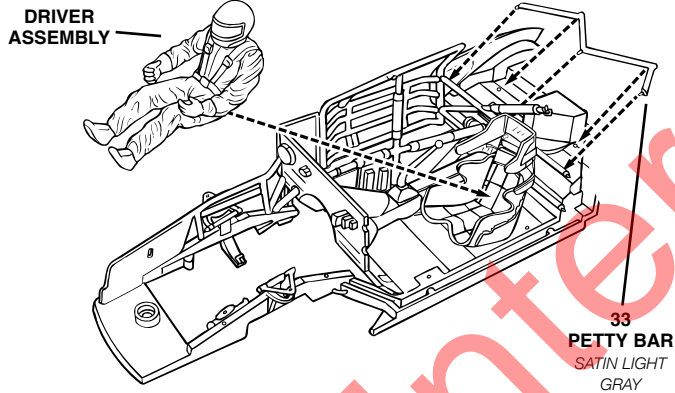

F

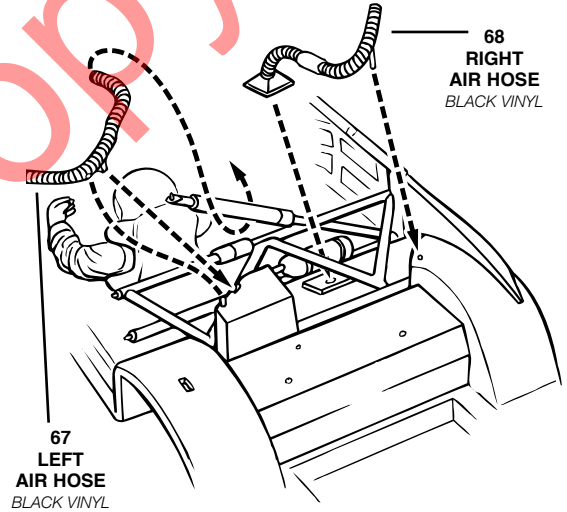

G

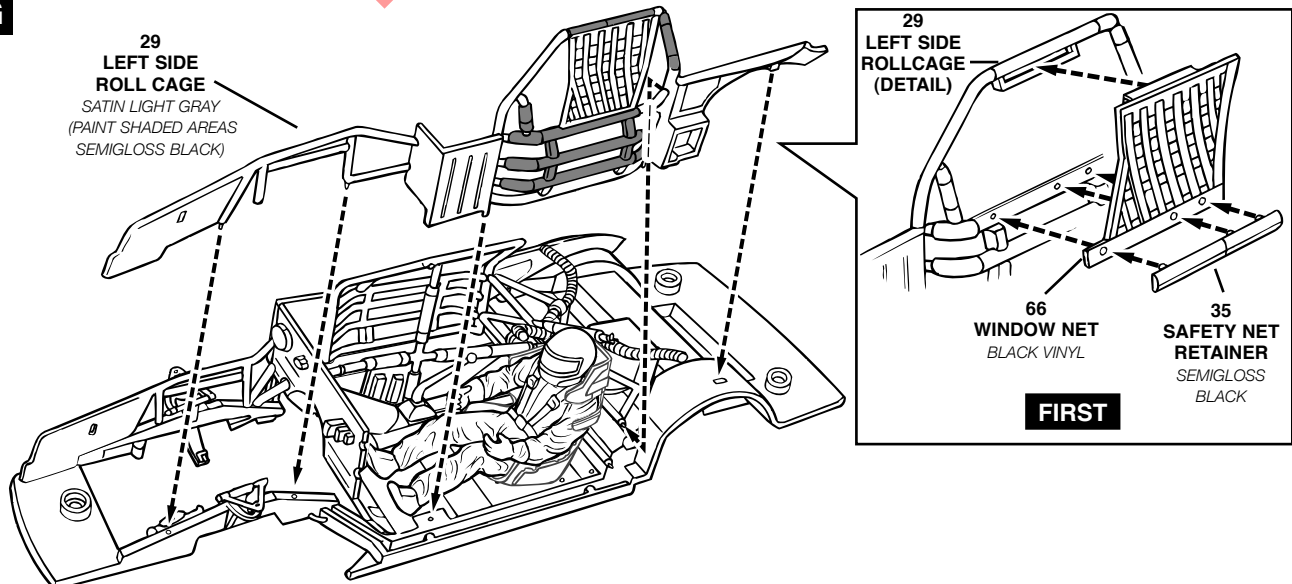

2

CHASSIS ASSEMBLY CONTINUED

H

41
ROLLCAGE
TOP
(DETAIL)
SATIN LIGHT
GRAY

45
REAR VIEW
MIRROR

41
ROLLCAGE
TOP
(PAINT SHADED AREA
SEMIGLOSS BLACK)

52
DASHBOARD
FLAT BLACK
(PAINT SWITCHES AND
DETAILS SILVER METALLIC)

59
STEERING
WHEEL
(PAINT SHADED
AREA ALUMINUM)

NOTE: CUT INSTRUMENT
PANEL OFF SHEET AND GLUE
TO BACK SIDE OF
DASHBOARD USING

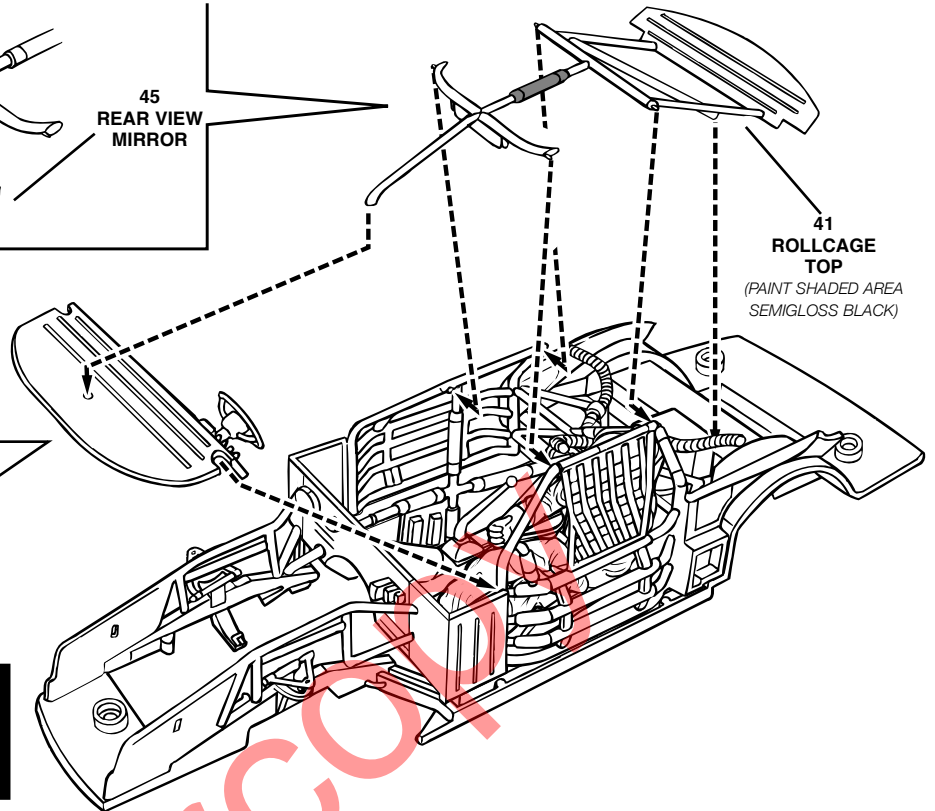

3

REAR SUSPENSION ASSEMBLY

A

92
REAR
SPRINGS
ALUMINUM

12
REAR
SHOCKS
STEEL

39
OIL TANK
STEEL

CHASSIS
ASSEMBLY

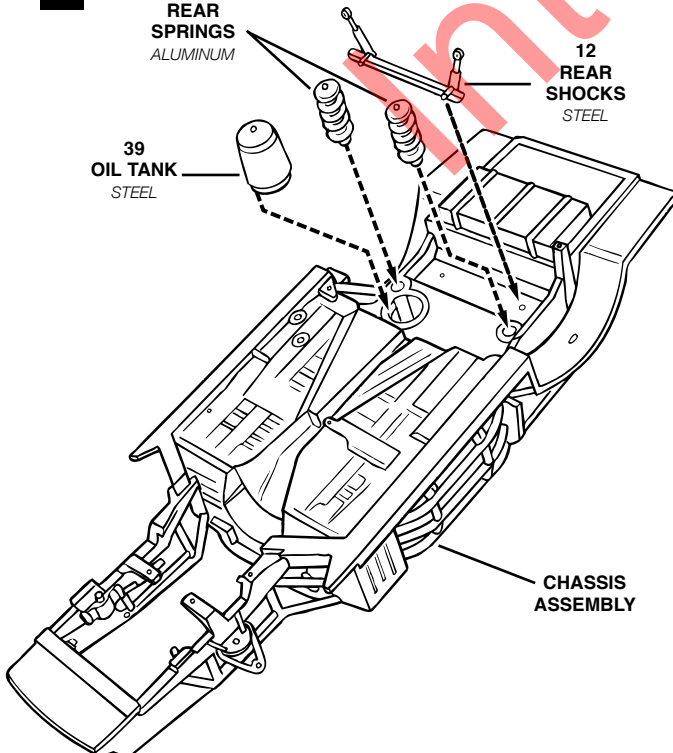

B

89
PUMP
STEEL

47
PANHARD
BAR
STEEL
86
PUMPKIN
STEEL

105
BELT
FLAT BLACK

85
REAR
SUSPENSION
FLAT BLACK

87
DRIVESHAFT
STEEL

CHASSIS
ASSEMBLY

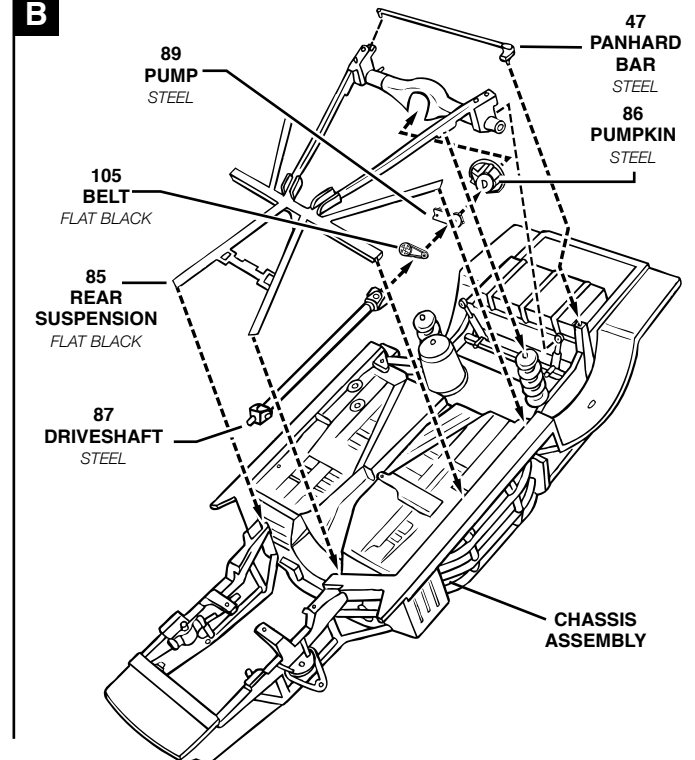

4

DRIVETRAIN ASSEMBLY

A

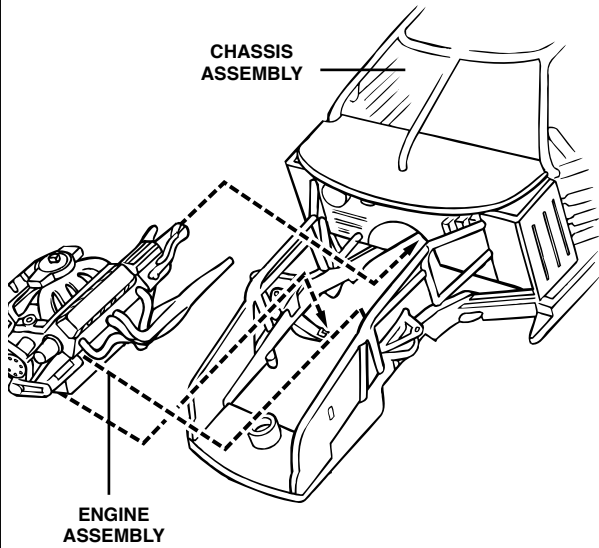

B

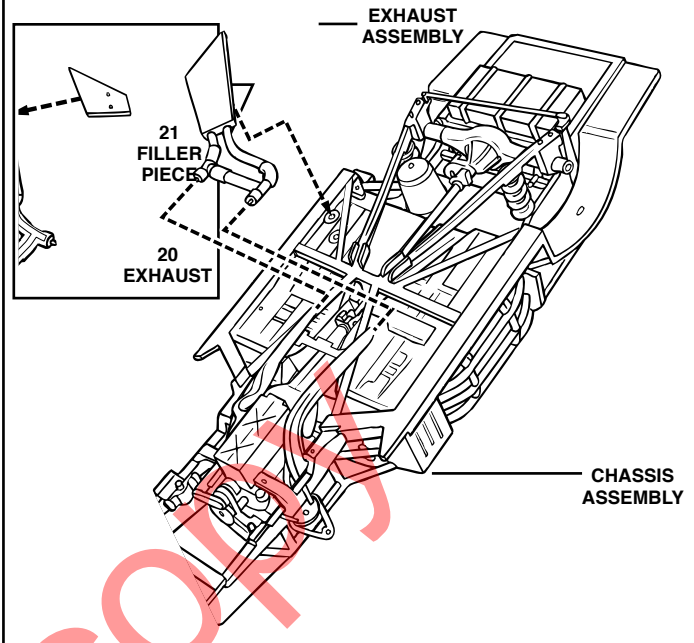

5

FRONT END ASSEMBLY

A

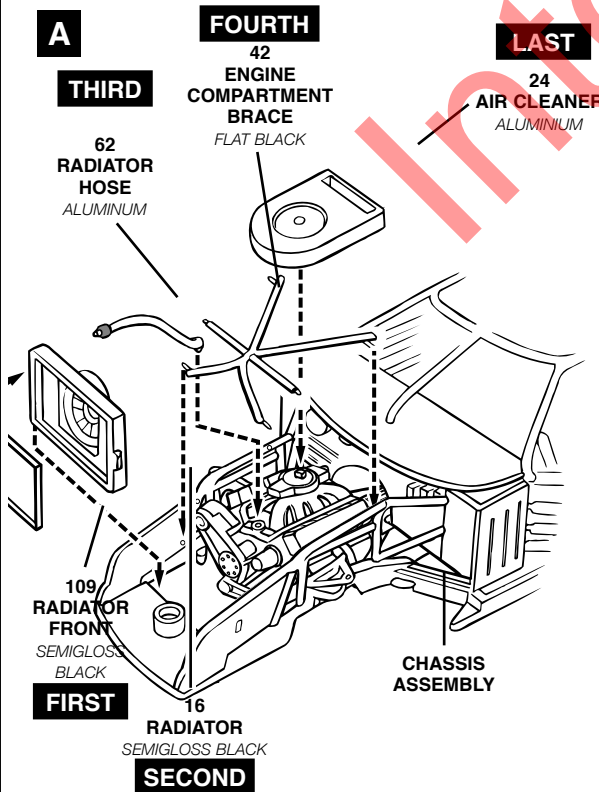

B

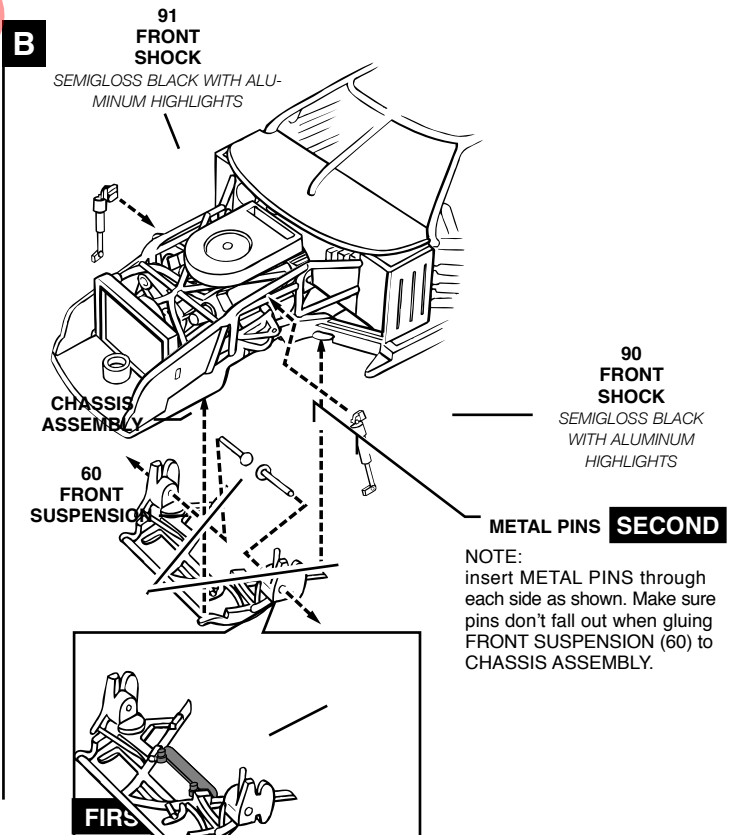

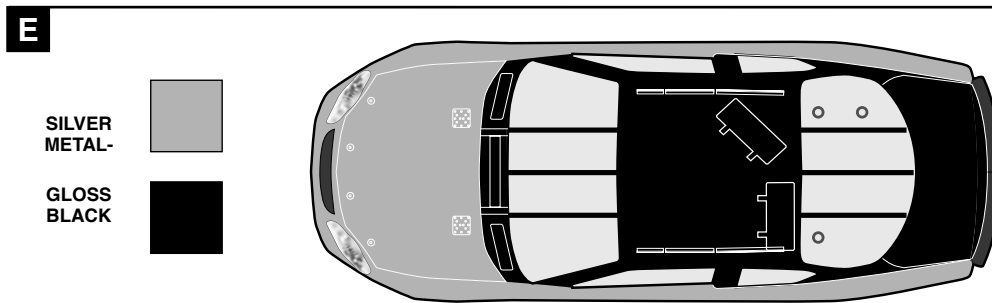
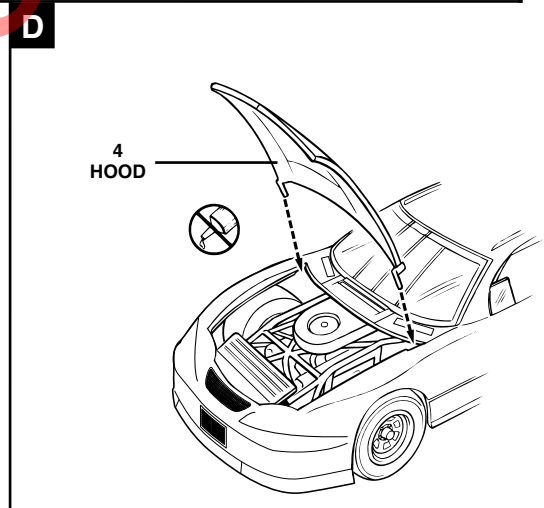
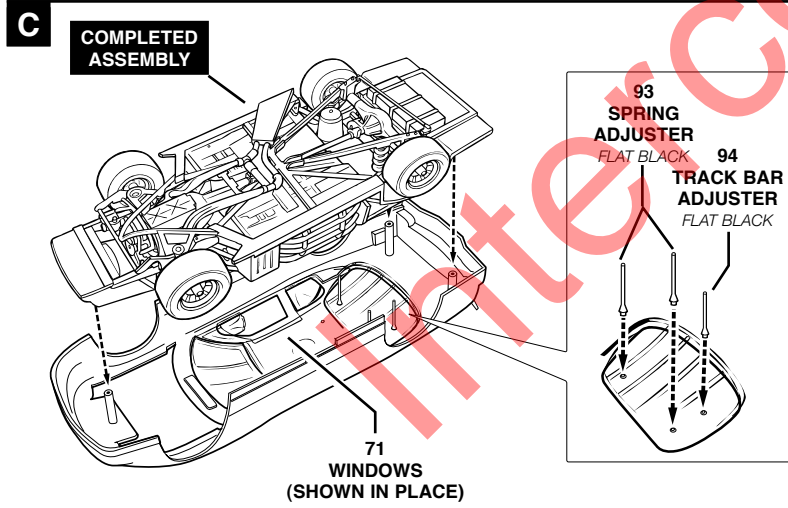
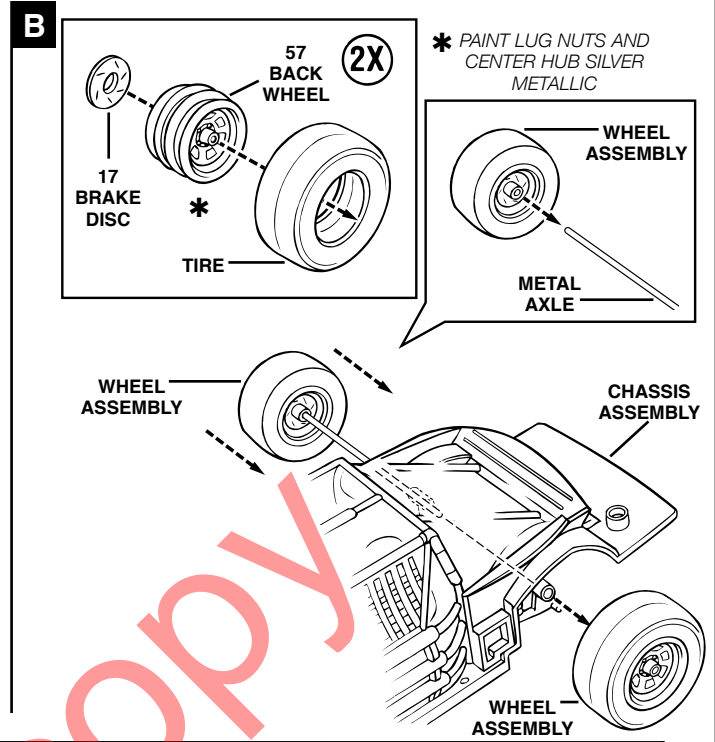
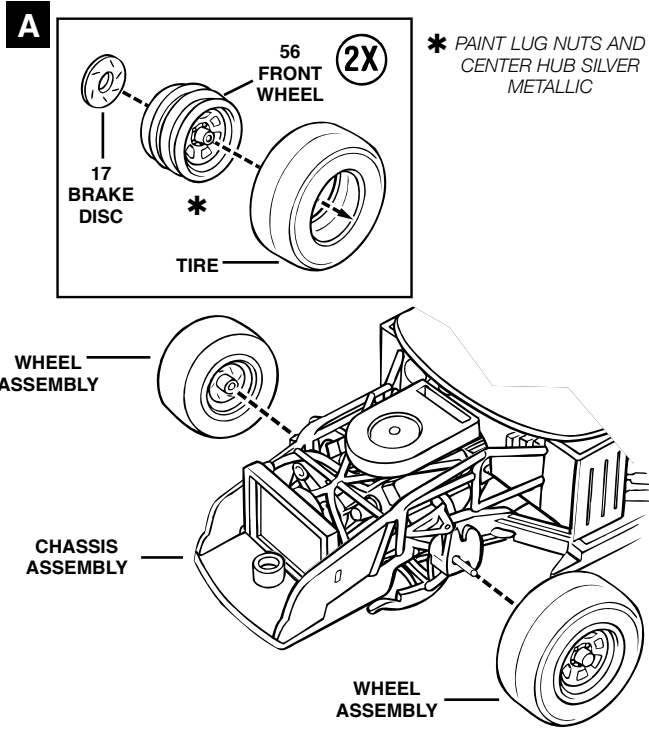

NOTE: PAINTING TIP ON HOW TO PAINT BODY BEFORE DECAL PLACEMENT

