



KIT 2196

20

Tony Stewart Home Depot® 2003 Monte Carlo™

85219600200

Tony Stewart is a race car driver's race car driver. Before you stumble over that line again, let us explain what we meant. Even though Tony Stewart is the 2002 NASCAR® Cup Champion, he always finds a little time for his hobby-racing cars. If there is a race scheduled somewhere and it catches Tony's interest, even on a quarter-mile dirt bullring, there's always the possibility that you may see him. These smaller series do not have the purses that a Cup race will, so Tony is certainly not doing it for the money. He enters these races because, well, Tony likes racing cars, you see.

While Tony Stewart's career so far has been relatively short, he has jam-packed it with highlights. Starting out racing go-carts at the tender age of seven, Tony has spent a lot of time piloting open wheeled cars, becoming the Indy Racing Northern Light series Rookie of the Year in 1996, then Indy 500® Rookie of the Year on his way to clinching the IRL Championship in 1997.

Gaining a ride in the NASCAR® Grand National series driving for Joe Gibbs, he didn't have a single win. None. People around the track started wondering if Tony could compete in a car with fenders around the wheels. Just the same, Gibbs saw the raw

talent and promoted him to the Cup series and there was no stopping him. 6 wins and a top ten finish in the points in 2000. Three more wins and a second place finish in the final standings in '01. Then the 2002 season began and Tony suffered a blown engine in the season opening Daytona 500. One would think that starting the season dead last in the points would shake one's confidence. Not Tony. All season, the rallying cry in the #20® team was "Last to First", and they pulled it off. 2002 Champion.

Not only does Tony like race cars, but also race teams, and he's got a whole lot of them. You see, Tony owns not only the World of Outlaws team that Danny Lasoski took to second place in the standings in 2003 but also 5 USAC sprint car teams, 2 three-quarter midget teams, a Legends series team and a remote control car company. Being a very busy guy, Tony has a trusted confidant to oversee all these enterprises-his mom. Now that he's signed up with the Joe Gibbs Cup team through the 2009 season, you'll be seeing a lot more of Tony Stewart, usually in Victory Lane. That's just fine with Tony because...he really likes racing cars.



* REPEAT SEVERAL TIMES
* A REPETER PLUSIEURS FOIS



* OPTIONAL PARTS
* PIECES EN OPTION



* DECAL
* DECAL COMANIE



* ALTERNATIVE ASSEMBLY
* ENSEMBLAGE ALTERNATIVE



* CEMENT TOGETHER
* A COLLER



* REMOVE AND THROW AWAY
* A RETIRER ET JETER



* DO NOT CEMENT
* NE PAS COLLER

READ THIS BEFORE YOU BEGIN

- * Study the assembly drawings.
* Each plastic part is identified by a number.
* In the assembly drawings, some parts will be marked by a star (★) to indicate chrome plated plastic.
* For better paint and decal adhesion, wash the plastic parts in a mild detergent solution. Rinse and let air dry.
* Check the fit of each piece before cementing in place.
* Use only cement for polystyrene plastic.
* Scrape plating and paint from areas to be cemented.
* Allow paint to dry thoroughly before handling parts.
* Any unused parts may be discarded.

DECAL APPLICATION INSTRUCTIONS

- 1. Cut desired decal from sheet.
2. Dip decal in water for a few seconds.
3. Place wet decal on paper towel.
4. Wait until decal is movable on paper backing.
5. Place decal in position on model, face up and slide backing away.
6. Press out air bubbles with a soft damp cloth.
7. Milkyness that may appear is for better decal adhesion and will dry clear. Wipe away any excess adhesive.
8. Do not touch decal until fully dry.
9. Allow the decals 48 hours to dry before applying clear coat.

NOTE: Decals are compatible with setting solutions or solvents.

LIRE CE QUI SUIT AVANT DE COMMENCER

- * Etudier les schémas de montage.
* Chaque pièce en plastique est identifiée par un numéro.
* Sur les schémas de montage, certaines pièces sont marquées d'une étoile (★) pour indiquer qu'elles sont en plastique chromé.
* Pour une meilleure prise de la peinture et des autocollants, laver les pièces en plastique avec une solution détergente peu concentrée. Les rincer et les laisser sécher à l'air.
* Vérifier que chaque pièce s'ajuste bien avant de la coller en place.
* N'utiliser que de la colle pour polystyrène.
* Gratter les parties à coller pour enlever le chrome et la peinture.
* Laisser la peinture bien sécher avant de manipuler les pièces.
* Toute pièce inutilisée peut être jetée.

DIRECTIVES D'APPLICATION DES AUTOCOLLANTS

- 1. Découper l'autocollant désiré de la feuille.
2. Tremper l'autocollant dans de l'eau pendant quelques secondes.
3. Placer l'autocollant mouillé sur une serviette en papier.
4. Attendez que l'autocollant puisse être déplacé sur son support en papier.
5. Mettre l'autocollant en position sur le modèle face sur le dessus et faire glisser le support pour l'enlever.
6. Appuyer avec un chiffon doux humide pour éliminer les bulles d'air.
7. La substance laiteuse qui peut apparaître est destinée à améliorer l'adhésion de l'autocollant et devient incolore au séchage. Essuyer pour enlever tout excédent d'adhésif.
8. Ne pas toucher l'autocollant tant qu'il n'est pas bien sec.
9. Laisser l'autocollant sécher pendant 48 heures avant d'appliquer une couche transparente.

REMARQUE: Les autocollants sont compatibles avec les solutions de fixation ou les solvants.

This paint guide is provided to complete this kit as shown on the box.

Ce guide de peinture est fourni pour reproduire le modèle réduit qui apparaît sur la boîte.

Table with 2 columns: Paint Name and Color. Rows include Aluminum, Burnt Iron, Flat Dark Magenta, Flat Black, Gloss Black, Gloss Orange, Gloss Red, Gloss White, Satin Light Gray, Semigloss Black, and Steel.

If you have any questions or comments, call our hotline at: (800) 833-3570 or, please write to:

Revell-Monogram Consumer Service Department, 725 Landwehr Road, Northbrook, Illinois 60062
Be sure to include the plan number (85219600200), part number, description, your return address and phone number.

Visit our website: www.revell-monogram.com

1

ENGINE ASSEMBLY

A

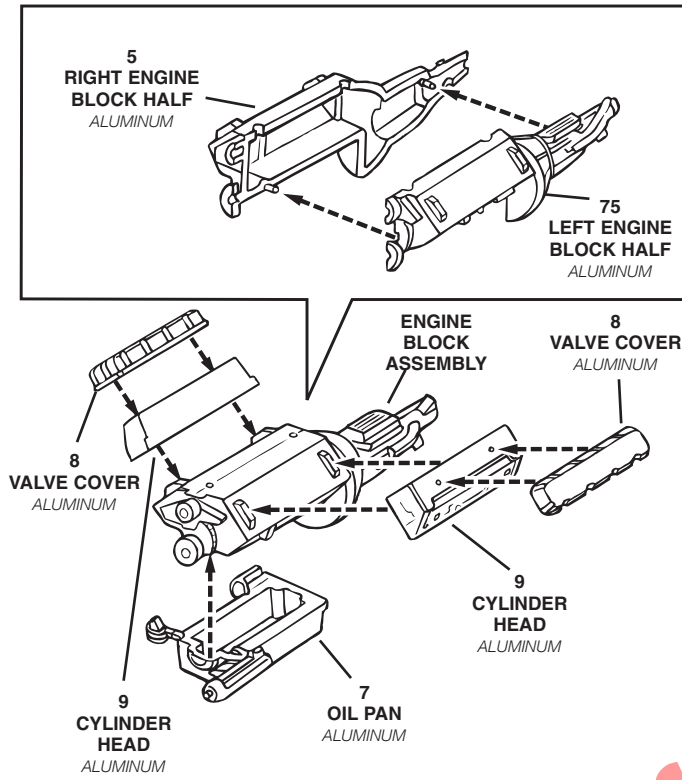

B

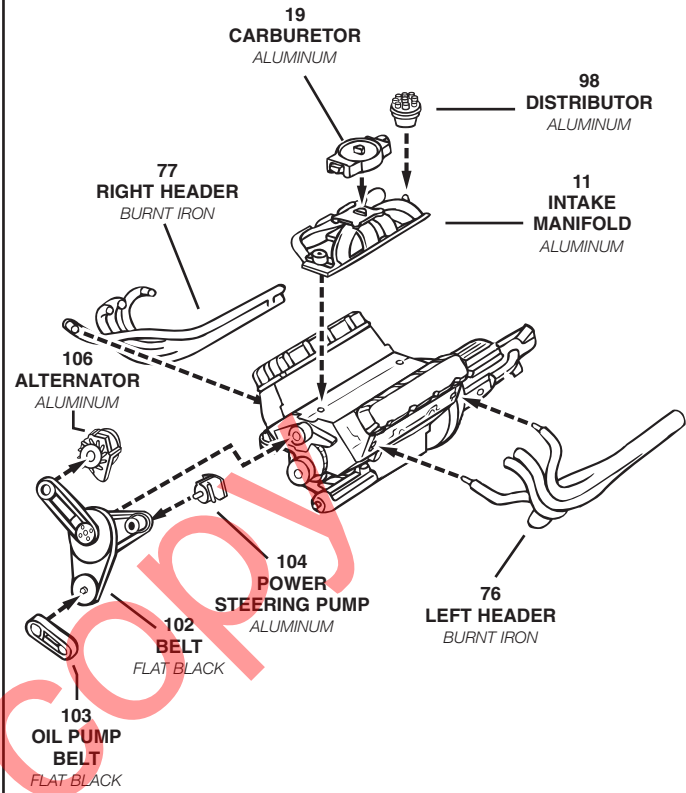

2

CHASSIS ASSEMBLY

A

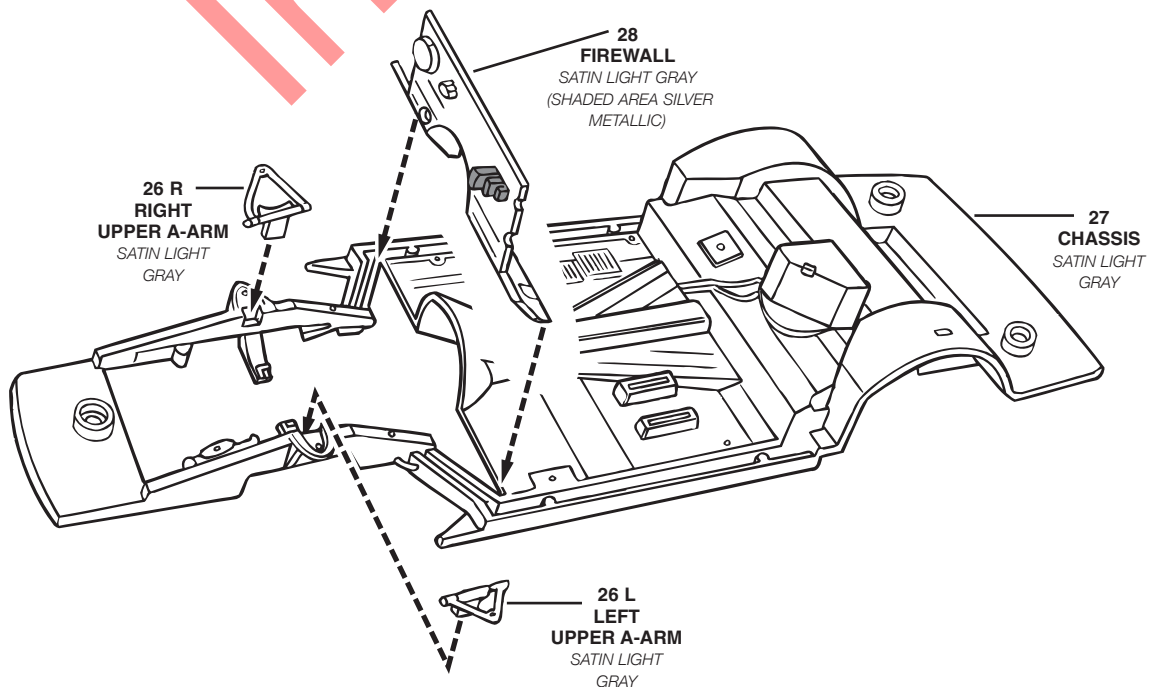

B

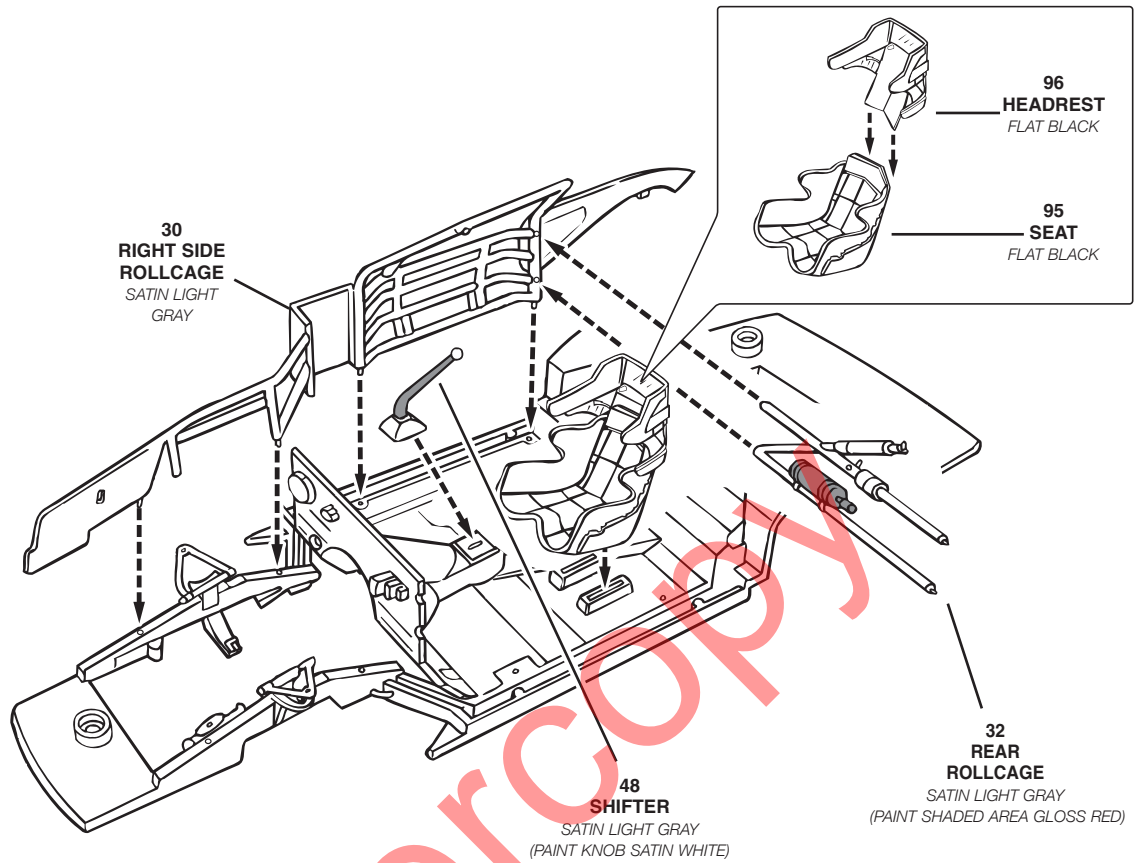

C

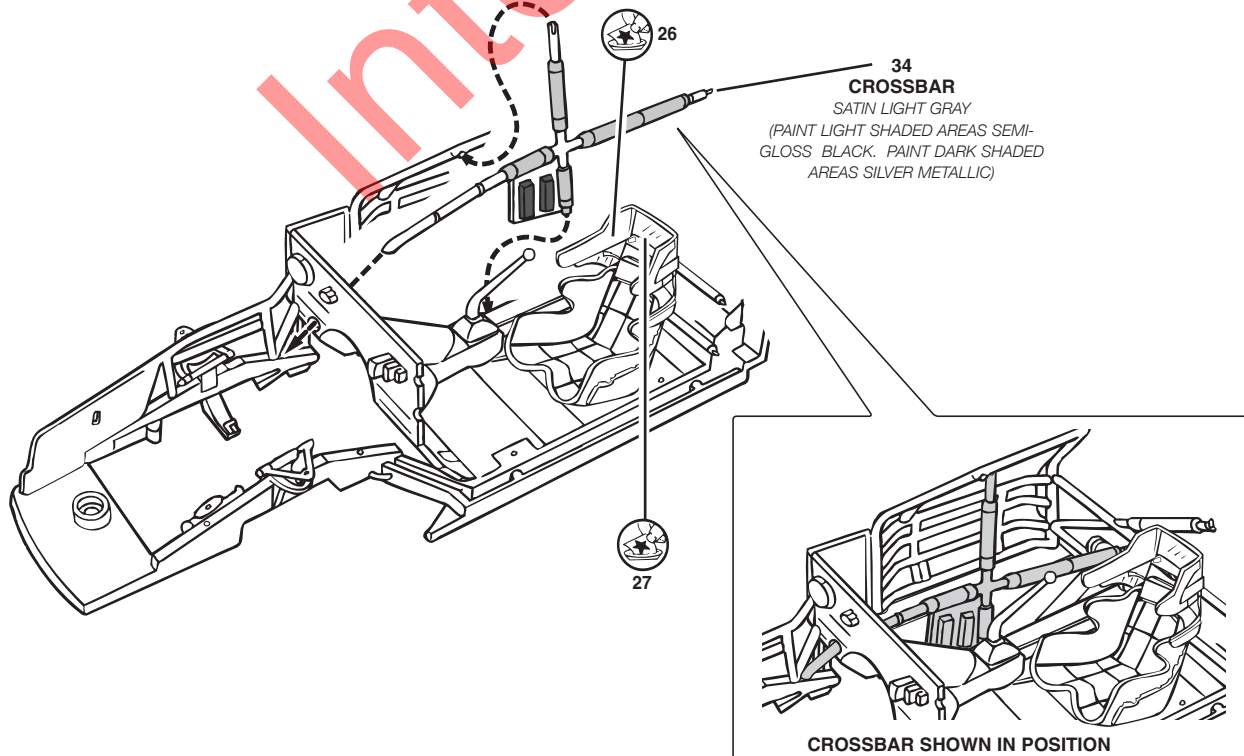

D

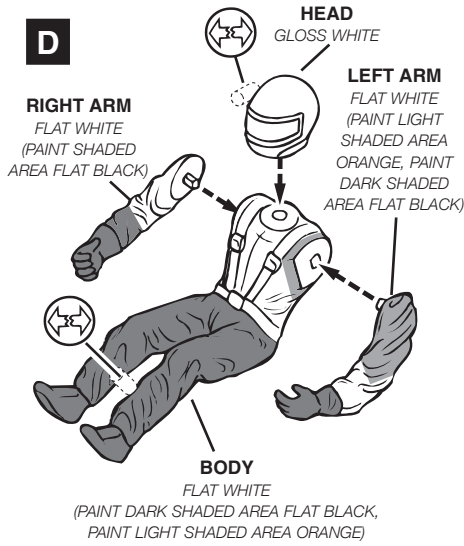

NOTE: DRIVER DECALS MUST BE APPLIED BEFORE CEMENTING FIGURE TO CHASSIS

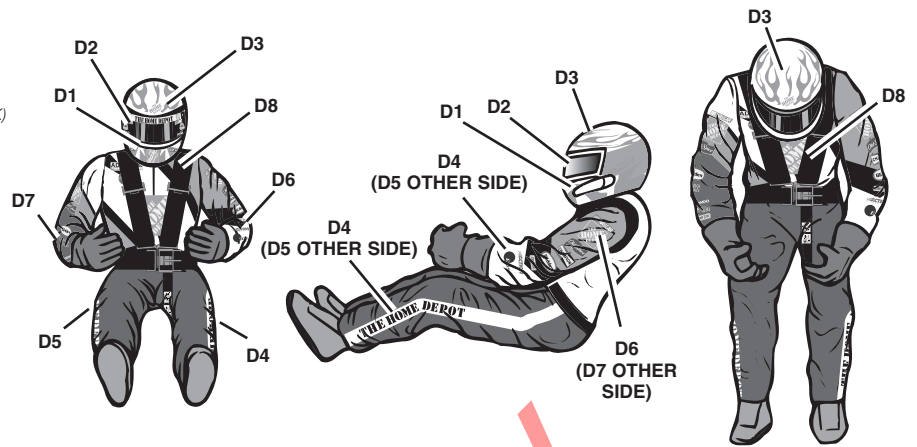

E

DRIVER ASSEMBLY

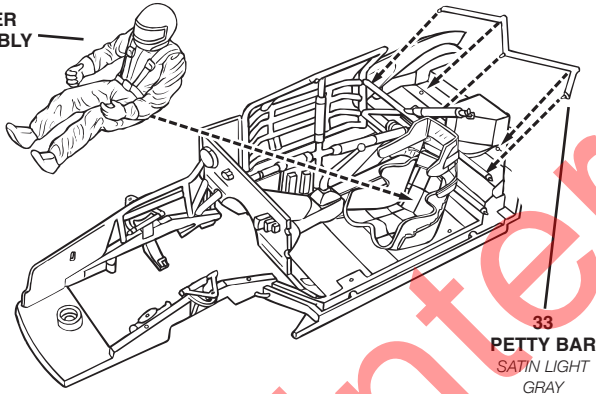

F

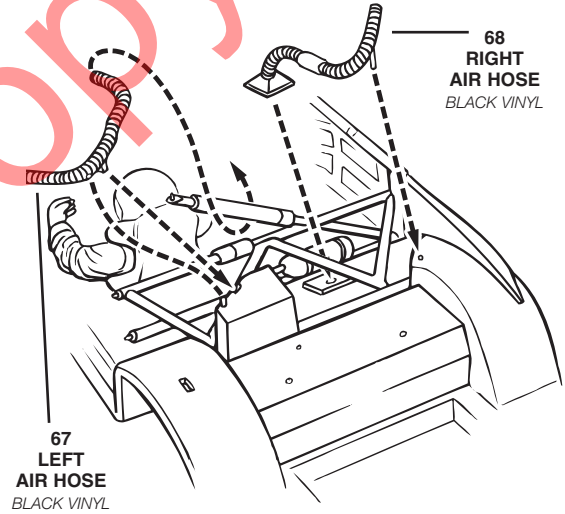

G

29
LEFT SIDE ROLL CAGE
SATIN LIGHT GRAY
(PAINT SHADED AREAS SEMIGLOSS BLACK)

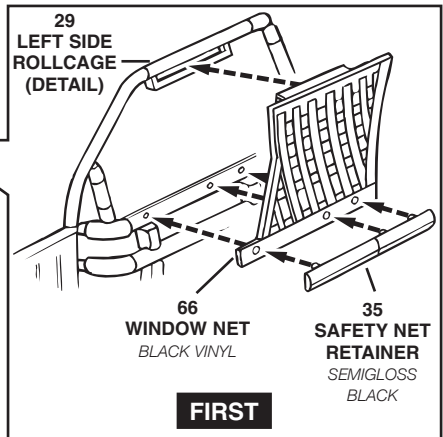
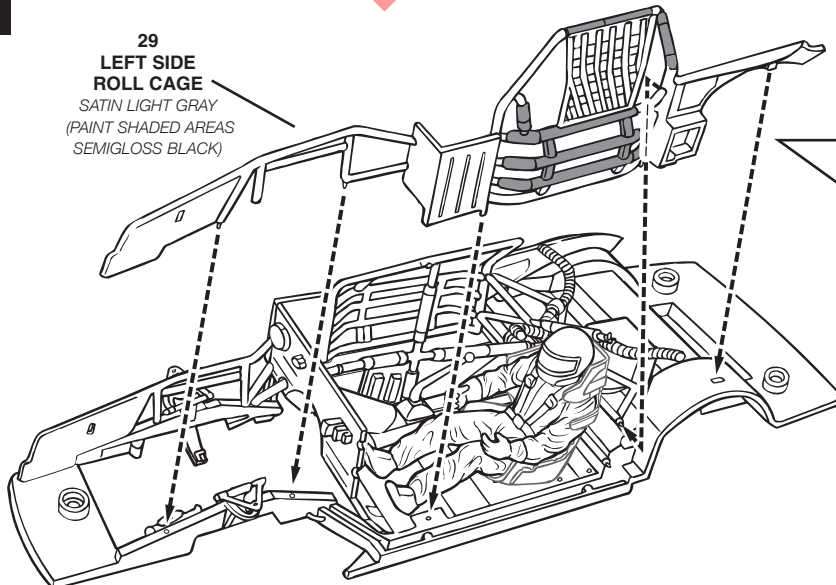

2

CHASSIS ASSEMBLY CONTINUED

H

41
ROLLCAGE
TOP
(DETAIL)
SATIN LIGHT
GRAY

45
REAR VIEW
MIRROR

41
ROLLCAGE
TOP
(PAINT SHADED AREA
SEMIGLOSS BLACK)

52
DASHBOARD
FLAT BLACK
(PAINT SWITCHES AND
DETAILS SILVER METALLIC)

59
STEERING
WHEEL
(PAINT SHADED
AREA ALUMINUM)

NOTE: CUT INSTRUMENT
PANEL OFF
SHEET AND GLUE
TO BACK SIDE OF
DASHBOARD USING

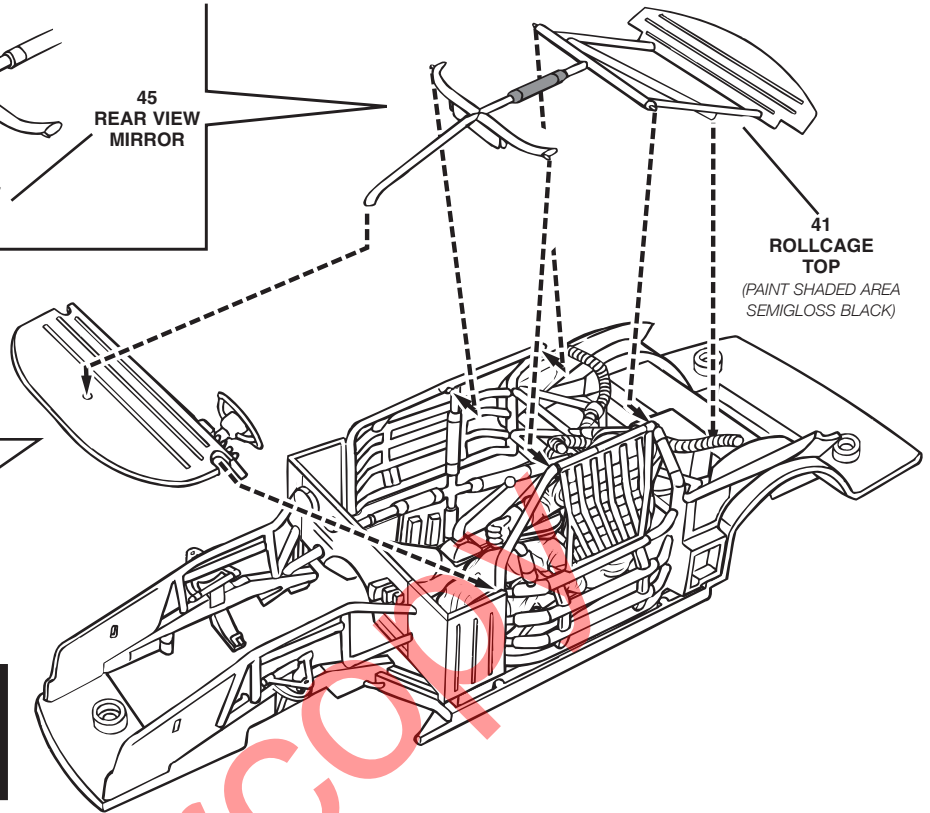

3

REAR SUSPENSION ASSEMBLY

A

92
REAR
SPRINGS
ALUMINUM

12
REAR
SHOCKS
STEEL

39
OIL TANK
STEEL

CHASSIS
ASSEMBLY

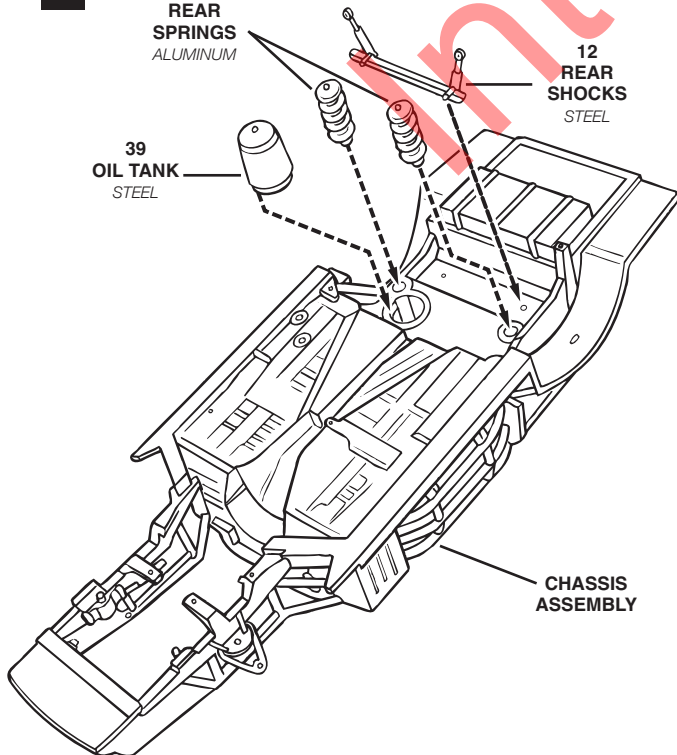

B

89
PUMP
STEEL

47
PANHARD
BAR
STEEL
86
PUMPKIN
STEEL

105
BELT
FLAT BLACK

85
REAR
SUSPENSION
FLAT BLACK

87
DRIVESHAFT
STEEL

CHASSIS
ASSEMBLY

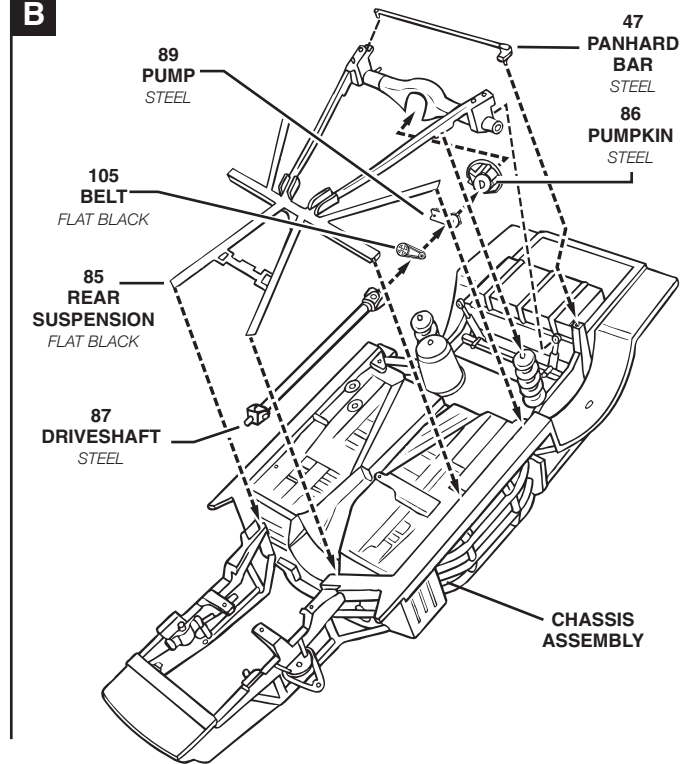

4

DRIVETRAIN ASSEMBLY

A

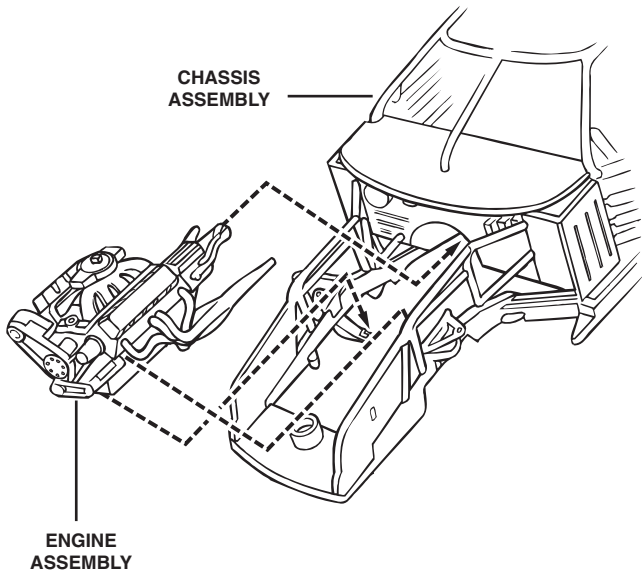

B

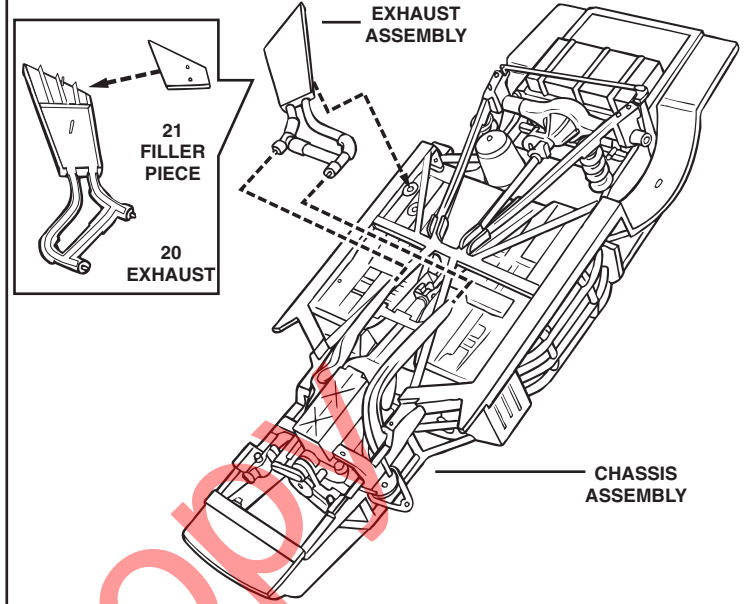

5

FRONT END ASSEMBLY

A

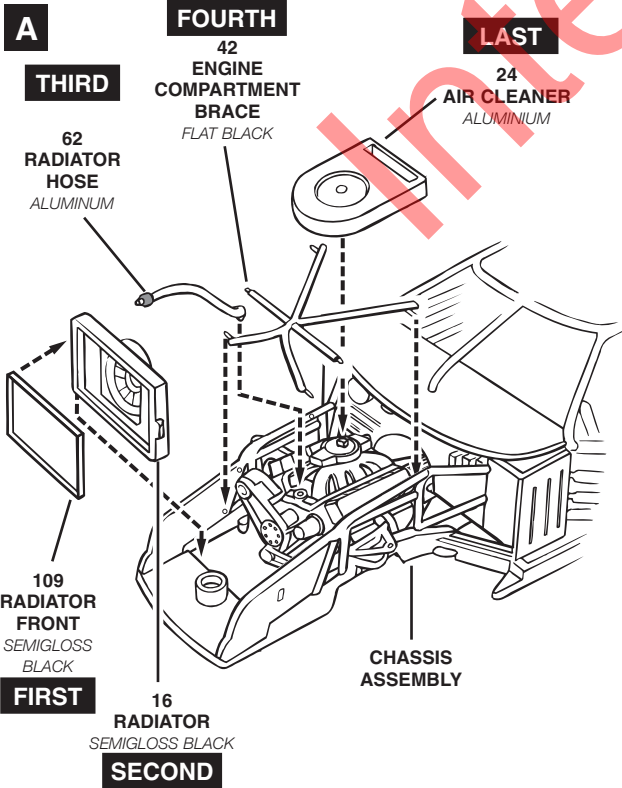

B

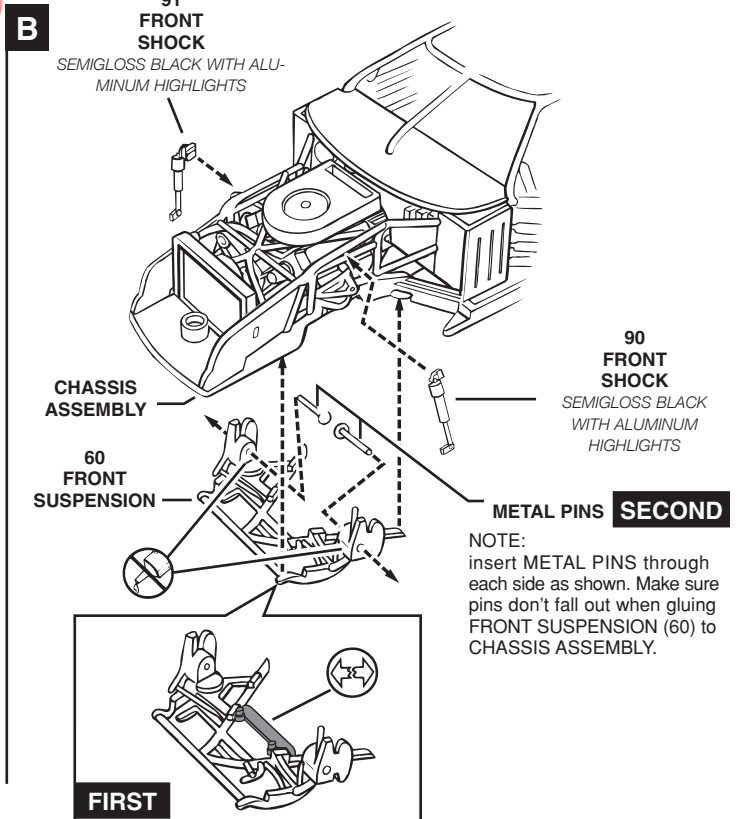

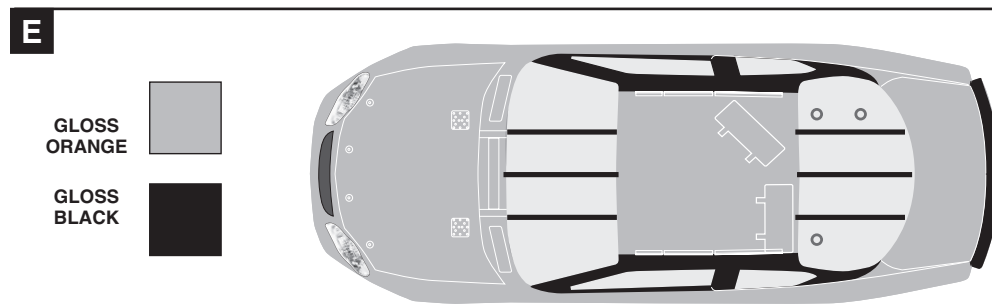
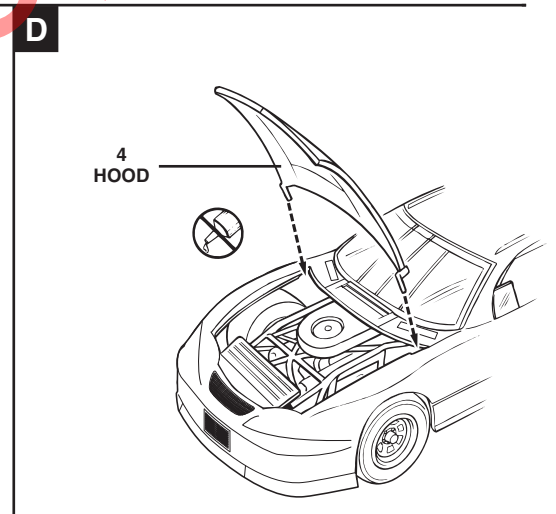
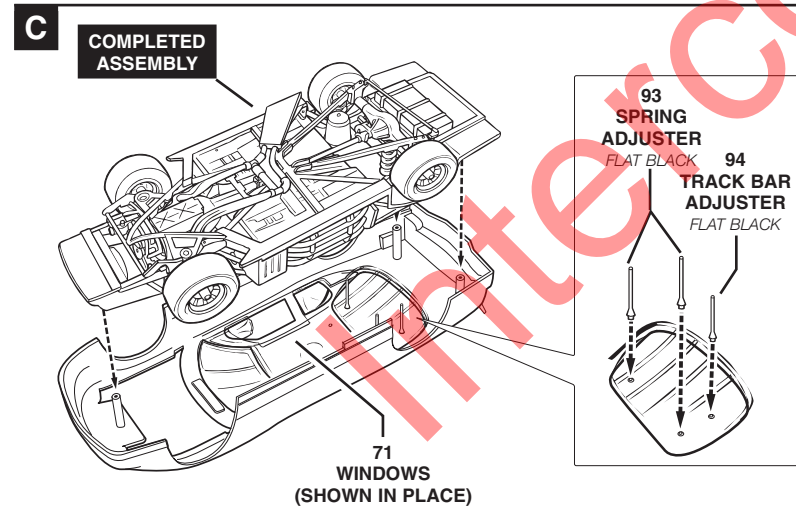
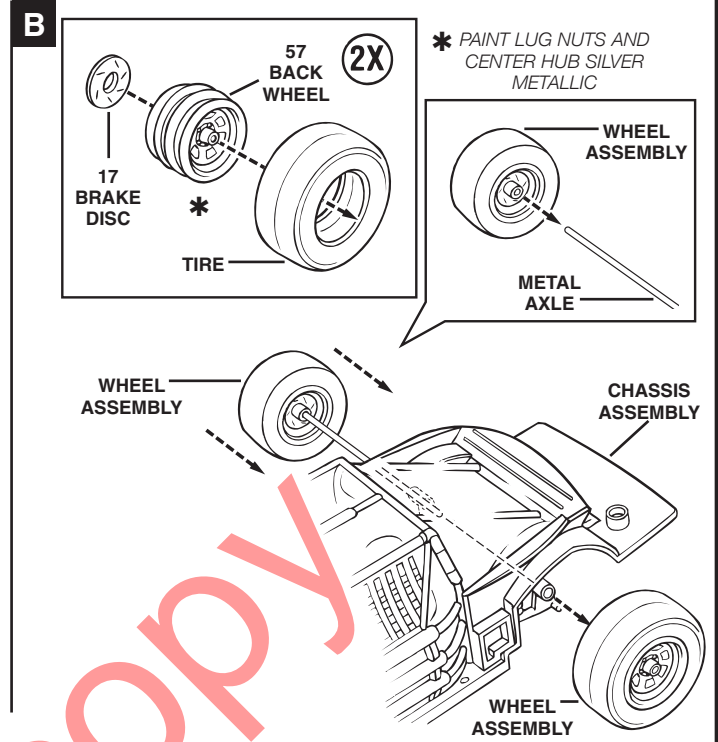
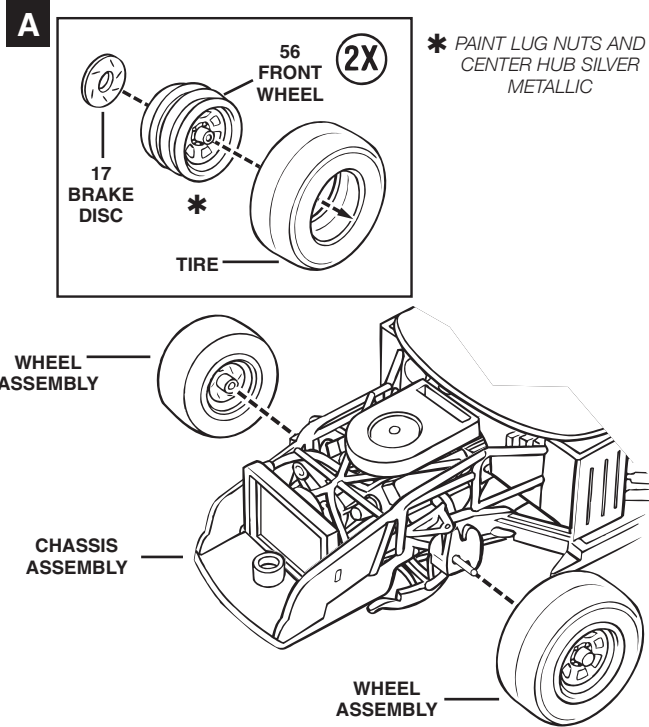

NOTE: PAINTING TIP ON HOW TO PAINT BODY BEFORE DECAL PLACEMENT

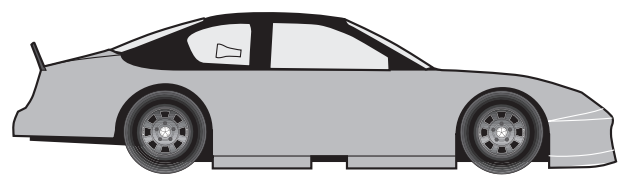

DECAL PLACEMENT



NOTE: DECALS 2, 3, 4, 9 and 36 MUST BE APPLIED FIRST

