



KIT2830

85283000200

# 1993 Honda<sup>®</sup> Civic<sup>®</sup> Coupe

## 2 'n 1 TUNER SERIES

Wherever you go in the world, you'll find people who dig their cars. Sure, there are plenty of folks for whom a car is a necessary evil, a conveyance to get to work or the market in. But for many, driving is fun, a whole lot of fun when the speed picks up. For over half a century, car enthusiasts have searched for ways to extract more fun from their cars.

Back then, as well as today, one picks up a car that can be obtained at a low price and then fixes it up to look better as well as go faster.

These days, it really hasn't changed much. The cars change and the faces working on them are noticeably younger, but it's really all the same. Durable, inexpensive import cars have been with us for decades now. So it's no wonder that these modified sport compacts are the new breed of hot rods. Now, many companies that have been producing modified and beefed up parts for the old V8 hot rods now are producing the same for 4 and 6 cylinder overhead cam engines. With these, (and a full compliment of computers), ingenious tuners are pulling enormous amounts of horsepower out these little motors.

Among the favorite subjects for this transformation is the Honda<sup>®</sup> Civic<sup>®</sup>, the subject of your Revell kit. The Honda<sup>®</sup> VTEC<sup>®</sup> engine, small in physical size and easy to work on, has become the small-bloc V8 of the new generation. The clean design of the Civic<sup>®</sup> coupe body style recalls the sloping rooflines of the smartly styled full size American cars of decades past.

Now would be a good time to spend a few moments looking over this plan and thinking about what you would like to have your Civic<sup>®</sup> coupe look like. We have included some extra goodies to consider: Two sets of seats, one stock and the other racing style; two complete front and rear end bumper treatments; three sets of wheels; three rear wings and two separate hoods, one custom and the other stock, but molded in tricky clear plastic! Of course, if you're so inclined, the clear hood can be painted to match (or not match) the rest of your creation. We hope you have as much fun building your new kit as we had designing it for you.

Honda<sup>®</sup>, Civic<sup>®</sup>, Vtec<sup>®</sup>, and the automobile designs and distinctive likeness of the Honda Civic are trade-



**\* REPEAT SEVERAL TIMES**  
\* A REPETER PLUSIEURS FOIS



**\* OPTIONAL PARTS**  
\* PIECES EN OPTION



**\* DECAL**  
\* DECAL COMANIE



**\* ALTERNATIVE ASSEMBLY**  
\* ENSEMBLAGE ALTERNATIVE



**\* CEMENT TOGETHER**  
\* A COLLER



**\* REMOVE AND THROW AWAY**  
\* A RETIRER ET JETER



**\* DO NOT CEMENT**  
\* NE PAS COLLER

### READ THIS BEFORE YOU BEGIN

- \* Study the assembly drawings.
- \* Each plastic part is identified by a number.
- \* In the assembly drawings, some parts will be marked by a star (★) to indicate chrome plated plastic.
- \* For better paint and decal adhesion, wash the plastic parts in a mild detergent solution. Rinse and let air dry.
- \* Check the fit of each piece before cementing in place.
- \* Use only cement for polystyrene plastic.
- \* Scrape plating and paint from areas to be cemented.
- \* Allow paint to dry thoroughly before handling parts.
- \* Any unused parts may be discarded.

### DECAL APPLICATION INSTRUCTIONS

1. Cut desired decal from sheet.
2. Dip decal in water for a few seconds.
3. Place wet decal on paper towel.
4. Wait until decal is movable on paper backing.
5. Place decal in position on model, face up and slide backing away.
6. Press out air bubbles with a soft damp cloth.
7. Milkyness that may appear is for better decal adhesion and will dry clear. Wipe away any excess adhesive.
8. Do not touch decal until fully dry.
9. Allow the decals 48 hours to dry before applying clear coat.

**NOTE:** Decals are compatible with setting solutions or solvents.

### LIRE CE QUI SUIT AVANT DE COMMENCER

- \* Etudier les schémas de montage.
- \* Chaque pièce en plastique est identifiée par un numéro.
- \* Sur les schémas de montage, certaines pièces sont marquées d'une étoile (★) pour indiquer qu'elles sont en plastique chromé.
- \* Pour une meilleure prise de la peinture et des autocollants, laver les pièces en plastique avec une solution détergente peu concentrée. Les rincer et les laisser sécher à l'air.
- \* Vérifier que chaque pièce s'ajuste bien avant de la coller en place.
- \* N'utiliser que de la colle pour polystyrène.
- \* Gratter les parties à coller pour enlever le chrome et la peinture.
- \* Laisser la peinture bien sécher avant de manipuler les pièces.
- \* Toute pièce inutilisée peut être jetée.

### DIRECTIVES D'APPLICATION DES AUTOCOLLANTS

1. Découper l'autocollant désiré de la feuille.
2. Tremper l'autocollant dans de l'eau pendant quelques secondes.
3. Placer l'autocollant mouillé sur une serviette en papier.
4. Attendez que l'autocollant puisse être déplacé sur son support en papier.
5. Mettre l'autocollant en position sur le modèle face sur le dessus et faire glisser le support pour l'enlever.
6. Appuyer avec un chiffon doux humide pour éliminer les bulles d'air.
7. La substance laiteuse qui peut apparaître est destinée à améliorer l'adhésion de l'autocollant et devient incolore au séchage. Essuyer pour enlever tout excédent d'adhésif.
8. Ne pas toucher l'autocollant tant qu'il n'est pas bien sec.
9. Laisser l'autocollant sécher pendant 48 heures avant d'appliquer une couche transparente.

**REMARQUE:** Les autocollants sont compatibles avec les solutions de fixation ou les solvants.

### This optional paint guide is provided if you choose to detail paint your model.

Ce guide de peinture vous sera fourni si vous choisissez de peindre votre modèle en détail.

Aluminium	Aluminium
Flat Black	Noir mat
Gloss Red	Rouge brillant
Gold	Or
Gunmetal	Bronze
Hot Pink	Rose chaud
Neon Yellow	Jaune de néon
Satin Red	Rouge satiné
Satin White	Blanc satiné
Semigloss Black	Noir satiné
Steel	Acier
Turnsignal Amber	Feu clignotant de direction ambre

If you have any questions or comments, call our hotline at: **(800) 833-3570** or, please write to:

**Revell-Monogram Consumer Service Department, 725 Landwehr Road, Northbrook, Illinois 60062**

Be sure to include the plan number (85283000200), part number, description, your return address and phone number.

Visit our website: [www.revellmonogram.com](http://www.revellmonogram.com)

# 1

# ENGINE ASSEMBLY



**NOTE:** *ITALICIZED COLOR CALL OUTS REPRESENT CUSTOM HOOD TUNER COLORS. BOLD ITALICIZED COLOR CALL OUTS REPRESENT CLEAR HOOD TUNER VERSION. CALLOUTS THAT ONLY SHOW ONE COLOR IS COMMON TO BOTH TUNER VERSIONS.*

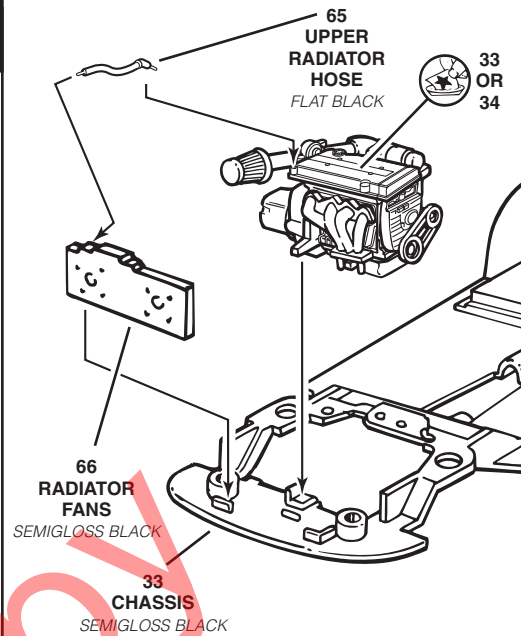
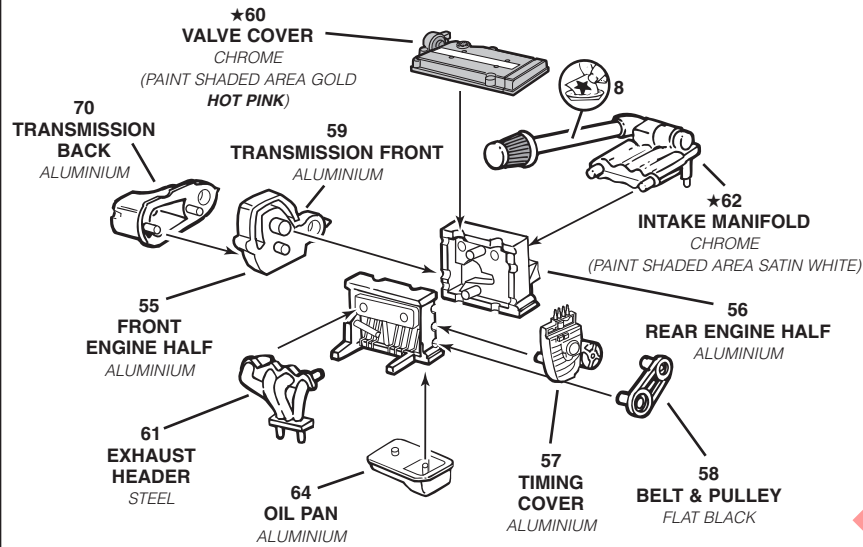

# 2

# WINDOW AND DASH ASSEMBLY

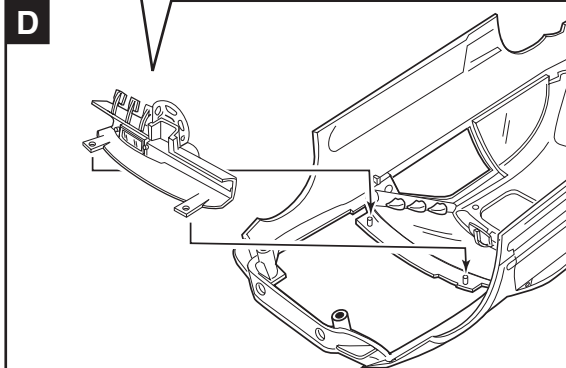
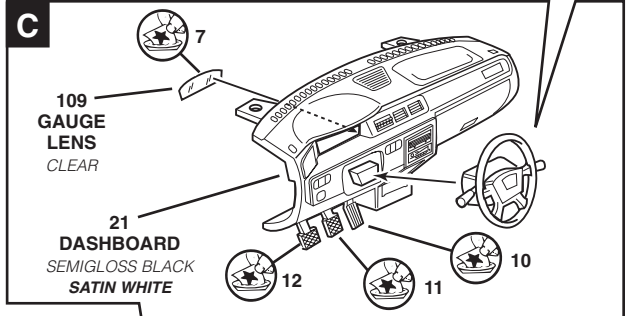
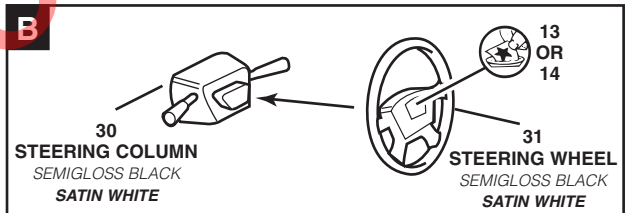
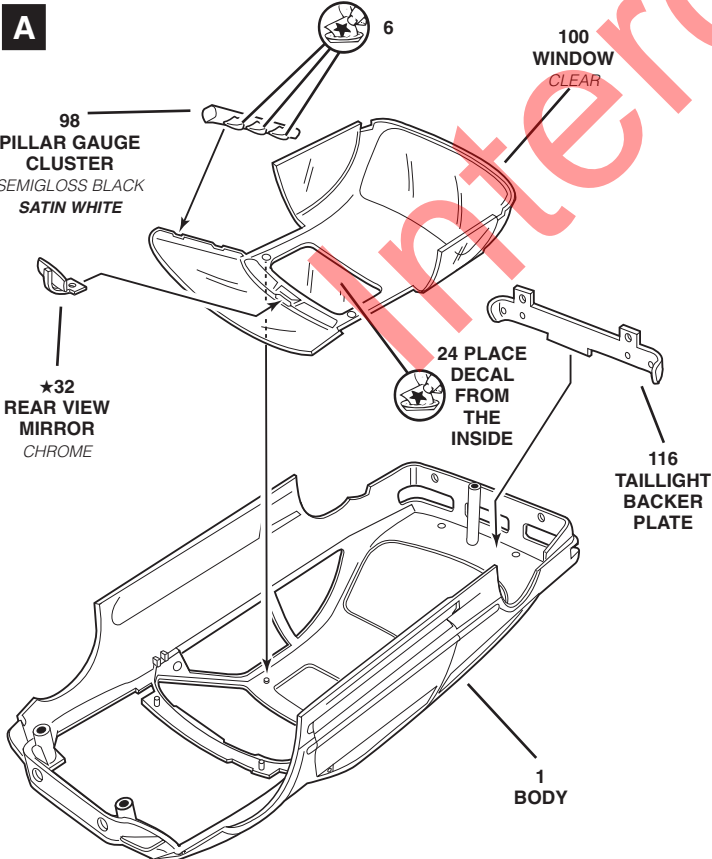

# 3

# HOOD ASSEMBLY

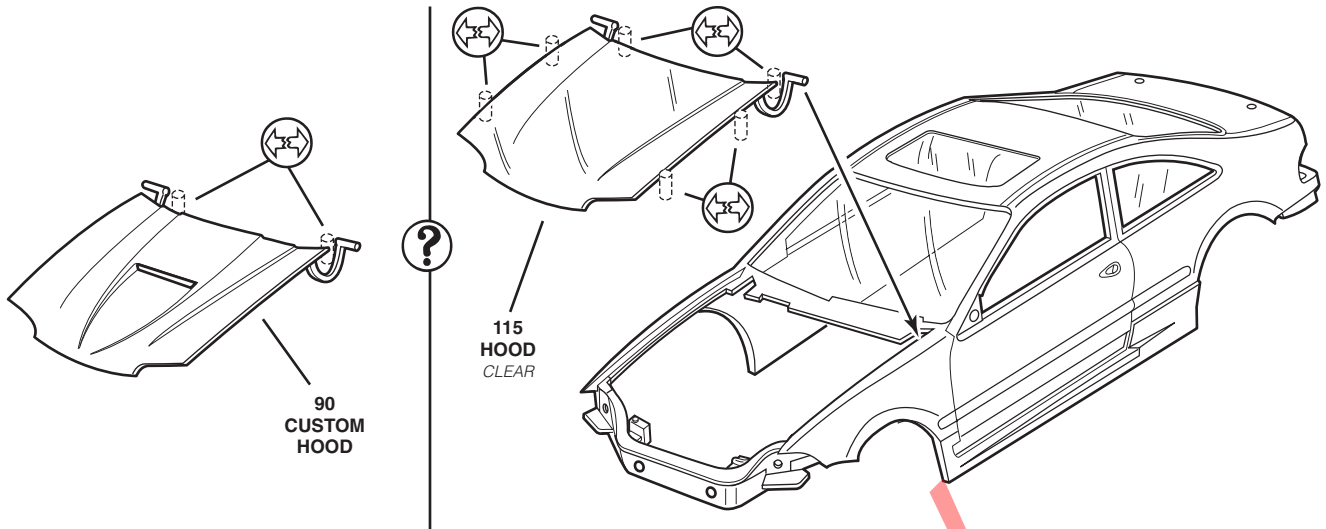

# 4

# INTERIOR ASSEMBLY

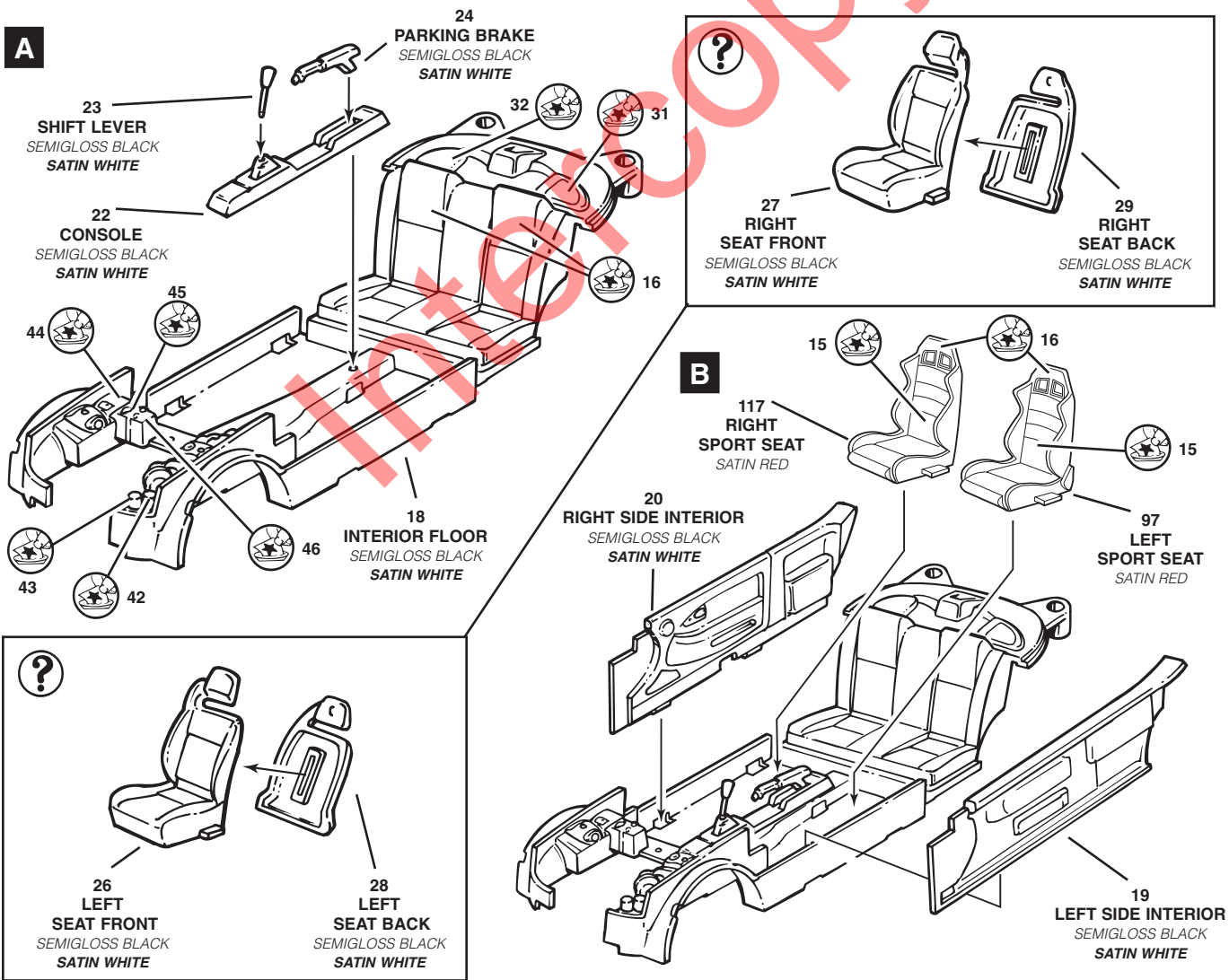

# 4

# INTERIOR ASSEMBLY CONTINUED

C

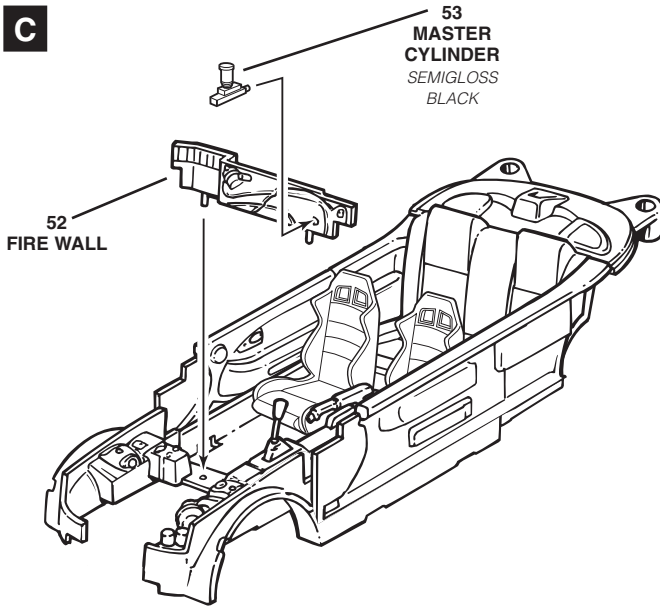

D

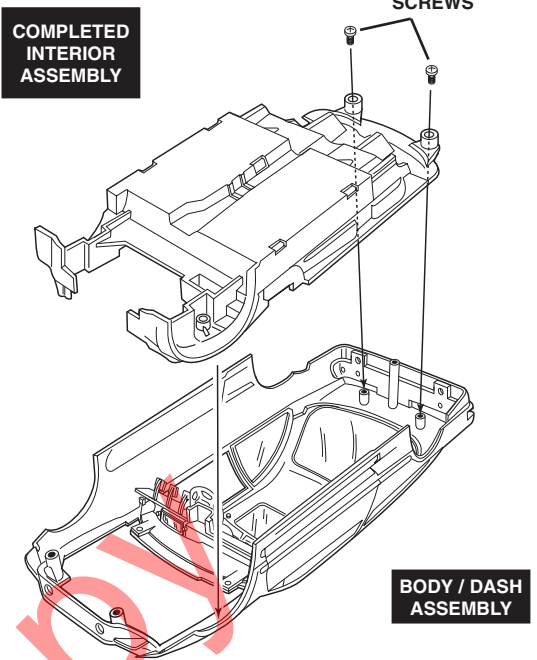

# 5

# SUSPENSION ASSEMBLY

A

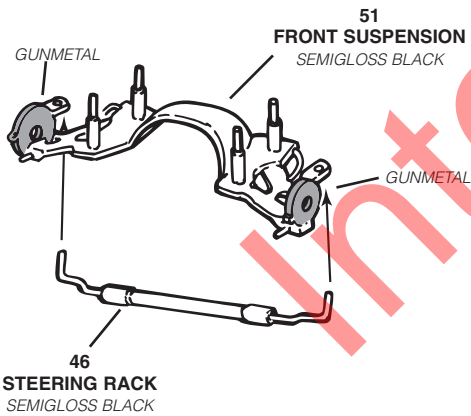

B

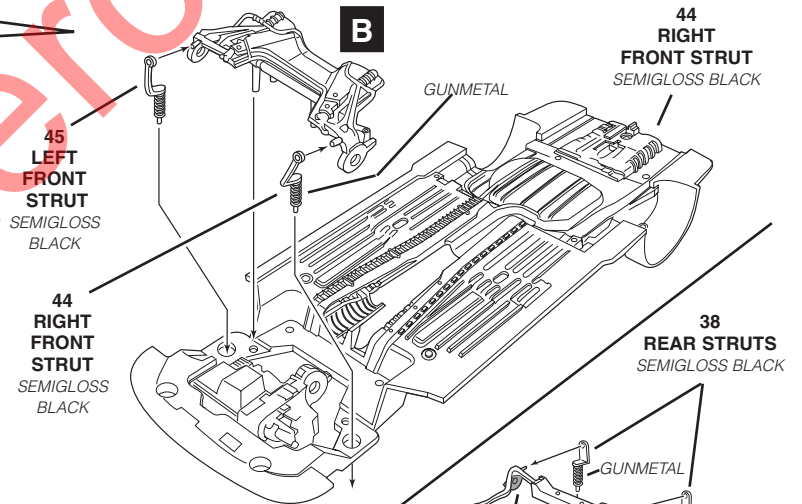

C

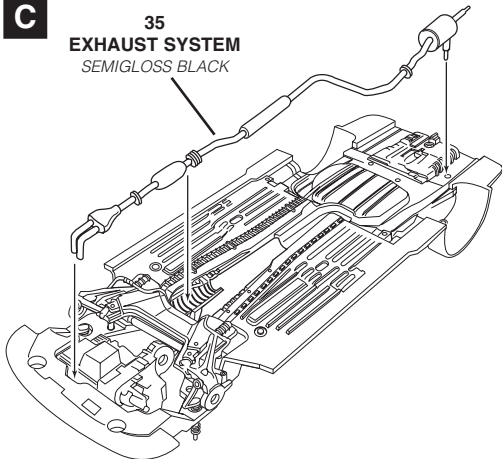

D

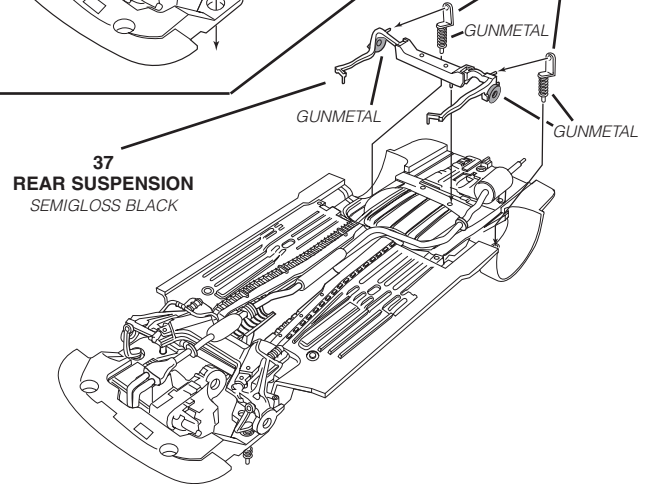

# 6

# CHASSIS ASSEMBLY

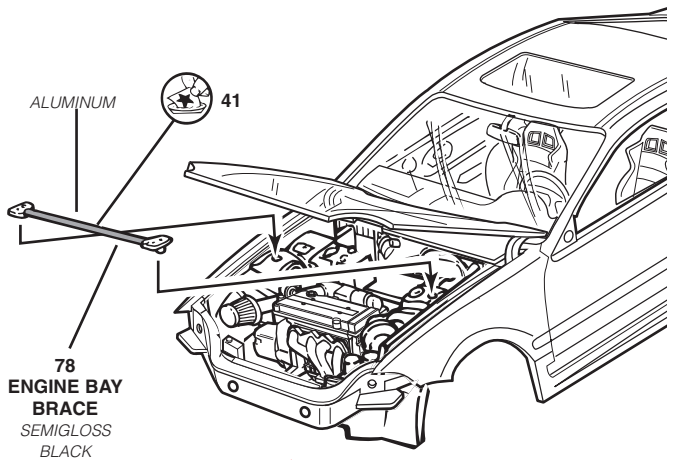
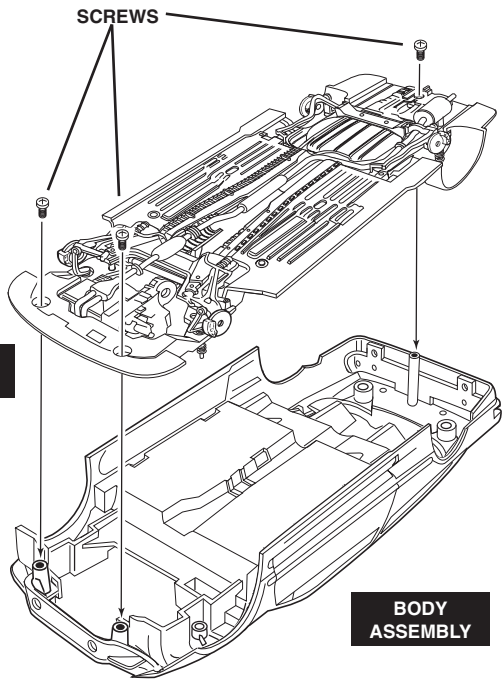

# 7

# FRONT ASSEMBLY

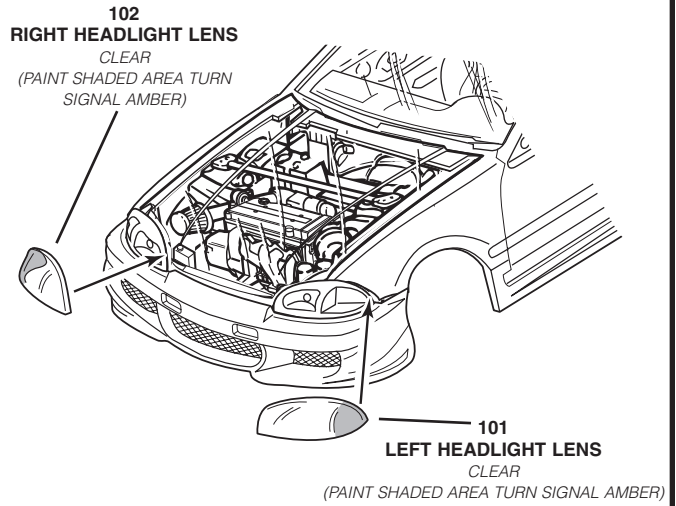
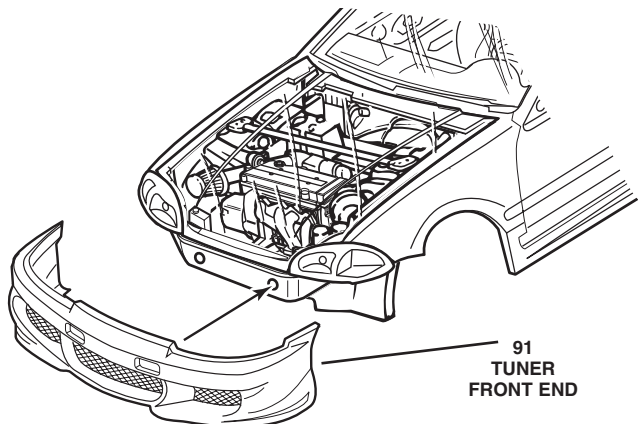
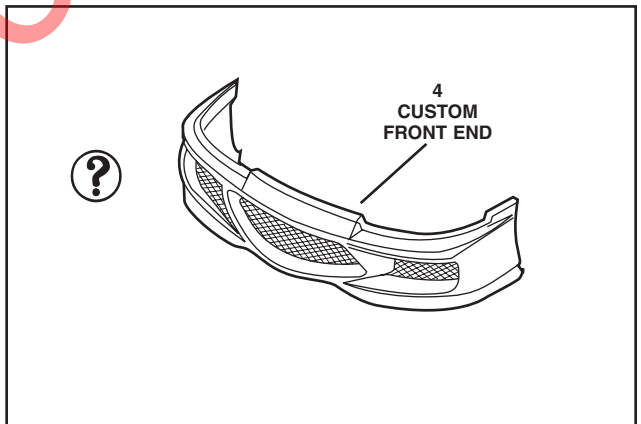
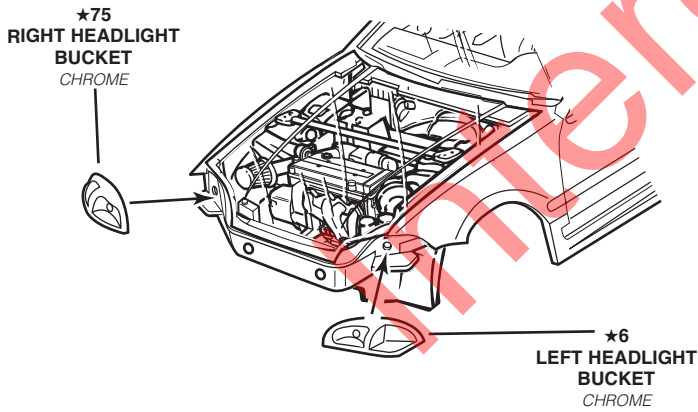

# 8

# REAR ASSEMBLY

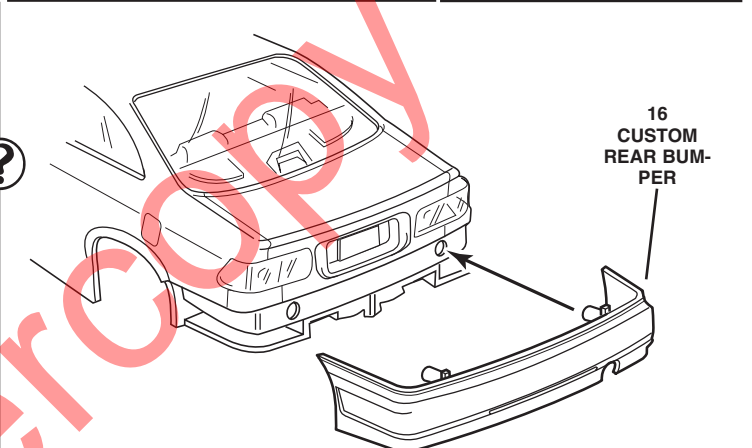
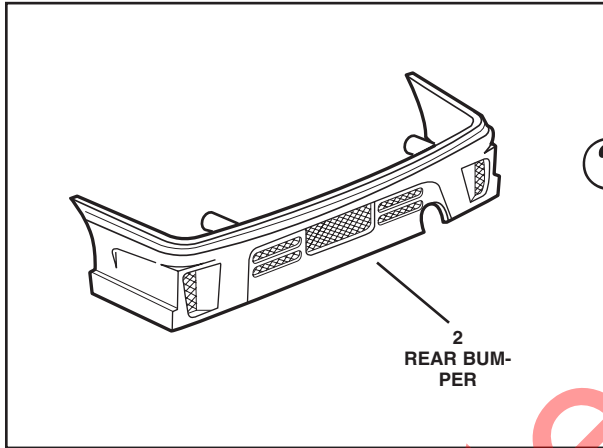
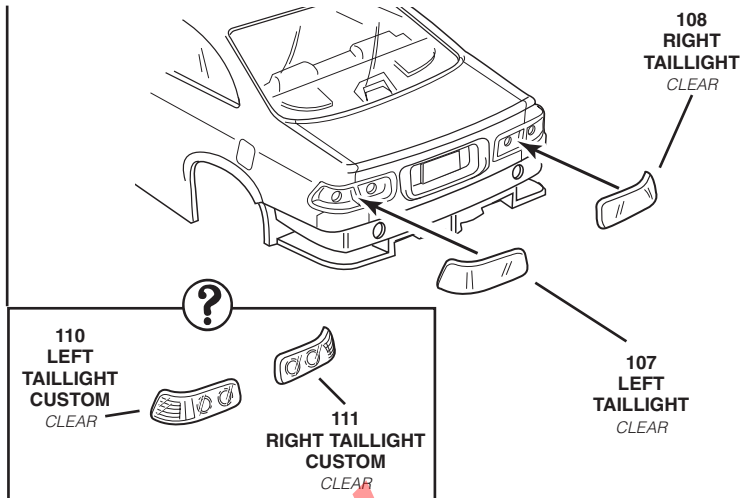
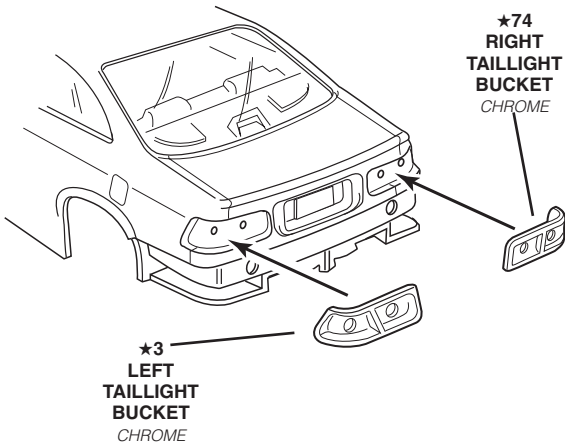

# 9

# SPOILER ASSEMBLY

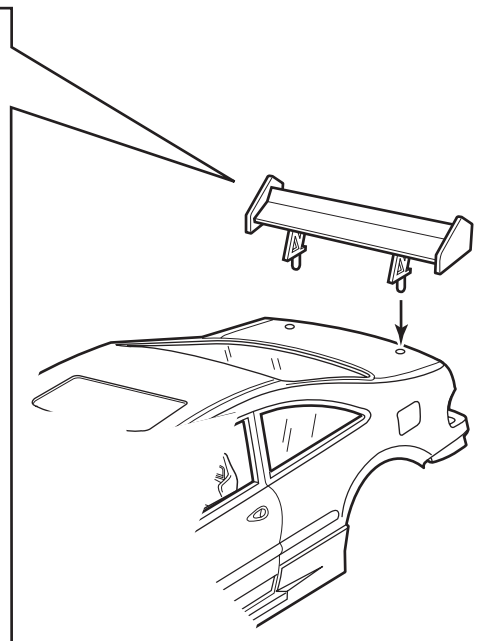
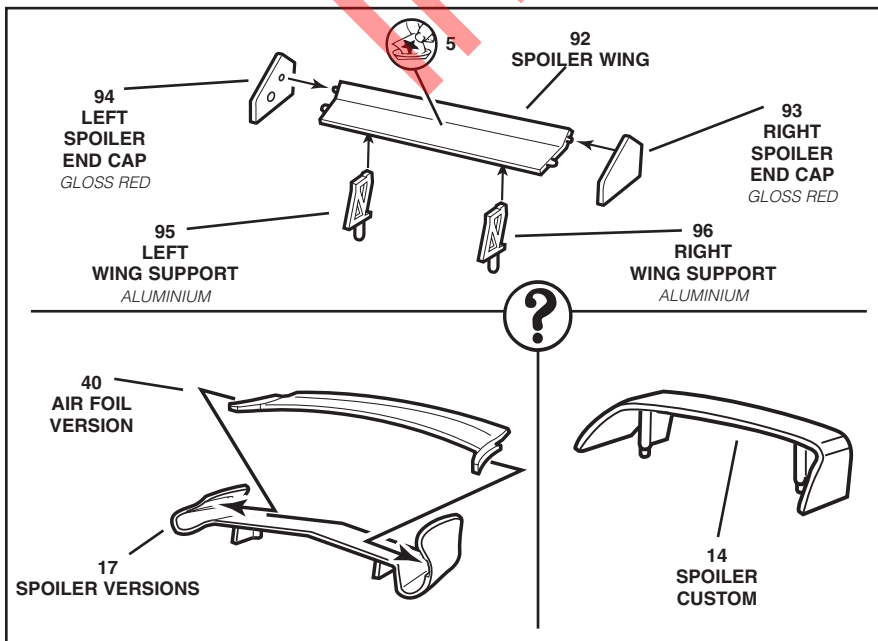

# 10

# MIRROR ASSEMBLY

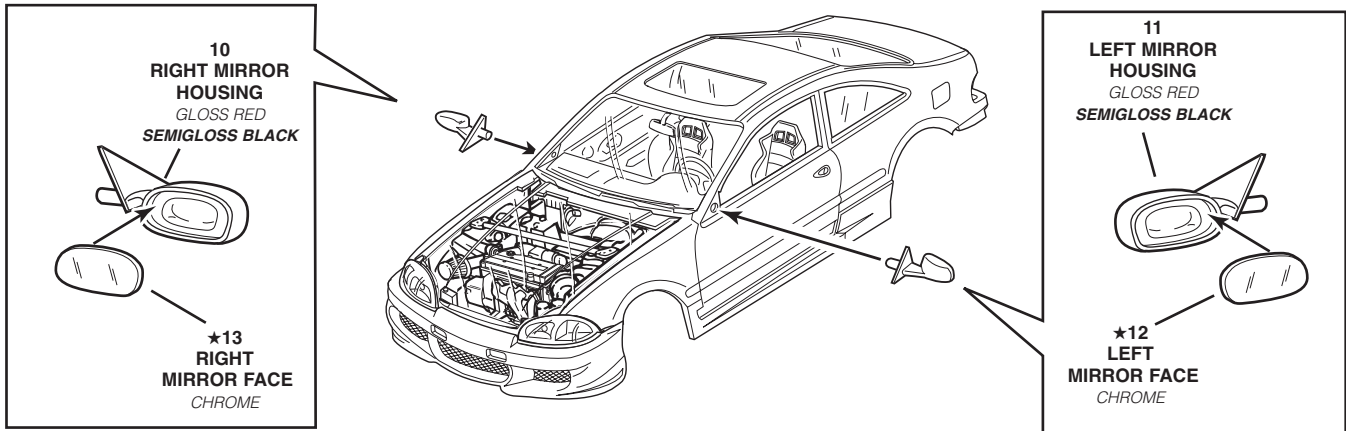

# 11

# WHEEL ASSEMBLY

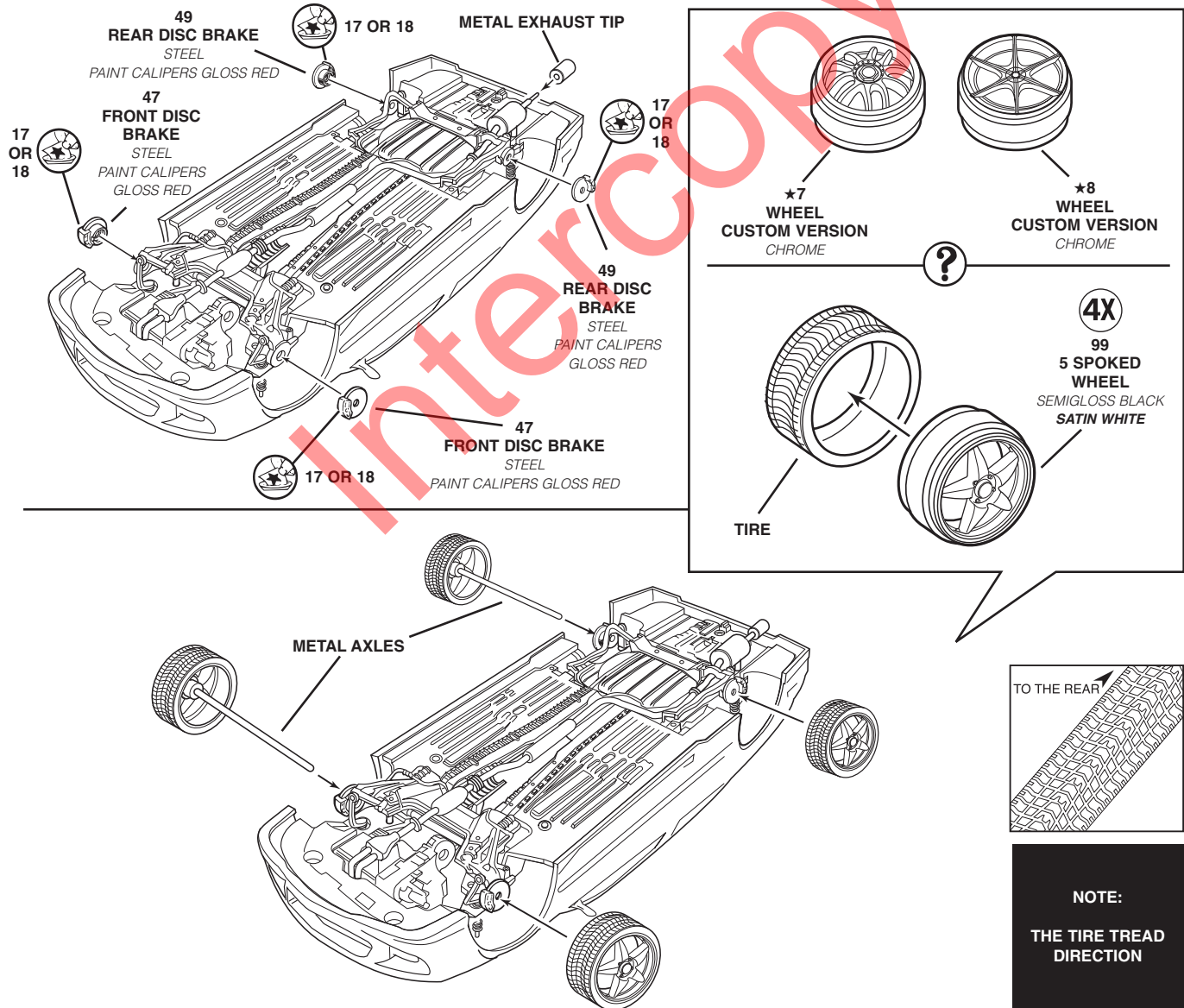

- HOT PINK
- NEON YELLOW

