



KIT 2843



Dale Earnhardt, Jr.
Chance 2 Motorsports
"DMP" MONTE CARLO™

85284300200

Having a NASCAR® race team in the 21st century is far different than in the sport's earliest days 50+ years ago. Sponsor contracts, television contracts, even the weekly race purse all have the words "multi-million dollar" in front of them. If that wasn't enough pressure to perform, there's 42 other teams, better organized and better financed than ever, looking to pass you by every week. Ask anyone associated with a race team and they'll confirm that it's a tremendous amount of stress.

Then again, your name could be Dale Earnhardt, Jr. This third generation driver has dealt with all of these pressures as well as the overwhelming burden of being the son of, in the eyes of millions of fans, the greatest stock car driver ever.

In addition to the solid racing skills Junior learned from his late father, the family heritage is also apparent in that the Budweiser® Monte Carlo™ wears the number 8, a respectful

nod to his grandfather Ralph Earnhardt who ran the dirt bullrings of NASCAR® in the 50's.

Through it all, Dale Jr. rises to meet the challenges. With the tragic 2001 season behind him, Junior has matured and has stepped up to take his place among racing's elite. While not entirely leaving behind the persona of the wise-cracking young gun with the Budweiser® hat on backwards, he's brought together the scores of talented people working the red & black #8 as well as DEI's two other Cup teams, keeping all three legitimate threats to clinch the win every race. Perhaps more than anyone else, Dale Jr. has also brought together the fans of the veteran drivers that were rookies 10 and 20 years ago with the "new breed" of fans cheering on the younger generation of NASCAR® competitors. The future not only looks bright, it looks like there will be no shortage of Earnhardts in Victory Lane any time soon.



* REPEAT SEVERAL TIMES
* A REPETER PLUSIEURS FOIS



* OPTIONAL PARTS
* PIECES EN OPTION



* DECAL
* DECAL COMANIE



* ALTERNATIVE ASSEMBLY
* ENSEMBLAGE ALTERNATIVE



* CEMENT TOGETHER
* A COLLER



* REMOVE AND THROW AWAY
* A RETIRER ET JETER



* DO NOT CEMENT
* NE PAS COLLER

READ THIS BEFORE YOU BEGIN

- * Study the assembly drawings.
- * Each plastic part is identified by a number.
- * In the assembly drawings, some parts will be marked by a star (★) to indicate chrome plated plastic.
- * For better paint and decal adhesion, wash the plastic parts in a mild detergent solution. Rinse and let air dry.
- * Check the fit of each piece before cementing in place.
- * Use only cement for polystyrene plastic.
- * Scrape plating and paint from areas to be cemented.
- * Allow paint to dry thoroughly before handling parts.
- * Any unused parts may be discarded.

DECAL APPLICATION INSTRUCTIONS

1. Cut desired decal from sheet.
2. Dip decal in water for a few seconds.
3. Place wet decal on paper towel.
4. Wait until decal is movable on paper backing.
5. Place decal in position on model, face up and slide backing away.
6. Press out air bubbles with a soft damp cloth.
7. Milkyness that may appear is for better decal adhesion and will dry clear. Wipe away any excess adhesive.
8. Do not touch decal until fully dry.
9. Allow the decals 48 hours to dry before applying clear coat.

NOTE: Decals are compatible with setting solutions or solvents.

LIRE CE QUI SUIT AVANT DE COMMENCER

- * Etudier les schémas de montage.
- * Chaque pièce en plastique est identifiée par un numéro.
- * Sur les schémas de montage, certaines pièces sont marquées d'une étoile (★) pour indiquer qu'elles sont en plastique chromé.
- * Pour une meilleure prise de la peinture et des autocollants, laver les pièces en plastique avec une solution détergente peu concentrée. Les rincer et les laisser sécher à l'air.
- * Vérifier que chaque pièce s'ajuste bien avant de la coller en place.
- * N'utiliser que de la colle pour polystyrène.
- * Gratter les parties à coller pour enlever le chrome et la peinture.
- * Laisser la peinture bien sécher avant de manipuler les pièces.
- * Toute pièce inutilisée peut être jetée.

DIRECTIVES D'APPLICATION DES AUTOCOLLANTS

1. Découper l'autocollant désiré de la feuille.
2. Tremper l'autocollant dans de l'eau pendant quelques secondes.
3. Placer l'autocollant mouillé sur une serviette en papier.
4. Attendez que l'autocollant puisse être déplacé sur son support en papier.
5. Mettre l'autocollant en position sur le modèle face sur le dessus et faire glisser le support pour l'enlever.
6. Appuyer avec un chiffon doux humide pour éliminer les bulles d'air.
7. La substance laiteuse qui peut apparaître est destinée à améliorer l'adhésion de l'autocollant et devient incolore au séchage. Essuyer tout excédent d'adhésif.
8. Ne pas toucher l'autocollant tant qu'il n'est pas bien sec.
9. Laisser l'autocollant sécher pendant 48 heures avant d'appliquer une couche transparente.

This paint guide is provided to complete this kit as shown on the box.

Ce guide de peinture est fourni pour reproduire le modèle réduit qui apparaît sur la boîte.

Aluminum	Aluminum
Flat Black	Noir mat
Flat White	Blanc mat
Flat Yellow	Jaune mat
Gloss Black	Noir brillant
Gloss Red	Rouge brillant
Gloss White	Blanc brillant
Light Gray	Gris clair
Satin White	Blanc satiné
Semigloss Black	Noir satiné
Silver	Argent
Steel	Acier

If you have any questions or comments, call our hotline at: (800) 833-3570 or, please write to:

Revell-Monogram Consumer Service Department, 725 Landwehr, Northbrook, Illinois 60062

Be sure to include the plan number (85284300200), part number, description, your return address and phone number.

Visit our website: www.revell-monogram.com

1

ENGINE ASSEMBLY

A * **NOTE: BEND PLUG WIRES SO THAT LONG TABS ON WIRES FIT INTO DEPRESSIONS ON CYLINDER HEADS**

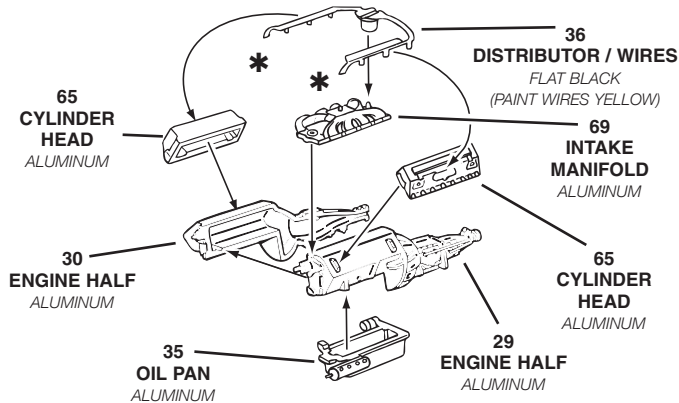

B

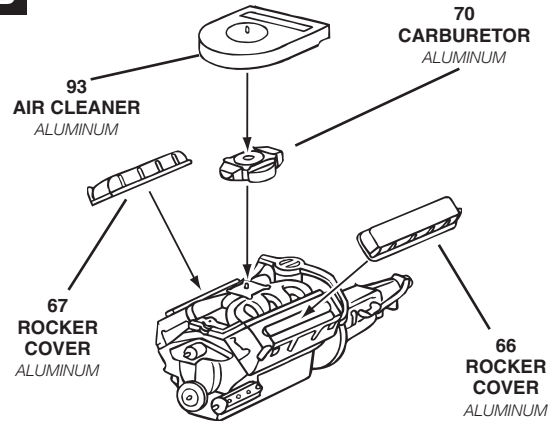

C

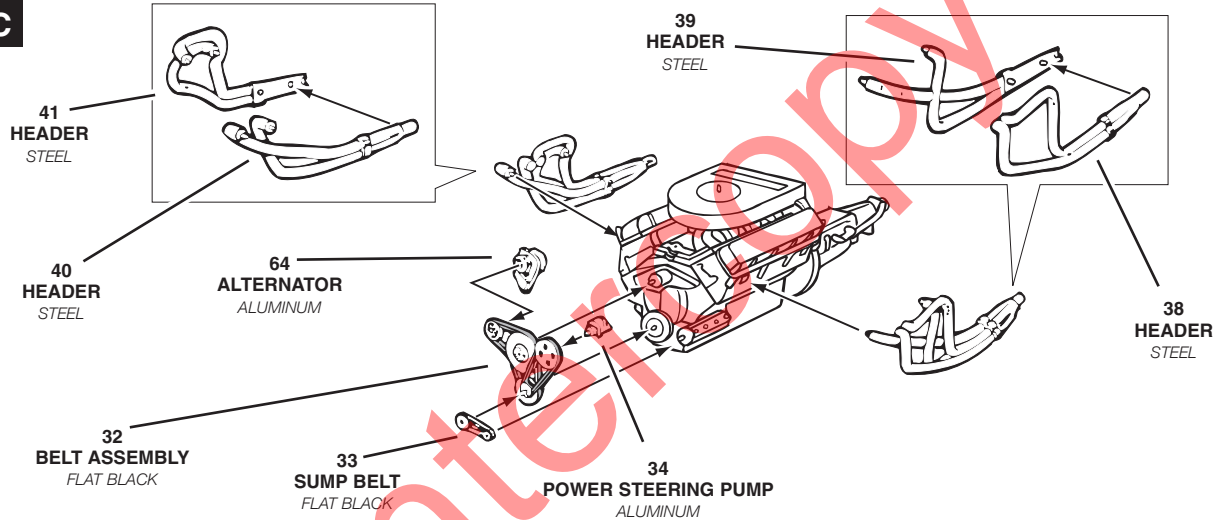

2

CHASSIS / INTERIOR ASSEMBLY

A

NOTE: LEAVE SUPPORT STRAP IN PLACE UNTIL STEP 4A

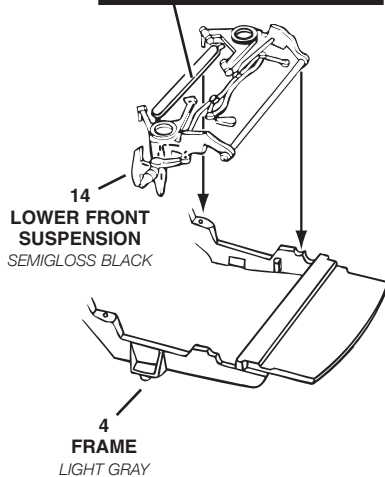

B

15 RIGHT UPPER ARM LIGHT GRAY (SHADED AREA SEMI-GLOSS BLACK)

96 LEFT UPPER ARM LIGHT GRAY (SHADED AREA SEMI-GLOSS BLACK)

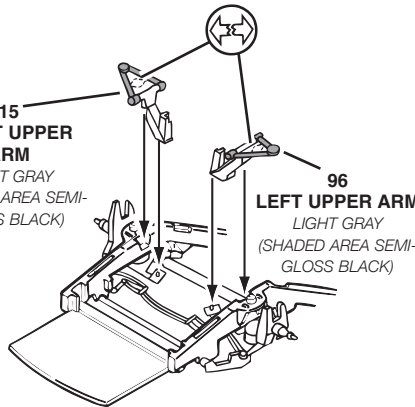

C

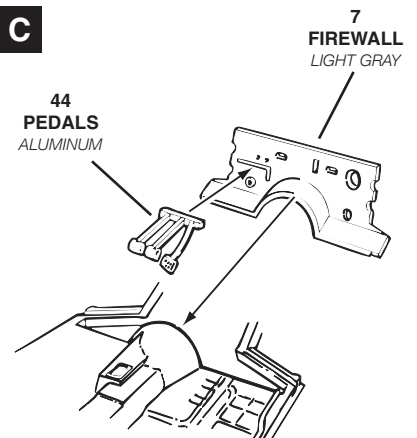

D

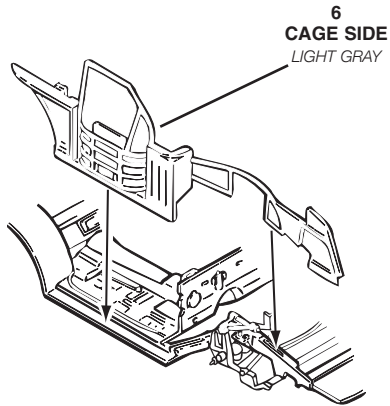

E

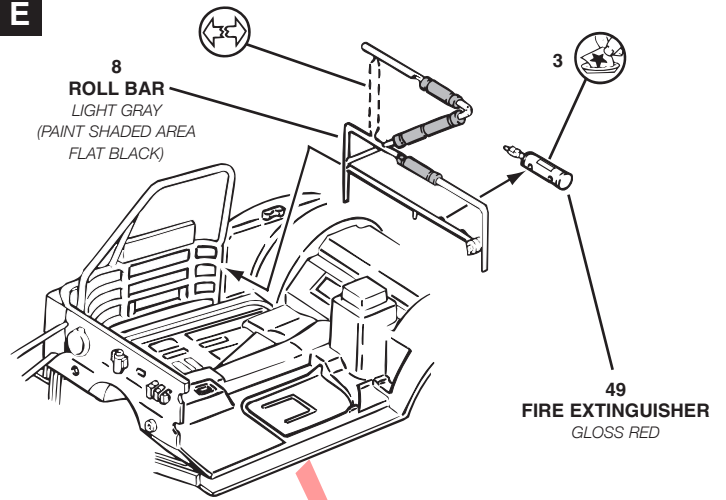

F

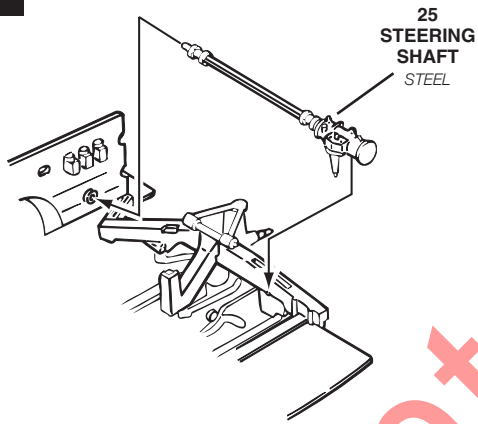

G

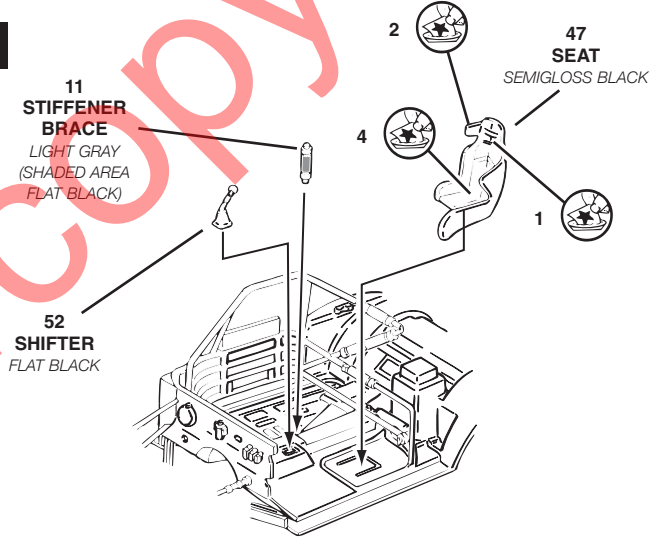

H

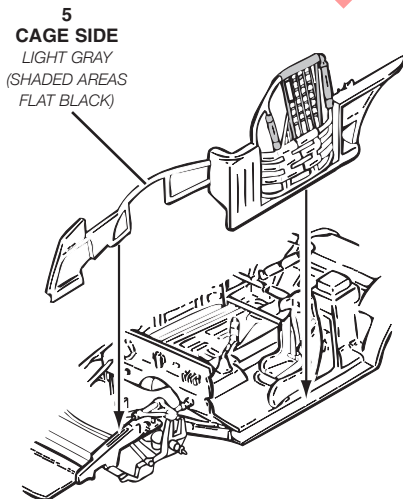

I

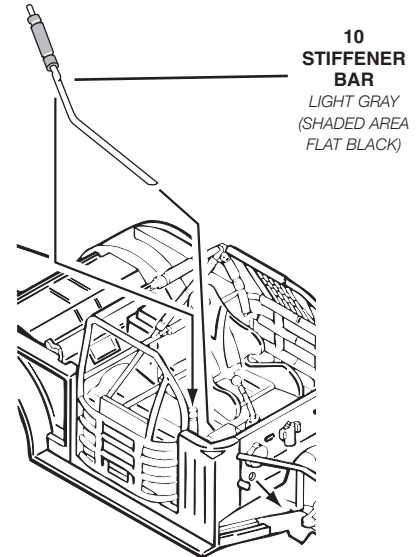

2

CHASSIS / INTERIOR ASSEMBLY CONTINUED

J

57
PETTY BAR
LIGHT GRAY

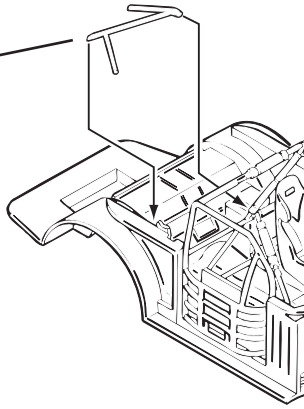

K

50
HOSE
FLAT BLACK

48
HOSE
FLAT BLACK

51
HOSE
FLAT BLACK

61
HOSE
FLAT BLACK

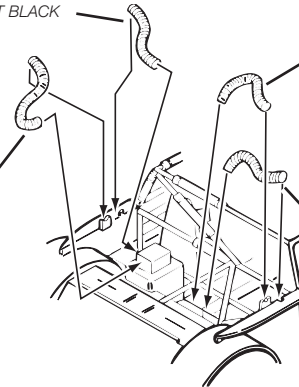

L

73
TOP STIFFENER BAR
LIGHT GRAY
(SHADED AREA FLAT BLACK)
FIRST

9
TOP BRACE
LIGHT GRAY
(SHADED AREA FLAT BLACK)
SECOND

72
MIRROR
FLAT BLACK
(MIRROR FACE SILVER)

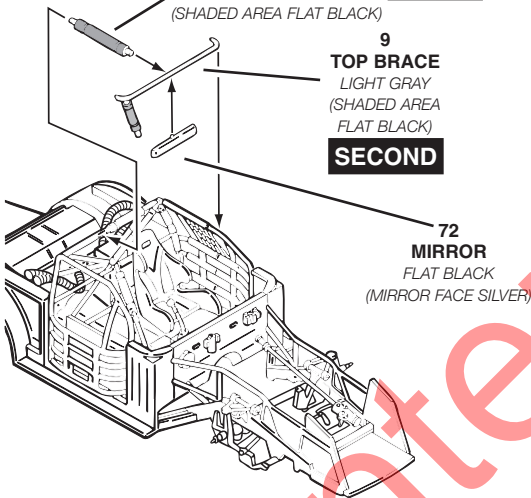

M

56
REAR SHELF
SEMIGLOSS
BLACK
THIRD

12
KICKER BAR
ASSEMBLY
LIGHT GRAY
SECOND

13
FUEL CELL
LIGHT GRAY
(PAINT SHADED
AREA ALUMINUM)
FIRST

92
REAR SUSPENSION
ADJUSTMENT TUBES
LIGHT GRAY

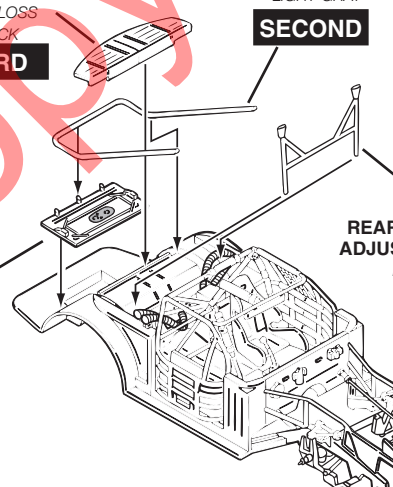

3

SUSPENSION / CHASSIS ASSEMBLY

A

59
OILER TANK
ALUMINUM

22
SHOCK ASSEMBLY
LIGHT GRAY
(SHADED AREA ALUMINUM)

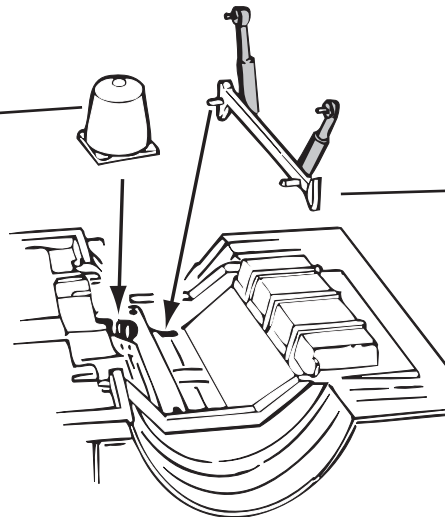

3

SUSPENSION / CHASSIS ASSEMBLY CONTINUED

B

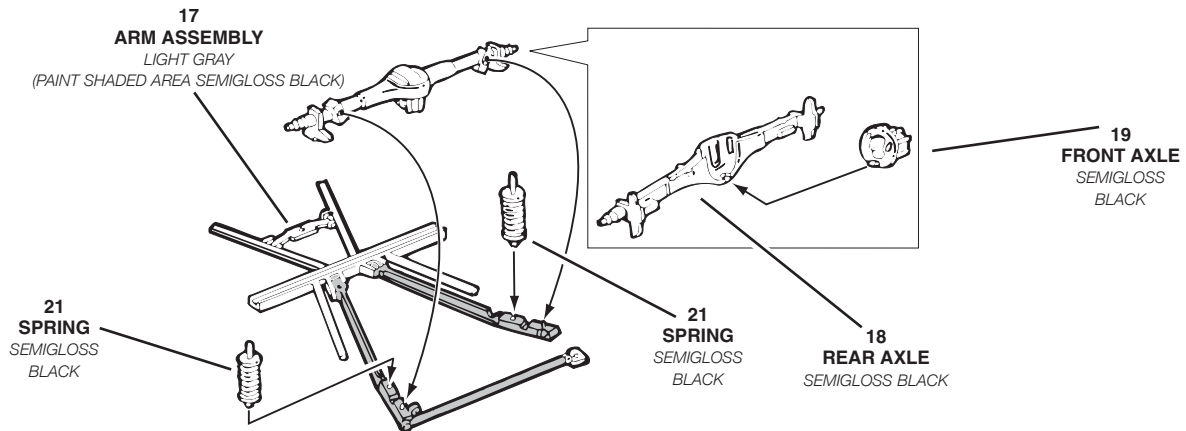

C

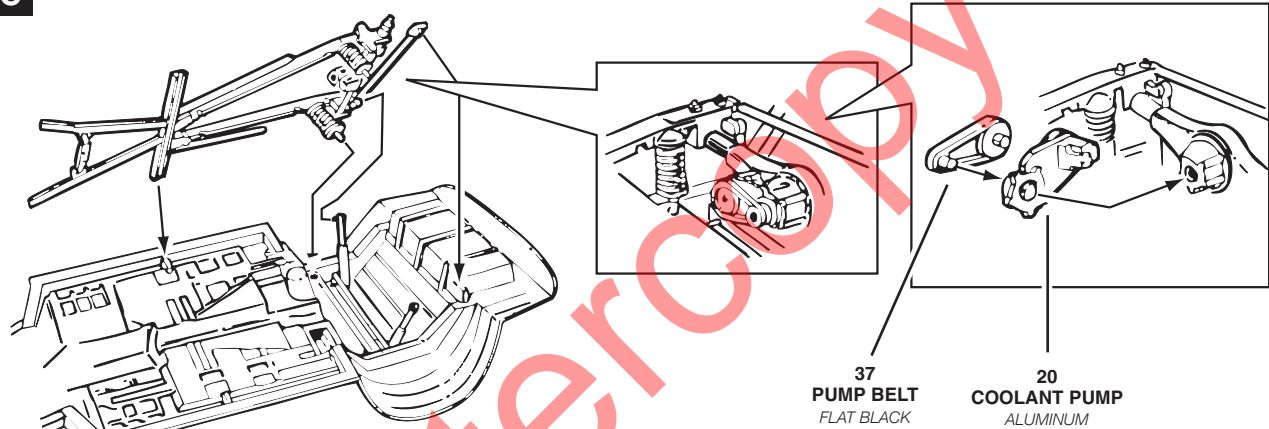

4

CHASSIS DETAIL ASSEMBLY

A

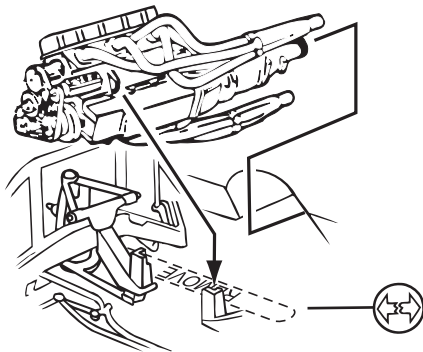

B

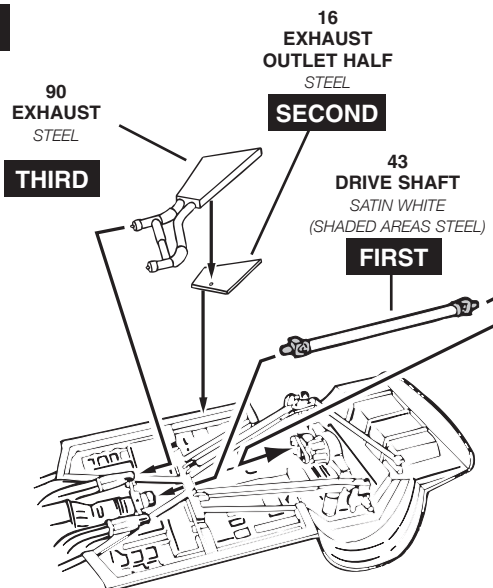

C

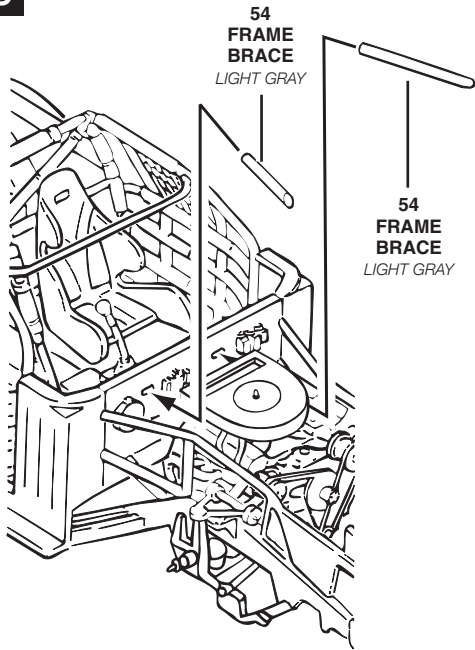

D

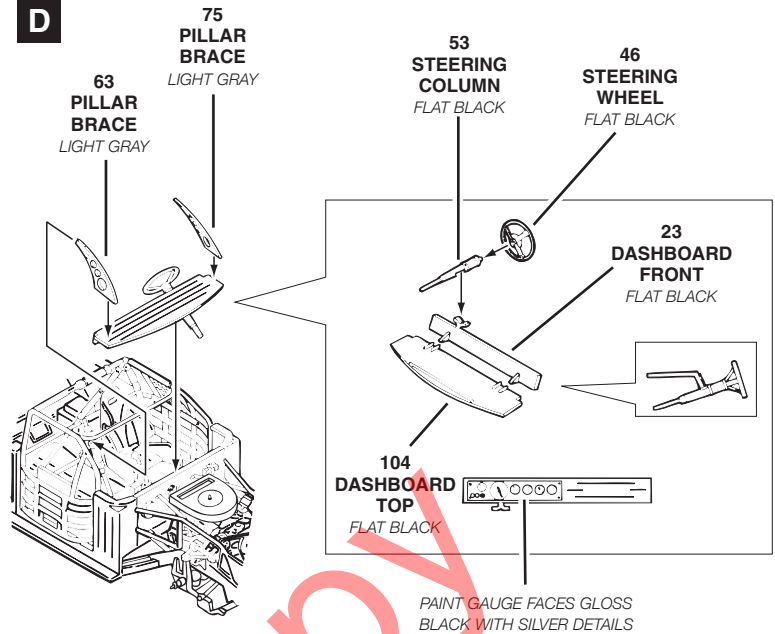

E

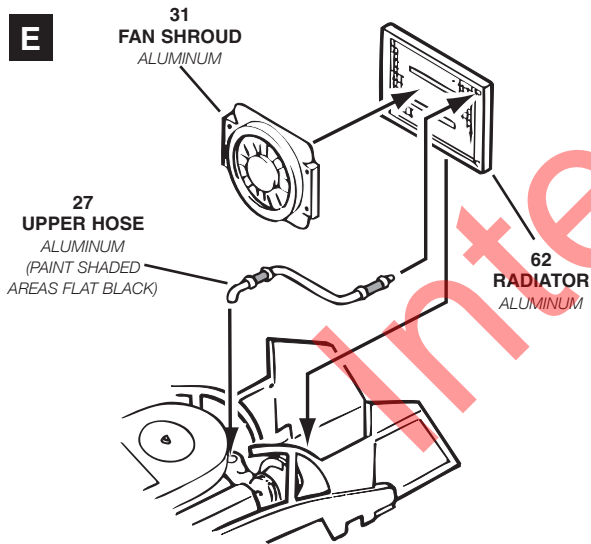

F

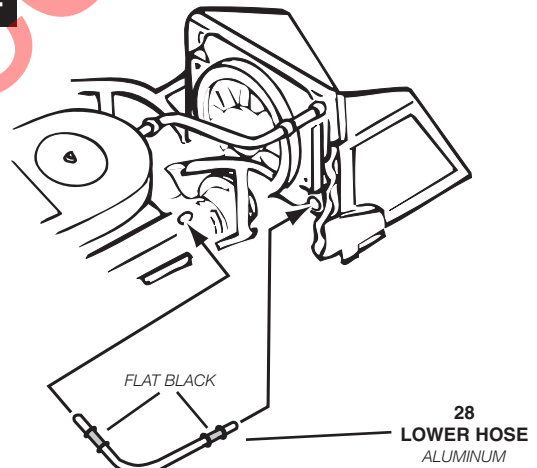

G

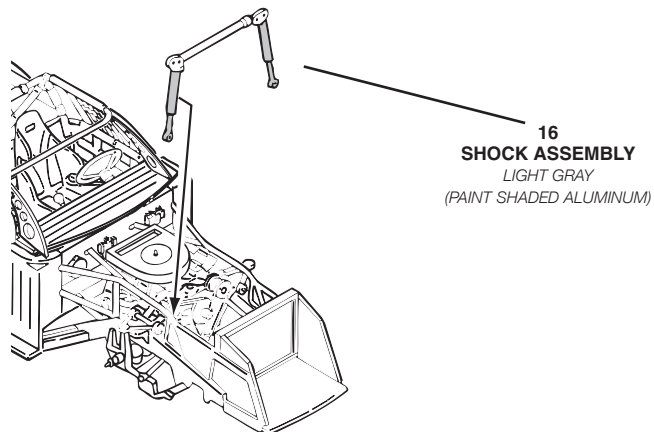

5

FINAL ASSEMBLY

A

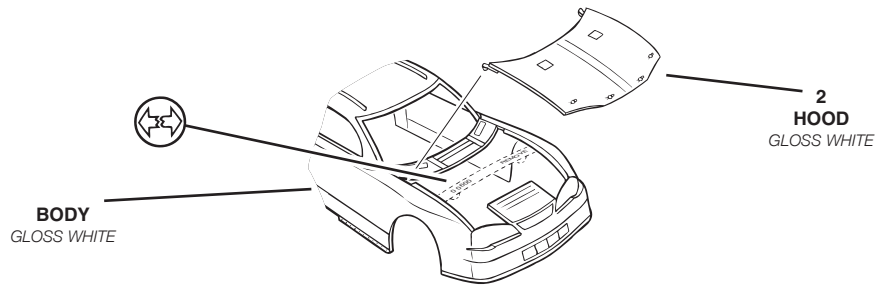

B

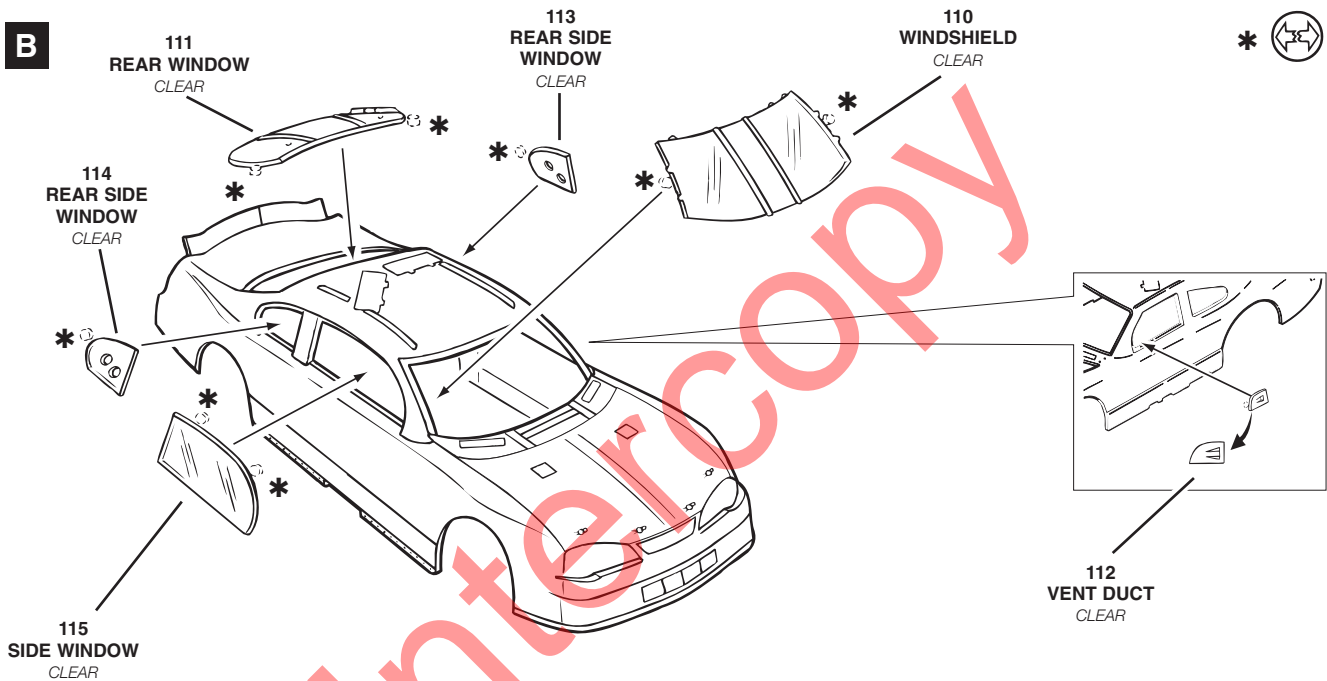

NOTE: PAINT ALL WINDOW TRIM SEMIGLOSS BLACK

C

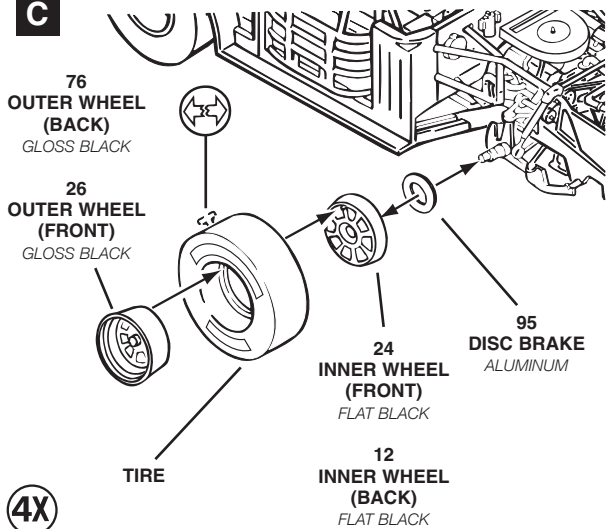

D

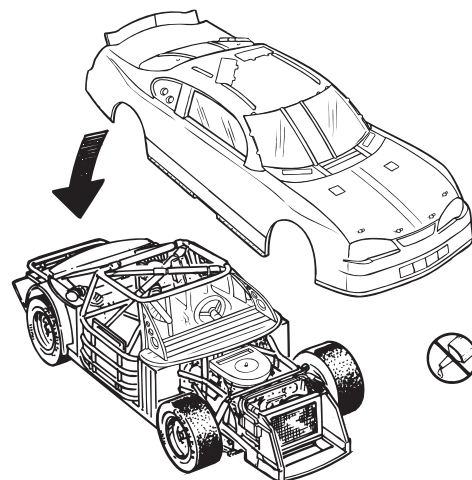

DECAL PLACEMENT



APPLY A-P IN ORDER FIRST!

DECALS 1, 2, 3, AND 4 ARE FOR INTERIOR USE ONLY

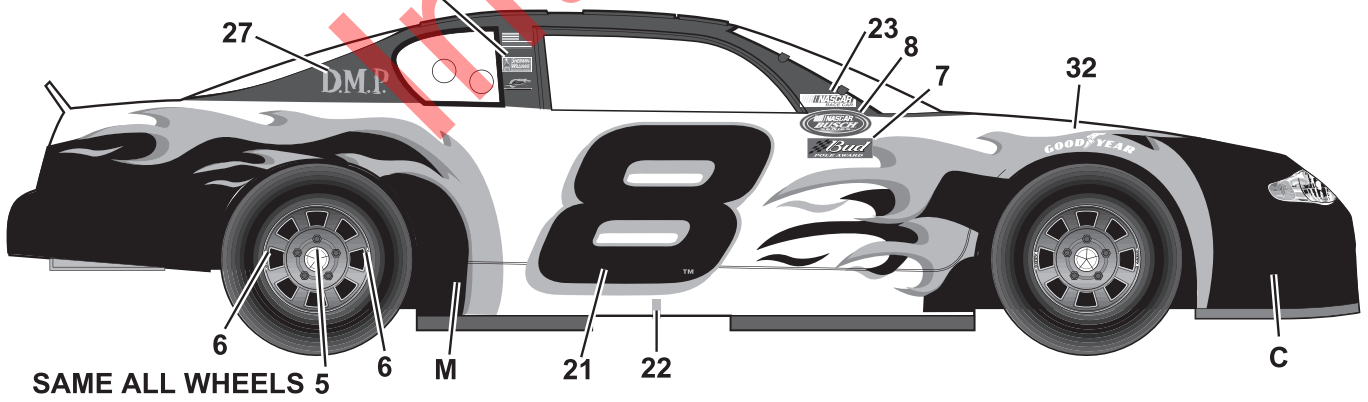
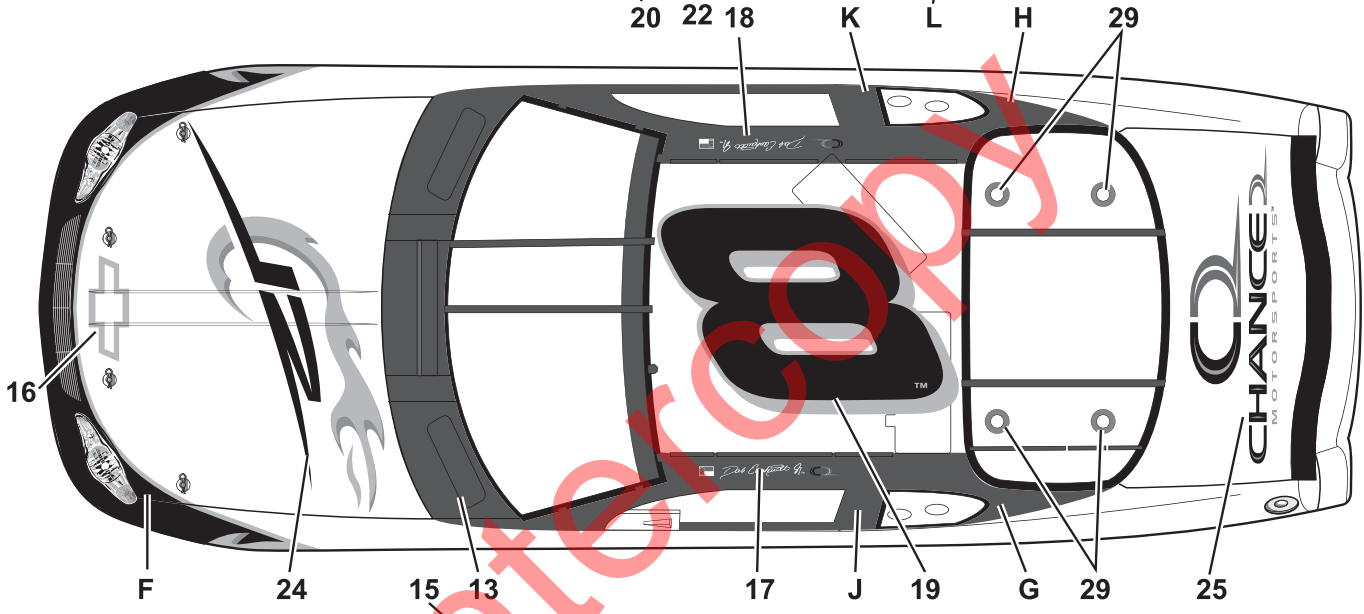
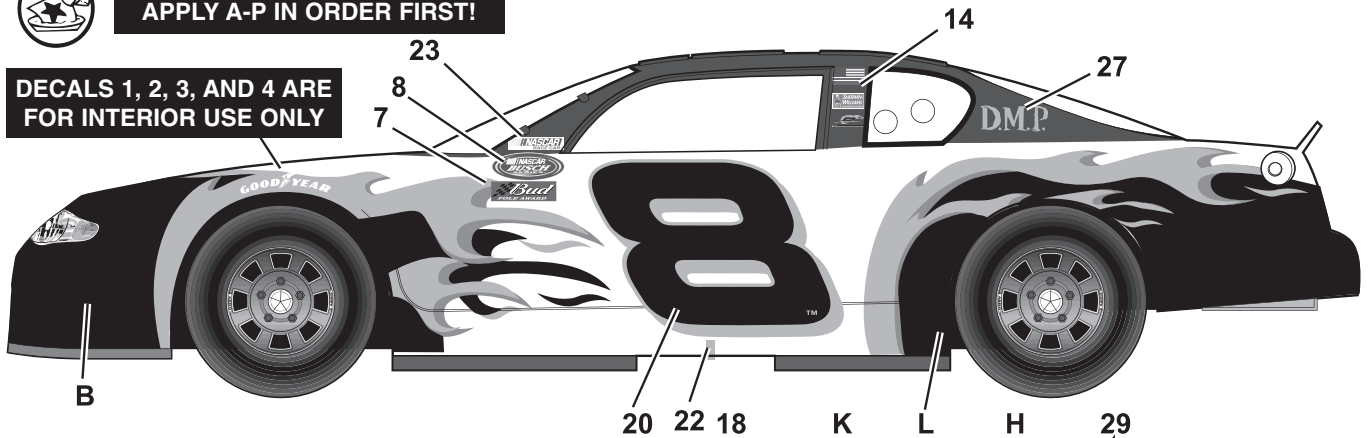

SAME ALL WHEELS 5 6 M

